



SmartBright LED Floodlight

BVP174 LED95/CW 100W WB GREY CE

SmartBright LED Floodlight - 9500 lm - 100 W - 5700 K

The SmartBright LED Floodlight is a versatile floodlight engineered to deliver significant energy savings, an ideal solution for diverse floodlighting applications. The product is also designed to meet relevant performance and safety standards, offering you reliable and long-lasting performance.

Product data

General Information	
Lamp family code	LED66 [LED module 6600 lm]
Light source color	757 cool white
Light source replaceable	No
Driver included	Yes
Optical cover/lens type	Polycarbonate bowl/cover UV-resistant
Luminaire light beam spread	30° x 80°
Control interface	-
Connection	Flying leads/wires
Cable	Cable 0.6 m without plug
Protection class IEC	Safety class I
Flammability mark	For mounting on normally flammable surfaces
CE mark	CE mark
Constant light output	No
Number of products on MCB of 16 A type B	26
Light source engine type	LED

Operating and Electrical	
Input Voltage	220 to 240 V
Input Frequency	50 or 60 Hz
Inrush current	9.7 A
Inrush time	0.065 ms
Power Factor (Min)	0.9
Controls and Dimming	
Dimmable	No
Mechanical and Housing	
Housing Material	Aluminum die cast
Optical cover/lens material	Polycarbonate
Mounting device	Mounting bracket adjustable
Optical cover/lens shape	Flat
Optical cover/lens finish	Frosted
Overall length	356 mm
Overall width	190 mm

SmartBright LED Floodlight

Overall height	53 mm
Effective projected area	0.11036 m ²
Color	Gray

Approval and Application

Ingress protection code	IP65 [Dust penetration-protected, jet-proof]
Mech. impact protection code	IK07 [2 J reinforced]

Initial Performance (IEC Compliant)

Initial luminous flux (system flux)	9500 lm
Luminous flux tolerance	+/-10%
Initial LED luminaire efficacy	95 lm/W
Init. Corr. Color Temperature	5700 K
Init. Color Rendering Index	>70
Initial chromaticity	SDCM<7
Initial input power	100 W
Power consumption tolerance	+/-10%

Application Conditions

Ambient temperature range	-40 to +45 °C
Maximum dim level	Not applicable

Product Data

Full product code	871016332101199
Order product name	BVP174 LED95/CW 100W WB GREY CE
EAN/UPC - Product	8710163321011
Order code	911401689704
Numerator - Quantity Per Pack	1
Numerator - Packs per outer box	6
Material Nr. (12NC)	911401689704
Net Weight (Piece)	2.300 kg



Dimensional drawing

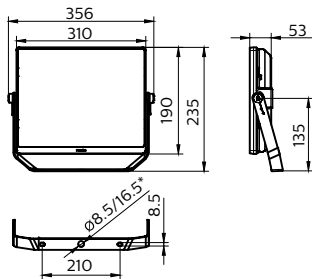

* Configuration for Australia, New Zealand and Korea

BVP173/174/175/176 Smartbright

