



ENGLISH

19" Cable Entry Panel with Brush

Material 1,5 mm Steel, Brush	Finish Electrostatic Powder Paint
Packaging One piece in a box	



H (U)	D (mm)	W (mm)	Weight kg	Part No
2U	10	483	0,3	CCA-X-5032

* X : color code = 7: RAL 7035 (Grey); 9: RAL 9005 (Black)

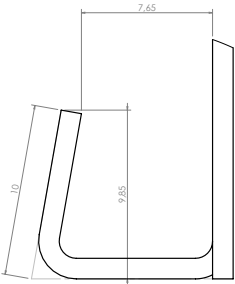
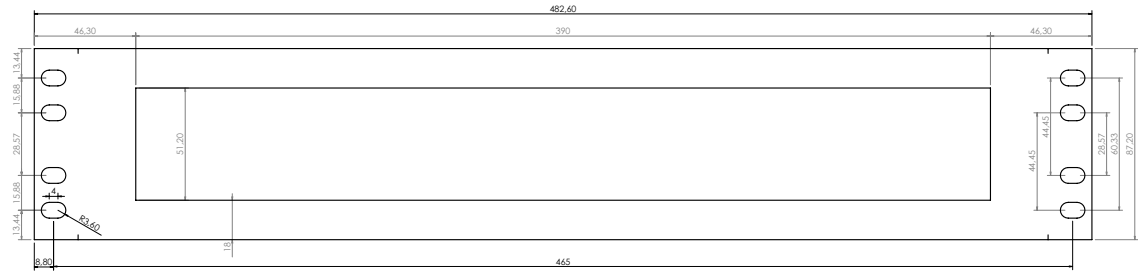

C (5 : 1)