

FEATURES

- Economical all-metal locking nut
- Ideal for heat environments
- Can be reused many times
- Adjustable
- Ideal for service and repairs
- No anti-vibration washer required
- Made from grade 8 steel
- Bright zinc plated finish offers resistance to corrosion

RS PRO Stover Locking Nut Zinc Plated Steel M8



RS Professionally Approved Products bring to you professional quality parts across all product categories. Our product range has been tested by engineers and provides a comparable quality to the leading brands without paying a premium price.

Family Name

Product Description

Stover Nuts are an economical hexagon all-metal self-locking nut. The self-locking function is produced by having irregularly shaped threads at the top of the nut; these threads grip the corresponding bolt threads, giving a stronger hold. Advantages to this are that they can be reused many times, be adjusted, and removed after installation - ideal for servicing, or repairs. Stover nuts are resistant to shocks and vibration; being all-metal, means that they are ideal for heat environments. They do not require any form of anti-vibration washer. They have a bright zinc plated finish, offering resistance to corrosion. Made from grade 8 steel.

General Specifications

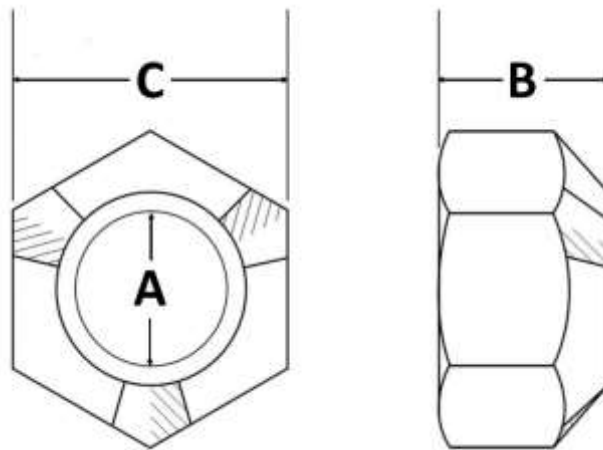

RS Stock No.	A – Diameter (mm)	B – Height (mm)	C – Across Flats (mm)
2253205	6	6	10
2253207	8	8	13
2253208	10	10	17
2253209	12	12	19
2253210	16	16	24
2253211	20	20	30



Connection Diagrams / Assembly Diagrams /
Illustrations / Accessories