



## Datasheet

# RS PRO GC4010 4.0mm Banana Female connector

Stock number: 180-5415

EN

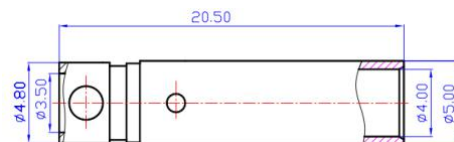

Section

## Material & Parameter

Recommend USE: Motor/controller  
Metal Material: Brass Gold Plated  
Use Times: 2000 TIMES  
Cable Spec: 14AWG

Contact Resistance: 0.55mΩ  
Rated Current: 32A  
Momentary Current: 70A

**Remark:** Data sheet will change according with the test background