



**APPLICATION GUIDE**  
**Shuttered Keystone Wallplate**  
**Socket with Keystone on**  
**Shuttered Wallplate**

**CAT. NO.**

E8231RJS

E8231RJS\_5

E8232RJS

E8232RJS\_5

E8231RJS4



E8232TDRJS\_5

E8232RJS4

**Pieno**

Thank you for choosing **Schneider Electric** Pieno's electronic accessories. To ensure proper application of our products, please read through the following information before installation and use.

**This application guide applies to the following products.**

	<b>Cat. no.</b>	<b>Description</b>
	E8231RJS	1 Gang Shuttered Keystone Wallplate (without Module)
	E8231RJS4	1 Gang Telephone Socket, Keystone on Shuttered Wallplate
	E8231RJS_5	1 Gang RJ45 Data Outlet, Category 5e, Keystone on Shuttered Wallplate
	E8232RJS	2 Gang Shuttered Keystone Wallplate (without Module)
	E8232RJS4	2 Gang Telephone Socket, Keystone on Shuttered Wallplate
	E8232RJS_5	2 Gang RJ45 Data Outlet, Category 5e, Keystone on Shuttered Wallplate
	E8232TDRJS_5	2 Gang Telephone + RJ45 Data Outlet, Category 5e, Keystone on Shuttered Wallplate

## SPECIFICATIONS

Dimension : 87mm x 87mm

Mounting Centre : 60.3 mm

## IMPORTANT NOTE

1. The products must be installed by qualified electricians.
2. Please check your local wiring regulations before installation.
3. Safekeeping the faceplate to prevent damage during product installation.
4. Turn off the power supply when you clean the product. Use a soft, slightly-moistened cloth or tissue paper to wipe off the dust and dirt on the surface. Clean with much diluted detergent if necessary but avoid using corrosive chemicals.

## WIRING DIAGRAMS

### MODULAR WIRING CONFIGURATION

COLOR CODE	T568B	T568A
White-Blue	5	5
Blue	4	4
White-Orange	1	3
Orange	2	6
White-Green	3	1
Green	6	2
White-brown	7	7
Brown	8	8

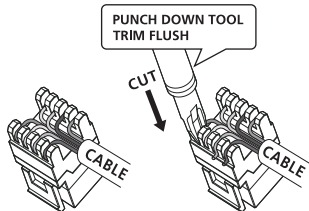

## MOUNTING INSTRUCTION

1. Connect the wires to the terminals (recommend to leave 10-12mm bare metal wire) and tighten the terminal screws.

2. Screw the grid plate onto the wall box.

3. Snap the faceplate onto the grid plate.

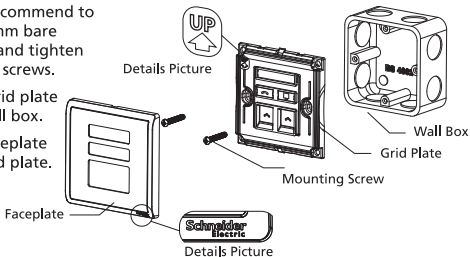

Insert a screwdriver into the clip lock, and twist the screwdriver to remove the faceplate.

