

Spherical Bearing Insert – Metric (Stainless Steel)

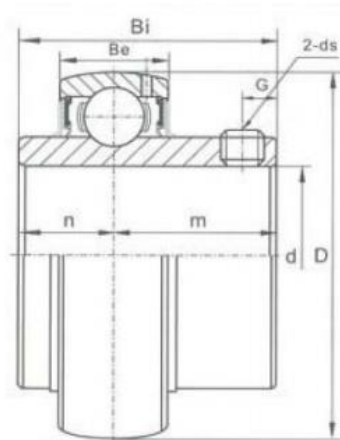

RS Article no.	Bearing unit No.	Shaft Dia.	Dimension (mm)							Basic Dynamic Load Rating (kgf)	Basic Static Load Rating (kgf)	Weight (kg)
		d (mm)	D	Bi	Be	n	m	G	ds			
7508706	UC204SS	20	47	31	17	12.7	18.3	4.5	M6x1.0	1000	630	0.16
7508716	UC205SS	25	52	34	17	14.3	19.7	5.5	M6x1.0	1100	710	0.20
7508728	UC206SS	30	62	38.1	19	15.9	22.2	6.0	M6x1.0	1520	1020	0.32
7508734	UC207SS	35	72	42.9	20	17.5	25.4	6.5	M8x1.0	2010	1390	0.46
7508740	UC208SS	40	80	49.2	21	19.0	30.2	8.0	M8x1.0	2560	1810	0.62