

RS Pro PB Switch Off-Mom SPDT Snap Solder

PA Series

Sub-Miniature Pushbutton Switches



IP 67
ACCORDING TO
EN 60529:1991+A1:2001
IEC 60529:2001

RoHS
compliant

Pb
lead free

SPECIFICATION:

MAX. CURRENT/VOLTAGE RATING WITH RESISTIVE LOAD:

100mA 24VDC-life expectancy 200,000 cycles
2A 125VAC-life expectancy 10,000 cycles

INITIAL CONTACT RESISTANCE: 50mΩ max.

INSULATION RESISTANCE: 1GΩ min.at 500VDC.

DIELECTRIC STRENGTH: 1,000 VAC rms.

ELECTRICAL LIFE AT FULL LOAD: 200,000 cycles.

OPERATING TEMPERATURE: -30°C to 85°C.

PANEL THICKNESS: 1.5 mm (.059) min. -4 mm (.157) max.

TOTAL TRAVEL: 2.5 mm (.098)

OPERATING FORCE: 2N~5N

CONTACT BOUNCE: 10 ms.

MECHANICAL LIFE: 1,000,000 cycles.

TORQUE: 0.5 Nm max.applied to nut

SOLDERING: 350°C max.for 5 seconds.

HOW TO ORDER

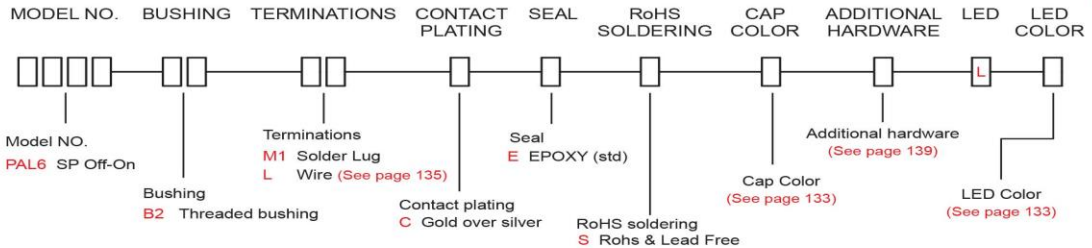

PA (Lock)
Pushbutton Switches

SWITCH FUNCTION

MODEL NO.	POS.1	POS.2
PAL6	OFF	ON
TERM. COMM.	OPEN	1-3
SCHEMATIC		

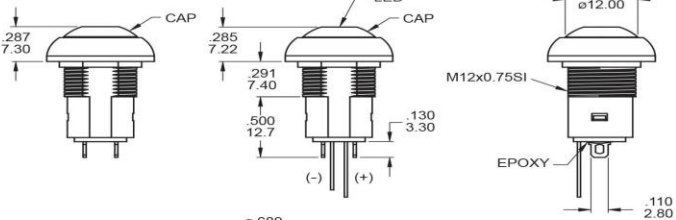

PANEL MOUNTING

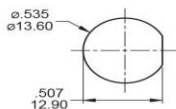

ADDITIONAL HARDWARE

- 1.M12 X 0.75 NUTS (MNU- PA03)
- 2.LOCKING WASHER (MNU-1M09)
- 3.O-RING (FCP-A253)

L1

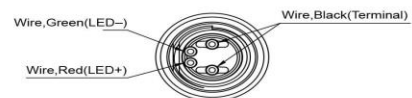
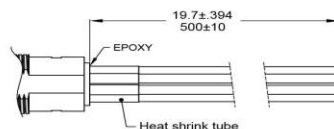

※ Multi-wire lead AWG20,section 0.6mm²,UL approved.
(Black / Green / Red)



PA Series

Sub-Miniature Pushbutton Switches

SWITCH FUNCTION

NO. POLES	MODEL NO.	SWITCH FUNCTION		CONNECTED TERMINALS		SCHEMATIC
		POS.1	POS.2	POS.1	POS.2	
SP	PAS6	OFF	MOM	OPEN	1-3	
SP	PAS7	ON	OFF(MOM)	1-3	OPEN	

MOM=MOMENTARY



PA
Pushbutton Switches

B1

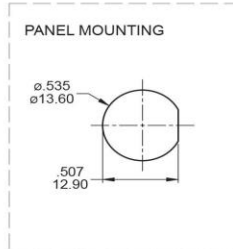
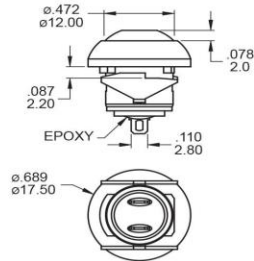
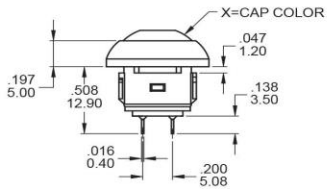

SPST

Part No. Shown : PAS6B1M1CESX-5

B1

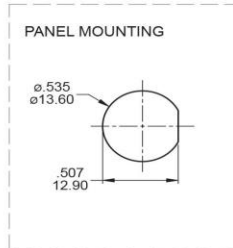
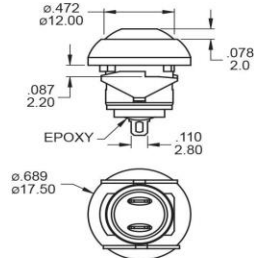
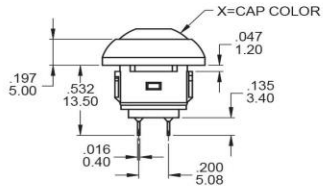

SPST

Part No. Shown : PAS7B1M1CESX-5

B2

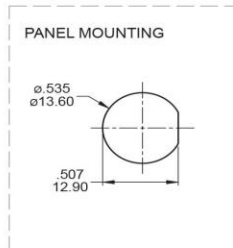
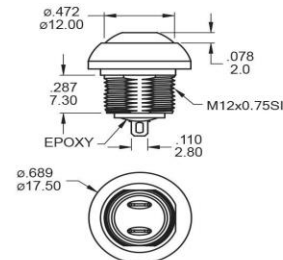
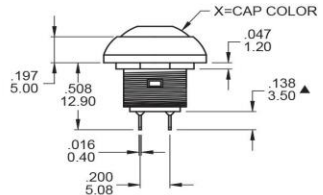

SPST

Part No. Shown : PAS6B2M1CESX-5

B3

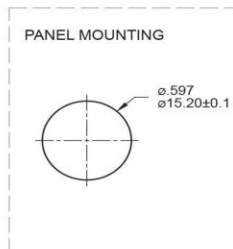
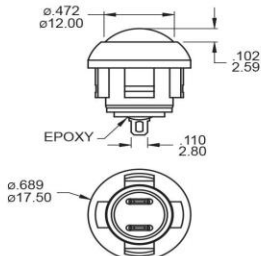
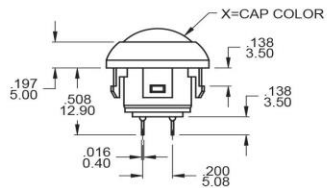

SPST

Part No. Shown : PAS6B3M1CESAX-5

PA Series

Sub-Miniature Pushbutton Switches

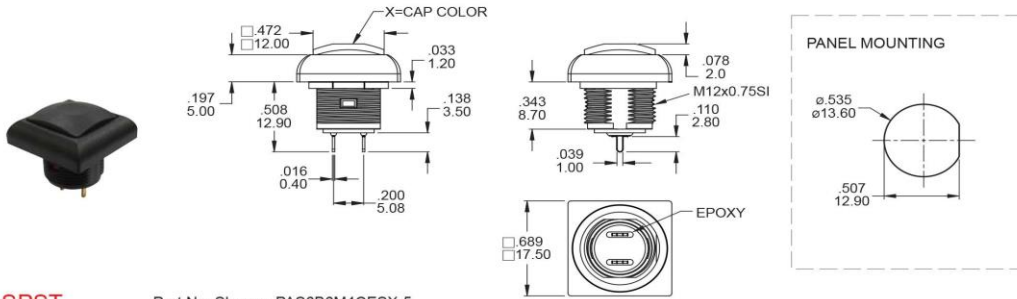

SPST

Part No. Shown : PAS6B6M4CESX-5

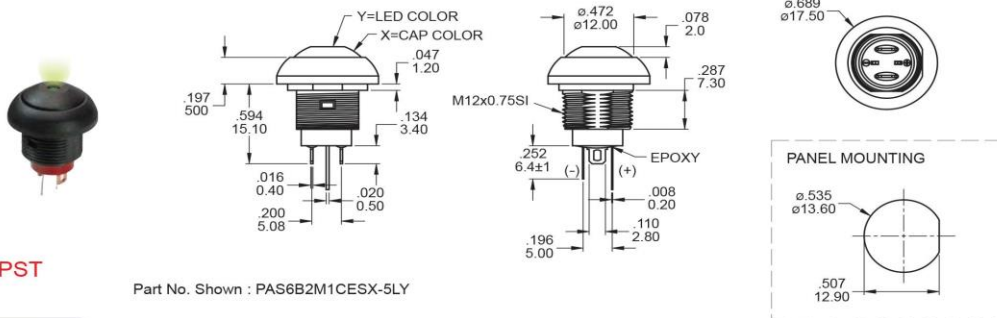

SPST

Part No. Shown : PAS6B2M1CESX-5LY

WIRE

Note: When the switches with the wire assembly, we only test the electric conduction and will not test the contact resistance on the wire.

L1

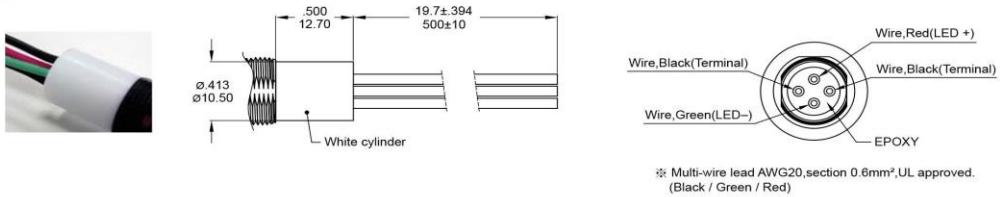

L2

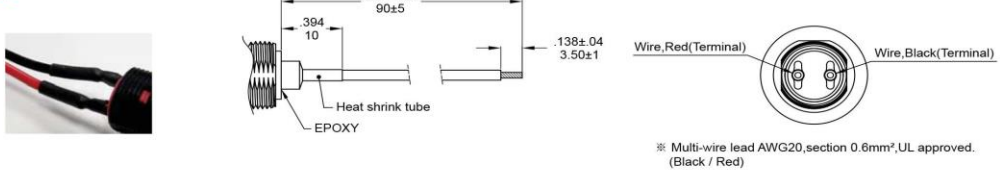

L3

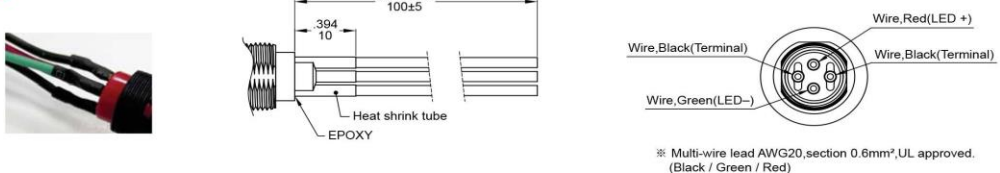



PA Series

Sub-Miniature Pushbutton Switches

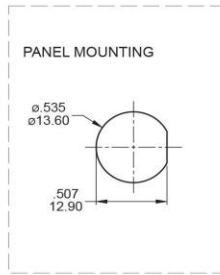
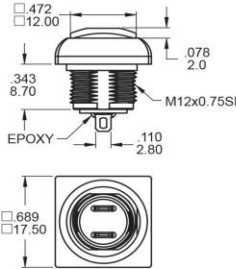
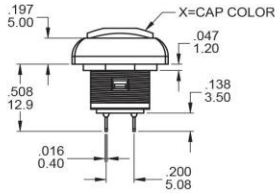

SPST

Part No. Shown : PAS6D1M1CESX-5



PA
Pushbutton Switches

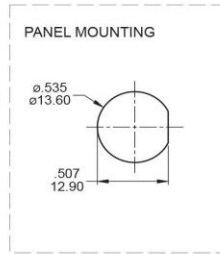
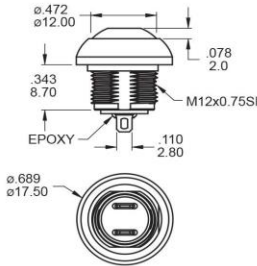
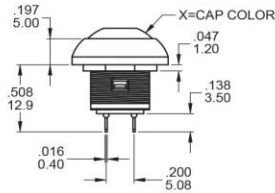

SPST

Part No. Shown : PAS6D2M1CESX-5

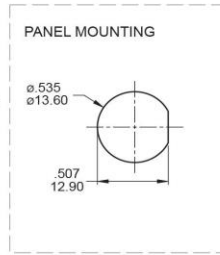
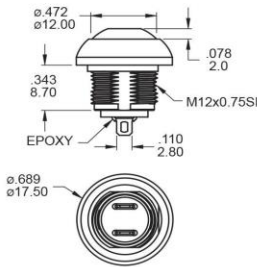
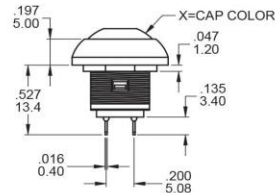

SPST

Part No. Shown : PAS7D2M1CESX-5

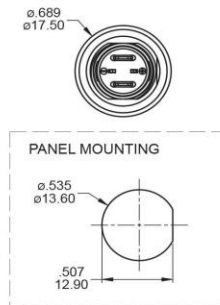
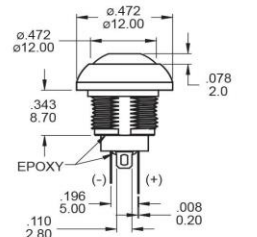
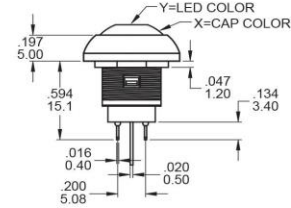

SPST

Part No. Shown : PAS6D2M1CESX-5LY

BUSHING PLATING



- PLATING
- A Chromium
 - C Stain-chromium
 - D Stain-nickel



Chromium



Stain-chromium



Stain-nickel



PA Series

Sub-Miniature Pushbutton Switches



SPECIFICATION:

MAX. CURRENT/VOLTAGE RATING WITH RESISTIVE LOAD:

100mA 24VDC-life expectancy 200,000 cycles
2A 125VAC-life expectancy 10,000 cycles

INITIAL CONTACT RESISTANCE: 50mΩ max.

INSULATION RESISTANCE: 1GΩ min.at 500VDC.

DIELECTRIC STRENGTH: 1,000 VAC rms.

ELECTRICAL LIFE AT FULL LOAD: 200,000 cycles.

OPERATING TEMPERATURE: -30°C to 85°C.

PANEL THICKNESS: 1.5 mm (.059) min. -4 mm (.157) max.

TOTAL TRAVEL: 2.5 mm(.098)

OPERATING FORCE: 2N~5N

CONTACT BOUNCE: 10 ms.

MECHANICAL LIFE: 1,000,000 cycles.

TORQUE: 0.5 Nm max.applied to nut

SOLDERING: 350°C max.for 5 seconds.

IP 67
ACCORDING TO
EN 60529 (IEC 60529)



HOW TO ORDER

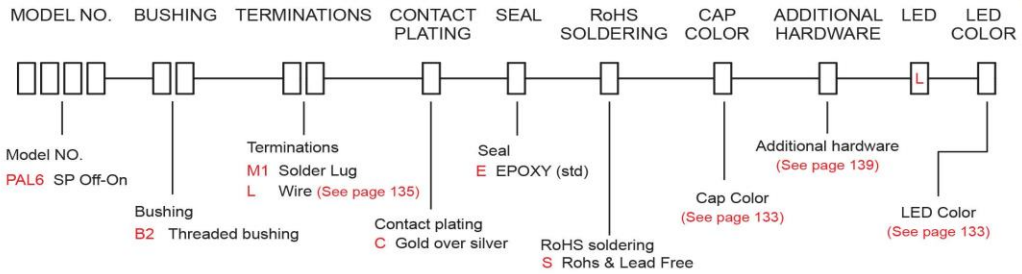

PA (Lock)
Pushbutton Switches

SWITCH FUNCTION

MODEL NO.	POS.1	POS.2
	PAL6	OFF
TERM. COMM.	OPEN	1-3
SCHEMATIC		

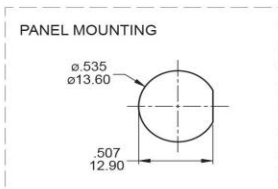
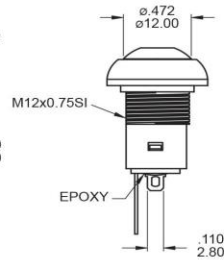
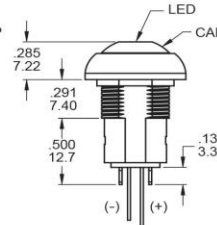
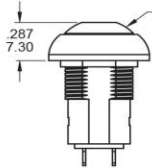

Non-LED

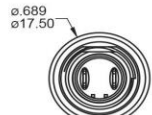

LED

ADDITIONAL HARDWARE

- 1.M12 X 0.75 NUTS (MNU- PA03)
- 2.LOCKING WASHER (MNU-1M09)
- 3.O-RING (FCP-A253)

L1

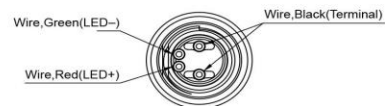
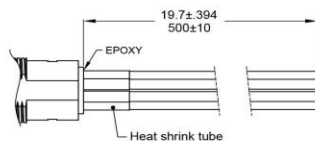

* Multi-wire lead AWG20, section 0.6mm², UL approved.
(Black / Green / Red)



PA Series

Sub-Miniature Pushbutton Switches

B2

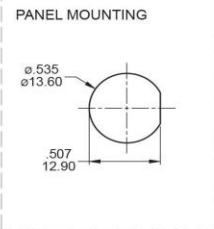
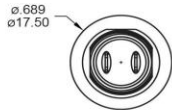
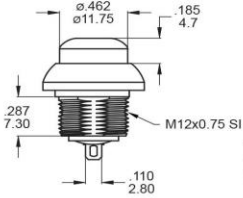
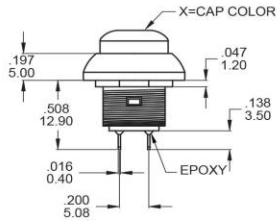

SPST

Part No. Shown : PAS6B2M1CESGX-5

D2

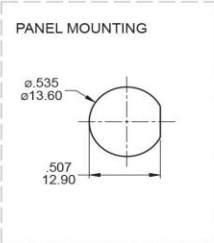
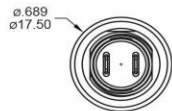
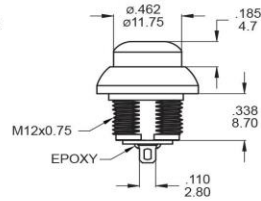
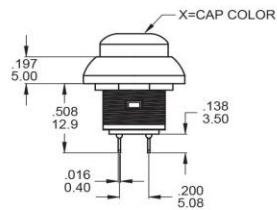

SPST

Part No. Shown : PAS6D2M1CESGX-5

B2

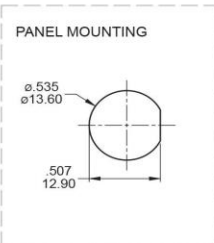
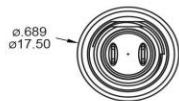
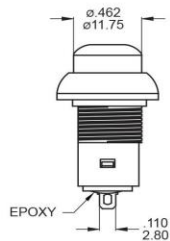
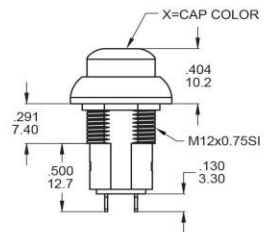

SPST

Part No. Shown : PAL6B2M1CESGX-5



PA (High CAP)
Pushbutton Switches

HARDWARE

M12 NUT

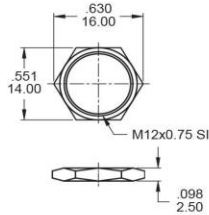

M12x0.75 SI
MNU-PA03

LOCK WASHER

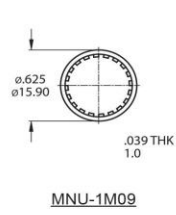

MNU-1M09

Supplied with B2 / D1 / D2 bushing

O-RING

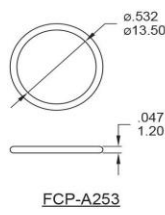

FCP-A253

Supplied with PAL6 and D1 / D2 options

O-RING

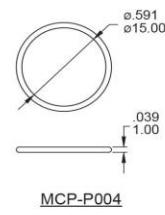

MCP-P004

Supplied standard with B3 options

EVA WASHER

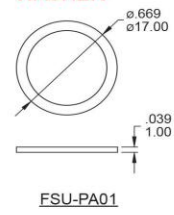

FSU-PA01

Supplied standard with B1 / B2 options

RUBBER - HOOD

MCP-P003 (Transparent cap)



MCP-P003-2 (Black cap)

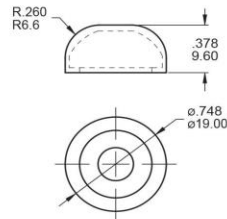

SOLDERING PROCESSES

MANUAL SOLDERING: Use soldering iron of 30 watts, controlled at 350°C approximately 5 seconds while applying solder.

WAVE SOLDERING:

Recommended Soldering Temperature: 260 ± 5°C

Duration of Solder Immersion: Max 5 sec.

(PCB is 1.6mm in thickness)

IP 67 for the whole series:
Protected against the effects of immersion up to 1 m water(30mn)

