

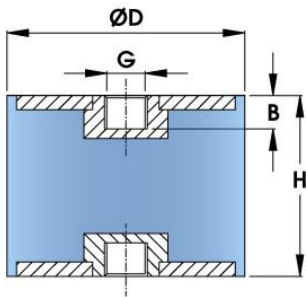

ENGLISH

Female – Female Cylindrical Mounts

A simple and cost-effective mount. For use in compression and shear. A very large range of available size and studs.



- H = Height
- D = Diameter
- G = Tread
- B = Thread Depth

RS Code	Item Code	Description	D (mm)	H (mm)	G x L/B (mm)	Max Compression Load (kg)	Max Shear Load (kg)
1623237	C2020M6-2	Cyl. Mount (F/F) 20x20mm M6 60 ShA	20	20	M6	27	10.12