

Datasheet

# Snap-in grabber latch

RS Stock No: 1611953

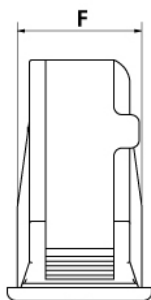

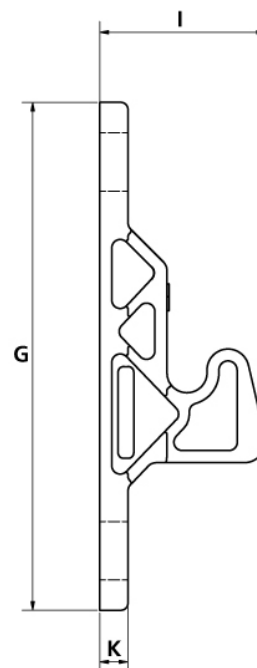
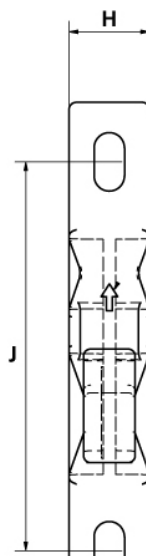
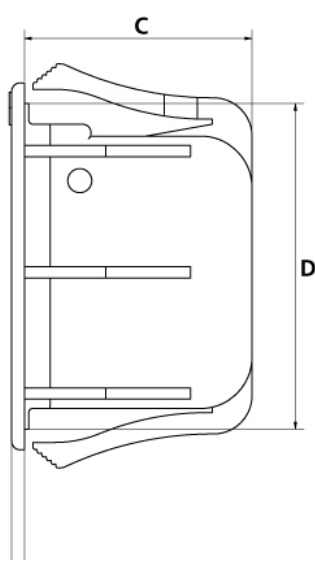
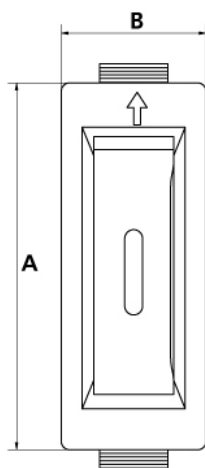

ENGLISH

## Specification

Spring loaded, over-centre latches, made from corrosion resistant materials

Catch snaps into frame, pull to open

Fits frame from 1.1 to 2.9mm thick

Housing ABS polycarbonate, keeper mineral filled nylon

Part Number	A	B	C	D	E	F	Pull Force (N)
1611953	43	17	26.7	38.2	1.5	14.6	44

Part Number	G	H	I	J	K	Bore Size
1611953	72	11.4	23.5	55	4	4.3 x 8.3