

Thank you for choosing **Schneider Electric™ AvatarOn C** series products. To ensure proper application of our product, Please read through the following information before installation and use.

This application guide applies to the following products.

(Notes: suffix_WE/WG/DG.....G*etc. mean the colors and sales areas)

English	Arabic
Socket	مقبس
USB Socket	مقبس USB
Switch	
VDI	
Connection Unit	
Multi gang	
Keycard Switch	
Universal Shaver Socket	
Hotel Accessories	
Universal Dimmer	
Fan Controller	

Thank you for choosing **Schneider Electric™ AvatarOn C** series products. To ensure proper application of our product, Please read through the following information before installation and use.

This application guide applies to the following products.

(Notes: suffix _WE/WG/DG.....G*etc. mean the colors and sales areas)

Cat. No.	Description
E8715	13A 250V 1 gang with switch socket
E8715N	13A 250V 1 gang with switch socket with LED
E87T25	13A 250V 2 gang with switch socket
E87T25N	13A 250V 2 gang with switch socket with LED
E8715_15	15A 250V 1 gang 3 round pin with switch socket
E87426	13A 250V 1 gang socket
E87426_15	15A 250V 1 gang 3 ROUND PIN socket
E87T426	13A 250V twin Gang socket

SPECIFICATIONS

Rated Voltage	:250V~
Mounting center	:60.3mm
Rated Current	:Refer to product marking

⚠ WARNING

ELECTRIC SHOCK, EXPLOSION OR ARCING HAZARD

- This product must be installed by qualified electricians.
- This product should only be used in accordance with this specification and under the appropriate circumstance, Please check your local wiring regulations before installation.
- The power must be disconnected before installation, maintenance or replacement.
- Make sure the product is installed completely and safely before turning on the power.
- Avoid any foreign objects ingress into USB charger such as small metal wires, paper clips, liquids, etc.

Failure to follow this instruction may result in death or serious injury.

CAUTION

RISK OF DAMAGE DEVICE

- Please install with standard wall box to ensure the product to be used properly
- Please keep the front cover safe in order to prevent damages before and during installation.
- Ensure the power supply is turned off when cleaning the product. Use a piece of soft and dry cloth to wipe off the dirt and contamination on the surface. Do NOT use corrosive chemicals.
- Shield / mask the product before renovation to avoid contamination and degradation.
- Indoor use only.

Failure to follow this instruction may result in damage to the device.

WIRING DIAGRAMS

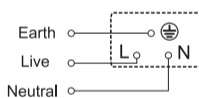

MOUNTING INSTRUCTION

- 1 Remove the surround.
- 2 Insert the wires into the terminals and tighten the terminal screws.
- 3 Fix the grid plate onto the wall box with mounting screw.
- 4 Reattach the surround.

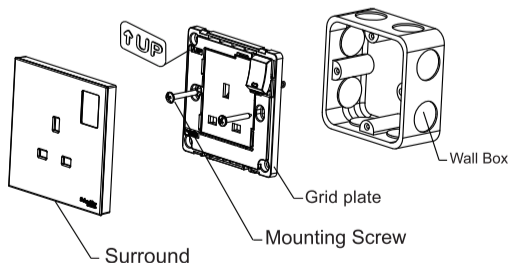

***COVER REMOVE INSTRUCTION.**

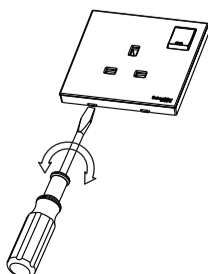

Thank you for choosing **Schneider Electric™ AvatarOn C** series products. To ensure proper application of our product, Please read through the following information before installation and use.

This application guide applies to the following products.
 (Notes: suffix _WE/WG/DG.....G*etc. mean the colors and sales areas)

Cat. No.	Description
E8732ACQUSB	21W A+C, fast charging, USB charger
E8715USB	13A 1 gang switch socket with 2.1A 2 port USB
E8715USBR	13A 1 gang switch socket with 2.1A 2 port USB
E87426ACUSB	13A socket with 21W USB A+C fast charging
E8715DACUSB	13A socket with double pole switch with 21W USB A+C fast charging
E8715DACUSBR	13A socket with double pole switch with 21W USB A+C fast charging
E87T25ACUSB	13A 2G Switched Socket with USB A+C 21W

SPECIFICATIONS

CR No. / SPEC	E8732ACQUSB	E8715USB / E8715USBR	E87426ACUSB / E8715DACUSB / E8715DACUSBR	E87T25ACUSB
USB rated input	100-240V~ 50/60Hz 0.6A Max	100-250V~ 50/60Hz 0.45A Max	220-250V~ 50/60Hz 0.45A Max	100-250V~ 50/60Hz 0.6A Max
USB output	Type C: 5V ≡ 3A ; 9V ≡ 2A ; 12V ≡ 1.5A ; Type A: 5V ≡ 3A ; 9V ≡ 2A ; 12V ≡ 1.5A Type A+C: 5V ≡ 4.2A (2.4A Max. for each port)	5V ≡ 2.1A Max. for each port	Type C: 5V ≡ 3A ; 9V ≡ 2.33A ; 12V ≡ 1.75A ; 15V ≡ 1.4A Type A: 5V ≡ 3A ; 9V ≡ 2A ; 12V ≡ 1.5A Type A+C: 5V ≡ 3.2A (2.4A Max. for each port)	Type C: 5V ≡ 3A ; 9V ≡ 2.3A ; 12V ≡ 1.8A ; Type A: 5V ≡ 3A ; 9V ≡ 2.3A ; 12V ≡ 1.8A Type A+C: 5V ≡ 3.2A (2.4A Max. for each port)
USB Protection	Over heat, output over current, output over voltage, output short circuit			
Socket voltage; current	250V~ ; 13A			
Mounting centre	60.3mm		120.6mm	
Operation Temperature	0-40°C		0-35°C	

⚠ WARNING

ELECTRIC SHOCK, EXPLOSION OR ARCING HAZARD

- This product must be installed by qualified electricians.
- This product should only be used in accordance with this specification and under the appropriate circumstance. Please check your local wiring regulations before installation.
- The power must be disconnected before installation, maintenance or replacement.
- Make sure the product is installed completely and safely before turning on the power.
- This permanently connected equipment does not contain internal disconnected device, a readily accessible disconnected device should be provided externally.
- The product should be mounted on the surface of concrete or non-flammable materials.
- Avoid any foreign objects ingress into USB charger such as small metal wires, paper clips, liquids, etc.

Failure to follow this instruction may result in death or serious injury.

CAUTION

RISK OF DAMAGE DEVICE

- This product is only applicable at altitudes below 2000m.
- Please install this product in a British Standard wall box with 2 lugs of 47mm depth.
- Please shield / mask the product before renovation to avoid damage or contamination.
- Please keep the front cover safe in order to prevent damages before and during installation.
- Ensure the power supply is turned off when cleaning the product. Use a piece of soft and dry cloth to wipe off the dirt and contamination on the surface. Do NOT use corrosive chemicals.
- Before charging the product, please ensure the battery of your device is complied with Battery Charging Specification. Do not use multi-adaptors for multiple charging to avoid damaging devices.
- Please check the voltage at the home should not be higher than the rated voltage during installation, otherwise the USB module may be damaged
- The charging time depends on the supported charging protocol, power, battery capacity, charging line quality and other factors decided by the charged device itself.
- Some charging cables integrated with charging facility, connecting this kind of charging cable may trigger the normal charging mode.
- User will feel some heat at the product surface when charging is in progress
- Indoor use only.

Failure to follow this instruction may result in damage to the device.

WIRING DIAGRAMS

E8732ACQUSB

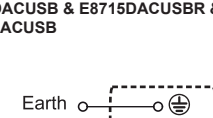
E8715USB & E8715USBR & E87426ACUSB & E8715DACUSB & E8715DACUSBR & E87T25ACUSB

MOUNTING INSTRUCTION

- 1 Remove the surround.
- 2 Insert the wires into the terminals and tighten the terminal screws.
- 3 Fix the grid plate onto the wall box with mounting screw.
- 4 Reattach the surround.

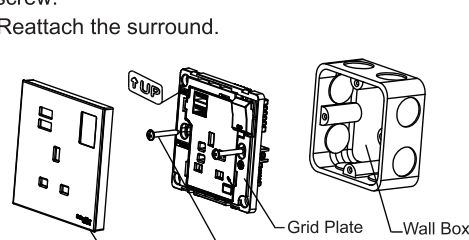

E8715USBR

*Open lid for insulation resistance test

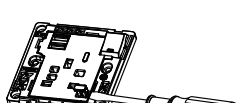

E8715DACUSBR

Remove surround to turn off the micro switch for the insulation resistance test.

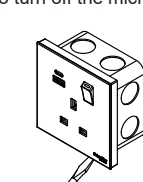

*COVER REMOVE INSTRUCTION

1G switched socket with USB

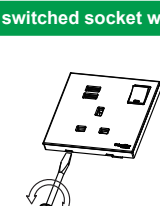

2G switched socket with USB

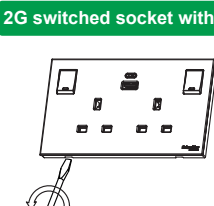

Note: Each terminal shall be able to accept solid or stranded cable as below

Terminal wiring capacity	a) 1~4X1.5mm ² b) 1~2X2.5mm ² c) 1X4mm ²
--------------------------	------------------------------------------------------------------------------

Thank you for choosing **Schneider Electric™ AvatarOn C** series products. To ensure proper application of our product, Please read through the following information before installation and use.

This application guide applies to the following products.
 (Notes: suffix _WE/WG/DG.....G*etc. mean the colors and sales areas)

Cat. No.	Description
E8731L1F	16AX 250V 1G 1 WAY switch with fluorescent locator
E8731L2F	16AX 250V 1G 2 WAY switch with fluorescent locator
E8732L1F	16AX 250V 2G 1 WAY switch with fluorescent locator
E8732L2F	16AX 250V 2G 2 WAY switch with fluorescent locator
E8733L1F	16AX 250V 3G 1 WAY switch with fluorescent locator
E8733L2F	16AX 250V 3G 2 WAY switch with fluorescent locator
E8734L1F	16AX 250V 4G 1 WAY switch with fluorescent locator
E8734L2F	16AX 250V 4G 2 WAY switch with fluorescent locator
E8731D20N	20A 250V 1 gang double pole switch with LED
E8732D20N	20A 250V 2 gang double pole switch with LED
E8731D20N_2	20A 250V 1 gang 2 WAY double pole switch with LED
E8731D32N	32A 250V 1 gang double pole switch with LED
E8731D45N	45A 250V 1 gang double pole switch with LED
E8731MF	16AX 250V 1 gang intermediate switch with fluorescent locator
E8731BP	10A 250V 1G BELL PRESS switch with fluorescent locator
E8731PRF	10A 250V 1G momentary switch with fluorescent locator
E8732PRF	10A 250V 2 gang momentary switch with fluorescent locator
E8733PRF	10A 250V 3G momentary switch with fluorescent locator

SPECIFICATIONS

Rated Voltage	: 250V~
Mounting center	: 60.3mm
Rated Current	: Refer to product marking
Self ballasted lamp(SBL) Load	: 200 W(16 AX) 250 W(20A)

⚠ WARNING

ELECTRIC SHOCK, EXPLOSION OR ARCING HAZARD

- This product must be installed by qualified electricians.
- This product should only be used in accordance with this specification and under the appropriate circumstance, Please check your local wiring regulations before installation.
- The power must be disconnected before installation, maintenance or replacement.
- Make sure the product is installed completely and safely before turning on the power.
- Avoid any foreign objects ingress into USB charger such as small metal wires, paper clips, liquids, etc.

Failure to follow this instruction may result in death or serious injury.

CAUTION

RISK OF DAMAGE DEVICE

- Please install with standard wall box to ensure the product to be used properly
- Please keep the front cover safe in order to prevent damages before and during installation.
- Ensure the power supply is turned off when cleaning the product. Use a piece of power and dry cloth to wipe off the dirt and contamination on the surface. Do NOT use corrosive chemicals.
- Shield / mask the product before renovation to avoid contamination and degradation.
- Indoor use only.

Failure to follow this instruction may result in damage to the device.

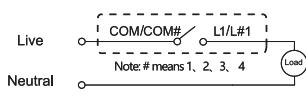
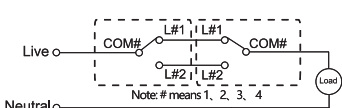
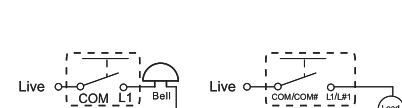
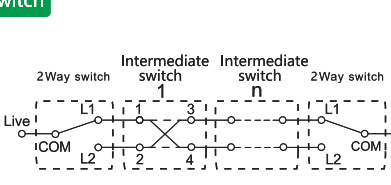
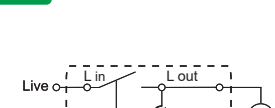
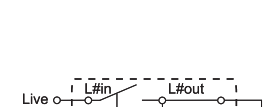
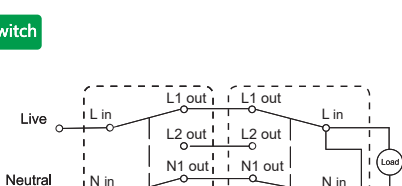
WIRING DIAGRAMS
1G/2G/3G/4G 1Way switch

1G/2G/3G/4G 2Way switch

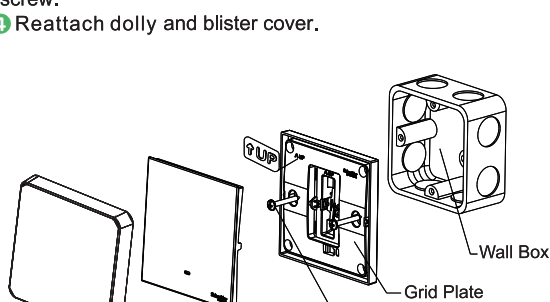
Door bell & Momentary switch

Intermediate switch

1G 20A/32A/45A 1Way switch

2G 20A 1Way switch

1G 20A 2Way switch

MOUNTING INSTRUCTION

- 1 Remove the blister cover and dolly.
- 2 Insert the wires into the terminals and tighten the terminal screws.
- 3 Fix the grid plate onto the wall box with mounting screw.
- 4 Reattach dolly and blister cover.



*COVER REMOVE INSTRUCTION



Thank you for choosing **Schneider Electric™ AvatarOn C** series products. To ensure proper application of our product, Please read through the following information before installation and use.

This application guide applies to the following products.

(Notes: suffix _WE/WG/DG.....G*etc. mean the colors and sales areas)

Cat. No.	Description
E8731RJS4	1 Gang TELEPHONE socket, KS ON ST WALLPLATE
E8731RJSC	1 Gang RJ45 Data Socket Cover without module
E8732RJS4	2 Gang TEL socket, KS ON SHU WP
E8732RJSC	2 Gang RJ45 Data Socket Cover without module
E8731TV	1 Gang TV socket, 75OHM, THROUGH-CNN
E8731TVF	1 Gang CATV socket ,45 DEGREE , F CNN
E8732TVF	2 Gang TV socket + F CNN
E8733SMATV	SMAT TV, FM, F socket
E8731RJS5	1 Gang RJ45 DATA, CAT5E, KS ON SHU WP
E8732RJS5	2 Gang RJ45 DATA, CAT5E, KS ON SHU WP
E8731RJS6	1 Gang RJ45 DATA, CAT6, KS ON SHU WP
E8732RJS6	2 Gang RJ45 DATA, CAT6, KS ON SHU WP
E8732TDRJS5	1 Gang TEL+RJ45 DATA, CAT5E, KS ON SHU WP
E8732TVFMM	2 Gang TV Master/FM Socket
E8731KPB	PANIC BUTTON with key reset
E8731VC	Volume control, 5W, 8OHM
E8732HDUSB	HDMI™ / HDMI® ENABLED + USB SOCKET
E8731SC	Speaker connection 1 pair
E8730X	1G BLANK PLATE
E8730TX	2G BLANK PLATE

SPECIFICATIONS

Mounting center :60.3mm

⚠ WARNING

ELECTRIC SHOCK, EXPLOSION OR ARCING HAZARD

- This product must be installed by qualified electricians.
- This product should only be used in accordance with this specification and under the appropriate circumstance, Please check your local wiring regulations before installation.
- The power must be disconnected before installation, maintenance or replacement.
- Make sure the product is installed completely and safely before turning on the power.
- Keep a safe distance between low voltage cables and high voltage cables.

Failure to follow this instruction may result in death or serious injury.

CAUTION

RISK OF DAMAGE DEVICE

- Please install with standard wall box to ensure the product to be used properly
- Please keep the front cover safe in order to prevent damages before and during installation.
- Ensure the power supply is turned off when cleaning the product. Use a piece of soft and dry cloth to wipe off the dirt and contamination on the surface. Do NOT use corrosive chemicals.
- Shield / mask the product before renovation to avoid contamination and degradation.
- Indoor use only
- Avoid any foreign objects ingress into USB charger such as small metal wires, paper clips, liquids, etc.

Failure to follow this instruction may result in damage to the device.

WIRING DIAGRAMS

Panic Button

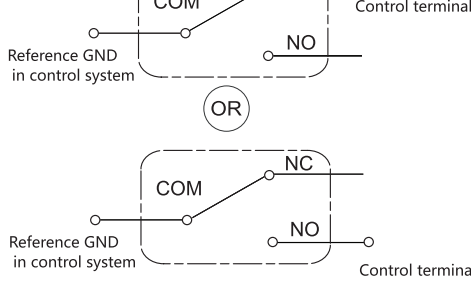

Tel outlet wiring instructions

1. Cable of different colour must be fixed corresponding.
2. Fix the cable to the position 4, 3, 5, 2 according to the right diagram.

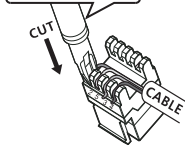

Data outlet wiring instructions

MODULAR WIRING CONFIGURATION		
COLOR CODE	T568B	T568A
White-Blue	5	5
Blue	4	4
White-Orange	1	3
Orange	2	6
White-Green	3	1
Green	6	2
White-Brown	7	7
Brown	8	8

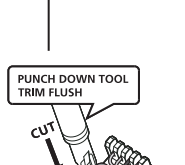

Cable in the range of 26AWG to 22AWG is suitable for Tel outlet and Data outlet.

TV outlet wiring instructions

Cut the sheath of coaxial cable according to the following diagram. And then insert the cable to the product.

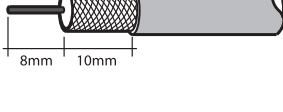

Volume control

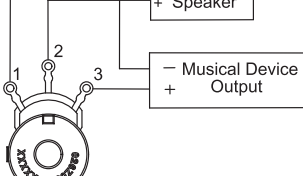

Speaker Connection

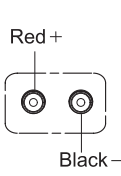

HDMI™ / HDMI® USB

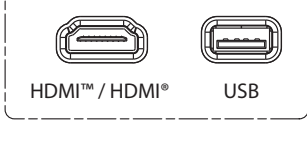

MOUNTING INSTRUCTION

- 1 Remove the surround.
- 2 Insert the wires into the terminals and tighten the terminal screws.
- 3 Fix the grid plate onto the wall box with mounting screw.
- 4 Reattach the surround.

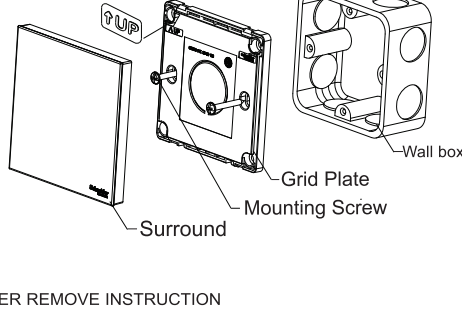

***COVER REMOVE INSTRUCTION**

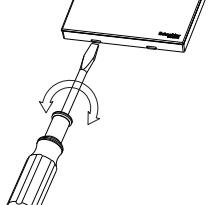

* The terms HDMI, HDMI High-Definition Multimedia Interface, HDMI Trade dress and the HDMI Logos are trademarks or registered trademarks of HDMI Licensing Administrator, Inc.

*The registered trademark ® notation is only applicable to country where the trademark is registered. For an up to date downloadable list of countries and geographical areas where the HDMI Adopted Trademarks are registered, please visit : <https://hdmi.org/docs/trademarks>.

Thank you for choosing **Schneider Electric™ AvatarOn C** series products. To ensure proper application of our product, Please read through the following information before installation and use.

This application guide applies to the following products.

(Notes: suffix _WE/WG/DG.....G*etc. mean the colors and sales areas)

Cat. No.	Description
E8731TB	25A 250V 1 Gang CONNECTION UNIT
E87554	45A 250V 1 Gang CONNECTION UNIT
E8730FSG	13A 250V 1 Gang FUSED CONNECTION UNIT
E8731DFSGN	13A 250V 1G Double Pole switched Fused Connection Unit with Neon

SPECIFICATIONS

Rated Voltage	:250V~
Mounting center	:60.3mm
Rated Current	:Refer to product marking

⚠ WARNING

ELECTRIC SHOCK, EXPLOSION OR ARCING HAZARD

- This product must be installed by qualified electricians.
- This product should only be used in accordance with this specification and under the appropriate circumstance, Please check your local wiring regulations before installation.
- The power must be disconnected before installation, maintenance or replacement.
- Make sure the product is installed completely and safely before turning on the power.
- Avoid any foreign objects ingress into USB charger such as small metal wires, paper clips, liquids, etc.

Failure to follow this instruction may result in death or serious injury.

CAUTION

RISK OF DAMAGE DEVICE

- Please install with standard wall box to ensure the product to be used properly
- Please keep the front cover safe in order to prevent damages before and during installation.
- Ensure the power supply is turned off when cleaning the product. Use a piece of soft and dry cloth to wipe off the dirt and contamination on the surface. Do NOT use corrosive chemicals.
- Shield / mask the product before renovation to avoid contamination and degradation.
- Indoor use only.

Failure to follow this instruction may result in damage to the device.

WIRING DIAGRAMS

E8731TB

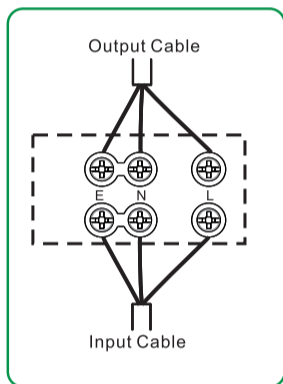

E87554

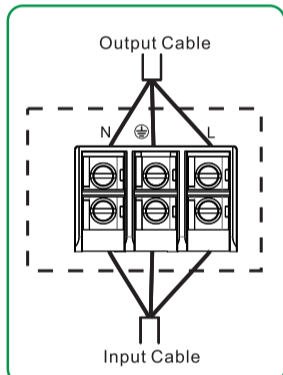

E8730FSG

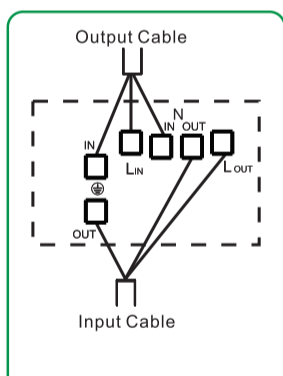

E8731DFSGN

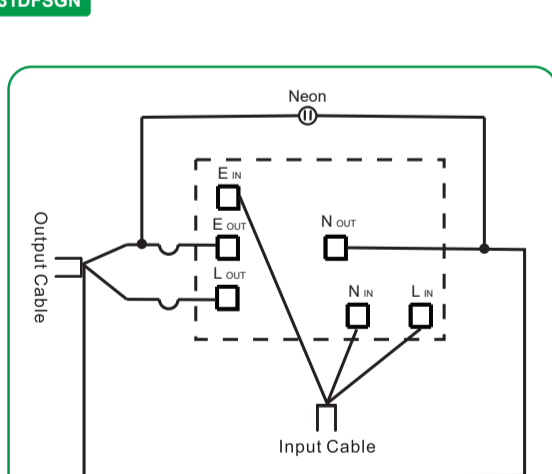

MOUNTING INSTRUCTION

- 1 Remove the surround.
- 2 Insert the wires into the terminals and tighten the terminal screws.
- 3 Fix the grid plate onto the wall box with mounting screw.
- 4 Reattach the surround.

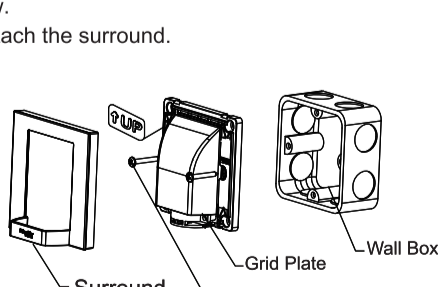

*COVER REMOVE INSTRUCTION

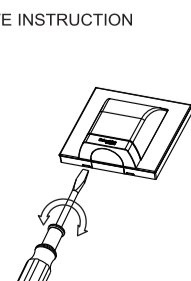

NNZ9565905 V00

Thank you for choosing **Schneider Electric™ AvatarOn C** series products. To ensure proper application of our product, Please read through the following information before installation and use.

This application guide applies to the following products.
(Notes: suffix_ WE/WG/DG.....G*etc. mean the colors and sales areas)

Cat. No.	Description
E8731_26	2G multi-surround
E8731_36	3G multi-surround
E8731_46	4G multi-surround
E8731_56	5G multi-surround

SPECIFICATIONS

The center between two modular :86.3mm

⚠ WARNING

ELECTRIC SHOCK, EXPLOSION OR ARCING HAZARD

- This product must be installed by qualified electricians.
- This product should only be used in accordance with this specification and under the appropriate circumstance, Please check your local wiring regulations before installation.
- The power must be disconnected before installation, maintenance or replacement.
- Make sure the product is installed completely and safely before turning on the power.
- Keep a safe distance between low voltage cables and high voltage cables.

Failure to follow this instruction may result in death or serious injury.

CAUTION

RISK OF DAMAGE DEVICE

- Please install with standard wall box to ensure the product to be used properly
- Please keep the front cover safe in order to prevent damages before and during installation.
- Ensure the power supply is turned off when cleaning the product. Use a piece of soft and dry cloth to wipe off the dirt and contamination on the surface. Do NOT use corrosive chemicals.
- Shield / mask the product before renovation to avoid contamination and degradation.
- Indoor use only
- Avoid any foreign objects ingress into USB charger such as small metal wires, paper clips, liquids, etc.
- When making a product combination, the requirements of a single product must be met.

Failure to follow this instruction may result in damage to the device.

MOUNTING INSTRUCTION

1 Fix one product into Multi-gang

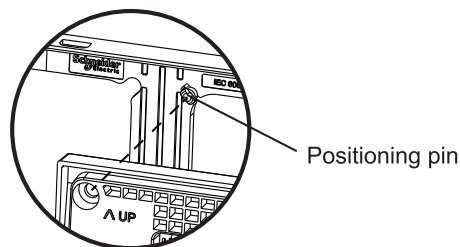
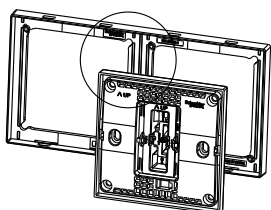

2 Install the product with Multi-gang together into wallbox

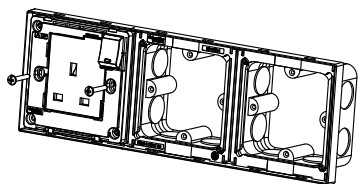

3 Install other product into wallbox

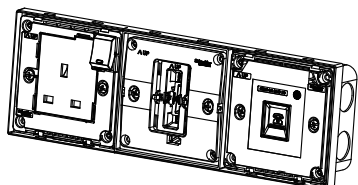

4 Install cover into product

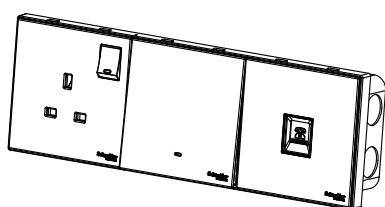

Thank you for choosing **Schneider Electric™ AvatarOn C** series products. To ensure proper application of our product, Please read through the following information before installation and use.

This application guide applies to the following products.
(Notes: suffix_ WE/WG/DG.....G*etc. mean the colors and sales areas)

Cat. No.	Description
E8731EKTID	16A electronic KEY CARD TIME DELAY SW

SPECIFICATIONS

Rated Voltage	:220-240V~,50/60Hz
Mounting center	:60.3mm
Rated Current	:16A
RFID	:13.56MHz(recommendation MIFARE Classic card)

NNZ9565907 V00

⚠ WARNING

ELECTRIC SHOCK, EXPLOSION OR ARCING HAZARD

- This product must be installed by qualified electricians.
- This product should only be used in accordance with this specification and under the appropriate circumstance, Please check your local wiring regulations before installation.
- The power must be disconnected before installation, maintenance or replacement.
- Make sure the product is installed completely and safely before turning on the power.
- Avoid any foreign objects ingress into USB charger such as small metal wires, paper clips, liquids, etc.

Failure to follow this instruction may result in death or serious injury.

CAUTION

RISK OF DAMAGE DEVICE

- Please install with standard wall box to ensure the product to be used properly
- Please keep the front cover safe in order to prevent damages before and during installation.
- Ensure the power supply is turned off when cleaning the product. Use a piece of soft and dry cloth to wipe off the dirt and contamination on the surface. Do NOT use corrosive chemicals.
- Shield / mask the product before renovation to avoid contamination and degradation.
- Indoor use only.

Failure to follow this instruction may result in damage to the device.

WIRING DIAGRAMS

Generally

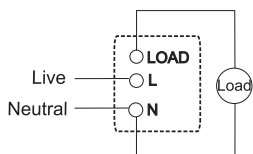

Application for connect contactor

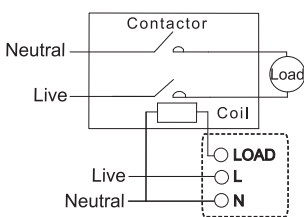

MOUNTING INSTRUCTION

- 1 Remove the surround.
- 2 Insert the wires into the terminals and tighten the terminal screws.
- 3 Fix the grid plate onto the wall box with mounting screw.
- 4 Reattach the surround.

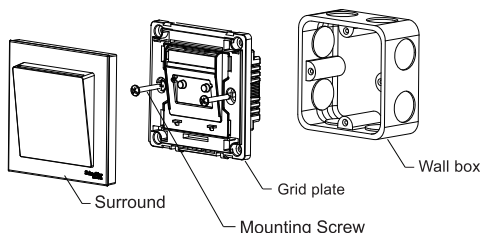

***COVER REMOVE INSTRUCTION**

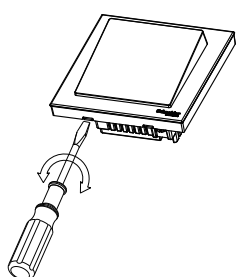

Thank you for choosing **Schneider Electric™ AvatarOn C** series products. To ensure proper application of our product, Please read through the following information before installation and use.

This application guide applies to the following products.

(Notes: suffix_WE/WG/DG.....G*etc. mean the colors and sales areas)

Cat. No.	Description
E87T727V	115V/240V UNIVERSAL SHAVER

SPECIFICATIONS

Rated Voltage	:240V~ 50/60Hz
Output Voltage	:115/240V~
Rated Power	:20VA
Mounting center	:120.6mm

NNZ9565908_V00

⚠ WARNING

ELECTRIC SHOCK, EXPLOSION OR ARCING HAZARD

- This product must be installed by qualified electricians.
- This product should only be used in accordance with this specification and under the appropriate circumstance, Please check your local wiring regulations before installation.
- The power must be disconnected before installation, maintenance or replacement.
- Make sure the product is installed completely and safely before turning on the power.
- Avoid any foreign objects ingress into USB charger such as small metal wires, paper clips, liquids, etc.

Failure to follow this instruction may result in death or serious injury.

CAUTION

RISK OF DAMAGE DEVICE

- Please install with standard wall box to ensure the product to be used properly
- Please keep the front cover safe in order to prevent damages before and during installation.
- Ensure the power supply is turned off when cleaning the product. Use a piece of soft and dry cloth to wipe off the dirt and contamination on the surface. Do NOT use corrosive chemicals.
- Shield / mask the product before renovation to avoid contamination and degradation.
- Indoor use only.

Failure to follow this instruction may result in damage to the device.

WIRING DIAGRAMS

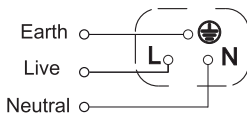

MOUNTING INSTRUCTION

- 1 Remove the surround.
- 2 Insert the wires into the terminals and tighten the terminal screws.
- 3 Fix the grid plate onto the wall box with mounting screw.
- 4 Reattach the surround.

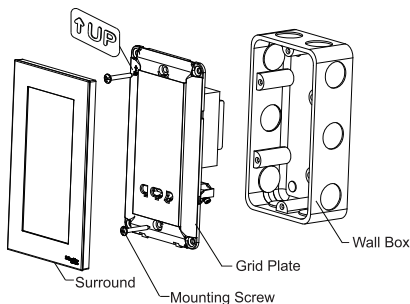

*COVER REMOVE INSTRUCTION

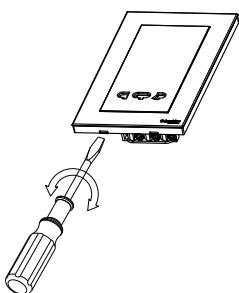

Thank you for choosing **Schneider Electric™ AvatarOn C** series products. To ensure proper application of our product, Please read through the following information before installation and use.

This application guide applies to the following products.

(Notes: suffix _WE/WG/DG.....G*etc. mean the colors and sales areas)

Cat. No.	Description
E8731BPDM	250V 10A 1G BELL SW W ILL DND,PCU, SYM
E8732DMS	16AX 2 Gang SW W/ NE W/ C & P SYM
E8732CF	10A MECHANICAL CURTAIN switch with fluorescent locator

SPECIFICATIONS

Rated Voltage	:250V~
Mounting center	:60.3mm
Rated Current	:Refer to product marking
Self ballasted lamp(SBL) Load	:200W only for E8732DMS

⚠ WARNING

ELECTRIC SHOCK, EXPLOSION OR ARCING HAZARD

- This product must be installed by qualified electricians.
- This product should only be used in accordance with this specification and under the appropriate circumstance, Please check your local wiring regulations before installation.
- The power must be disconnected before installation, maintenance or replacement.
- Make sure the product is installed completely and safely before turning on the power.
- Avoid any foreign objects ingress into USB charger such as small metal wires, paper clips, liquids, etc.

Failure to follow this instruction may result in death or serious injury.

CAUTION

RISK OF DAMAGE DEVICE

- Please install with standard wall box to ensure the product to be used properly
- Please keep the front cover safe in order to prevent damages before and during installation.
- Ensure the power supply is turned off when cleaning the product. Use a piece of soft and dry cloth to wipe off the dirt and contamination on the surface. Do NOT use corrosive chemicals.
- Shield / mask the product before renovation to avoid contamination and degradation.
- Indoor use only.

Failure to follow this instruction may result in damage to the device.

WIRING DIAGRAMS

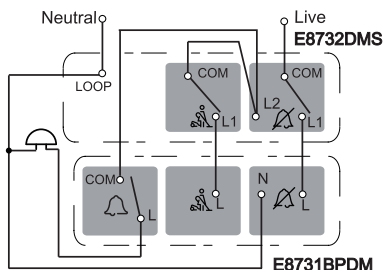

E8732CF

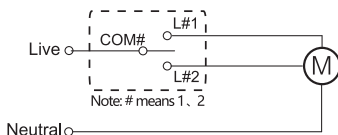

MOUNTING INSTRUCTION

- 1 Remove the surround.
- 2 Insert the wires into the terminals and tighten the terminal screws.
- 3 Fix the grid plate onto the wall box with mounting screw.
- 4 Reattach the surround.

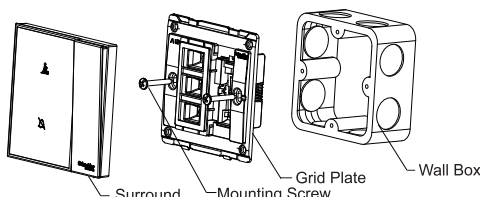

***COVER REMOVE INSTRUCTION**

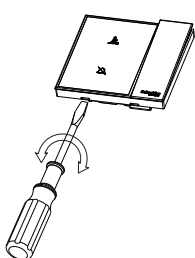

Thank you for choosing **Schneider Electric™ AvatarOn C** series products. To ensure proper application of our product, Please read through the following information before installation and use.

This application guide applies to the following products.
(Notes: suffix_ WE/WG/DG.....G*etc. mean the colors and sales areas)

Cat. No.	Description
E8732RD250U	UNI DIMMER WITH SW

SPECIFICATIONS

Rated Voltage :220-240V~ 50Hz
Mounting center :60.3mm

Compatible load		
	LED Dimmable LED lighting	3-150W
	Electronic step-down converter for extra low-voltage incandescent lamps	3-250W

NINZ9565910 V00

⚠ WARNING

ELECTRIC SHOCK, EXPLOSION OR ARCING HAZARD

- This product must be installed by qualified electricians.
- This product should only be used in accordance with this specification and under the appropriate circumstance, Please check your local wiring regulations before installation.
- The power must be disconnected before installation, maintenance or replacement.
- Make sure the product is installed completely and safely before turning on the power.
- Avoid any foreign objects ingress into USB charger such as small metal wires, paper clips, liquids, etc.

Failure to follow this instruction may result in death or serious injury.

CAUTION

RISK OF DAMAGE DEVICE

- Please install with standard wall box to ensure the product to be used properly
- Please keep the front cover safe in order to prevent damages before and during installation.
- Ensure the power supply is turned off when cleaning the product. Use a piece of soft and dry cloth to wipe off the dirt and contamination on the surface. Do NOT use corrosive chemicals.
- Shield / mask the product before renovation to avoid contamination and degradation.
- Indoor use only.

Failure to follow this instruction may result in damage to the device.

WIRING DIAGRAMS

One Way Operation

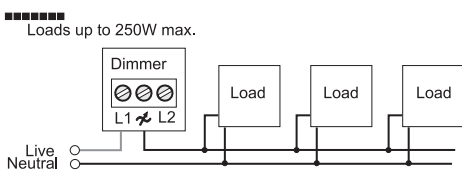

Operation with 2way switch

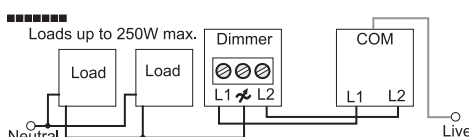

- Note:
1. Dimmer must always be connected to LIVE.
 2. Two or more dimmers MUST NOT be connected in parallel or series to control the same load from two different locations.

Normal operation

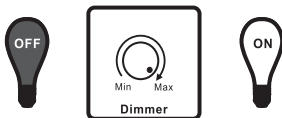

Lamp ON/OFF shift: push knob
Dimming up: clockwise
Dimming down: anti-clockwise

MOUNTING INSTRUCTION

- 1 Remove the surround.
- 2 Insert the wires into the terminals and tighten the terminal screws.
- 3 Fix the grid plate onto the wall box with mounting screw.
- 4 Reattach the surround.

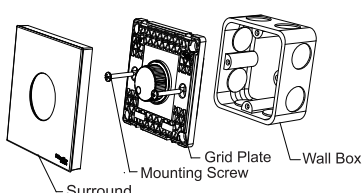

***COVER REMOVE INSTRUCTION**

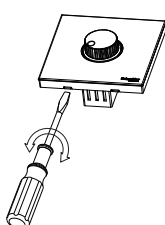

Thank you for choosing **Schneider Electric™ AvatarOn C** series products. To ensure proper application of our product, Please read through the following information before installation and use.

This application guide applies to the following products.

(Notes: suffix _WE/WG/DG.....G*etc. mean the colors and sales areas)

Cat. No.	Description
E8732V400F	FAN CONTROLLER WITH SWITCH

SPECIFICATIONS

Rated Voltage	:220-240V~ 50Hz
Mounting center	:60.3mm
Compatible load	:Exhaust fans/Ceiling fans (40-500W) (M)

⚠ WARNING

ELECTRIC SHOCK, EXPLOSION OR ARCING HAZARD

- This product must be installed by qualified electricians.
- This product should only be used in accordance with this specification and under the appropriate circumstance, Please check your local wiring regulations before installation.
- The power must be disconnected before installation, maintenance or replacement.
- Make sure the product is installed completely and safely before turning on the power.
- Avoid any foreign objects ingress into USB charger such as small metal wires, paper clips, liquids, etc.

Failure to follow this instruction may result in death or serious injury.

CAUTION

RISK OF DAMAGE DEVICE

- Please install with standard wall box to ensure the product to be used properly
- Please keep the front cover safe in order to prevent damages before and during installation.
- Ensure the power supply is turned off when cleaning the product. Use a piece of soft and dry cloth to wipe off the dirt and contamination on the surface. Do NOT use corrosive chemicals.
- Shield / mask the product before renovation to avoid contamination and degradation.
- Indoor use only.

Failure to follow this instruction may result in damage to the device.

WIRING DIAGRAMS

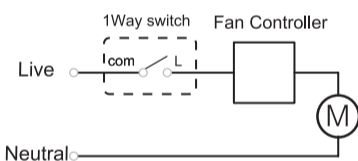

MOUNTING INSTRUCTION

- 1 Remove the surround.
- 2 Insert the wires into the terminals and tighten the terminal screws.
- 3 Fix the grid plate onto the wall box with mounting screw.
- 4 Reattach the surround.

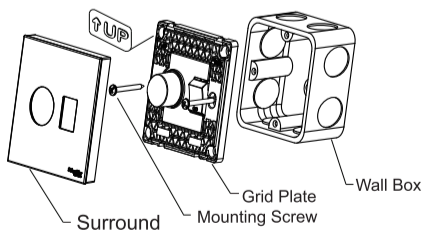

*To dismantle the product, please remove the surround with suitable screw-driver.

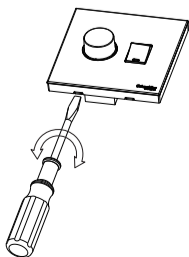

نشكركم على اختيار شنايدر إلكترونيك لشراء سلسلة منتجات أفاتار-اون سي. لضمان استخدام المنتج الاستخدام الصحيح، يُرجى قراءة المعلومات التالية قبل التركيب والاستخدام. ينطبق دليل الاستخدام هذا على المنتجات التالية. (ملاحظة: اللاحقة *WE/WG/DG G_ وتوضح الألوان ومناطق المبيعات).

الوصف	رقم الكتالوج: لا
مقبس تحويل بمنفذ واحد بقدرة تحمل تيار كهربائي 13 أمبير 250 فولت	E8715
مقبس تحويل بمنفذ واحد بقدرة تحمل تيار كهربائي 13 أمبير 250 فولت وLED	E8715N
مقبس تحويل بمنفذين بقدرة تحمل تيار كهربائي 13 أمبير 250 فولت	E87T25
مقبس تحويل بمنفذين بقدرة تحمل تيار كهربائي 13 أمبير 250 فولت وLED	E87T25N
مقبس تحويل 3 دبوس مستدير بمنفذ واحد بقدرة تحمل تيار كهربائي 13 أمبير 250 فولت	E8715_15
مقبس بمنفذ واحد بقدرة تحمل تيار كهربائي 13 أمبير 250 فولت	E87426
مقبس 3 دبوس مستدير بمنفذ واحد بقدرة تحمل تيار كهربائي 13 أمبير 250 فولت	E87426_15
مقبس بمنفذ مزدوج بقدرة تحمل تيار كهربائي 13 أمبير 250 فولت	E87T426

المواصفات	القوة الكهربائية
250 فولت تقريباً	قاعدة التركيب:
60.3 ملم	التيار المقنن:
راجع علامة المنتج	

تحذير

الصدمة الكهربائية أو الانفجار أو التقوس الكهربائي الكهربيائية

- يجب أن يركب المنتج خبراء أعمال الكهرباء.
- يجب استخدام هذا المنتج فقط وفقاً لهذه المواصفات وفي ظل الظروف الملائمة، يُرجى التحقق من لوائح الأسلاك المحلية قبل التركيب.
- يجب فصل التيار الكهربائي قبل التركيب أو الصيانة أو الاستبدال.
- تأكد من تركيب المنتج بالكامل وبأمان قبل تشغيل الطاقة.
- تجنب إدخال أي أجسام غريبة في شاحن USB مثل الأسلاك المعدنية الصغيرة ودبابيس الورق والسوائل وما إلى ذلك.

قد يتسبب عدم اتباع هذه التعليمات إلى الوفاة أو الإصابة الخطيرة.

تحذير

خطر تلف الجهاز

- يُرجى تركيب المنتج بصندوق الحائط القياسي للتأكد من تشغيله بصورة ملائمة.
- يُرجى الحفاظ على سلامة الغطاء الخارجي لتجنب الأضرار قبل التركيب وفي أثناءه.
- تأكد من إيقاف تشغيل مصدر الطاقة عند تنظيف المنتج. استخدم قطعة قماش ناعمة وجافة لإزالة ما على الأسطح من أوساخ وتلوث. لا تستخدم المواد الكيميائية المسببة للتآكل.
- قم بتغطية المنتج أو حفظه قبل ترميمه لتجنب تلوثه وتآكله.
- للاستخدام الداخلي فقط.

قد يتسبب عدم اتباع هذه التعليمات إلى تلف الجهاز.

مخطط بياني للأسلاك

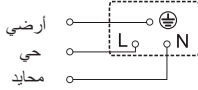

تعليمات التركيب

- 1 أزل الجزء الخارجي.
- 2 أدخل الأسلاك في الأجهزة وأحكم ربط المسامير المولوب.
- 3 قم بتثبيت اللوحة الشبكية على صندوق الحائط مع مسمار تركيب.
- 4 أعد تركيب الجزء الخارجي.

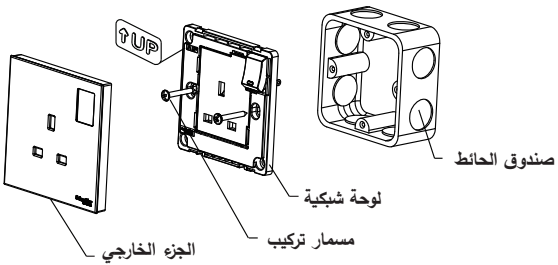

تعليمات إزالة الغطاء

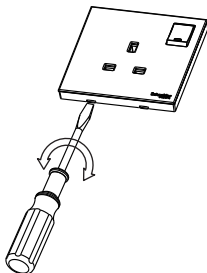

نشكركم على اختيار شوايدر إلكترونيك لشراء سلسلة منتجات أفاتار-اون سي. لضمان استخدام المنتج الاستخدام الصحيح، يُرجى قراءة المعلومات التالية قبل التركيب والاستخدام.
ينطبق دليل الاستخدام هذا على المنتجات التالية.
(ملاحظة: اللاحقة *_WE/WG/DG G_ وغيرها، توضح الألوان ومناطق المبيعات).

الوصف	رقم الكatalog: لا
21 وات من النمط "A" و" C"، خاصة الشحن السريع، شاحن بمنفذ USB مقبس 13 أمبير بمنفذ واحد مع منفذين USB 2.1 أمبير	E8732ACQUSB
مقيس 13 أمبير بمنفذ واحد مع منفذين USB 2.1 أمبير	E8715USB
مقيس 13 أمبير بمنفذ واحد مع منفذين USB 2.1 أمبير	E8715USBR
مقيس 13 أمبير مع منفذ USB 21 فولت من النمط "A+C" بخاصية الشحن السريع	E87426ACUSB
مقيس 13 أمبير بمنفذ واحد مع منفذ USB 21 فولت من النمط "A+C" بخاصية الشحن السريع	E8715DACUSB
مقيس 13 أمبير بمنفذ واحد مع منفذ USB 21 فولت من النمط "A+C" بخاصية الشحن السريع	E8715DACUSBR
مقيس 13 أمبير بمنفذين مع منفذ USB 2.1 من النمط "A+C"	E87T25ACUSB

المواصفات

رقم الفئة / المواصفات	E8732ACQUSB	E8715USB / E8715USBR	E87426ACUSB / E8715DACUSB / E8715DACUSBR	E87T25ACUSB
الدخل المحدد لمنفذ USB	100-240 فولت~ 50/60 هيرتز 0.6 أمبير كحد أقصى	100-250 فولت~ 50/60 هيرتز 0.45 أمبير كحد أقصى	220-250 فولت~ 50/60 هيرتز 0.45 أمبير كحد أقصى	100-250 فولت~ 50/60 هيرتز 0.6 أمبير كحد أقصى
خرج منفذ USB:	النمط C: 5 فولت ~ 3 أمبير، 9 فولت ~ 2 أمبير، 12 فولت ~ 1.5 أمبير، النمط A: 5 فولت ~ 3 أمبير، 9 فولت ~ 2 أمبير، 12 فولت ~ 1.5 أمبير النمط A+C: 5 فولت ~ 4.2 أمبير (2.4 أمبير كحد أقصى لكل منفذ)	5 فولت 2.1 أمبير كحد أقصى لكل منفذ	النمط C: 5 فولت ~ 3 أمبير، 9 فولت ~ 2.33 أمبير، 12 فولت ~ 1.75 أمبير، 15 فولت ~ 1.4 أمبير النمط A: 5 فولت ~ 3 أمبير، 9 فولت ~ 2 أمبير، 12 فولت ~ 1.5 أمبير النمط A+C: 5 فولت ~ 3.2 أمبير (2.4 أمبير كحد أقصى لكل منفذ)	النمط C: 5 فولت ~ 3 أمبير، 9 فولت ~ 2.3 أمبير، 12 فولت ~ 1.8 أمبير، النمط A: 5 فولت ~ 3 أمبير، 9 فولت ~ 2.3 أمبير، 12 فولت ~ 1.8 أمبير النمط A+C: 5 فولت ~ 3.2 أمبير (2.4 أمبير كحد أقصى لكل منفذ)
حماية منفذ USB	فرط السخونة، تيار الخرج الزائد، جهد الخرج الزائد، قصر دائرة الخرج			
جهد/ تيار المقيس	13 أمبير؛ ~ 250 فولت			
قاعدة التركيب	60.3 ملم		120.6 ملم	
درجة حرارة التشغيل	40-0 درجة مئوية		35-0 درجة مئوية	

تحذير

الصدمة الكهربائية أو الانفجار أو التفوس الكهربائي الكهربائي

- يجب أن يركب المنتج خبراء أعمال الكهرباء.
 - يجب استخدام هذا المنتج فقط وفقاً لهذه المواصفات وفي ظل الظروف الملائمة، يُرجى التحقق من لوائح الأسلاك المحلية قبل التركيب.
 - يجب فصل التيار الكهربائي قبل التركيب أو الصيانة أو الاستبدال.
 - تأكد من تركيب المنتج بالكامل وبأمان قبل تشغيل الطاقة.
 - لا يحتوي هذا الجهاز المتصل، بصورة دائمة، على جهاز داخلي غير متصل، لذا؛ يجب توفير جهاز منفصل يسهل الوصول إليه خارجياً.
 - يجب تركيب المنتج على سطح خرساني أو سطح من مواد غير قابلة للاشتعال.
 - تجنب إدخال أي أجسام غريبة في شاحن USB مثل الأسلاك المعدنية الصغيرة ودبابيس الورق والسوائل وما إلى ذلك.
- قد يتسبب عدم اتباع هذه التعليمات إلى الوفاة أو الإصابة الخطيرة.

تحذير

خطر تلف الجهاز

- هذا المنتج قابل للاستخدام فقط على ارتفاعات أقل من 2000 متر.
 - يرجى تثبيت هذا المنتج في صندوق حائط مطابق للمواصفات البريطانية مع قطبين بعمق 47 مم.
 - يرجى تغطية المنتج أو حفظه قبل ترميمه لتجنب تلفه أو تلوثه.
 - يُرجى الحفاظ على سلامة الغطاء الخارجي لتجنب الأضرار قبل التركيب وفي أثناءه.
 - تأكد من إيقاف تشغيل مصدر الطاقة عند تنظيف المنتج. استخدم قطعة قماش ناعمة وجافة لإزالة ما على الأسطح من أوساخ وتلوث. لا تستخدم المواد الكيميائية المسببة للتآكل.
 - قبل شحن المنتج، يرجى التأكد من توافق بطارية جهازك مع مواصفات شحن البطارية. لا تستخدم محولات متعددة المقاييس من أجل شحن عدة أجهزة في وقت واحد لتجنب تلف الأجهزة.
 - يرجى التأكد من أن الجهد في المنزل يجب ألا يكون أعلى من الجهد المحدد أثناء التثبيت، وإلا فقد تتلف وحدة منفذ USB
 - يعتمد وقت الشحن على بروتوكول الشحن المدعوم والطاقة وسعة البطارية وجودة خط الشحن وعوامل أخرى تُحدّد وفقاً للجهاز المشحون نفسه.
 - قد يؤدي توصيل بعض كابلات الشحن المدمجة مع مرفق الشحن إلى تشغيل وضع الشحن العادي.
 - سيُشعر المستخدم ببعض الحرارة على سطح المنتج أثناء الشحن
 - للاستخدام الداخلي فقط.
- قد يتسبب عدم اتباع هذه التعليمات إلى تلف الجهاز.

مخطط بياني للأسلاك

E8715USB & E8715USBR & E87426ACUSB & E8715DACUSB & E8715DACUSBR & E87T25ACUSB

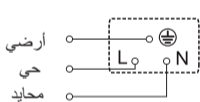

E8732ACQUSB

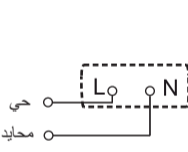

تعليمات التركيب

- 1 أزل الجزء الخارجي.
- 2 أدخل الأسلاك في الأجهزة وأحكام ربط المسامير المولوب.
- 3 قم بتثبيت اللوحة الشبكية على صندوق الحائط مع مسامير تركيب.
- 4 أعد تركيب الجزء الخارجي.

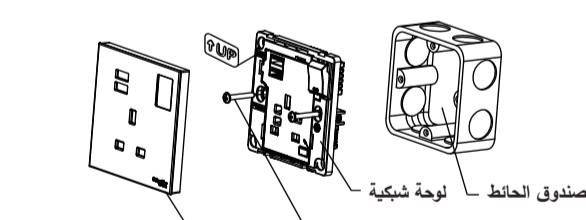

E8715USBR

* افتح الغطاء لإجراء اختبار مقاومة العزل

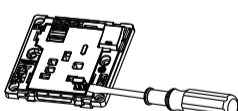

E8715DACUSBR

قم بإزالة الغطاء لإيقاف تشغيل المفتاح الصغير لاختبار مقاومة العزل.

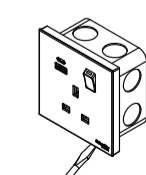

مقيس بمنفذين مع منفذ USB

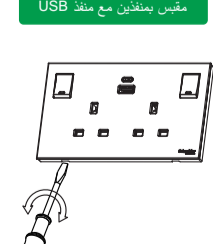

مقيس بمنفذ واحد مع منفذ USB من النمط L

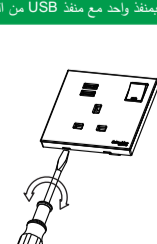

ملاحظة: يجب أن يكون بوسع كل طرف موصل قبول كابل صلب أو مجدول على النحو التالي

سعة التوصيلات الملكية الطرفية	(أ) 1~4X1.5م ² (ب) 1~2X2.5م ² (ج) 1X4م ²
-------------------------------	------------------------------------------------------------------------------