

Datasheet

RS PRO Bearing Adapter Sleeve

Stock No: 196-4134



Technical Specifications:

Inside Diameter	40
Locknut Diameter	65
Total Length	50

Features & Benefits:

- Most commonly used method of locating bearings with a tapered bore onto a cylindrical shaft
- Easy to install
- Require no additional location on the shaft required
- Fitted with a slit that allows for easy mounting to increase flexibility
- Different Options available to suit many bearing variations
- Range of sizes available to accommodate oil injection

Dimensional line drawings

Dimensions

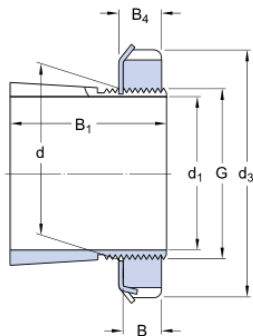

d ₁	40	mm
d	45	mm
d ₃	65	mm
B ₁	50	mm
B	10	mm
B ₄	11	mm
G	M 45x1.5	

Mass

Mass adapter sleeve assembly

0.27

kg

Quality Standards

ISO – 2982-1

