

Datasheet

9 Way Straight Through Hole Mount

RS Stock number [528-3531](#)

Dimensions: (mm)

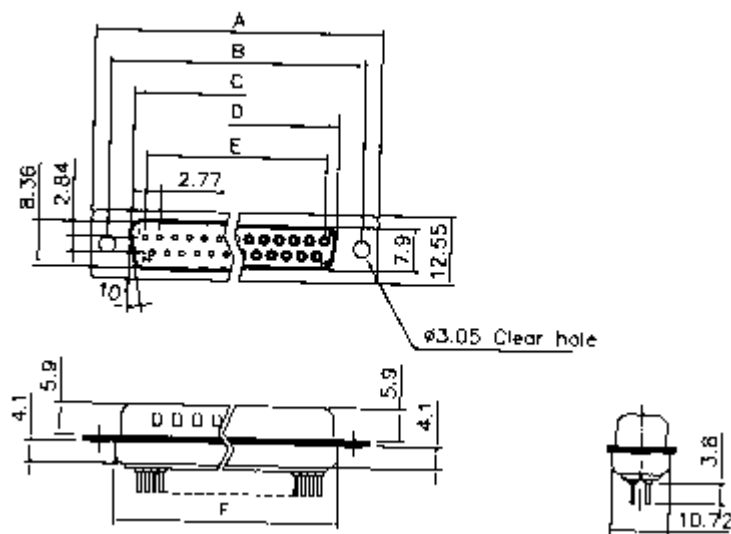

Positions	A	B	C	D	E	F
9	30.81	24.99	16.92	16.33	11.08	19.20
15	39.14	33.32	25.50	24.66	19.39	27.70
25	53.04	47.04	38.96	38.38	33.24	41.10
37	69.32	63.50	55.42	54.84	49.86	57.30

Specifications

- Insulator Glass- Filled Thermoplastic PBT UL94-0 rated
- Contact: Turned Copper Alloy
- Shell: Steel 100µ" Tin over 50µ" min Nickel
- Contact Resistance: 10milliohms Max at 1 Amp DC
- Insulation Resistance: 100 milliohms at 500 VDC
- Dielectric Withstanding Voltage: 1000 VAC/ RMS 60Hz for 1 min
- Current Rating: 5 AMP all contacts simultaneously
- Voltage Rating: 250 VAC/ RMS 60Hz
- Temperature Range: -55°C to 125°C
- Contact Type: Machine Pin
- Contact Plating: Gold over Nickel