

# Datasheet

## Spacer For Use With Any Enclosure

RS Stock number 603-536

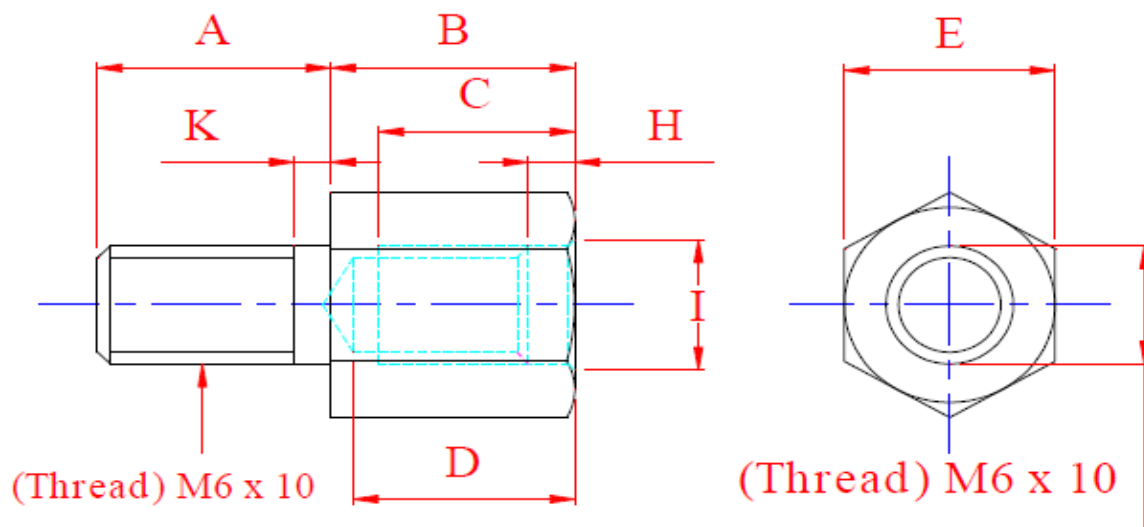

Stock No.	Dimensions (in mm)			
	A	B	C	D (Max.)
603-485	7-5	10	6.0 +0/ -1.0	8
603-491	7-5	12	8.0 +0/ -1.0	10
603-508	10	14	10.0 +0/ -1.0	12
603-514	10	16	10.0 +0/ -1.0	12
603-520	10	18	10.0 +0/ -1.0	12
603-536	20	20	16.0 +0/ -1.0	18
E : 10 ; H : 2 ; I : (Dia) 6.1 ; K : (Max.) 1.7				

Material : Cold Rolled Steel.

Finish : Zinc Plated.