

FEATURES

- All fluids usable in aggressive environment
- Mechanical resistance
- Silicon free

RS PRO Pneumatic Quick Connect Couplings

RS Stock No.: 2312685



RS PROfessionally Approved Products bring to you professional quality parts across all product categories. Our product range has been tested by engineers and provides a comparable quality to the leading brands without paying a premium price.

Product Description

The RS PRO male socket inox short 3/8 works in 0 to 16 bar pressure range. It mainly used in compressed air & tools, pneumatic & fluid technology, food & beverages applications. It provides high performance for multiple fluids in a wide range of temperature and pressure. Operating temperature range is from - 15 °C to + 200 °C. RoHS and REACH compliant.

General Specifications

Material	Steel
Applications	Lubrication System, Cooling System, Pneumatic Machinery Equipment

Mechanical Specifications

Connection Type	Tube
Tube Connection Size	7.5
Coupling Gender	Male
Threaded Connection	3/8 in Male
Thread Size	3/8in
Hose Barb Connection	4mm
Wrench Size	21
Length	50.5mm

Similar Products

Parameters	2312521	2312522
Brand	RS PRO	RS PRO
Connection Type	Threaded, Tube	Threaded, Tube
Tube Connection Size	9mm	10mm
Coupling Gender	Male	Male
Threaded Connection	3/8 in Male	1/2 in Male
Thread Size	3/8in	1/2in
Hose Barb Connection	30.5mm	25Hex
Wrench Size	20Hex	54mm

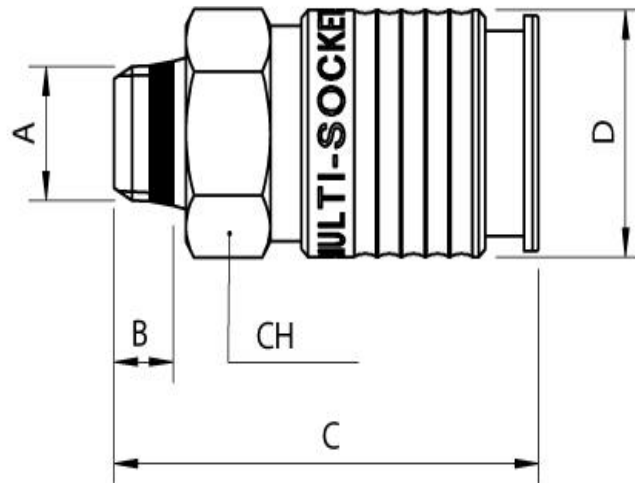

A	B	C	D	CH	Pack.
3/8	7.5	50.5	24	21	2