



ENGLISH

## Datasheet

# RS PRO 5A Crimp Contacts for RS PRO Heavy Duty Range



The RS PRO Heavy-Duty Connector series is a full range of heavy-duty inserts, housings, crimps and accessories. Crimps are available in 5A, 10A, 16A, 40A, 70A, 100A and 200A options which cover all but the most specialised of situations. All the crimp options are available with Silver plating however the lower current crimps are also offered with Gold plating for better conductivity at lower voltages and currents. The RS PRO Heavy-Duty connectors have been created for applications that are subjected to harsh environments or where high vibration can cause standard connectors to fail. This makes them ideal for food & beverage manufacturing, packaging machines, conveyor belt systems, railway, oil & gas processing and other industrial automation. The entire range of connectors are RoHS compliant and as with all RS PRO products, offer exceptional value for money.

## Features & Benefits:

- **Gold or Silver Plated**
- **Male and Female Crimps sold Separately**
- **Fits RS PRO Heavy Duty Inserts**
  - **Modular RS-HM Inserts**

## Dimensional drawing and sizes

RS Stock Code Silver-Plated	RS Stock Code Gold-Plated	Gender	Current	Wire Diameter		C	Stripping Length
				mm <sup>2</sup>	AWG		
208-4702	208-4694	Female	5A	0.09-0.25	28-24	0.64	5
208-4703	208-4695	Female	5A	0.25-0.33	26-22	0.90	5
208-4704	208-4696	Female	5A	0.33-0.52	22-20	1.12	5
208-4705	208-4697	Female	5A	0.52-0.82	22-18	1.35	5

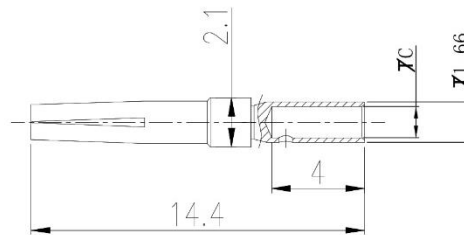
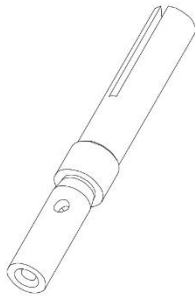

RS Stock Code Silver-Plated	RS Stock Code Gold-Plated	Gender	Current	Wire Diameter		C	Stripping Length
				mm <sup>2</sup>	AWG		
208-4706	208-4698	Male	5A	0.09-0.25	28-24	0.64	5
208-4708	208-4699	Male	5A	0.25-0.33	26-22	0.90	5
208-4709	208-4700	Male	5A	0.33-0.52	22-20	1.12	5
208-4710	208-4701	Male	5A	0.52-0.82	22-18	1.35	5

