

Datasheet

RS PRO RS-HA Compact Inserts

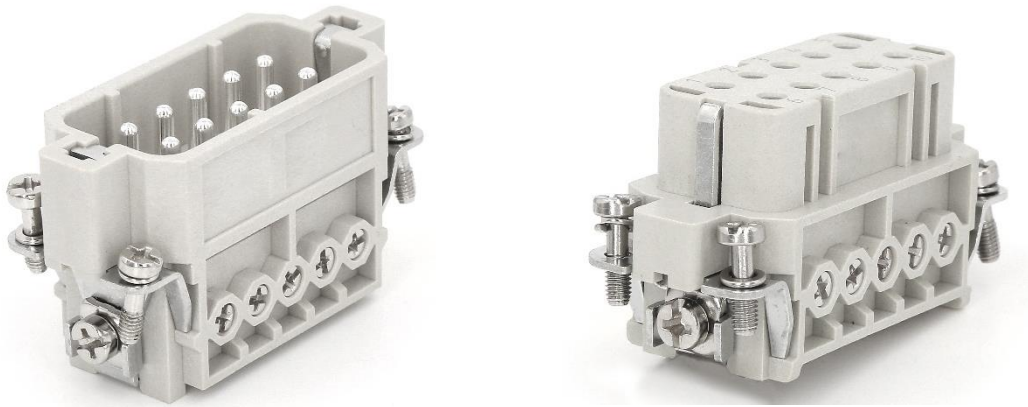

The RS PRO Heavy-Duty Connector series is a full range of heavy-duty inserts, housings, crimps and accessories. The inserts are all made from Polycarbonate to industry standard sizes and are available in a choice of screw, crimp or spring clam terminations in a large variety of current ratings. Modular inserts are also offered allowing for maximum versatility when designing a system. These connectors have been created for applications that are subjected to harsh environments or where high vibration can cause standard connectors to fail. This makes them ideal for food & beverage manufacturing, packaging machines, conveyor belt systems, railway, oil & gas processing and other industrial automation. The entire range of connectors are RoHS compliant and as with all RS PRO products, offer exceptional value for money.

Features & Benefits:

- Slim and Compact Inserts
- 3 to 32 Poles
- Crimp or Screw Termination
- Screw AWG 18-14
- 16A, 250V (Except 3 and 4 Pole 10A, 230V)
- For use with 16A crimps
- Polycarbonate Body

Quality Standards



Dimensional line drawings

3 Pole Female Screw 10A 230V for RS PRO H3A series Housing 208-4323

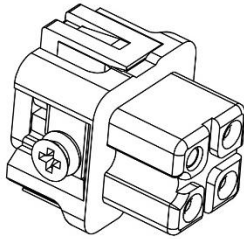
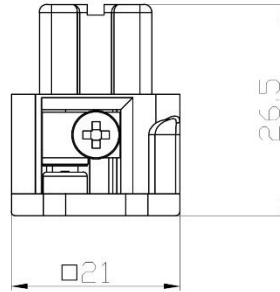
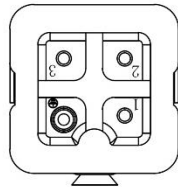

3 Pole Male Screw 10A 230V for RS PRO H3A series Housing 208-4326

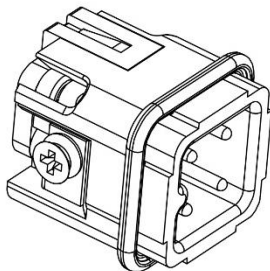
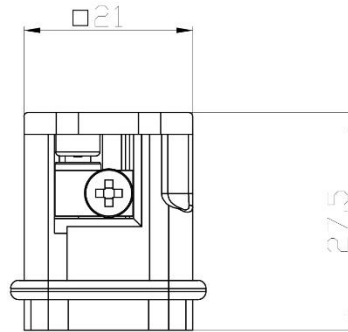
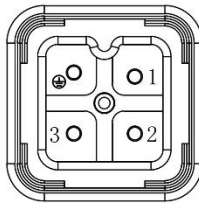

Dimensional line drawings

3 Pole Female Cage Clamp 10A 230V for RS PRO H3A series Housing

208-4324

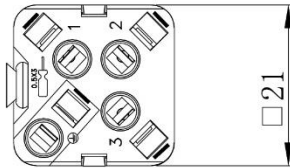
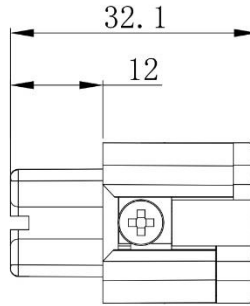
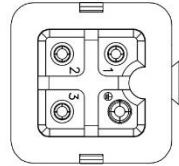

3 Pole Male Cage Clamp 10A 230V for RS PRO H3A series Housing

208-4327

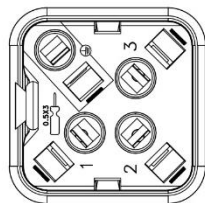
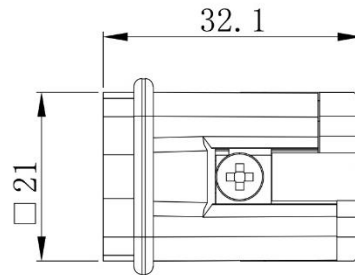
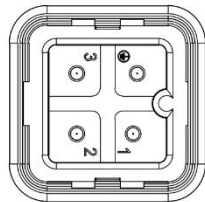

Dimensional line drawings

4 Pole Female Screw 10A 230V for RS PRO H3A series Housing 208-4328

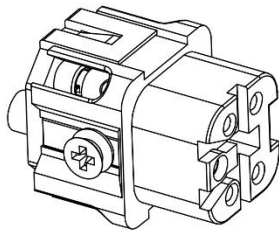
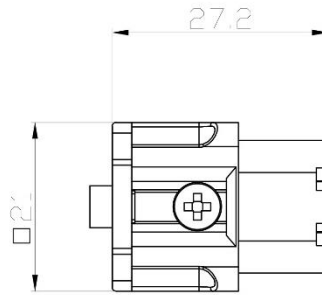
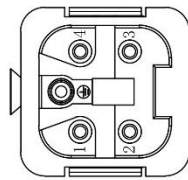

4 Pole Male Screw 10A 230V for RS PRO H3A series Housing 208-4329

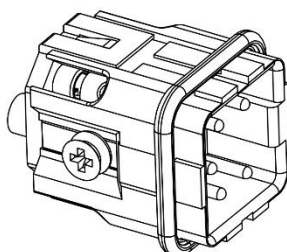
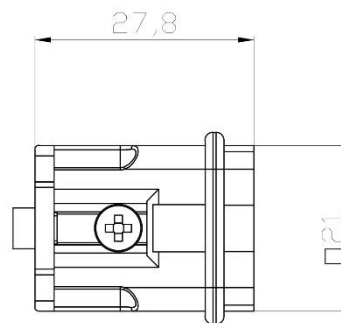
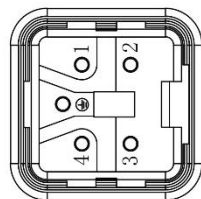

Dimensional line drawings

10 Pole Female Screw 16A 250V for RS PRO H10A series Housing

208-4330

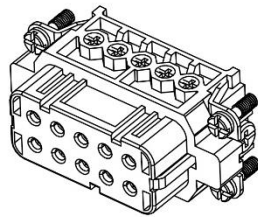
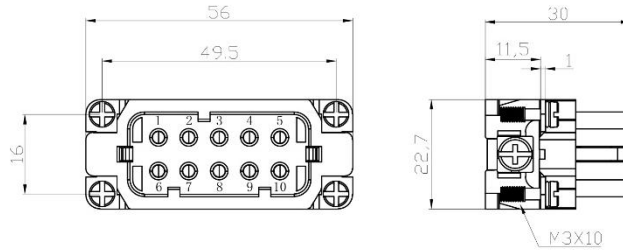

10 Pole Male Screw 16A 250V for RS PRO H10A series Housing

208-4333

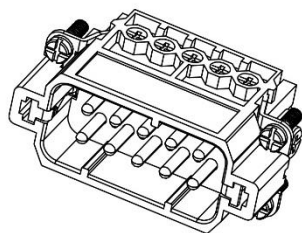
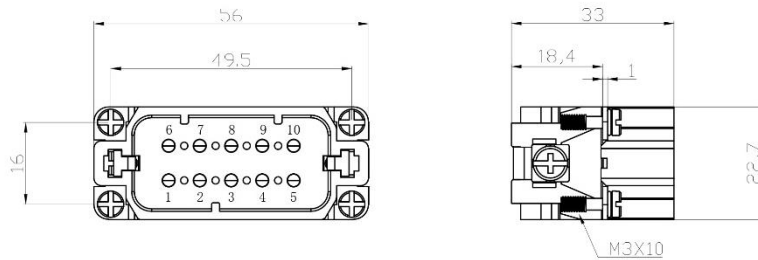

Dimensional line drawings

10 Pole Female Crimp for RS PRO H10A series Housing 208-4332

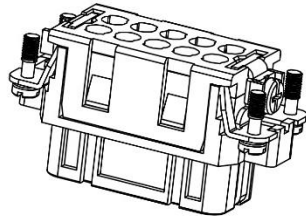
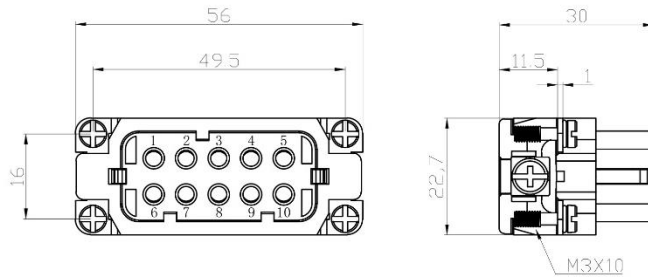

10 Pole Male Crimp for RS PRO H10A series Housing 208-4334

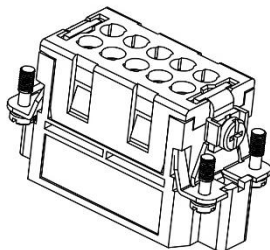
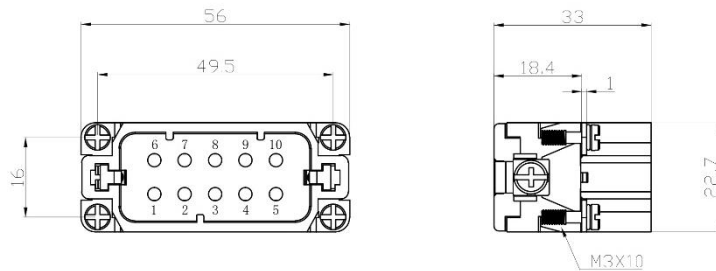

Dimensional line drawings

16 Pole Female Screw 16A 250V for RS PRO H16A series Housing 208-4335

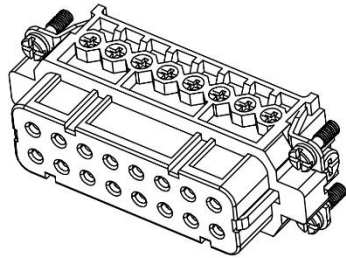
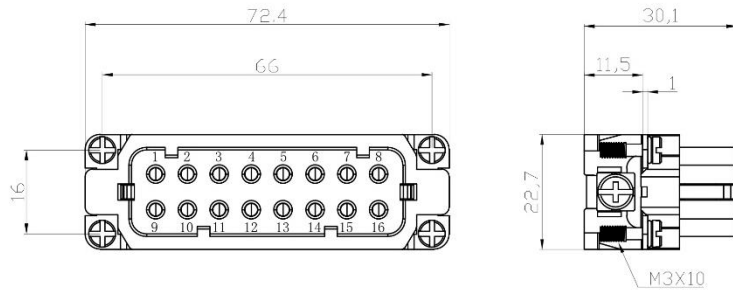

16 Pole Male Screw 16A 250V for RS PRO H16A series Housing 208-4337

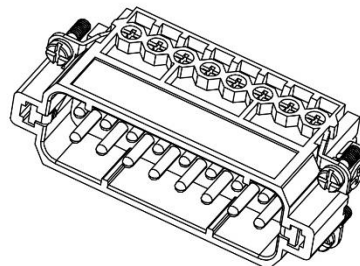
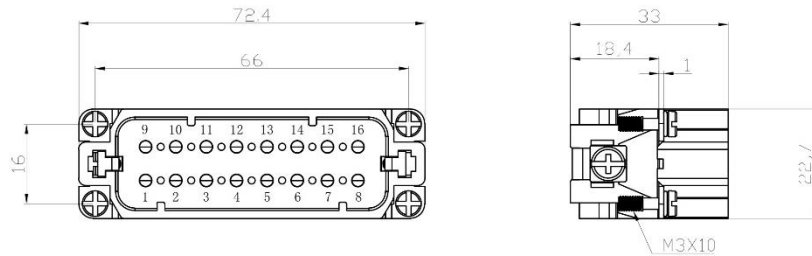

Dimensional line drawings

16 Pole Female Crimp 16A 250V for RS PRO H16A series Housing 208-4336

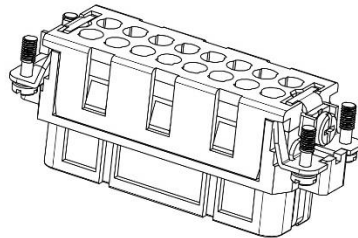
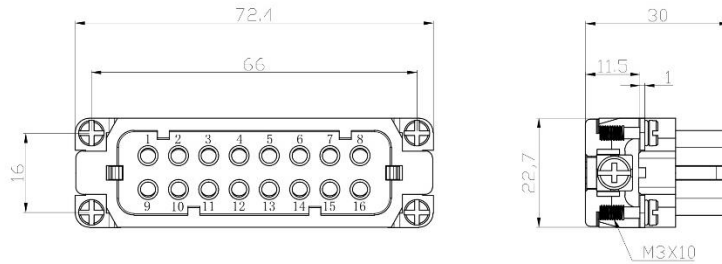

16 Pole Male Crimp 16A 250V for RS PRO H16A series Housing 208-4338

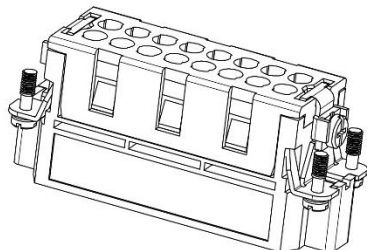
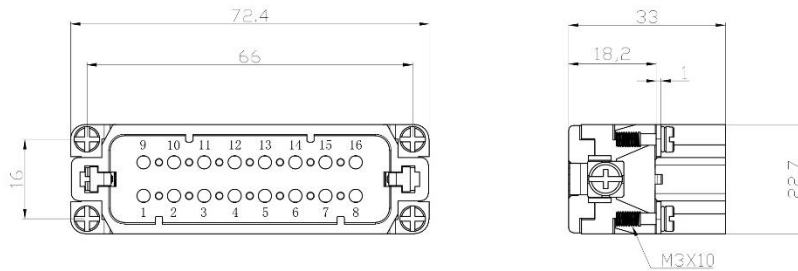

Dimensional line drawings

32 Pole Female Screw 16A 250V for RS PRO H32A series Housing

208-4339 (2x 16 pole)

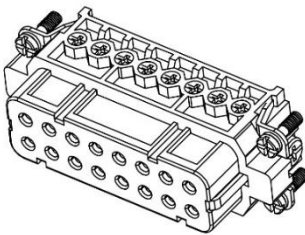
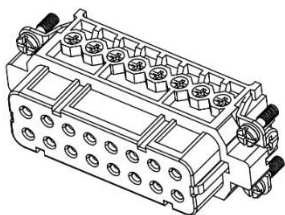
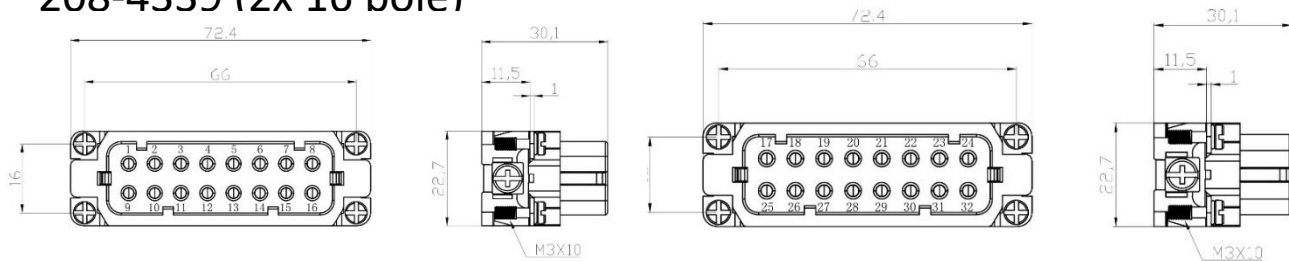

32 Pole Male Screw 16A 250V for RS PRO H32A series Housing

208-1211 (2x 16 pole)

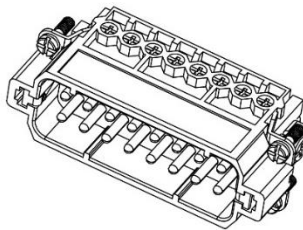
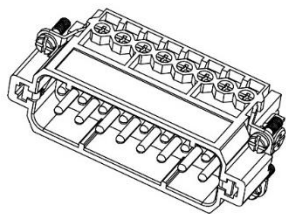
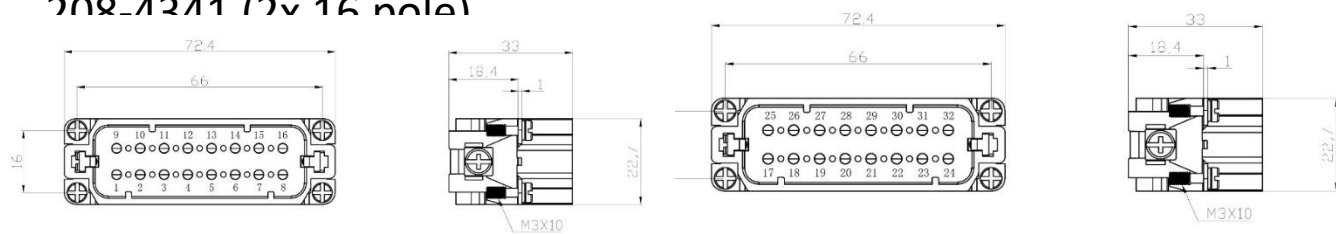

Dimensional line drawings

32 Pole Female Crimp 16A 250V for RS PRO H32A series Housing

208-4340 (2x 16 pole)

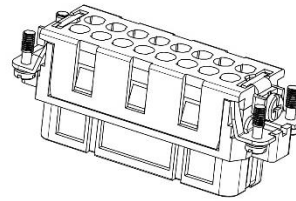
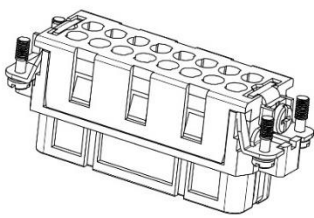
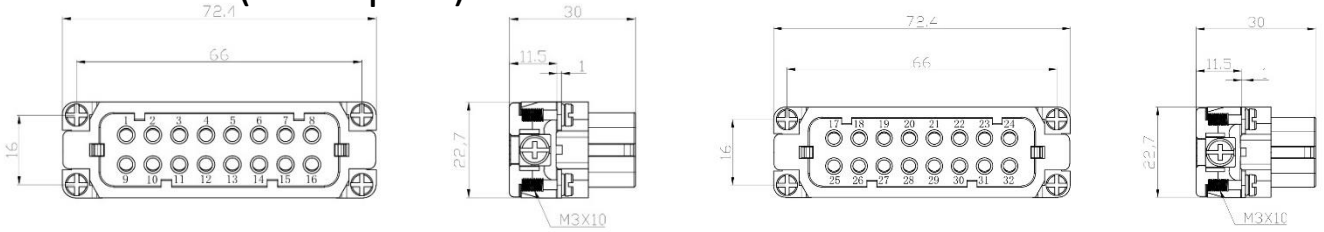

32 Pole Male Crimp 16A 250V for RS PRO H32A series Housing

208-4342 (2x 16 pole)

