

XA2EA42

Complete push button, Easy Harmony XA2, plastic, flush, red, 22mm, spring return, unmarked, 1NC



Main

| | |
|---------------------------|----------------------|
| Range of product | Easy Harmony XA2 |
| Product or component type | Complete push-button |
| Device short name | XA2 |
| Bezel material | Plastic |
| Fixing collar material | Plastic |

Complementary

| | |
|---|--|
| Mounting diameter | 22.5 mm |
| Sale per indivisible quantity | 1 |
| Protective treatment | TC |
| Operating position | Any position |
| Fixing center | $\geq 30 \times 40$ mm (panel) - thickness: 1...5 mm |
| Fixing mode | Fixing nut: 2...2.4 N.m |
| Shape of signaling unit head | Round |
| Type of operator | Spring return |
| Operator profile | Red flush |
| Contacts type and composition | 1 NC |
| Contact operation | Slow-break |
| Positive opening | With NC contact conforming to IEC 60947-5-1 appendix K |
| Mechanical durability | 1500000 cycles |
| Connections - terminals | Screw clamp terminal, $\leq 2 \times 1.5$ mm ² Screw clamp terminal, $\leq 1 \times 2.5$ mm ² Screw clamp terminal, $\geq 1 \times 0.5$ mm ² Faston terminals, connection size: 6.3 mm |
| Tightening torque | 0.8 N.m |
| Short-circuit protection | 10 A gL fuse conforming to IEC 60269-1 |
| [Ith] conventional free air thermal current | 10 A |
| [Ui] rated insulation voltage | 600 V conforming to IEC 60947-1 |
| [Uimp] rated impulse withstand voltage | 6 kV conforming to IEC 60947-1 |
| [Ie] rated operational current | 3 A at 240 V, AC-15, A600 0.27 A at 250 V, DC-13, Q600 |
| Electrical durability | 500000 Cycles, AC-15, 3 A at 230 V, operating rate <60 cyc/mn, load factor: 0.5 conforming to IEC 60947-5-4 500000 cycles, DC-13, 0.2 A at 110 V, operating rate <60 cyc/mn, load factor: 0.5 |
| Electrical reliability | $\Lambda < 10\exp(-8)$ at 24 V |
| Width | 30 mm |
| Height | 42 mm |
| Depth | 54.7 mm |
| Net weight | 0.032 kg |
| Cap/operator or lens colour | Red |
| Type of operator | Spring return |

Environment

| | |
|---------------------------------------|---|
| Ambient air temperature for storage | -40...70 °C |
| Ambient air temperature for operation | -25...55 °C |
| Overvoltage category | Class I conforming to IEC 536 |
| IP degree of protection | IP65 conforming to IEC 60529 |
| IK degree of protection | IK03 conforming to IEC 60529 |
| Standards | IEC 60947-5-1 GB 14048.5 IEC 60947-1 GB 14048.1 |
| Product certifications | CCC[RETURN]CE |
| Vibration resistance | 10 gn (f= 40...500 Hz) conforming to IEC 60068-2-6 |
| Shock resistance | 70 gn (duration = 11 ms) for half sine wave acceleration conforming to IEC 60068-2-27 |

Packing Units

| | |
|------------------------------|-----------|
| Unit Type of Package 1 | PCE |
| Number of Units in Package 1 | 1 |
| Package 1 Height | 3.300 cm |
| Package 1 Width | 3.300 cm |
| Package 1 Length | 6.350 cm |
| Package 1 Weight | 34.000 g |
| Unit Type of Package 2 | BB1 |
| Number of Units in Package 2 | 5 |
| Package 2 Height | 5.000 cm |
| Package 2 Width | 5.000 cm |
| Package 2 Length | 15.000 cm |
| Package 2 Weight | 170.000 g |
| Unit Type of Package 3 | S02 |
| Number of Units in Package 3 | 100 |
| Package 3 Height | 15.000 cm |
| Package 3 Width | 30.000 cm |
| Package 3 Length | 40.000 cm |
| Package 3 Weight | 3.737 kg |

Offer Sustainability

| | |
|----------------------------|---|
| Sustainable offer status | Green Premium product |
| REACH Regulation | REACH Declaration |
| REACH free of SVHC | Yes |
| EU RoHS Directive | Pro-active compliance (Product out of EU RoHS legal scope) EU RoHS Declaration |
| Mercury free | Yes |
| China RoHS Regulation | China RoHS Declaration |
| RoHS exemption information | Yes |
| Environmental Disclosure | Product Environmental Profile |
| Circularity Profile | End Of Life Information |
| WEEE | The product must be disposed on European Union markets following specific waste collection and never end up in rubbish bins |

Dimensions

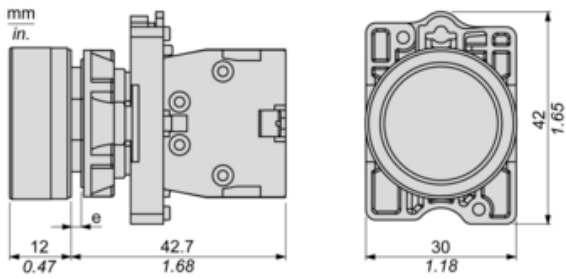

(e) Clamping thickness: 1 to 6 mm / 0.04 to 0.24 in.

Panel Cut-out for Pushbuttons, Switches and Pilot Lights (Finished Holes, Ready for Installation)

Connection by Screw Clamp Terminals

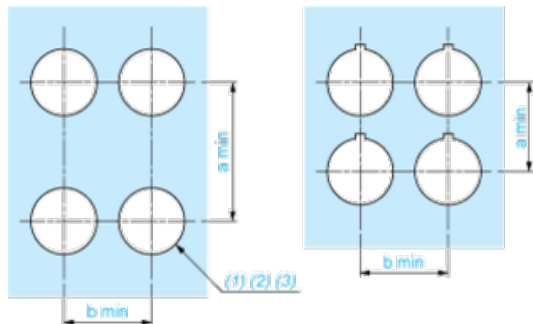

- (1) Diameter on finished panel or support
- (2) For selector switches and Emergency stop buttons, use of an anti-rotation plate type ZB5AZ902 is recommended.
- (3) $\varnothing 22.5$ mm recommended ($\varnothing 22.3_0^{+0.4}$) / $\varnothing 0.89$ in. recommended ($\varnothing 0.88$ in. $^{+0.016}$)

| Connections | a in mm | a in in. | b in mm | b in in. |
|------------------------------------|---------|----------|---------|----------|
| By screw clamp terminals connector | 40 | 1.57 | 30 | 1.18 |
| By Faston connectors | 45 | 1.77 | 32 | 1.26 |

Detail of Lug Recess

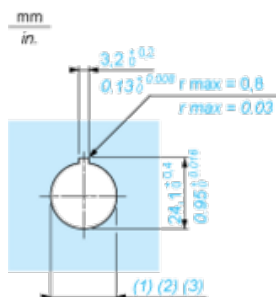

- (1) Diameter on finished panel or support
- (2) For selector switches and Emergency stop buttons, use of an anti-rotation plate type ZB5AZ902 is recommended.
- (3) $\varnothing 22.5$ mm recommended ($\varnothing 22.3_0^{+0.4}$) / $\varnothing 0.89$ in. recommended ($\varnothing 0.88$ in. $^{+0.016}$)