

Dimensions

Push buttons, flush type

XB7NA●●●●, XB7NH●●

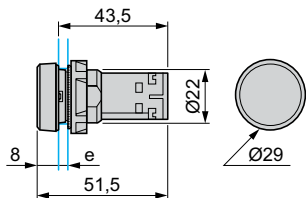

Push buttons, projecting type

XB7NL●●●●

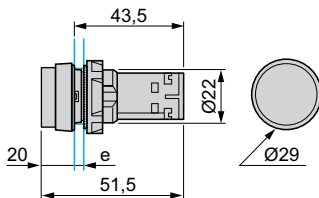

Selector switches, standard handle

XB7ND●●

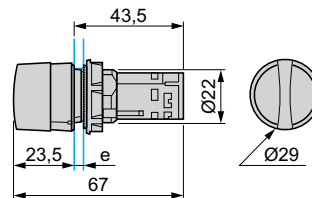

e : support panel thickness: 1 to 6 mm (metal), 2 to 6 mm (plastic).

Key switches

XB7NG●●

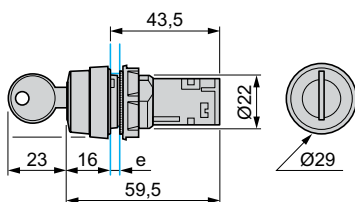

Emergency switching off push buttons

XB7ES54●P

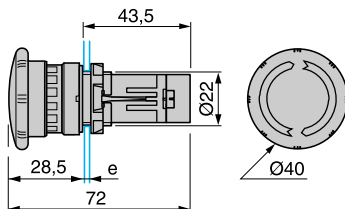

Emergency switching off push buttons with key

XB7ES14●P

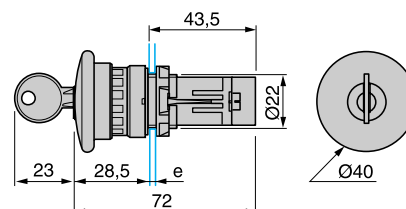

e : support panel thickness: 1 to 6 mm (metal), 2 to 6 mm (plastic).

Pilot lights with screw terminal

XB7EV●●●P

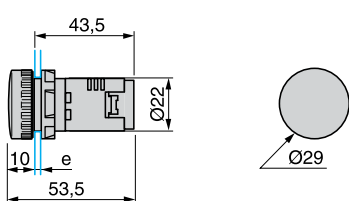

Pilot lights with Faston® terminal

XB7EV●●●P3

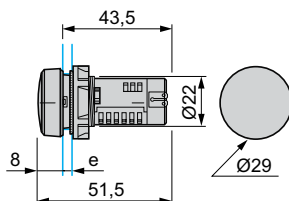

Illuminated push buttons

XB7NW●●●●, XB7NJ●●●●

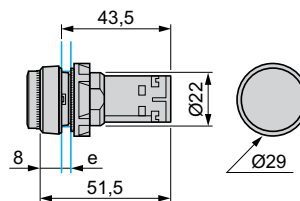

e : support panel thickness: 1 to 6 mm (metal), 2 to 6 mm (plastic).

Faston clip connection (for pilot lights only)

"U" type tag connection

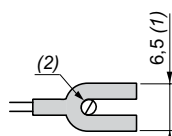
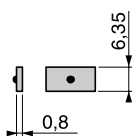

(1) 6.5 recommended, 7 mm max.
(2) M3 screw clamp terminal.

Mounting

Diameter of finished mounting holes

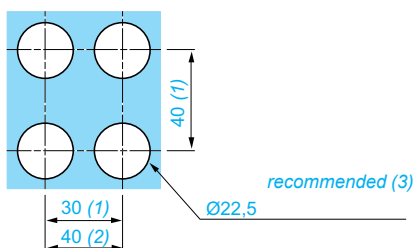

(1) Minimum value.
(2) 40 mm for Emergency switching off push button only.
(3) Standard value: Ø 22.3 (0; + 0.4).