

## 2 Bolt Pillar bearings SL Series – Metric

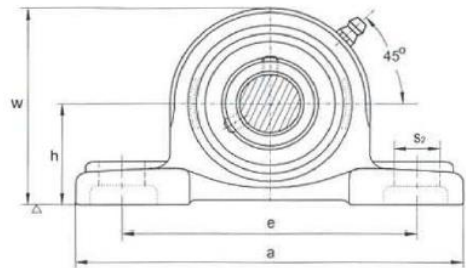
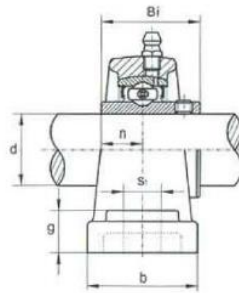

| RS Article no. | Bearing unit No. | Shaft Dia. | Dimension (mm) |     |     |    |                |                |    |     |      |      |     | Bolt used (mm) | Bearing No. | Housing No. | Weight (kg) |
|----------------|------------------|------------|----------------|-----|-----|----|----------------|----------------|----|-----|------|------|-----|----------------|-------------|-------------|-------------|
|                |                  | d (mm)     | h              | a   | e   | b  | s <sub>2</sub> | s <sub>1</sub> | g  | w   | Bi   | n    |     |                |             |             |             |
| 7508933        | UCP201           | 12         | 30.2           | 127 | 95  | 38 | 16             | 13             | 14 | 62  | 31.0 | 12.7 | M10 | UC 201         | P 201       | 0.63        |             |
| 7508936        | UCP202           | 15         | 30.2           | 127 | 95  | 38 | 16             | 13             | 14 | 62  | 31.0 | 12.7 | M10 | UC 202         | P 202       | 0.63        |             |
| 7508949        | UCP203           | 17         | 30.2           | 127 | 95  | 38 | 16             | 13             | 14 | 62  | 31.0 | 12.7 | M10 | UC 203         | P 203       | 0.63        |             |
| 7508946        | UCP204           | 20         | 33.3           | 127 | 95  | 38 | 16             | 13             | 14 | 65  | 31.0 | 12.7 | M10 | UC 204         | P 204       | 0.65        |             |
| 7508952        | UCP205           | 25         | 36.5           | 140 | 105 | 38 | 16             | 13             | 15 | 71  | 34.0 | 14.3 | M10 | UC 205         | P 205       | 0.79        |             |
| 7508964        | UCP206           | 30         | 42.9           | 165 | 121 | 48 | 20             | 17             | 17 | 83  | 38.1 | 15.9 | M14 | UC 206         | P 206       | 1.30        |             |
| 7508977        | UCP207           | 35         | 47.6           | 167 | 127 | 48 | 20             | 17             | 18 | 93  | 42.9 | 17.5 | M14 | UC 207         | P 207       | 1.60        |             |
| 7508974        | UCP208           | 40         | 49.2           | 184 | 137 | 54 | 20             | 17             | 18 | 98  | 49.2 | 19.0 | M14 | UC 208         | P 208       | 2.00        |             |
| 7508983        | UCP209           | 45         | 54.0           | 190 | 146 | 54 | 20             | 17             | 20 | 106 | 49.2 | 19.0 | M14 | UC 209         | P 209       | 2.20        |             |
| 7508986        | UCP210           | 50         | 57.2           | 206 | 159 | 60 | 23             | 20             | 21 | 114 | 51.6 | 19.0 | M16 | UC 210         | P 210       | 2.80        |             |
| 7508999        | UCP211           | 55         | 63.5           | 219 | 171 | 60 | 23             | 20             | 23 | 126 | 55.6 | 22.2 | M16 | UC 211         | P 211       | 3.40        |             |
| 7508992        | UCP212           | 60         | 69.8           | 241 | 184 | 70 | 23             | 20             | 25 | 138 | 65.1 | 25.4 | M16 | UC 212         | P 212       | 4.80        |             |
| 7509009        | UCP213           | 65         | 76.2           | 265 | 203 | 70 | 28             | 25             | 27 | 151 | 65.1 | 25.4 | M20 | UC 213         | P 213       | 5.70        |             |
| 7509002        | UCP214           | 70         | 79.4           | 266 | 210 | 72 | 28             | 25             | 27 | 157 | 74.6 | 30.2 | M20 | UC 214         | P 214       | 7.00        |             |
| 7509006        | UCP215           | 75         | 82.6           | 275 | 217 | 74 | 28             | 25             | 28 | 163 | 77.8 | 33.3 | M20 | UC 215         | P 215       | 7.60        |             |