

ANSI 150# SS316 Flange End Swing Check Valves

Features

- Swing Type
- ANSI 150# Flange Connection
- Size: 1/2" - 4" (DN15 - DN100)
- Working Pressure: 150#
- Material: SS316, CF8M
- Applicable Medium: General oil, gas & water applications
- Temperature Range: -29°C to 150°C

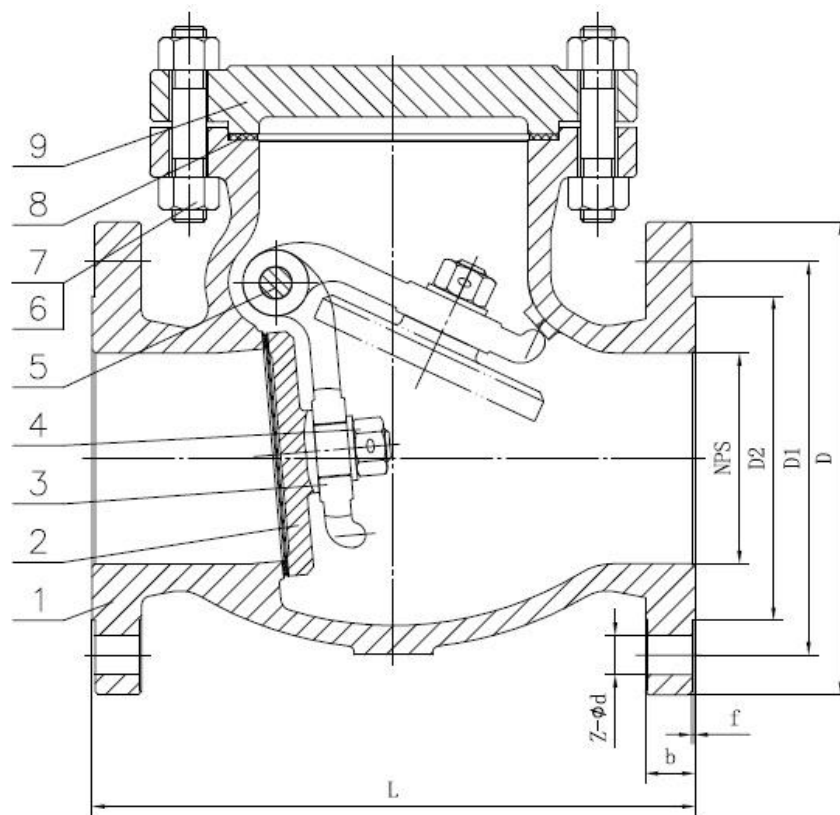

Technical Specifications

1. Basic design and manufacture according to BS1868 & ASME B16.34
2. Structure length according to ASME B16.10
3. Flange ends complied with ASME B16.5
4. Inspection and tested according to API 598

Performance Specification Sheet

Nominal pressure		150 #	
Test pressure	Shell test	3.0	MPa
	Seal test	2.2	
	Air seal test	0.4 - 0.7	
Applicable Medium: General oil, gas & water			

Ordering Information

VL - S - SC - F - 150 - 24
 I II III IV V VI

I Type of Item

VL Low Pressure Valves

II Material Grade

S SS316, CF8M CI Cast Iron
 FS Forged Steel CS Cast Steel
 B Brass

III Item

GA Gate Valve B1 1 PC Ball Valve
 GL Globe Valve B2 2 PC Ball Valve
 YS Y-Strainer B3 3 PC Ball Valve
 SC Swing Check Valve BL 3 Way Ball Valve L Port
 VC Vertical Check Valve BT 3 Way Ball Valve T Port
 WC Wafer Check Valve BMF Male x Female Mini Ball Valve
 DD Dual Disk BU Butterfly Valve

IV Connection Type

SW S/W G BSPP
 BW B/W N NPT
 R BSPT F Flange End
 W Wafer L Lug

V Pressure

200 200 PSI 2000 2000 PSI
 300 300 PSI 150 ANSI 150# Flange Standard
 600 600 PSI 10K JIS 10K Flange Standard
 800 800 PSI PN16 PN 16 Flange Standard
 1000 1000 PSI

For Inch OD & Inch NB Sizes

VI Size

Size	1/8"	1/4"	5/16"	3/8"	1/2"	5/8"	3/4"	1"
Code	02	04	05	06	08	10	12	16
Size	1 1/4"	1 1/2"	2"	2 1/2"	3"	4"	5"	6"
Code	20	24	32	40	48	64	80	96

VII Coating

(None) No Additional Coating
 NI Nickel Plating

Material List

No.	Part Name	Material
1	Body	CF8M/SS316
2	Disc	CF8M/SS316
3	Arm	CF8M/SS316
4	Nut	SS316
5	Hinge Pin	SS316
6	Bolt	SS316
7	Nut	SS316
8	Gasket	PTFE
9	Bonnet	CF8M/SS316

Dimension List

Size	Connection	Impa Code	Part No	NPS	D	D1	D2	L	Z-Ød	b	f	Weight (Kg)
1/2"	Flange-end	-	VL-S-SC-F-150-08	15	89	60.5	35	152	4-Ø19	11.1	2	-
3/4"	Flange-end	-	VL-S-SC-F-150-12	20	98.5	70	43	178	4-Ø19	11.1	2	-
1"	Flange-end	-	VL-S-SC-F-150-16	25	108	79.2	51	127	4-Ø19	11.1	2	-
1 1/2"	Flange-end	-	VL-S-SC-F-150-24	38	127	98.6	73	165	4-Ø19	14.3	2	7.00
2"	Flange-end	-	VL-S-SC-F-150-32	50	152	120.7	92	203	4-Ø19	15.9	2	11.00
2 1/2"	Flange-end	-	VL-S-SC-F-150-40	65	178	139.7	105	216	4-Ø19	17.5	2	12.30
3"	Flange-end	-	VL-S-SC-F-150-48	80	190	152.4	127	241	4-Ø19	19.5	2	26.04
4"	Flange-end	-	VL-S-SC-F-150-64	100	230	190.5	157.2	292	8-Ø19	24.3	2	36.00

Part Number Reference

Impa Code	Part No	Description
-	VL-S-SC-F-150-08	1/2" 150# SS316 FLANGE END SWING CHECK VALVE
-	VL-S-SC-F-150-12	3/4" 150# SS316 FLANGE END SWING CHECK VALVE
-	VL-S-SC-F-150-16	1" 150# SS316 FLANGE END SWING CHECK VALVE
-	VL-S-SC-F-150-24	1 1/2" 150# SS316 FLANGE END SWING CHECK VALVE
-	VL-S-SC-F-150-32	2" 150# SS316 FLANGE END SWING CHECK VALVE
-	VL-S-SC-F-150-40	2 1/2" 150# SS316 FLANGE END SWING CHECK VALVE
-	VL-S-SC-F-150-48	3" 150# SS316 FLANGE END SWING CHECK VALVE
-	VL-S-SC-F-150-64	4" 150# SS316 FLANGE END SWING CHECK VALVE