

Datasheet
Stock No:1706993
RS Pro
7/16 STRAIGHT PLUG CLAMP

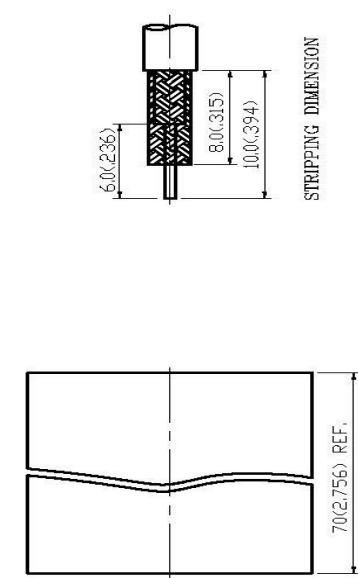
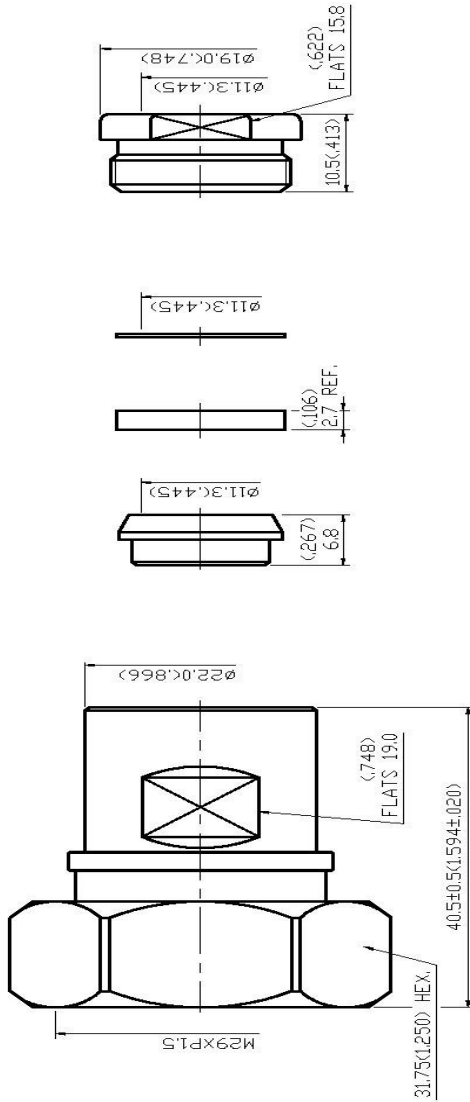

- 1.0 ELECTRICAL**
 1.1 FREQUENCY RANGE: DC-7.5 GHz
 1.2 NOMINAL IMPEDANCE: 50 OHMS
 1.3 VOLTAGE RATING: 1000 VOLTS MAX.
 1.4 VSWR: 1.1 MAX @6 GHz
- 2.0 MATERIALS**
 2.1 BODIES: BRASS PER JIS-C3604
 2.2 CENTER CONTACT: BERYLLIUM COPPER PER ASTM B196 UNS C17300
 2.3 INSULATION: TEFLON PER ASTM D1457 AND ASTM D1710
- 3.0 FINISHES AND OTHERS**
 3.1 SEE BELOW TABLE FOR DETAILS
- 4.0 MECHANICAL**
 4.1 INTERFACE IN ACCORDANCE WITH: IEC 169-4
 4.2 FOR USE WITH LMR400 OR SIMILAR STYLE CABLE
 4.3 CABLE ATTACHMENT: OUTER CLAMP, INNER PLUG IN
- 5.0 ENVIRONMENTAL**
 5.1 OPERATING TEMPERATURE RANGE: -55° C TO +155° C

NO	DESCRIPTION	MATERIAL	Q	TY	FINISH
12	HEAT SHRINK TUBE	PE	1		BLACK (ADHESIVE SHRINK)
11	NUT	BRASS	1		WHITE BRONZE 80µ" MIN.
10	WASHER	BRASS	1		WHITE BRONZE 80µ" MIN.
9	GASKET	SILICONE	1		RED
8	BRAD CLAMP	BRASS	1		WHITE BRONZE 80µ" MIN.
7	BODY	BRASS	1		WHITE BRONZE 80µ" MIN.
6	INSULATION	TEFLON	1		NONE
5	CENTER CONTACT	BERYLLIUM COPPER	1		SILVER 70µ" MIN.
4	O-RING	SILICONE	1		BLACK
3	O-RING	SILICONE	1		RED
2	BODY	BRASS	1		WHITE BRONZE 80µ" MIN.
1	SHELL	BRASS	1		WHITE BRONZE 80µ" MIN.

APPROVED by _____ DATE: _____

DESCRIPTION		7/16 STRAIGHT PLUG CLAMP	
製圖	DRAWN	品名	406220108117001 LMR400
檢圖	CHECK	DATE	01.04.18
認圖	APPROVAL	TITLE	NROHS COMPLIANT (500)
定	Jenny	單位	mm(m)
		比例	2:1
		圖號	62-0006-Z
		次	A-0