



ENGLISH

Datasheet

RS Pro Shock Proof Dial Indicator

RS Stock No: 614-1444



Specifications:

Shockproof mechanism disengages the gear assembly from the rack, when the gauge is exposed to sudden impacts.

Adjustable dial

Hardened & ground racks

Bezel lock

Lug back fitted

Tolerance pointers

Anvil thread 2.5mm

Measuring Range: 10mm

Bezel Diameter: 60mm

Dial Graduation: 0.01mm

Scale Reading: 0-100

Stem Diameter: 8mm

Order Code	Manufacturers Code	Description
614-1444	DG-MSP	Shock Proof Plunger Dial Indicator



ENGLISH

Datasheet

RS Pro Shock Proof Dial Indicator

Range Details:

Dial Dia (in)	Travel (in)	Grads (in)	Reading
60	10.0	0.01	0-100 c/w, 0-100 a/c

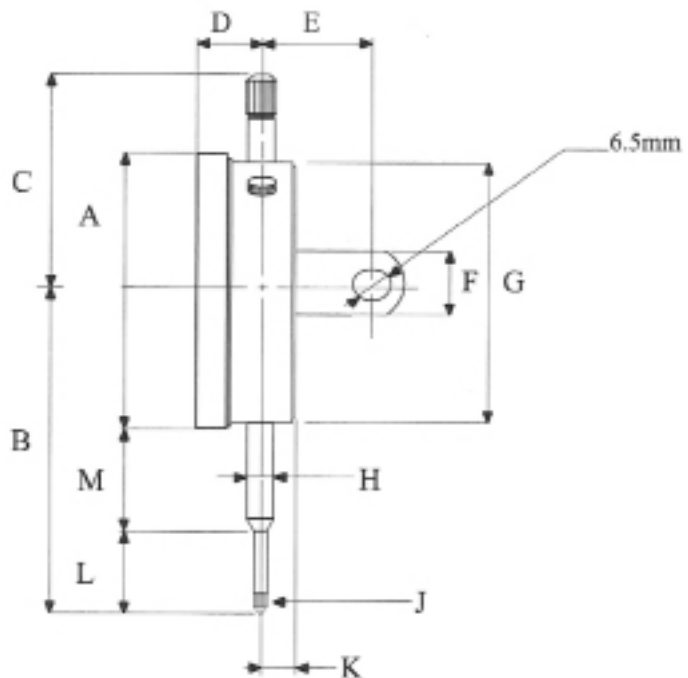

A	B	C	D	E	F	G	H	J	K	L	M
60	69.0	45.0	16.0	19.3	17.8	54.7	8.0	M2.5	8.0	20.0	18.0

All measurements figured in mm