

- Features:-
1. Conductive plastic long life resistance element.
  2. Precious metal high technology wiper gives noise free output.
  3. Special smaller electrical angles..... available option.

ELECTRICAL CHARACTERISTICS:-	UNITS	VALUE
Resistance Element.....	--	Conductive Plastic
Resistance value	Ohms	500,1k,2k,5k,10k (Other values upto 100K)
Standard Resistance Tolerance.....	±%	20
Best Possible Resistance Tolerance.....	±%	10
Standard independent Linearity Tolerances...(IEC 393)...	± %	2.0
Best Possible Independent Linearity Tolerance.....	± %	0.5
Electrical Angle.....(Smaller angle optional)	Degrees	320 ± 5
Resolution.....	--	Essentially infinite
Temperature Coefficient of Resistance(TCR)....	ppm/deg C	±400
Power Rating @ 70° C.....	Watts	1.0
Insulation Resistance @ 500 Vdc..	M Ohms	1000
Dielectric Strength @ 50 Hz.....	V ac	500
Maximum Wiper current.....	mAmps	1
short time wiper current 3 sec.	mAmps	10
End Voltage as a % of Applied Voltage....	%	Less than 0.5

**MECHANICAL CHARACTERISTICS :-**

Rotation (Mechanical Angle). With End Stop .....	Degrees	330 ± 5
Bearing Type.....	--	Sleeve
Torque... Starting.....	Nmm(Oz in)	5(0.708)
Torque... Running.....	Nmm(Oz in)	4 (0.566)
Nut Tightening Torque	Nm.	2.0 Max.

**ENVIRONMENTAL CHARACTERISTICS :-**

Operating Temperature.....	Degrees C	- 50 to +105
ROHS compliance	-	Yes

**PERFORMANCE :-**

Rotational Life (shaft Revolutions)..	Nos.	4,000,000 (Typical)
---------------------------------------	------	---------------------

**MATERIALS OF CONSTRUCTION:-**

Housing.....	--	Engg. Plastic
Shaft.....	--	Stainless steel
Terminals.....	--	Pads on PCB, Gold Plated
Mounting Hardware.....	--	Lock Washer-steel + Nut-Brass both Nickel plated
Bushing.....	--	Brass

a) Soldering Recommendation :- Use soldering Iron at 300° C for 3 second maximum  
 \* Standard tests have shown the life to be 5,000,000+. Confirmation test are continuing, waiting for consolidation of data.



## CONDUCTIVE PLASTIC POTENTIOMETER

NP 21

First Issue : 2009/03/07      Scale : 1:1

Tolerances  
DIN-ISO 2768-1 (1991-06)  
(Tolerance class-medium)

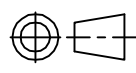

CUSTOMER DRAWING REF NO  
-----

REV -00

1 of 1