

# Locking Fork

## Vinyl Insulated, Butted Seam



### Specifications:

Barrel Seam	: Butted
Max. Voltage Rating	: 600V Building Wire 1,000V Signs, Fixtures and Luminaires
Max. Temperature Rating	: 221°F (105°C)
Max. Current	: Same as Wire
Insulator Material	: Vinyl
Terminal Material	: ETP Copper
Plating	: Tin

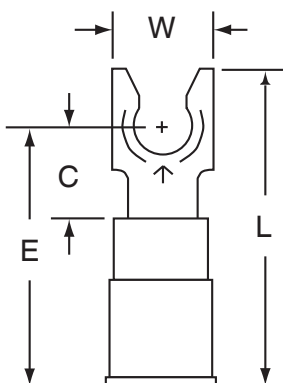

Part Number	Wire Range (AWG)	Stud Size	Max. Lock Width	W	C	L	E	Thickness	Barrel Length	Barrel I.D.	Max. Insulation Diameter
CLS-TV-1806	22-18	6	0.27	0.25	0.25	0.88	0.7	0.03	0.25	0.07	0.145
CLS-TV-1808		8	0.34	0.30							
CLS-TV-1810		10	0.35	0.32							
CLS-TV-1406	16-14	6	0.27	0.25	0.25	0.88	0.7	0.03	0.25	0.09	0.17
CLS-TV-1408		8	0.34	0.30							
CLS-TV-1410		10	0.35	0.32							
CLS-TV-1006	12-10	6	0.30	0.28	0.28	1.03	0.83	0.04	0.25	0.135	0.25
CLS-TV-1008		8	0.35	0.32							
CLS-TV-1010		10	0.36	0.32							
CLS-TV-1025		1/4	0.48	0.43	0.44	1.24	0.99				

Dimensions : Inches



# Locking Fork

## Vinyl Insulated, Butted Seam



### Engineering Specification:

Crimp-type terminals shall, electrically and mechanically, connect to a pre-stripped end of a stranded copper wire and have a flat tongue portion with a central opening for mounting around a screw or stud.

The terminal line shall offer tongue variations in hole (stud) size (6, 8, 10, etc.) and configuration (ring, fork, block fork, flanged block fork, locking fork, etc.) and barrel variations in wire (AWG) size (22-18, 16-14, 12-10, etc.) and construction (non-insulated brazed seam, vinyl insulated butted seam, nylon insulated with insulation grip, etc.). The terminal tongue shall be marked with the wire range and manufacturer's symbol (↑).

The vinyl-insulated, butted seam locking fork terminal shall be tin-plated, annealed copper, with the tongue having a specified stud slot (size 4 thru 1/4 in.) and a butted seam barrel covered by a molded vinyl funnel entry sleeve, colour coded and sized, for a specified (AWG) wire range (22-18, 16-14, 12-10).

### Part Number Table

Description	Part Number
Locking Fork, Vinyl Insulated, Butted Seam	CLS-TV-1806
	CLS-TV-1808
	CLS-TV-1810
	CLS-TV-1406
	CLS-TV-1408
	CLS-TV-1410
	CLS-TV-1006
	CLS-TV-1008
	CLS-TV-1010
	CLS-TV-1025

**Important Notice :** This data sheet and its contents (the "Information") belong to the members of the Premier Farnell group of companies (the "Group") or are licensed to it. No licence is granted for the use of it other than for information purposes in connection with the products to which it relates. No licence of any intellectual property rights is granted. The Information is subject to change without notice and replaces all data sheets previously supplied. The Information supplied is believed to be accurate but the Group assumes no responsibility for its accuracy or completeness, any error in or omission from it or for any use made of it. Users of this data sheet should check for themselves the Information and the suitability of the products for their purpose and not make any assumptions based on information included or omitted. Liability for loss or damage resulting from any reliance on the Information or use of it (including liability resulting from negligence or where the Group was aware of the possibility of such loss or damage arising) is excluded. This will not operate to limit or restrict the Group's liability for death or personal injury resulting from its negligence. Multicomp is the registered trademark of the Group. © Premier Farnell plc 2012.

