

## FEATURES

- All fluids usable in aggressive environment
- Mechanical resistance
- Silicon free

## RS PRO MALE SOCKET INOX SHORT 1/2

RS Stock No:- 2312687



RS PROfessionally Approved Products bring to you professional quality parts across all product categories. Our product range has been tested by engineers and provides a comparable quality to the leading brands without paying a premium price.

## Product Description

The RS PRO male socket inox short 1/2 works in 0 to 16 bar pressure range. It mainly used in compressed air & tools, pneumatic & fluid technology, food & beverages applications. It provides high performance for multiple fluids in a wide range of temperature and pressure. Operating temperature range is from - 15 °C to + 200 °C. RoHS and REACH compliant.

## General Specifications

<b>Material</b>	Steel
<b>Applications</b>	Lubrication System, Cooling System, Pneumatic Machinery Equipment

## Mechanical Specifications

<b>Connection Type</b>	Tube
<b>Tube Connection Size</b>	9
<b>Coupling Gender</b>	Male
<b>Threaded Connection</b>	1/2 in Male
<b>Thread Size</b>	1/2in
<b>Hose Barb Connection</b>	4mm
<b>Wrench Size</b>	21
<b>Length</b>	52mm

## Similar Products

Parameters	2312521	2312522
Brand	RS PRO	RS PRO
Connection Type	Threaded, Tube	Threaded, Tube
Tube Connection Size	9mm	10mm
Coupling Gender	Male	Male
Threaded Connection	3/8 in Male	1/2 in Male
Thread Size	3/8in	1/2in
Hose Barb Connection	30.5mm	25Hex
Wrench Size	20Hex	54mm

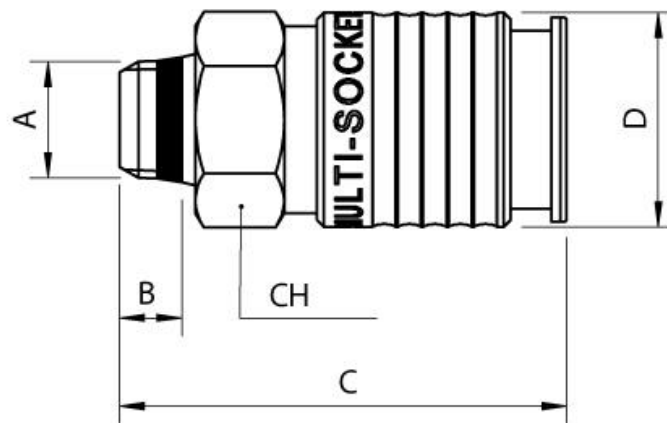

A	B	C	D	CH	Pack.
1/2	9	52	24	21	2