



Datasheet

ENGLISH

Nylon Heavy Duty Bridge Handle

Fixing Type

Plain bores for fixing with bolts from above.

Material

Nylon

Thread

Moulded bore

Info

This heavy duty handle features a flat edge with protruding areas for extra grip. When mounted on a wall or vertical surface it is suitable for a foot step application.

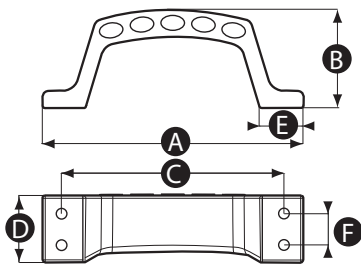

Part No.	A	B	C	D	E	F	Bore size (mm)
456545	162	63.5	140	42	27	20	6.5