

FEATURES

- Copper body material for high conductivity and easy crimping
- Tin plating for resistance to corrosion
- Added strength and excellent conductivity
- Vinyl insulation for electrical insulation and terminal protection
- Colour coded insulation for easy identification of terminal size
- Expanded insulation entry for easy wire insertion

RS PRO Insulated Ring Terminal, M6 (1/4) Stud Size, 0.5mm² to 1.5mm² Wire Size, Red

RS Stock No.: 267-3593



RS Professionally Approved Products bring to you professional quality parts across all product categories. Our product range has been tested by engineers and provides a comparable quality to the leading brands without paying a premium price.

Product Description

From RS PRO a high-quality insulated crimp ring terminal, also known as a ring connector or cable lug. Ring crimp terminals are used for connecting an electrical cable or wire to a stud or a post on an electrical component such as a battery terminal. This ring terminal is made from highly conductive copper and has a double crimp design with an internal copper sleeve. This internal copper sleeve strengthens the barrel, provides a robust and secure crimp and protects the wire against stress and high vibration. The ring terminal is then tin plated for maximum electrical conductivity and corrosion resistance.

General Specifications

Insulation	Insulated
Insulation Material	Nylon
Colour	Red
Contact Material	Copper
Contact Plating	Tin
Stud Size	M6 (1/4)
Double Crimp	With copper sleeve on barrel
Application	Wide range of industries for connecting wires to electrical components. Applications include wiring in industrial control systems and industrial machines, automotive applications, communication equipment, power supplies and domestic appliances.

Electrical Specifications

Maximum Electrical Rating	105°C 600V Max.
Maximum Electrical Current	22 AWG: 9A, 16 AWG: 18A

Mechanical Specifications

Thickness	0.75mm
Overall Length	27.8mm
Inner Ring Diameter	6.4mm
Outer Ring Diameter	11.6mm
Maximum Wire Size	1.5mm ²
Minimum Wire Size	0.5mm ²
Maximum Wire Size (AWG)	16AWG
Minimum Wire Size (AWG)	22AWG

Operation Environment Specifications

Maximum Operating Temperature	150°C
--------------------------------------	-------

Approvals

Compliance/Certifications	UL
----------------------------------	----



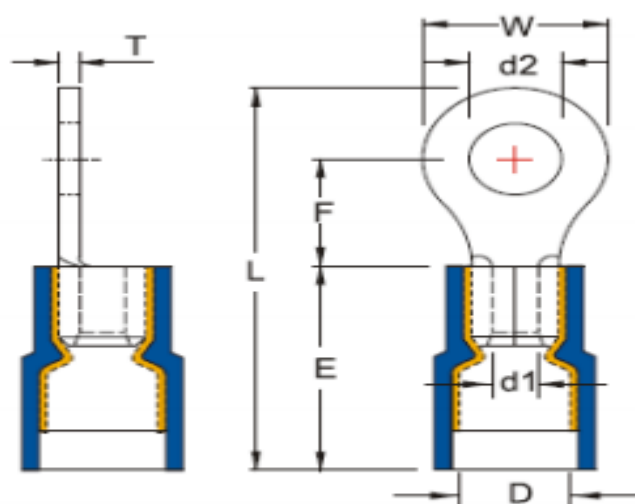
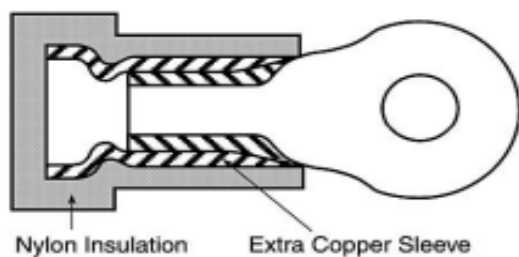

Dimensions

Wire Size (mm ² /AWG)	Stud Size		Dimensions (inch/mm)						
	d2		W	F	L	E	D	d1	T
	Size	(inch/mm)							
0.5-1.5 mm ² /22-16 AWG	1/4	.252/6.4	.457/11.6	.433/11.0	1.094/27.8	.433/11.0	.177/4.5	.067/1.7	.030/0.75