

FEATURES

- Provides quick and easy connection and disconnection
- Fully Insulated for protection against electrical shock
- Double crimp design with an internal copper sleeve
- Tin plating for resistance to corrosion
- Colour coded insulation for easy identification

RS PRO Red Insulated Spade Connector, 6.3 x 0.8mm Tab Size, 0.5mm² to 1.5mm²

RS Stock No.: 534-351



RS Professionally Approved Products bring to you professional quality parts across all product categories. Our product range has been tested by engineers and provides a comparable quality to the leading brands without paying a premium price.

Product Description

From RS PRO a high-quality insulated crimp receptacle terminal sometimes known as a female quick disconnect. Female crimp receptacles are a type of electrical wiring connector which, when mated with a male tab connector (or male quick disconnect), provide a fast and reliable interconnect between two wires. The body of the connector is made from tin plated brass and features an additional internal copper sleeve. This copper sleeve strengthens the barrel and provides a robust and secure crimp. The sleeve also protects the wire against stress and high vibration. The receptacle also has a plastic insulation which provides protection against electric shock and offers protection from dirt, grease, liquids and other contaminants. The colour of the insulation matches the wire size that the connector is used with making identification quick and easy.

General Specifications

Insulation	Insulated
Insulation Material	Vinyl
Termination Method	Crimp
Contact Plating	Tin
Contact Material	Brass
Colour	Red
Applications	Industrial control systems; Industrial machines; Automotive applications; Communication equipment; Power supplies; HVAC; Domestic appliances including dishwashers, washing machines and dryers
Gender	Female
Shrouded/Unshrouded	Shrouded

Electrical Specifications

Current Rating	10A
Voltage Rating	300V

Mechanical Specifications

Minimum Wire Size	0.5mm ²
Maximum Wire Size	1.5mm ²

Spade Connectors

Tab Size	6.3mm x 0.8mm
Minimum Wire Size (AWG)	16AWG
Maximum Wire Size (AWG)	22AWG
Overall Length	21.5mm

Operation Environment Specifications

Temperature Rating	75°C
---------------------------	------

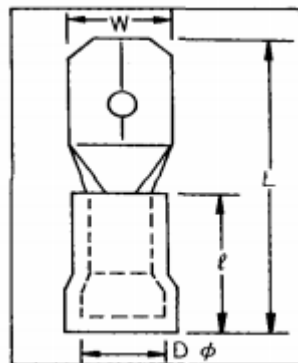

Spade Connectors



Part No.	Insulation Color.	Wire Range		Dimension				Tab Size	
		AWG	mm ²	W	D ϕ	L	ℓ	AWG	mm
631288 VH	RED	22-16	0.5-1.5	2.8	4.3	19.9	9.8	.110×.032	2.8×0.8
631485 VH	RED	22-16	0.5-1.5	4.8	4.3	19.6	9.8	.187×.020	4.8×0.5
631488 VH	RED	22-16	0.5-1.5	4.8	4.3	20.0	9.8	.187×.032	4.8×0.8
631638 VH	RED	22-16	0.5-1.5	6.3	4.3	20.7	9.8	.250×.032	6.3×0.8
635485 VH	BLUE	16-14	1.5-2.5	4.8	4.9	19.0	9.8	.187×.020	4.8×0.5
635638 VH	BLUE	16-14	1.5-2.5	6.3	4.9	21.3	9.8	.250×.032	6.3×0.8
633638 VH	YELLOW	12-10	2.5-6.0	6.3	6.6	25.0	13.8	.250×.032	6.3×0.8

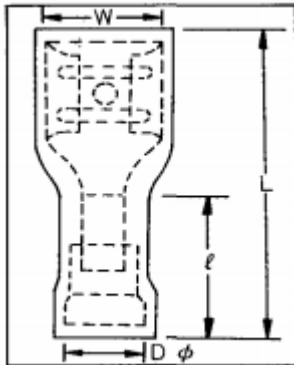

Part No.	Insulation Color.	Wire Range		Dimension				Tab Size	
		AWG	mm ²	W	D ϕ	L	ℓ	AWG	mm
381285 FEH	RED	22-16	0.5-1.5	4.3	4.3	20.0	10.0	.110×.020	2.8×0.5
381288 FEH	RED	22-16	0.5-1.5	4.3	4.3	20.0	10.0	.110×.032	2.8×0.8
381485 VH	RED	22-16	0.5-1.5	6.0	4.3	20.0	10.0	.187×.020	4.8×0.5
381488 VH	RED	22-16	0.5-1.5	6.0	4.3	20.0	10.0	.187×.032	4.8×0.8
381638 VH	RED	22-16	0.5-1.5	8.2	4.3	22.0	10.5	.250×.032	6.3×0.8
385485 VH	BLUE	16-14	1.5-2.5	6.0	4.8	20.6	10.0	.187×.020	4.8×0.5
385488 VH	BLUE	16-14	1.5-2.5	6.0	4.8	20.6	10.0	.187×.032	4.8×0.8
385638 VH	BLUE	16-14	1.5-2.5	8.2	4.8	21.3	10.5	.250×.032	6.3×0.8
383638 VH	YELLOW	12-10	2.5-6.0	7.8	6.0	25.5	13.7	.250×.032	6.3×0.8
383912 VH	YELLOW	12-10	2.5-6.0	11.7	6.0	30.0	13.7	.375×.047	9.5×1.2