

Unit 4

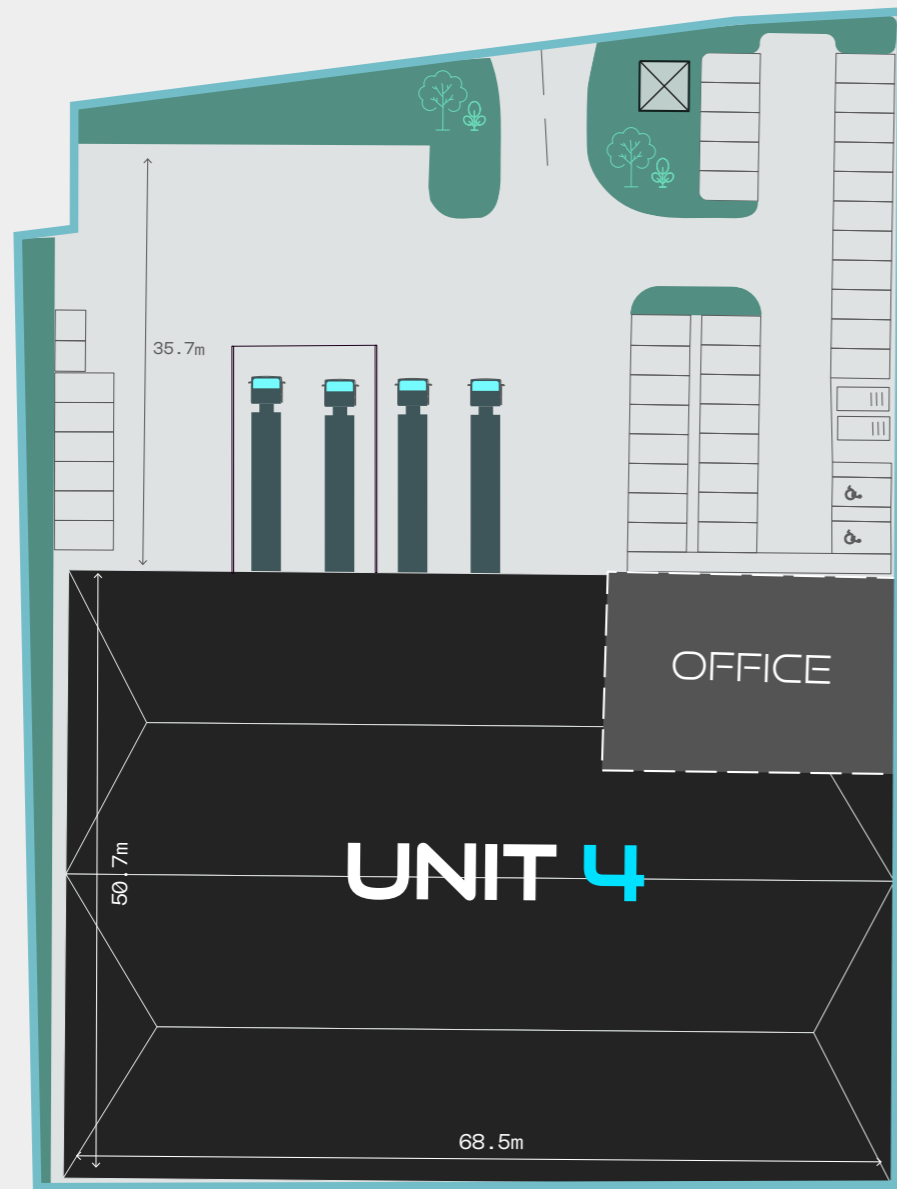

38,728 SQ FT

GROUND FLOOR

4,180 SQ FT

FIRST FLOOR OFFICE

2,186 SQ FT

SECOND FLOOR PLANT

45,094 SQ FT

TOTAL (GEA)

350KVA POWER



AIR / 022



12.5M CLEAR
INTERNAL HEIGHT



2 DOCK LEVEL
LOADING DOORS



2 LEVEL ACCESS
LOADING DOORS



35M
YARD DEPTH



1ST FLOOR
OFFICE



38 CAR
PARKING SPACES



3 EV CHARGING
POINTS



3 PV
PANELS



CYCLE
SHELTERS

BREEAM

BREEAM
'EXCELLENT'

HEATHROW | TW14 8RX

AIR / 023