

# KANAZAWA UNIVERSITY

Campus Life Guide Book

## Get Started!





# KANAZAWA UNIVERSITY HAS BEEN SELECTED FOR WORLD PREMIER INTERNATIONAL RESEARCH CENTER INITIATIVE.



In 2017, Japanese Government “MEXT” selected Kanazawa University for “World Premier International Research Center Initiative (WPI).” MEXT launched WPI in 2007 in a drive to build within Japan “globally visible” research centers with very high research standard and outstanding research environment and has selected 11 institutes so far until now. Having been selected for WPI, KU established the new Nano Life Science Institute and will receive intensive support from the government for the next 10 years.

## C O N T E N T S

A Brief Introduction .....	03
Colleges, Schools, and Graduate Schools .....	04
How to be an International Student of KU? .....	06
What Makes Kanazawa Special? .....	08
Study in Kanazawa .....	10
Living in Kanazawa .....	12
Tuition and Accommodation .....	13
Campus Map .....	14



## Kanazawa University Facts & Figures

1		The 4th Largest Campus in Japan	2,569,686 m <sup>2</sup>
2		Number of Students	10,139
3		International Students	666
4		Enrollment Includes Students from	43 countries/region
5		International Partner Institutions	271
6		Number of Books	1.91 million
7		Number of University Staffs	3,951
8		Budget for 2019 Fiscal Year	57,553 million yen
9		Journal Citation Ranking	18th
10		University Hospital	36 clinics

As of May 1, 2019



# A Brief Introduction of Kanazawa University

1862

## Third oldest university in Japan

Began with a Vaccination Center



1949

## The birth of the new Kanazawa University

Its main campus was located inside Kanazawa Castle. The University soon gained fame around the country as the “university in the castle,” where students could pass through the great castle gate on their way to classes, feeling like samurai warriors.

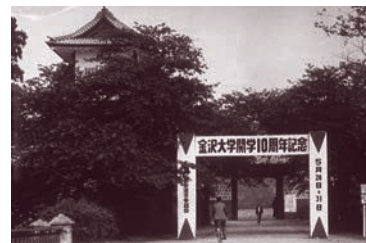

1995

## Kanazawa University Main Campus is relocated to Kakuma



2008

## The faculties system is replaced by 3 colleges and 16 schools

2012

## 150 years since our origin

2018

## The faculties system is reorganized into 3 colleges and 17 schools

# Colleges, Schools, and Graduate Schools

## UNDERGRADUATE

Colleges and Schools		Courses and Departments
College of Human and Social Sciences	School of Humanities	Psychology Program Human Sciences Program Archaeology and Cultural Resource Studies Program History Program Japanese and Chinese Language and Literature Program English and European Languages and Cultures Program Language Science Program
	School of Law	Course in Public Law and Policy Studies Course in Business Law Studies Course in Advanced Legal Studies
	School of Economics	Course in Economics Course in Global Management
	School of Teacher Education	Course in Educational Science Course in Curriculum Studies
	School of Regional Development Studies	Course in Welfare Management Course in Environmental Coexistence Course in Regional Planning Course in Health and Sport Science Course in Tourism and Cultural Heritage
	School of International Studies	Course in Global Studies Course in Japanese Studies Course in Asian Studies Course in American-British Studies Course in European Studies
College of Science and Engineering	School of Mathematics and Physics	Course in Mathematic Course in Physics Course in Computational Science
	School of Chemistry	Course in Chemistry Course in Applied Chemistry
	School of Mechanical Engineering	Course in Mechanical Engineering Course in Mechanical Sciences Course in Energy and Mechanical Systems Engineering
	School of Frontier Engineering	Intelligent Robotics Program Biomechatronics Program Material Design Program Measurement & Control System Design Program Human Eco-System Program Nano-sensing Program
	School of Electrical Information and Communication Engineering	Course in Electrical and Electronic Engineering Course in Information and Communication Engineering
	School of Geosciences and Civil Engineering	Course in Earth and Planetary Science Course in Civil Engineering and Disaster Prevention Course in Environmental and Urban Engineering
	School of Biological Science and Technology	Course in Biosystems Course in Aquatic Biology and Environmental Science Course in Bioengineering
College of Medical, Pharmaceutical and Health Sciences	School of Medicine	
	School of Pharmacy	
	School of Pharmaceutical Sciences	
	School of Health Sciences	Department of Nursing Department of Radiological Technology Department of Laboratory Sciences Department of Physical Therapy Department of Occupational Therapy

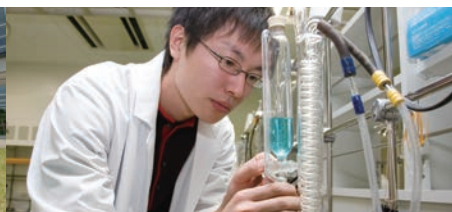



## GRADUATE SCHOOLS

Divisions	Courses		
Graduate School of Human and Socio-Environmental Studies (Master's Level Section of Integrated Course)	<b>Division of Humanities</b>	Human Sciences Course Linguistics and Literature Course	History Course Culture Resources Studies Course
	<b>Division of Economics</b>	Economic Theory and Policy Course Global Community and Economic Course Management Information Course	
	<b>Division of Regional Development Studies</b>	Regional Development Studies Course	
	<b>Division of International Studies</b>	International Relations and Area Studies Course Japanese Education and Japanese Culture Studies Course	
Graduate School of Human and Socio-Environmental Studies (Doctoral Level Section of Integrated Course)	<b>Division of Human and Socio-Environmental Studies</b>	Humanities Course Law and Politics Course Economics and Social Studies Course	
Graduate School of Natural Science and Technology (Master's Level Section of Integrated Course)	<b>Division of Mathematical and Physical Sciences</b>	Mathematics Course Computational Science Course	Physics Course
	<b>Division of Material Chemistry</b>	Chemistry Course	Applied Chemistry Course
	<b>Division of Mechanical Science and Engineering</b>	Mechanical Systems Engineering Course Environment and Human Related Mechanical Systems Course	
	<b>Division of Electrical Engineering and Computer Science</b>		
	<b>Division of Environmental Design</b>		
	<b>Division of Natural System</b>	Biological Science Course Chemical Engineering Course Earth and Environmental Sciences Course	Bioengineering Course
Graduate School of Natural Science and Technology (Doctoral Level Section of Integrated Course)	<b>Division of Mathematical and Physical Sciences</b>	 	
	<b>Division of Material Chemistry</b>		
	<b>Division of Mechanical Science and Engineering</b>		
	<b>Division of Electrical Engineering and Computer Science</b>		
	<b>Division of Environmental Design</b>		
	<b>Division of Natural System</b>		
Graduate School of Medical Sciences (Master's course)	<b>Division of Medical Science</b>	Medical Sciences	
Graduate School of Medical Sciences (Doctoral course)	<b>Division of Medicine</b>		
	<b>Division of Pharmacy</b>		
Graduate School of Medical Sciences (Integrated Course of Master's and Doctoral Levels)	<b>Division of Pharmaceutical Sciences</b>		
	<b>Division of Health Sciences</b>	Clinical Nursing Quantum Medical Technology Physical Therapy	Health Development Nursing Clinical Laboratory Science Occupational Therapy
Graduate School of Advanced Preventive Medical Sciences (Doctoral Course)	<b>Division of Advanced Preventive Medical Sciences</b>		
Graduate School of Frontier Science Initiative	<b>Division of Transdisciplinary Sciences</b>		
	<b>Division of Nano Life Science</b>		
Graduate School of Law	<b>Division of Law and Politics</b>	Research Course	Professional Course
	<b>Division of Legal Affairs</b>		
Graduate School of Professional Development in Teacher Education	<b>Division of Advanced Professional Development in Teacher Education</b>		



# How to be an International Student of KU?

## General Flow Chart of Graduate Admission — Degree and Non-degree (research) Students

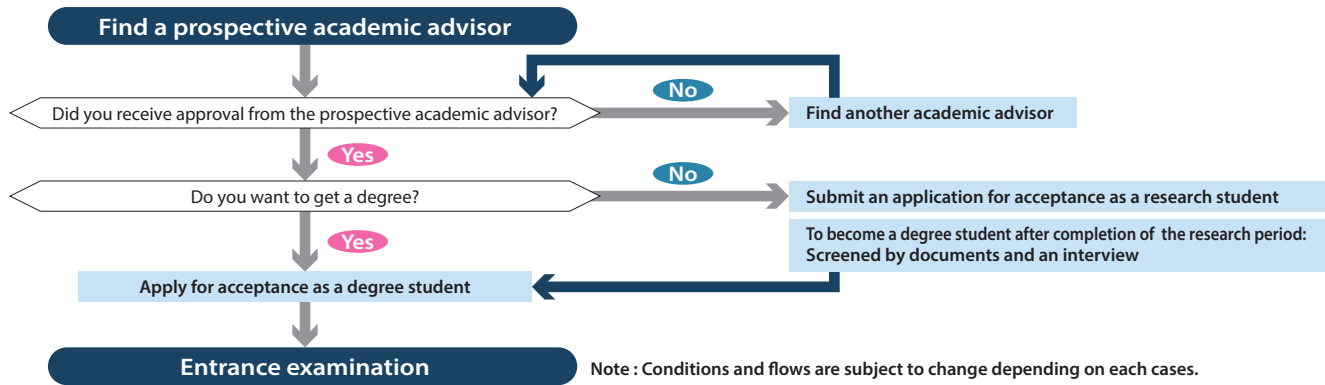









<https://www.adm.kanazawa-u.ac.jp/ie/e/abroad/guideline.html>



## Graduate School's Web Page

You can find the research field that you can carry out at the following website:

<b>Graduate School of Human and Socio-Environmental Studies</b> <a href="http://human-socio.w3.kanazawa-u.ac.jp/en/">http://human-socio.w3.kanazawa-u.ac.jp/en/</a> 	<b>Graduate School of Natural Science &amp; Technology</b> <a href="http://www.nst.kanazawa-u.ac.jp/eng/">http://www.nst.kanazawa-u.ac.jp/eng/</a> 		
<b>Graduate School of Medical Sciences</b> <a href="http://www.med.kanazawa-u.ac.jp/EN/">http://www.med.kanazawa-u.ac.jp/EN/</a> 	<b>Graduate School of Medical Sciences (Pharmacy, Pharmaceutical Sciences)</b> <a href="http://www.p.kanazawa-u.ac.jp/e/">http://www.p.kanazawa-u.ac.jp/e/</a> 	<b>Graduate School of Medical Sciences (Health Sciences)</b> <a href="http://mhs3.mp.kanazawa-u.ac.jp/eng/">http://mhs3.mp.kanazawa-u.ac.jp/eng/</a> 	<b>Graduate School of Advanced Preventive Medical Sciences</b> <a href="http://s-yobou.w3.kanazawa-u.ac.jp/">http://s-yobou.w3.kanazawa-u.ac.jp/</a> 
<b>Graduate School of Frontier Science Initiative</b> <a href="https://gsinfiniti.w3.kanazawa-u.ac.jp/">https://gsinfiniti.w3.kanazawa-u.ac.jp/</a> 	<b>Law School</b> <a href="http://knzwl.w3.kanazawa-u.ac.jp/">http://knzwl.w3.kanazawa-u.ac.jp/</a> 	<b>Graduate School of Professional Development in Teacher Education</b> <a href="https://pdte.ed.kanazawa-u.ac.jp/">https://pdte.ed.kanazawa-u.ac.jp/</a> 	

## Directory of Researchers

You can find your prospective academic advisor at the following website:

[http://ridb.kanazawa-u.ac.jp/public/index\\_en.php](http://ridb.kanazawa-u.ac.jp/public/index_en.php)





## Scholarship

### Japanese Government (MEXT) Scholarship Students

As can be seen in the chart below, there are mainly three types of Japanese government-sponsored scholarships available under the Japanese Government (the Ministry of Education, Culture, Sports, and Science and Technology (MEXT)) Scholarship program to study at Kanazawa University.

Types of Japanese Government (MEXT) Scholarship Students	Research students
	Undergraduate students
	Japanese studies students (Kanazawa University Japanese Language and Culture Program)
Ways to recruit and select	Embassy recommendation Scholarship recipients are recruited and initially screened by a Japanese embassy. Please inquire at the Japanese embassy or consulate general in your country for details.
	University recommendation Research students and Japanese studies students (Kanazawa University Japanese Language and culture program participants) who will be studying as an exchange student from our partner university can be directly recommended as the selected candidates to MEXT.

### Privately Financed Foreign Students

We support privately financed students go gain scholarship granted by Kanazawa University Foundation or private foundations. Scholarships available to international students are offered by approximately 30 private foundations per year.

<https://www.adm.kanazawa-u.ac.jp/ie/e/abroad/scholarship.html>



### Foreign-government Sponsored Students

When a request for acceptance of a foreign-government sponsored student is made through the Ministry of Education, Culture, Sports, Science and Technology of Japan (MEXT), a foreign government or an embassy of a foreign country, we make a decision regarding the acceptance or non-acceptance, taking into account the applicant's major field.

At present, Kanazawa University receive students who are dispatched from the government of Malaysia, Indonesia, Vietnam, Thailand, Myanmar, etc. Applications and acceptance procedures for international students dispatched from foreign governments, in which the Japanese government is not involved, are the same as for privately funded international students.

Useful Information>>STUDY IN JAPAN



## Exchange Students

Exchange programs are designed for **students from the institutions that have an exchange agreement with Kanazawa University** who intend to study at Kanazawa University for one semester up to one year. While remaining enrolled at their home institutions, they study in a non-degree program at Kanazawa University for the purpose of taking credited classes or participating in independent research under the guidance of a supervisor.

For details, please check the website at <http://kuglobal.w3.kanazawa-u.ac.jp/eg/>



Name of Program	Kanazawa University Exchange Program		Kanazawa University Japanese Language and Culture Program
Contents	<ul style="list-style-type: none"> <li>- Belong to College of Human and Social Sciences (undergraduate), Graduate School of Human and Socio-Environmental Studies or Graduate School of Law</li> <li>- Attend regular curriculum classes of Kanazawa University and/or study in their major field(s) at the graduate school</li> <li>- Can take courses on the Japanese language and on Japanese culture and society and earn credits with these courses</li> </ul>	<ul style="list-style-type: none"> <li>- Belong to College of Science and Engineering, College of Medical, Pharmaceutical and Health Sciences (undergraduate), Graduate School of Natural Science &amp; Technology, or Graduate School of Medical Sciences</li> <li>- Conduct research based on their individual purpose for studying while taking classes on major subjects given in Japanese or English</li> <li>- Can take courses on the Japanese language and on Japanese culture and society</li> </ul>	<ul style="list-style-type: none"> <li>- Belong to School of International Education</li> <li>- Attend upper-intermediate to advanced Japanese language courses, cultural courses examining not only present day Japanese society and culture but also the rich traditional culture of Kanazawa</li> <li>- Conduct a joint research project on multiple languages and cultures with Japanese students</li> <li>- complete a research project on subjects related to Japan</li> <li>- Can be selected as a Japanese Government (MEXT) Scholarship recipient</li> </ul>
Language of Instruction	English or/and Japanese		Japanese
Period	One year or one semester beginning in April or October		One year beginning in October



# What Makes Kanazawa Special?



Kanazawa balances the unique character of its cultural history with the conveniences of a modern city.

## A city of tradition and beauty

Kanazawa began to take shape during the Edo Period (1603-1867) at the hands of the Maeda clan who ruled the region. In its prime, the city was Japan's 4th largest city after Edo, Osaka, and Kyoto, boasting a population of 1,000,000. The heritage and scenic beauty from this prosperous time remain in the city where they continue to attract people from all over world.

This rich culture has permeated the lives of citizen while the policies of the Maeda clan continue to raise citizens' interest in arts and crafts. The multitudes of traditional industries live on in the new generation.



Higashi-chaya District



Pref. Noh Theater

## A city of colleges and students

There are 19 institutions of higher education in the Ishikawa Prefecture, giving it the 2nd highest per capita after Kyoto, and the 5th highest number of university students. This rich academic tradition goes back to the Meiji Period, when the government began opening schools to educate the future elite of the country. Kanazawa University began as the first such institution established on the Sea of Japan, which attracted the brightest and best students in the literary arts.

## A city of comfort and convenience

Ishikawa Prefecture has a population of 1,140,000, and 450,000 call Kanazawa their home. As the capital city located in the center of its prefecture, Kanazawa is the heart of politics, culture, and economics for the Hokuriku Region. The surrounding mountains and oceans afford breathtaking ambiance, while its fresh seafood and indigenous local vegetables tantalize your taste buds.

By opening of Hokuriku Shinkansen, it has been much more improved to reach Kanazawa from Tokyo area.



The Fourth High school Memorial of Cultural Exchange, Ishikawa





Kanazawa Castle Park

## A city rich in the expressions of nature

Kanazawa enjoys four clearly defined seasons that paint the already stunning landscape with vibrant strokes. Springs and summers are pleasant, and the year-round moisture has seeped into the industry, crafts, and culture.



Snow Covered Kenroku-En

## A city rich in tourism and the arts

In January 2009, several government ministries certified Kanazawa and four other cities as Level One Historic Cities. In June of the same year it became the 17th member of the UNESCO Creative Cities Network, the 3rd in Japan after Nagoya and Kobe, for its renaissance in the arts and music. Its professional performing group, the Orchestra Ensemble Kanazawa, has earned high praise for its performances overseas.



Kanazawa 21st Century Museum

## A city of abundant nature and traditional architecture

Another factor that led to the flourishing of traditional culture in Kanazawa is the region's distinctive scenery in each of the four seasons. Seasonal changes keep life interesting — in spring cherry blossoms color the city pink; in summer sweetfish dance in clear streams; in fall crimson foliage resembles swaths of brocade; in winter the world turns white. In addition to two large gently flowing rivers, Saigawa River and Asanogawa River, a network of water canals runs through the city, making a pleasant babbling sound. Because Kanazawa was not damaged by the war, it still has historical and cultural buildings that are over 400 years old. When you stroll around town, you will find old temples, shrines, and merchant houses with lattice doors. Because Kanazawa has many sightseeing spots such as Kenrokuen Garden — one of the three most beautiful gardens in Japan, Kanazawa Castle and samurai houses, it is also a tourist city.



Kanazawa Lacquerware

Kutani Pottery

# Study in Kanazawa

## Integrated Japanese Language Program

### What is the Integrated Japanese Language Program ?

We offer Japanese classes to our undergraduate and graduate students.

In general, all international students enrolled in Kanazawa University are eligible for this program, which is held in each quarter throughout the year. It offers a wide range of classes that cater to all levels of Japanese language ability, from beginners to advanced.

The aim of the IJLP is to improve students' Japanese language ability to help them fit into university and life in Japan. The ultimate goal, of course, is to give them enough language ability to be able to understand lectures in Japanese.

### Eligible Students

Any international students enrolled in Kanazawa University (undergraduates, graduates, research students, auditors, etc.) whose native language is not Japanese are eligible.

### Curriculum

This program consists of comprehensive classes, kanji classes and skill-specific classes. Students can select the appropriate level to fit their needs in each area.

- Comprehensive classes: Seven different levels, from zero (never studied Japanese before) to advanced. Learn Japanese comprehensively in a class that matches your own level.
- Kanji classes: Divided into difficulty levels, students learn how to read and write kanji, and how to use kanji vocabulary.
- Skill-specific classes: A range of classes for the four different skills of "talking," "listening," "writing," and "reading." Students can choose the class that best suits their learning goals and level.

## Advising System

When students encounter problems in their studies, classes, private life, or any other areas, they should feel free to consult their academic advisor, tutor, international student advisor, counselor, students affairs section or related divisions.

Tutors are domestic students who assist international students with their studies, living arrangements, and inter-personal relationships so that they can focus on their studies and social life. For example, tutors offer Japanese language support, help with submitting documents, and advise about life in Japan. They are an invaluable resource for international students getting used to life in Japan. They meet generally once or twice a week. Tutors will be your first friends in Japan!

Kanazawa University supports international students to find employment in Japan through "Hokuriku-Shinshu Employment Promotion Program for International Students." We offer business Japanese language training, career education, internship opportunities, and career counselling to the international students.







## Studies on Japanese Culture and Society

### Outlines

School of International Education offers an opportunity to learn, through hands-on experiences, about the culture and society of Japan in the "Program for the Studies on Japanese Culture and Society".

This program consists of subjects such as Budō (martial arts), Japanese Art Performance and Music, and Pottery. It is open to both international and Japanese students, so that both can interact with each other through coming into contact with the traditional culture and society of Japan and deepening their understanding in terms of both knowledge and experiences.

### Eligible students

- 1) International students who belong to School of International Education
- 2) All other students, international or domestic, from other departments and faculties

## Extracurricular Activities

### Outlines

Extracurricular cultural activities such as Tea Ceremony, and Flower Arrangement are prepared specially for international students who wish to get deeper understanding of traditional Japanese culture. An exhibition showcasing their work is held in July.

### Eligible students

Mainly international students at Kanazawa University





# Living in Kanazawa

## FOOD

**We have everything, from well-stocked supermarkets to ethnic dining.**

Preparing your own meals with the clever use of supermarket ingredients is the basis of a healthy and economic diet. But who wants to eat at home every night? Around campus you'll find no shortage of restaurants that fill you up without emptying your wallet. Make each meal an adventure!



Italian Restaurant

Yakitori Restaurant

Indian Restaurant

Sashimi



Kanazawa Curry

Hanton Rice

## Living Expense

Example of Breakdown per month

• Rent	30,000 yen ~ 50,000 yen
• Utility (Electric/Water/Gas)	around 10,000 yen (depends on the season)
• Food	25,000 yen ~ 30,000 yen
• Other expense	30,000 yen ~ 40,000 yen

## SHOPPING

**Foods stores, apparel shops, electronics stores and pharmacies have your needs covered.**

Foods stores, apparel shops, electronics stores, pharmacies, and hardware stores close to campus have everything you need at affordable prices.



Daily Necessities



Apparel Shop

Electronics Store

Hardware Store

Home Furnishing Store

## DOWNTOWN

**Town guide close to the heart of downtown.**

Getting from campus to where the action is couldn't be easier. Kanazawa's colorful downtown area is the talk of the town.



Kanazawa Station

Musashi

Tatemachi

Kohrinbo

Kohrinbo

## TRANSPORTATION

**A student's best friend!**

Kanazawa University has excellent access by public bus, and there are 3 bus stops on campus. This makes the access to campus very simple.



## HOSPITAL

**Peace of mind in emergency!**



Kanazawa University Hospital

## National Health Insurance

All foreign nationals who stay in Japan longer than 3 months are required to join the National Health Insurance system. This insurance covers about 70% of the medical charges, including hospitalization.



# Tuition and Accommodation

## Tuition and other fees

### Degree Students

Classification	Undergraduate	Graduate	Law school
Examination	17,000yen	30,000yen	30,000yen
Admission	282,000yen	282,000yen	282,000yen
Tuition (Annual)	535,800yen	535,800yen	804,000yen

#### \*Tuition Exemptions

Students enrolled in the graduate programs with financial difficulties but exemplary records are eligible for tuition exemption (complete or partial).

### Non-degree Students

Classification	Credit auditors	Research students
Examination	9,800yen	9,800yen
Admission	28,200yen	84,600yen
Tuition	14,800yen/unit	29,700yen/month

## Accommodation

### List of Accommodations at Kanazawa University

Basically, the period of residence in each accommodation is up to 24 months.

	Name	Location	Housing type	Eligibility for move in	*Fees/month
1	Kanazawa University Student Dormitory "Sakigake"	On Campus (Kakuma)	<ul style="list-style-type: none"> <li>Share house (Single gender housing)</li> <li>8 students share 1 unit (single persons); Shared with students of various nationalities including Japanese.</li> </ul>	<ul style="list-style-type: none"> <li>New international students</li> </ul>	Around 30,000yen - 40,000yen
2	Kanazawa University Student Dormitory "Hokumei"	On Campus (Kakuma)	<ul style="list-style-type: none"> <li>Share house (Single gender housing)</li> <li>5 students share 1 unit (single persons); Shared with students of various nationalities including Japanese.</li> </ul>	<ul style="list-style-type: none"> <li>New international students</li> </ul>	Around 30,000yen - 40,000yen
3	Kanazawa University International House	On Campus (Kakuma)	<ul style="list-style-type: none"> <li>Single Room (with small kitchen, shower and toilet.)</li> </ul>	<ul style="list-style-type: none"> <li>New international students</li> <li>New international researcher (negotiable)</li> </ul>	Around 30,000yen - 40,000yen
4	Ishikawa International Students House (Morinosato Kaikan)	Off Campus (Morinosato)	<ul style="list-style-type: none"> <li>Single room. (Comes with bathroom)</li> <li>Double room is also available. (Mostly for married couple without children)</li> <li>Shared laundry and kitchen</li> </ul>	<ul style="list-style-type: none"> <li>New International Students</li> </ul>	Around 30,000 yen - 40,000yen

\*Fees include room charge, utility fee and internet fee.



KU Student Dormitory "Sakigake"

KU Student Dormitory "Sakigake" LDK



KU International House



KU Student Dormitory "Hokumei"



Ishikawa International Student House "Morinosato Kaikan"

### Private Housing

When you live in Kanazawa, the rent varies according to each housing (by size, location etc.) and the approximate total living cost is around 80,000 yen ~ 100,000 yen per month. Please plan how to cover your living cost financially before coming to Kanazawa.

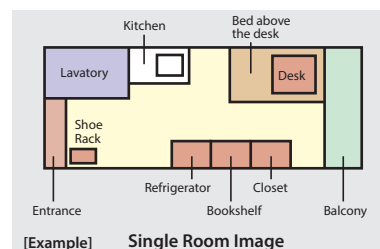

# Kakuma Campus

- College of Human and Social Sciences
- Graduate School of Human and Socio-Environmental Studies
- Law School
- Graduate School of Professional Development in Teacher Education

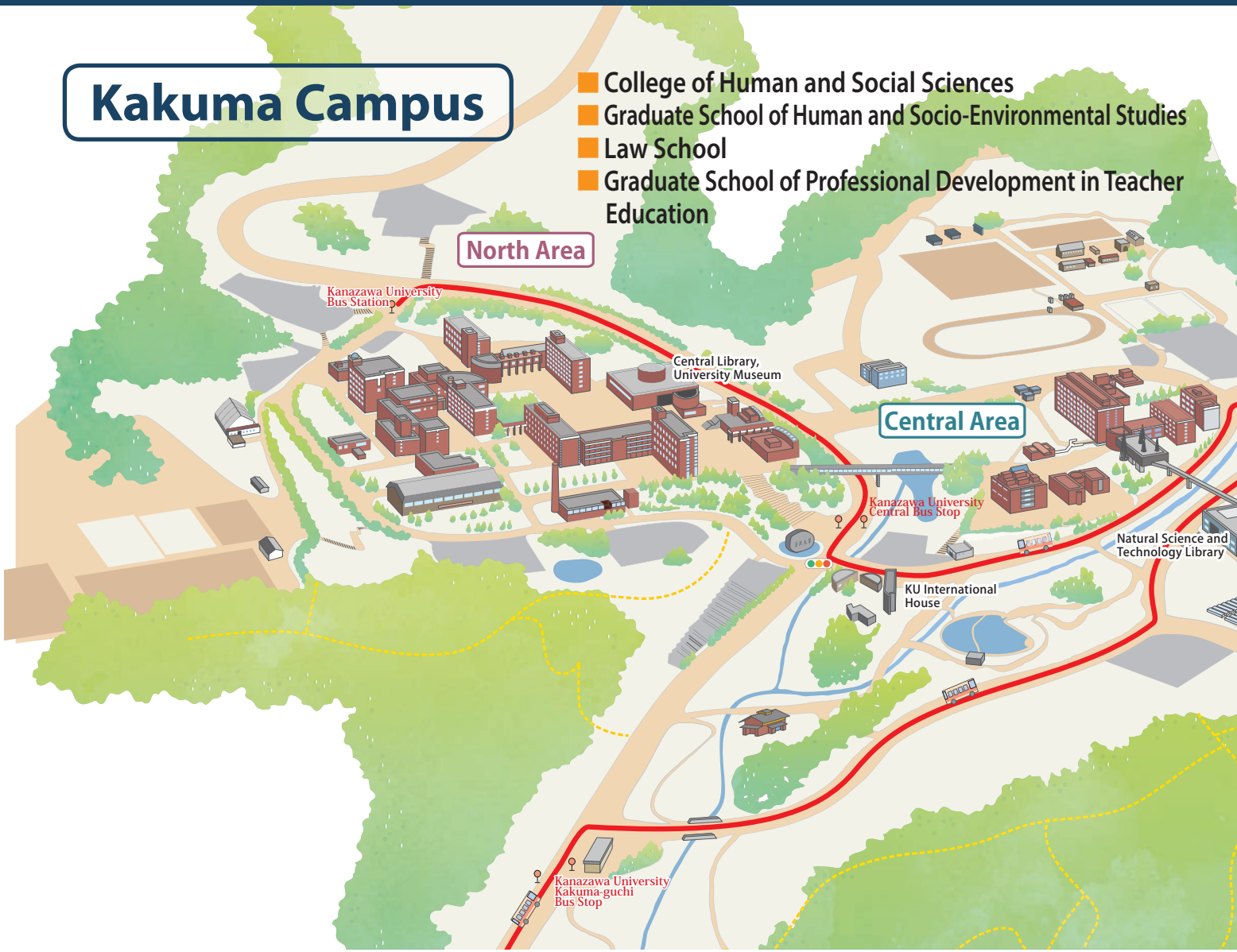

# Takaramachi-Tsuruma Campus

- School of Health Sciences
- Division of Health Sciences

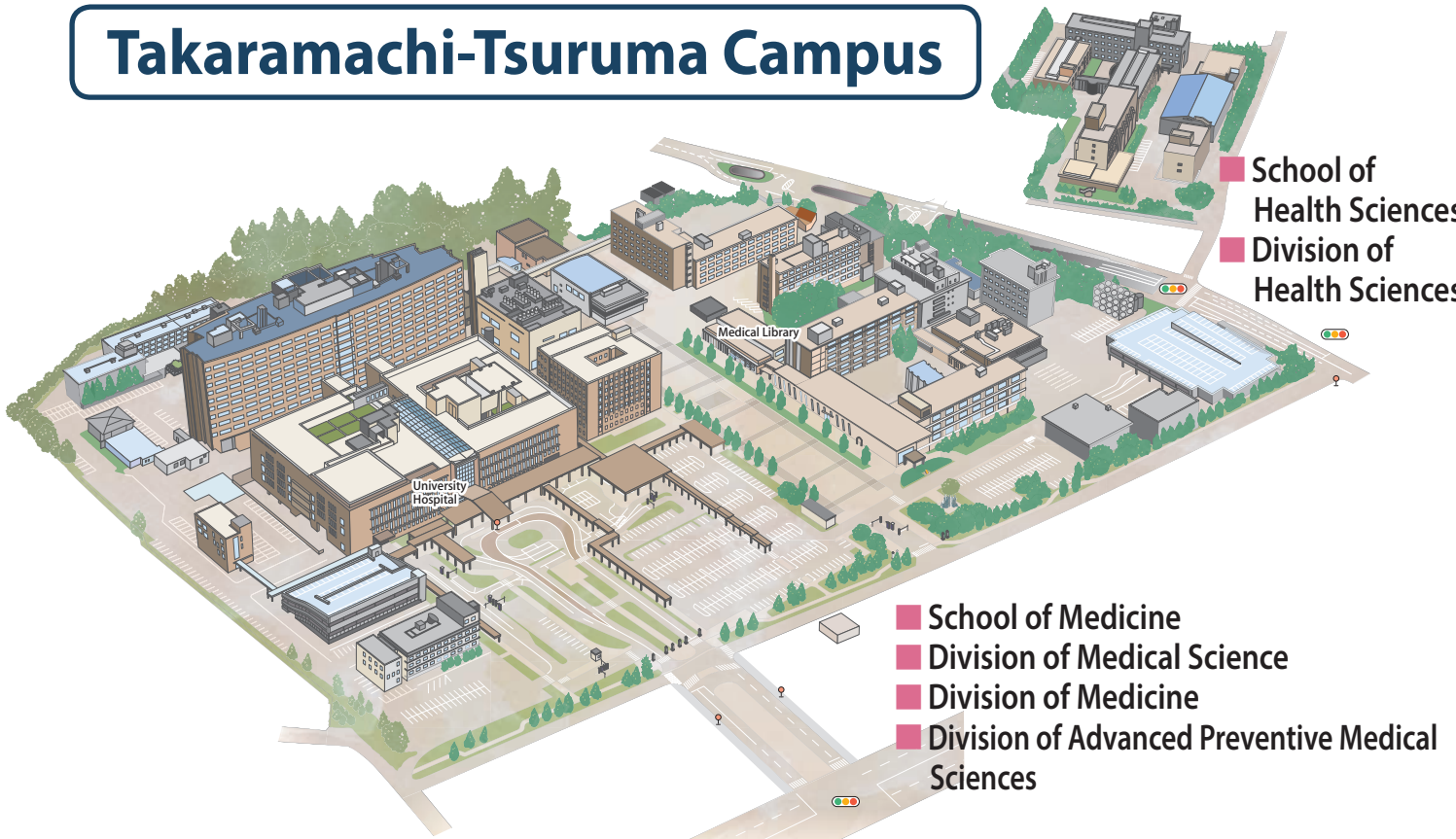

- School of Medicine
- Division of Medical Science
- Division of Medicine
- Division of Advanced Preventive Medical Sciences



- College of Science and Engineering
- Graduate School of Natural Science and Technology
- School of Pharmacy
- School of Pharmaceutical Sciences
- Division of Pharmacy
- Division of Pharmaceutical Sciences

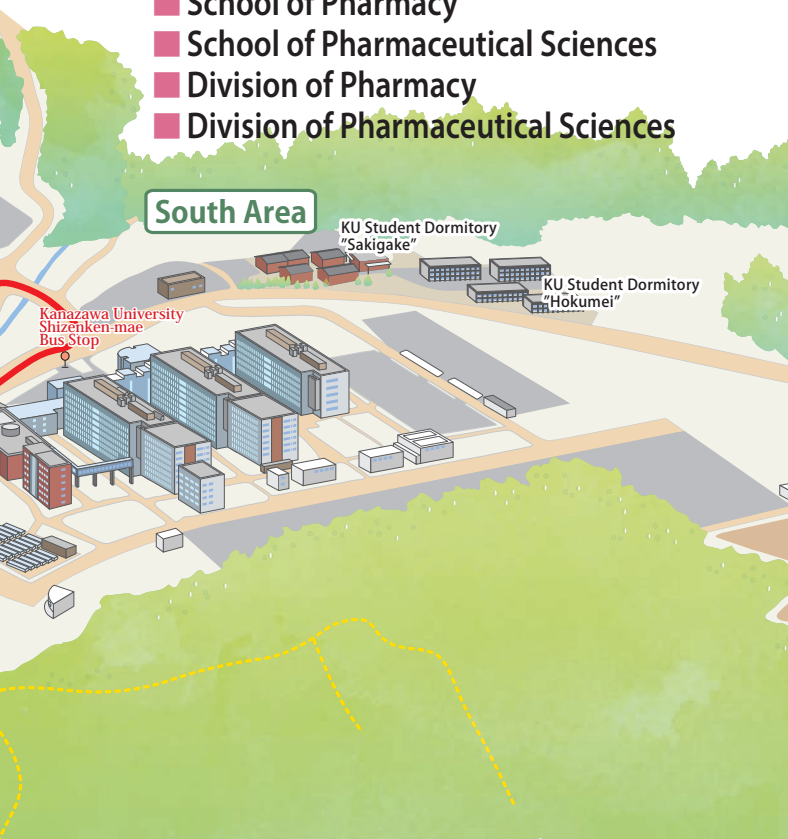

### Access to Kanazawa

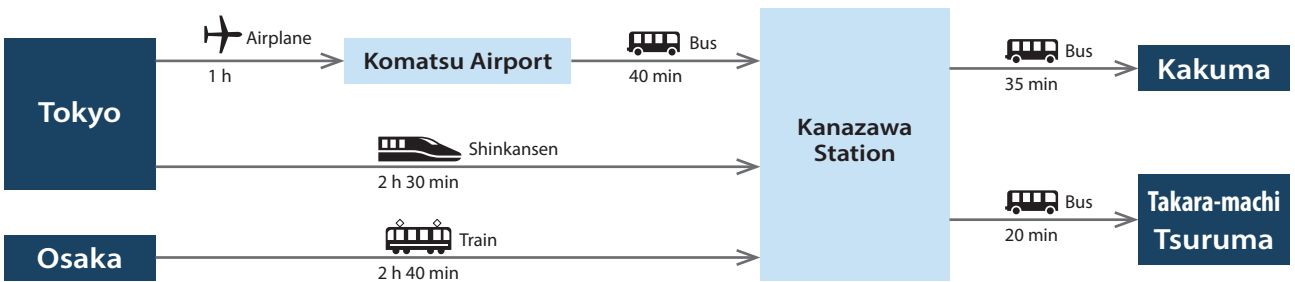



Published by International Relations Department, Kanazawa University  
Kakuma-machi, Kanazawa, Ishikawa 920-1192 Japan  
(International Student Section)  
E-mail : ryukou@adm.kanazawa-u.ac.jp  
(Global Affairs Section)  
E-mail : kokukou@adm.kanazawa-u.ac.jp  
<http://www.kanazawa-u.ac.jp/e/>

<http://sgu.adm.kanazawa-u.ac.jp/>

Issue Date : March, 2020

