

FMD 2012

EMERGENCY PAGING UNIT



Description

FMD 2012 remote microphone station, designed specifically for the VAIE 2250 system, enables live or recorded alert or evacuation messages to be sent out using a controlled microphone on separate zone (up to 12). The leds on the front panel provide the main information on the status of the emergency system and on any failures. Each station must be completed with an additional microphone (not included).

Additional microphones

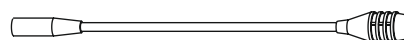

FMG 2000
Dynamic gooseneck



FMH 2000
Dynamic hand-held

References

1. Socket for stem or hand-held microphone.
2. Status-indicator LEDs.
3. Emergency key.
4. Key for interrupting message/failure buzzer.
5. Key for sending out pre-recorded alert message.
6. Key for sending out pre-recorded evac messages.
7. Call key.
8. Key for calling up pre-set messages.

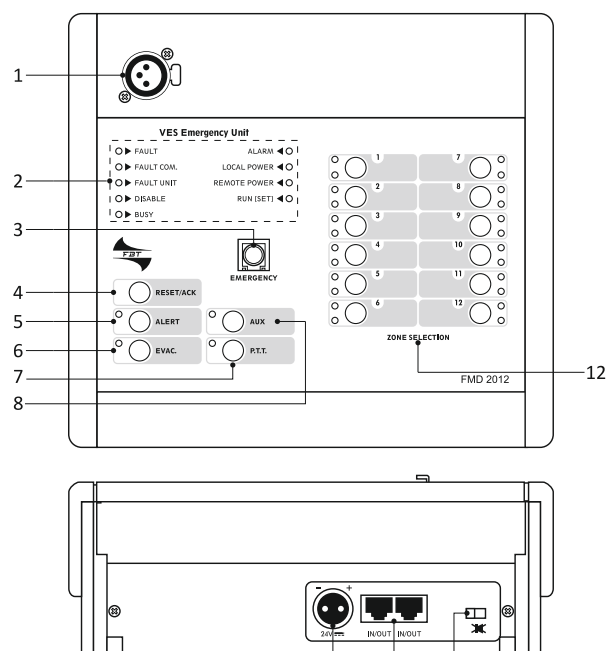

9. Connector for external 24 VDC power supply.
10. IN/OUT connectors.
11. Buzzer switch.*
12. Zone selection keys with status indicator led

(*) For exclusive use of installers, please refer to the instruction manual of the microphone station

**FMD 2012****EMERGENCY PAGING UNIT****Connections**

These stations must be connected to the "EMERGENCY UNITS" connectors of the VAIE 2250 system. It is possible to connect up to 7 remote stations in cascade formation. *

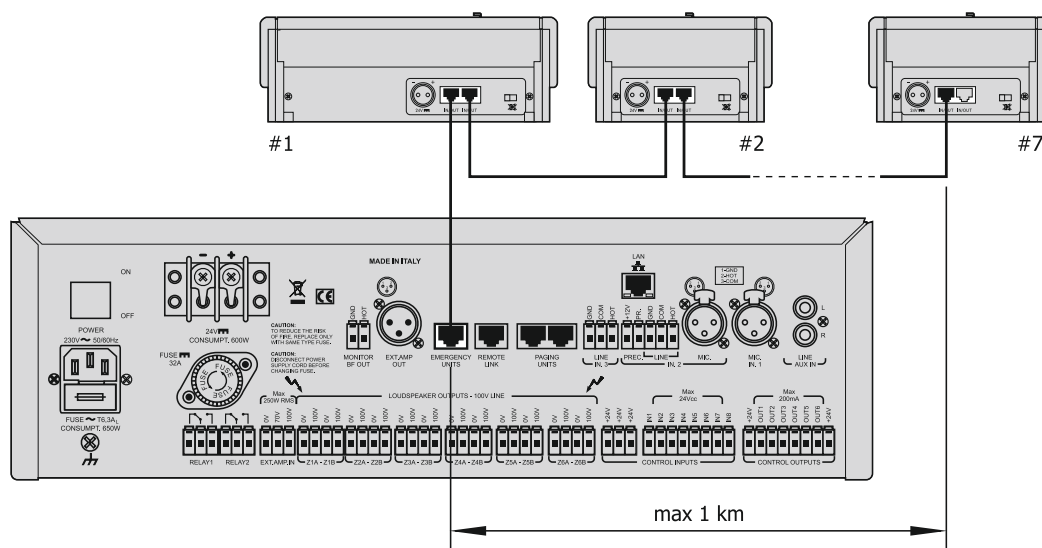

Important: the connections to the stations are made by means of CAT5e SF/UTP shielded cable and a shielded STP connector.

* According to the specifications of each system, it could be necessary to provide an external power supply through the appropriate local socket.

Technical data

N° of zone selectable	12
Power supply voltage	24VDC
Maximum absorption @24Vcc	130mA
Typical output level	300mV
Distortion	<1%
S/N ratio	>60dB
S/N ratio (weighted "A")	>65dB
Frequency response	130 ÷ 19.000Hz
Low cut filter	-3dB / 380Hz
Dimensions (W x H x D)	230 x 80 x 200mm
Net weight	1,55kg

