

CESL 10T

ALUMINIUM WEATHER-PROOF SOUND PROJECTOR

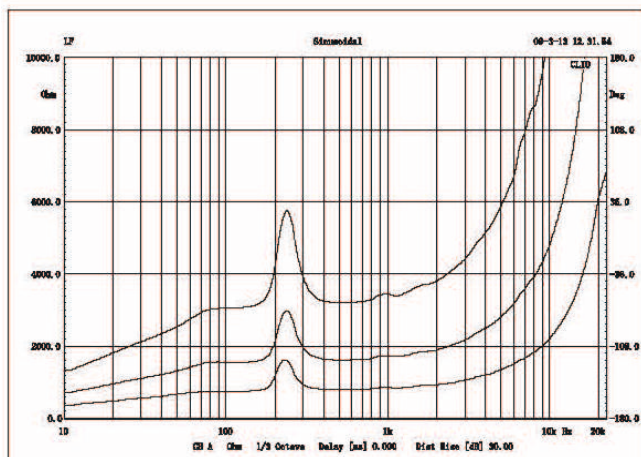
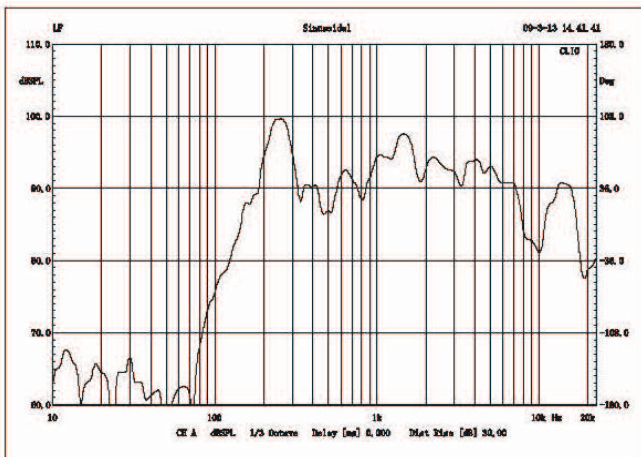
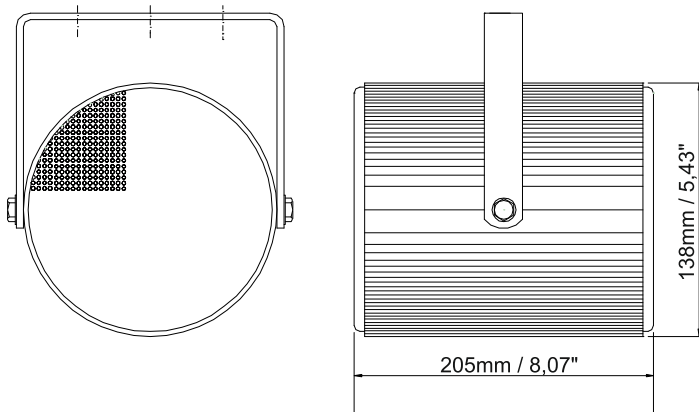

Specifications

GENERAL SPECIFICATIONS

| | |
|---------------------|---------------------|
| Frequency response | 130 - 15Khz |
| SPL | 100dB at 100V 10W/m |
| Sensitivity (1W,1m) | 91±3dB |
| Power handling | 10W |
| Power taps | 2,5W / 5W / 10W |
| Line input | 100V |
| Dimensions | Ø138mm x 205 |

PHYSICAL SPECIFICATIONS

| | |
|-------------------|-----------------------------|
| Material | Aluminum (white RAL 9016) |
| Component | 5" |
| Grill | Powder coated aluminum mesh |
| Finished colour | White RAL 9016 |
| Unit weight | 2,7kg |
| Gross weight | 24kg / 8pcs |
| Packing dimension | 74cm x 38cm x 29cm |

WOOFER SPEAKER SPECIFICATIONS

| | |
|-----------------|-------------------------------|
| Voice coil size | PSV Ø 20,4 x Ø 0,12 x 2 layer |
| DC impedance | 6,8 Ohm |
| Former | Paper |
| Magnet | Ferrite |
| Basket | Iron |
| Cone material | Paper with coating |
| Spider | Cloth |
| Dust cap | Mylar sub cone |
| Net weight | 550gr. |