



# ENERGY VALUE HOUSING AWARD®

A look at design features from the  
nation's elite energy-efficient  
home builders and remodelers

## 2011 WINNERS



**NAHB Research Center**

*In partnership with*

National Association of Home Builders  
U.S. Department of Energy/Building America Program  
National Renewable Energy Laboratory

*in cooperation with sponsors*

**BASF**

Andersen Corporation  
DOW Building Solutions  
SEISCO International Limited  
WaterFurnace International

BuildingGreen, LLC  
DuPont  
The Vinyl Siding Institute  
Whirlpool Corporation



# FERRIER CUSTOM HOMES

## Company Overview

Years in business: 26  
 Average homes built per year: 4  
 Member: Greater Fort Worth Builders Association; Home Builders Association of Greater Dallas

## House Overview

Size: 1,015 s.f.  
 Location: Fort Worth, Texas  
 Construction cost: Not reported  
 Completion date: April 2010



## Hot Climate, Custom Home

According to the EVHA judges, Ferrier Custom Homes creates “excellently crafted homes” in large part due to its meticulous construction management process. As one EVHA judge quipped, the company “could not improve on this process and still have the subcontractors show up.”

Judges further describe Ferrier Custom Homes’ marketing practices as a “blueprint for best practices.” The company’s marketing materials have a unified look and a strong, central theme, “Building Dreams. Saving Energy.” Its visually striking website hosts detailed information on past projects including construction photographs, lists of high performance home features, and testimonials by the homeowners.

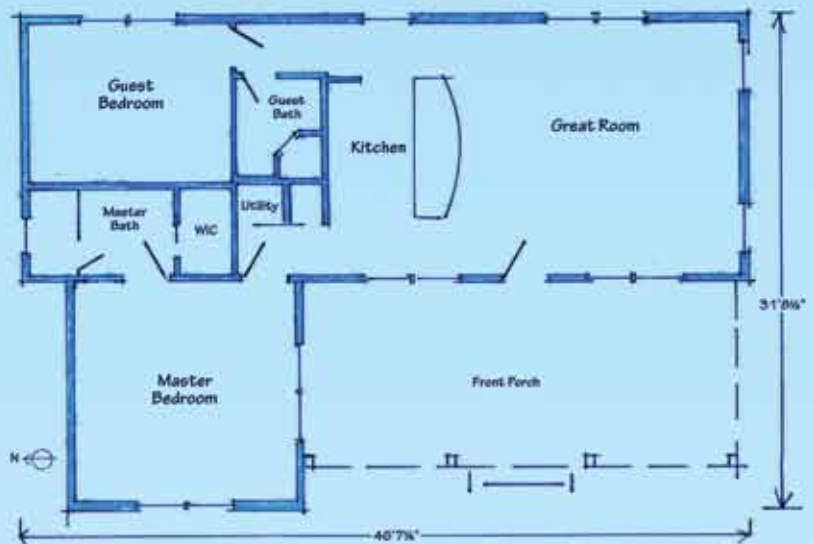



### Energy Features

Foundation: Uninsulated slab-on-grade  
 Wall Construction: Structural Insulated Panels  
 Wall Insulation: R-30  
 Rim Joist Insulation: N/A  
 Roof Construction: SIPs  
 Ceiling Insulation: R-50  
 Windows: Low-e, gas-filled, wood-framed; U-0.29; SHGC 0.19  
 HVAC: 9 HSPF, 18 SEER air source heat pump; Energy recovery ventilation  
 Ducts: Manual D design; All in conditioned space; Minimized duct design with registers at interior walls  
 Water Heating: 0.99 EF tankless electric water heater with PEX distribution  
 Lighting: 100% LED and CFL lighting with advanced lighting controls  
 Appliances: ENERGY STAR refrigerator and dishwasher  
 On-Site Energy Generation: 4-kW wind turbine  
 Duct Leakage Test: 12 cfm total at 25 Pa  
 Blower Door Test: 581 cfm at 50 Pa; 2.12 ACH50  
 HERS Index: 56 without/30 with wind turbine  
 Energy/Green Building Programs: National Green Building Certification Program, Builder's Challenge, ENERGY STAR, LEED for Homes, Green Built Texas





[www.nahbrc.com/evha](http://www.nahbrc.com/evha)

