

- NOTES:
- 1) PixelINK PART NUMBER: 06834-02
 - 2) FINISHED PART SHALL BE RoHS COMPLIANT
 - 3) ALL DIMENSIONS ARE IN MILLIMETERS
 - 4) INTERPRET DRAWING AS PER ASME Y14.5M - 1994
 - 5) REMOVE ALL SHARP EDGES AND BURRS
 - 6) MATERIAL: 2.588MM (0.1019") THK ALUMINUM 5052-H32
 - 7) FINISH: CLEAR IRRIDITE THEN POWDER PAINT WITH SHERWIN-WILLIAMS PA-019J-LT
 - 8) ALL SHEET METAL BENDS SHALL BE 90°, UNLESS OTHERWISE SPECIFIED.
 - 9) FOR IGES MODEL SEE IGES FILE V0510

REVISION		
REV	DESCRIPTION	DATE
01	PROTOTYPE RELEASE	14SEP16

TOLERANCES (UNLESS OTHERWISE SPECIFIED)	
FEATURE	TOLERANCE MM (INCHES)
PUNCHED HOLE	±0.13 [.005]
HOLE TO HOLE OR EDGE	±0.13 [.005]
EDGE TO EDGE	±0.25 [.010]
HOLE OR EDGE TO FOLD	±0.25 [.010]
FOLD TO FOLD	±0.51 [.020]
THREE FOLDS OR MORE	±0.76 [.030]
ANGLES	±1.0°

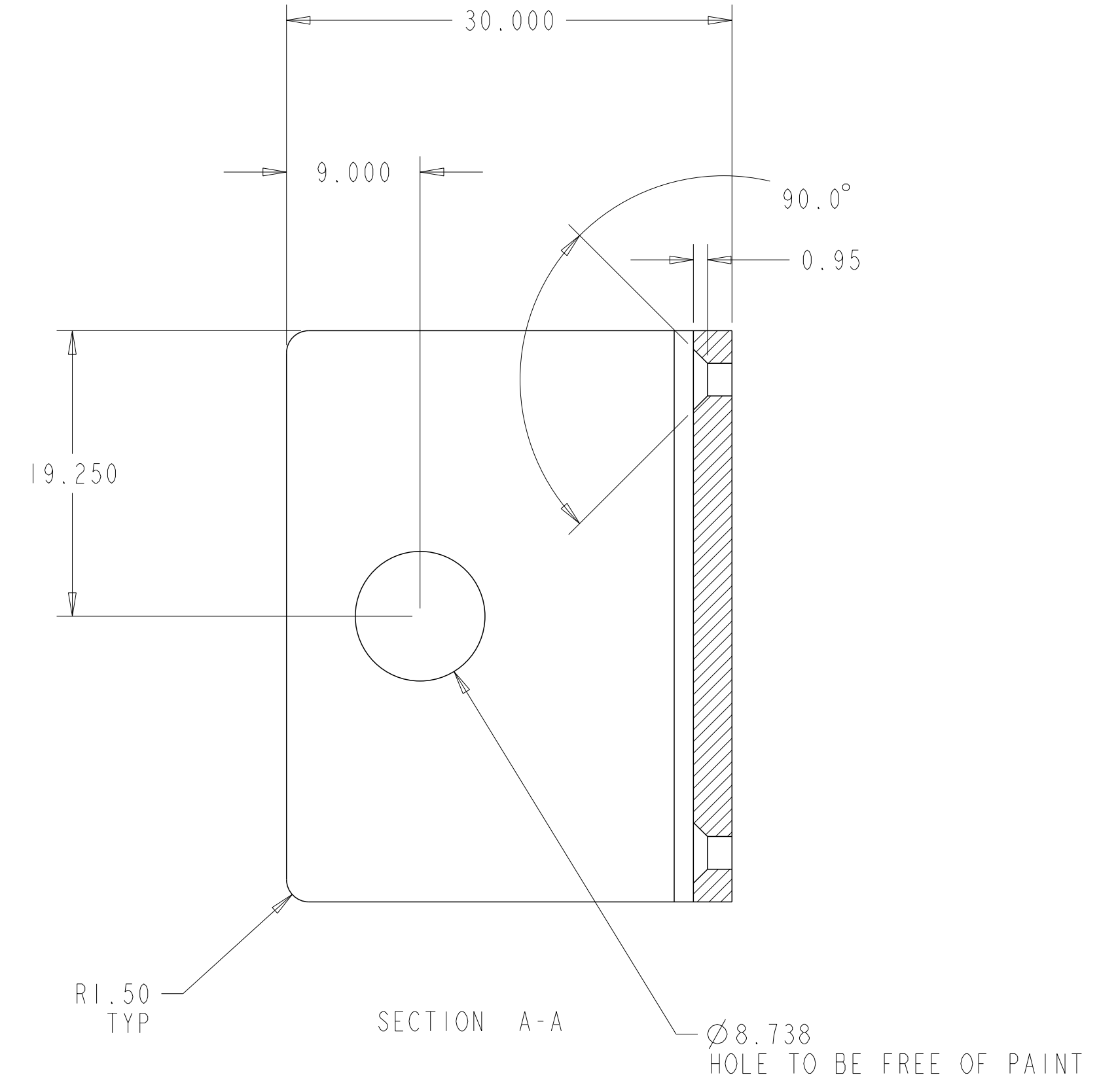
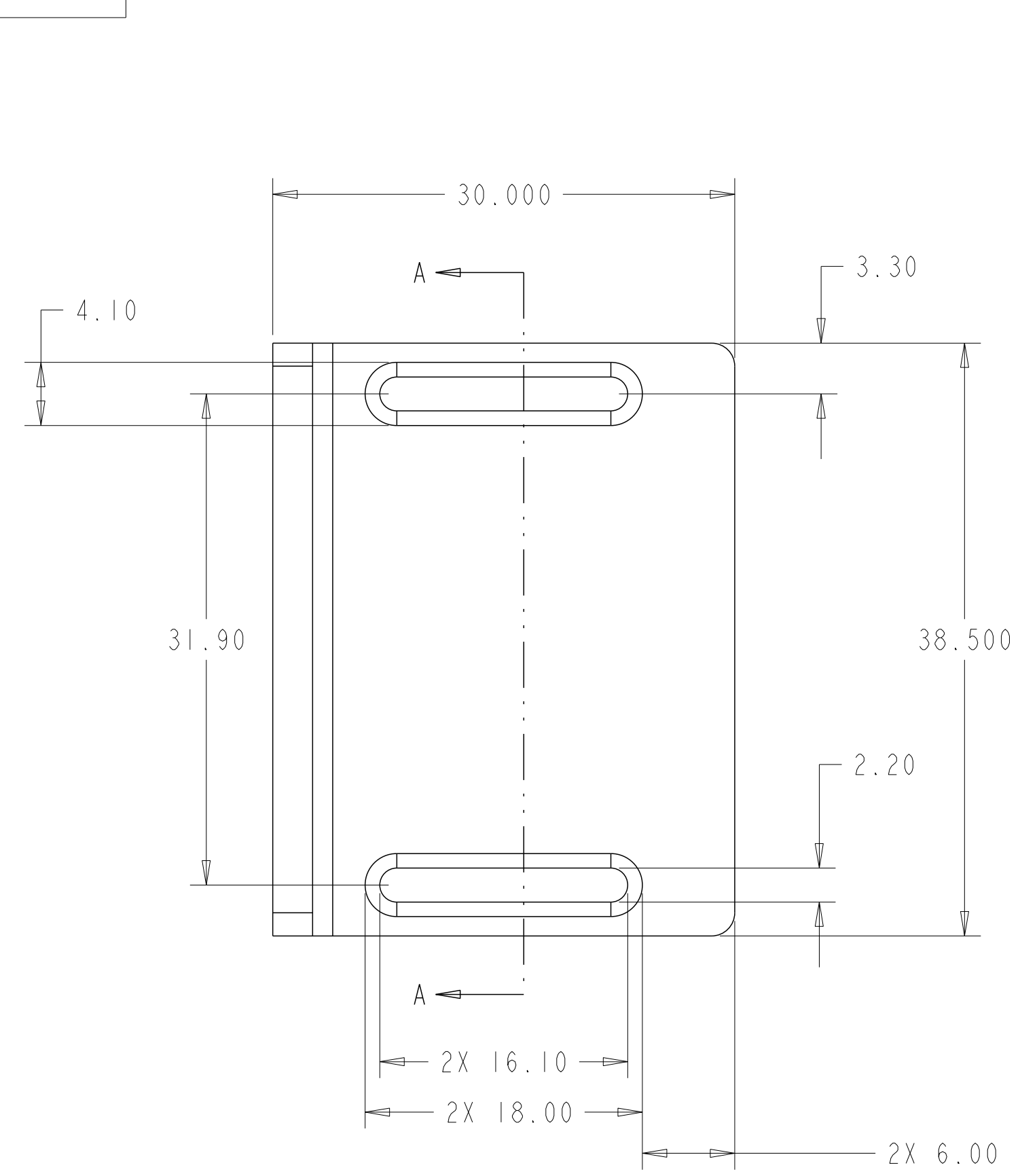

PRESS-FIT PEM
CLS-0420-1
SS 1/4-20 NUT
INSTALL FROM
NEAR SIDE

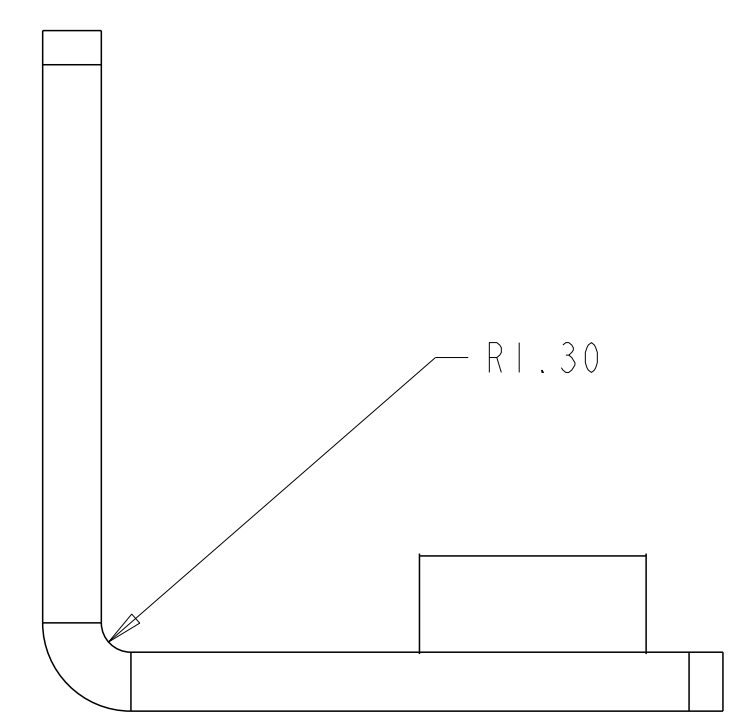
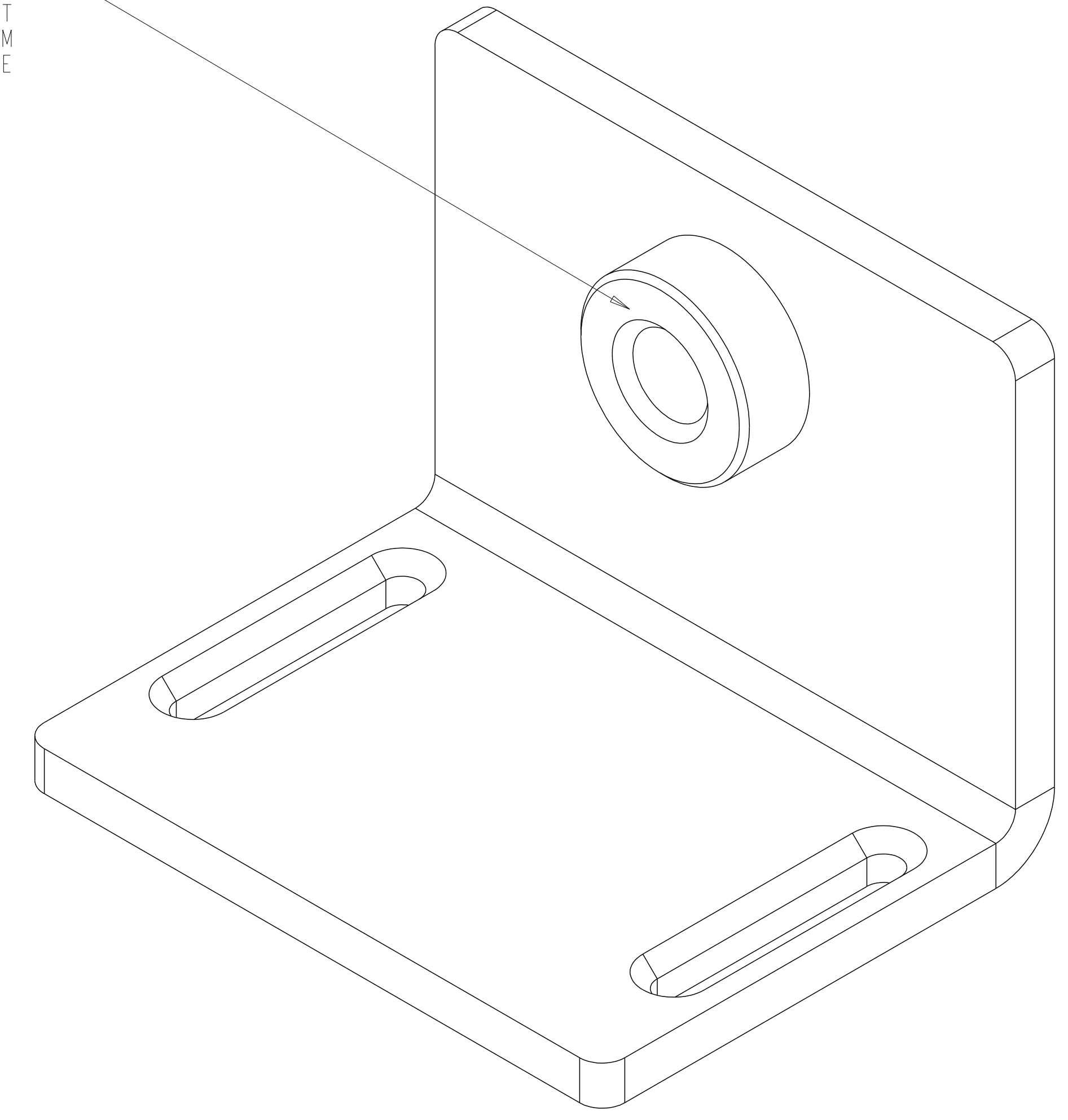

PERMANENTLY MARK PART NUMBER AND REVISION IN APPROXIMATE LOCATION INDICATED, USING .09/.12 HIGH CHARACTERS.

THIS DRAWING CONTAINS CONFIDENTIAL INFORMATION WHICH IS PROPRIETARY TO PixelINK. NO PART OF ITS CONTENTS MAY BE USED, COPIED, DISCLOSED OR CONVEYED TO ANY PARTY IN ANY MANNER WHATSOEVER WITHOUT PRIOR WRITTEN PERMISSION FROM PixelINK.

	DO NOT SCALE DRAWING REMOVE BURRS & SHARP EDGES DIMENSIONS IN MILLIMETERS UNLESS OTHERWISE SPECIFIED	DRW MM 14SEP16	METAK SYSTEMS
	TOLERANCES: .X ± .508 .XX ± .254 .XXX ± .127 ANGLES: +/- 0° 30'	DES MM 14SEP16	
ASSY	MATERIAL SEE NOTES	APR	DRAWING NUMBER: V0510-03
PL-D	FINISH SEE NOTES		SCALE 5.000 SHEET 1 OF 1
PRODUCT			
PL-D			
INITIAL APPLICATION			