



KILLSWITCH™

Foot Switch

USER MANUAL



INDEX

Safety Notice	3
Device Overview	4
Basic Operation	5
Additional Information	6

SAFETY NOTICE

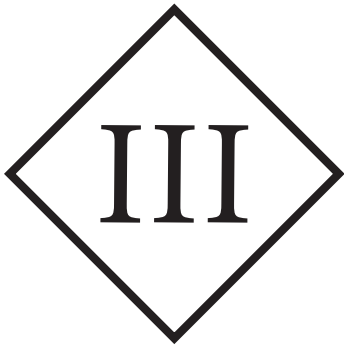
**CLASS III SYMBOL**

A Class III appliance is designed to be supplied from a separated/safety extra-low voltage (SELV) power source. The voltage from a SELV supply is low enough that under normal conditions a person can safely come into contact with it without risk of electrical shock. The extra safety features built into Class I and Class II appliances are therefore not required. For medical devices, compliance with Class III is not considered sufficient protection, and furthermore, stringent regulations apply to such equipment.

TECHNICAL DATA

Charging Voltage:	5 V
Charging Current:	250 mA
Connection:	(1) USB-C
Ambient Temperature:	+10 to +35 °C
Relative Humidity:	30 to 75%
Dimensions (W x H):	92.2 mm x 20.8 mm
Weight:	Approx. 105 g



DEVICE OVERVIEW

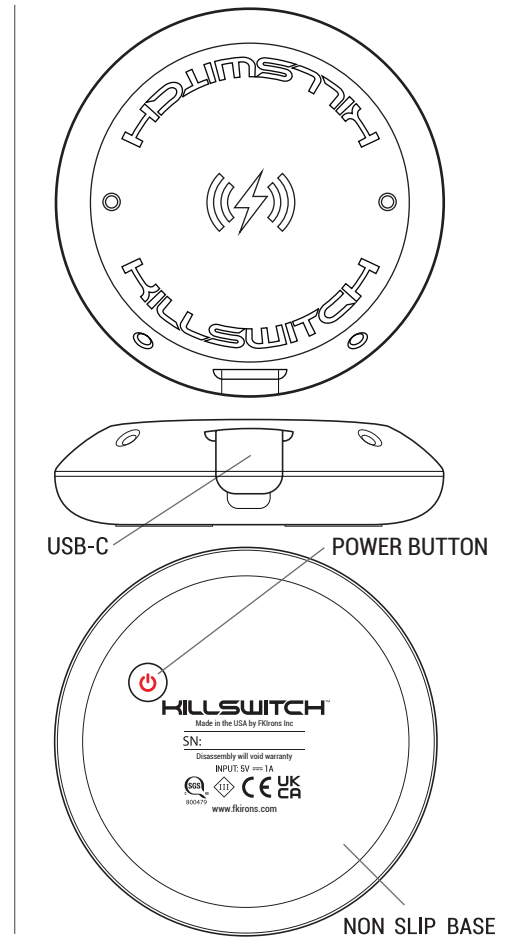

THE KILLSWITCH

Key Features

- Tap to toggle power on the connected device via Bluetooth.
- Long lasting rechargeable battery.
- No moving parts.
- Bluetooth enabled and can be paired with Darklab app for firmware update.*
- LED indicator for battery charge.
- LED indicator for feedback when tapped.
- Power button to turn ON/OFF and reset the device.
- USB-C connector to recharge the battery.
- Non slip surface.

Note: The Killswitch will not connect to the app when another device is connected, and cannot be controlled via the Darklab app. It's only meant to link the device.



Instructions

Pairing: To pair your device, simultaneously press and hold the up and down voltage buttons until LED is pink. When device finds killswitch the led turns blue and when its verified that the device found the killswitch, it will flash green once and then each tap will be blue to verify connection.

To temporarily disable the Killswitch: Press and hold the device power button until LED turns pink, and to reconnect the Killswitch, press and hold Power button until the LED turns Pink.

To desynchronize Killswitch: Simultaneously press and hold the up and down voltage buttons till the LED turns pink and then flashes blue, press voltage down button, once red LED will flash indicating Killswitch is desynchronized.

Pairing with app: Scan for nearby devices, and select the Killswitch to pair.

Pairing Darklab Device: Scan and select the device you wish to be controlled by the Killswitch. On the app's device control screen, select the settings menu, then select Killswitch. Make sure sync is turned on.

The Killswitch will connect to the device that's on, and only one device can be connected at a time. It will disconnect from devices that are OFF or charging.

If you have two LightningBolts, you can pair the same Killswitch to both batteries, however both devices cannot be connected at the same time.

Devices will automatically disconnect from Killswitch when charging.

Note: This device is not waterproof or water resistant. Please ensure no liquids penetrate the device. The use of FK Irons barrier film is highly recommended.

Killswitch operation: Operating the Killswitch is user friendly and easy to use. Just tap the device to toggle power.

Button operation:

Press and hold the power button for 10-15 seconds to turn the Killswitch OFF.

Press and hold the power button for 5-9 seconds to turn the Killswitch ON.

Press and hold the power button for 3-5 seconds to RESET your Killswitch.

Charging operation: Lift rubber plug and connect energized USB-C plug to charge your device. When USB-C is powered, the green LED light will turn ON and remain solid until the battery is completely charged. Once the Killswitch battery is fully charged, the green LED light indicator will turn OFF.

Using a Darklab charger and cable is highly recommended for optimum results. Be sure to charge your machine for 5 hours before use.



ADDITIONAL INFORMATION

WARRANTY

Darklab warrants that the device will perform efficiently when used as intended. Should this product prove to be defective due to manufacturing issues, Darklab will repair/replace the device - free of charge. This warranty will be void if the device shows signs of having been tampered, disassembled, handled roughly, dropped, overexposed to moisture or damage to sensors resulting in compromised functionality.

HANDY TIPS

The following tips will help you get the most out of your Killswitch and avoid potential issues:

- Only use approved power adapters, failure to do so can void your warranty.
- Use only quality cables. A good connection will ensure consistent performance.
- Keep safe using Killswitch approved barrier film. Typical adhesive could interfere with sensors.
- Use only FDA-approved cold sterilization solutions for disinfection.
- **NOT AUTOCLAVABLE.**

ADDITIONAL INFORMATION**TROUBLESHOOTING****1.- Killswitch manufacturer**

FK Irons: 1771 NW 79th Avenue, Doral, Florida 33126

2.- Firmware

It's important to keep the firmware on your Killswitch updated. Download the Darklab App for your I phone to receive updates and notifications about software updates.

For service inquiries, please contact service@fkirons.com.

For additional tips and tutorials, please visit our FK Irons Youtube channel.