

Numerical Summary of (One) and (Six) Year Road Plan

#915 - 358 th St. North of Church Road	Replace arch plate with CBC
#906 - 156 th St. North of Church Road	Replace bridge with CBC
#920 - Mill Rd. East of 108 th St	Replace bridge with CBC
#928 - Bay Road	Replace shoulders on Bay Road
#929 - East Bay Road	Install turn lane
#930 - Oak Hill Road East of 6 th St.	Patch mill overlay
#931 - Cove Road West of 42 nd St.	Patch mill overlay
#887 - East Mill Road	Relocate a portion of East Mill Road and rebuild
#932 - Young Road East of 12 th Ave.	Patch mill overlay
#831 - 27 th Ave South of Murry Rd.	Replace bridge #26305P with triple CMP's
#923 - 66 th St South of Weeping Water Rd	Replace bridge with triple CMP's
#832 - Havelock Ave East of 12 th Ave	Rebuild road and railroad crossing
#924 - 24 th St. South of HWY 34	Place jump span on Bridge #05505
#875 - 66 th St. North of Knabe Dr	Replace bridge #14705P with CBC
#912 - Scenic Drive	Replace bridge
#925 - 334 th St. South of Mckelvie Rd.	Replace bridge with CBC
#926 - Mckelvie Rd. West of 334 th St.	Replace Bridge with CBC
#898 - 322 nd St.t South of Wabash	Replace bridge #02315 with new bridge
#761 - Havelock Ave East of HWY 1	Replace bridge #13015 with concrete box culvert
#899 - Alvo Rd. West of 286 th	Replace closed structure with CMPS's
#933 - Fletcher South of 190 th St.	Replace with new bridge
#934 - Waverly Road East of 310 th St.	Patch mill overlay

CBC- Concrete Box Culvert

CMP- Corrugated Metal Pipe

CASS COUNTY, NEBRASKA

Design: Doreen Amy Dreyer, 876-2200
 Copyright: Doreen Amy Dreyer, 876-2200
 314 West 25th - Fairbury, NE - 68742
 Office: 876-2200
 Doreen Amy Dreyer: 876-2200
 Doreen Amy Dreyer: 876-2200

Legend: Doreen Amy Dreyer, 876-2200
 Copyright: Doreen Amy Dreyer, 876-2200

- Legend for "Year City"**
- 1 - 1 Year
 - 2 - 2 Year
 - 3 - 3 Year
 - 4 - 4 Year
 - 5 - 5 Year
 - 6 - 6 Year
 - 7 - 7 Year
 - 8 - 8 Year
 - 9 - 9 Year
 - 10 - 10 Year
 - 11 - 11 Year
 - 12 - 12 Year
 - 13 - 13 Year
 - 14 - 14 Year
 - 15 - 15 Year
 - 16 - 16 Year
 - 17 - 17 Year
 - 18 - 18 Year
 - 19 - 19 Year
 - 20 - 20 Year
 - 21 - 21 Year
 - 22 - 22 Year
 - 23 - 23 Year
 - 24 - 24 Year
 - 25 - 25 Year
 - 26 - 26 Year
 - 27 - 27 Year
 - 28 - 28 Year
 - 29 - 29 Year
 - 30 - 30 Year
 - 31 - 31 Year
 - 32 - 32 Year
 - 33 - 33 Year
 - 34 - 34 Year
 - 35 - 35 Year
 - 36 - 36 Year
 - 37 - 37 Year
 - 38 - 38 Year
 - 39 - 39 Year
 - 40 - 40 Year
 - 41 - 41 Year
 - 42 - 42 Year
 - 43 - 43 Year
 - 44 - 44 Year
 - 45 - 45 Year
 - 46 - 46 Year
 - 47 - 47 Year
 - 48 - 48 Year
 - 49 - 49 Year
 - 50 - 50 Year
 - 51 - 51 Year
 - 52 - 52 Year
 - 53 - 53 Year
 - 54 - 54 Year
 - 55 - 55 Year
 - 56 - 56 Year
 - 57 - 57 Year
 - 58 - 58 Year
 - 59 - 59 Year
 - 60 - 60 Year
 - 61 - 61 Year
 - 62 - 62 Year
 - 63 - 63 Year
 - 64 - 64 Year
 - 65 - 65 Year
 - 66 - 66 Year
 - 67 - 67 Year
 - 68 - 68 Year
 - 69 - 69 Year
 - 70 - 70 Year
 - 71 - 71 Year
 - 72 - 72 Year
 - 73 - 73 Year
 - 74 - 74 Year
 - 75 - 75 Year
 - 76 - 76 Year
 - 77 - 77 Year
 - 78 - 78 Year
 - 79 - 79 Year
 - 80 - 80 Year
 - 81 - 81 Year
 - 82 - 82 Year
 - 83 - 83 Year
 - 84 - 84 Year
 - 85 - 85 Year
 - 86 - 86 Year
 - 87 - 87 Year
 - 88 - 88 Year
 - 89 - 89 Year
 - 90 - 90 Year
 - 91 - 91 Year
 - 92 - 92 Year
 - 93 - 93 Year
 - 94 - 94 Year
 - 95 - 95 Year
 - 96 - 96 Year
 - 97 - 97 Year
 - 98 - 98 Year
 - 99 - 99 Year
 - 100 - 100 Year
- Legend for "Status of City"**
- 1 - 1 Year
 - 2 - 2 Year
 - 3 - 3 Year
 - 4 - 4 Year
 - 5 - 5 Year
 - 6 - 6 Year
 - 7 - 7 Year
 - 8 - 8 Year
 - 9 - 9 Year
 - 10 - 10 Year
 - 11 - 11 Year
 - 12 - 12 Year
 - 13 - 13 Year
 - 14 - 14 Year
 - 15 - 15 Year
 - 16 - 16 Year
 - 17 - 17 Year
 - 18 - 18 Year
 - 19 - 19 Year
 - 20 - 20 Year
 - 21 - 21 Year
 - 22 - 22 Year
 - 23 - 23 Year
 - 24 - 24 Year
 - 25 - 25 Year
 - 26 - 26 Year
 - 27 - 27 Year
 - 28 - 28 Year
 - 29 - 29 Year
 - 30 - 30 Year
 - 31 - 31 Year
 - 32 - 32 Year
 - 33 - 33 Year
 - 34 - 34 Year
 - 35 - 35 Year
 - 36 - 36 Year
 - 37 - 37 Year
 - 38 - 38 Year
 - 39 - 39 Year
 - 40 - 40 Year
 - 41 - 41 Year
 - 42 - 42 Year
 - 43 - 43 Year
 - 44 - 44 Year
 - 45 - 45 Year
 - 46 - 46 Year
 - 47 - 47 Year
 - 48 - 48 Year
 - 49 - 49 Year
 - 50 - 50 Year
 - 51 - 51 Year
 - 52 - 52 Year
 - 53 - 53 Year
 - 54 - 54 Year
 - 55 - 55 Year
 - 56 - 56 Year
 - 57 - 57 Year
 - 58 - 58 Year
 - 59 - 59 Year
 - 60 - 60 Year
 - 61 - 61 Year
 - 62 - 62 Year
 - 63 - 63 Year
 - 64 - 64 Year
 - 65 - 65 Year
 - 66 - 66 Year
 - 67 - 67 Year
 - 68 - 68 Year
 - 69 - 69 Year
 - 70 - 70 Year
 - 71 - 71 Year
 - 72 - 72 Year
 - 73 - 73 Year
 - 74 - 74 Year
 - 75 - 75 Year
 - 76 - 76 Year
 - 77 - 77 Year
 - 78 - 78 Year
 - 79 - 79 Year
 - 80 - 80 Year
 - 81 - 81 Year
 - 82 - 82 Year
 - 83 - 83 Year
 - 84 - 84 Year
 - 85 - 85 Year
 - 86 - 86 Year
 - 87 - 87 Year
 - 88 - 88 Year
 - 89 - 89 Year
 - 90 - 90 Year
 - 91 - 91 Year
 - 92 - 92 Year
 - 93 - 93 Year
 - 94 - 94 Year
 - 95 - 95 Year
 - 96 - 96 Year
 - 97 - 97 Year
 - 98 - 98 Year
 - 99 - 99 Year
 - 100 - 100 Year

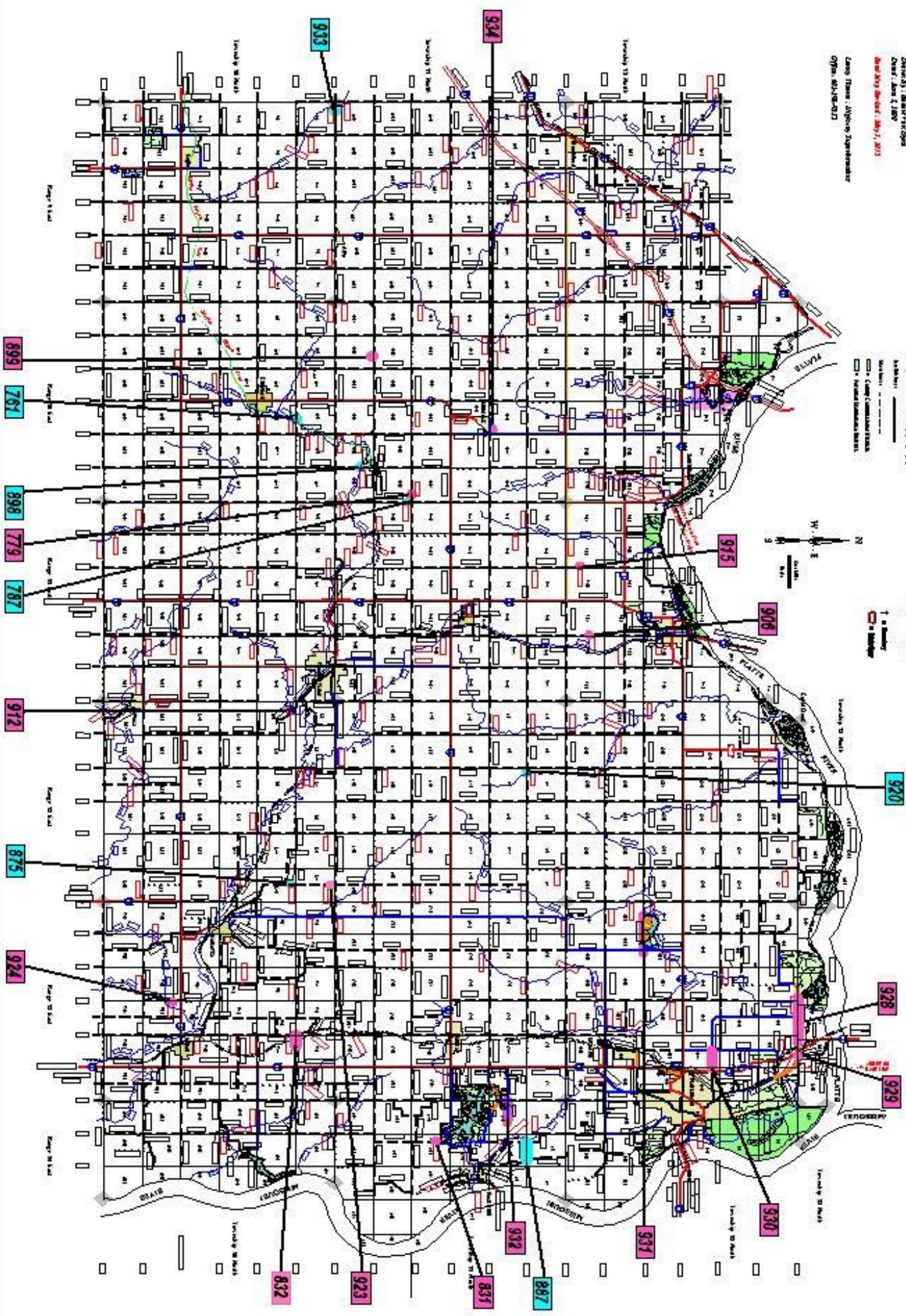

Cass County One & Six Year Road Plan

1 Year Road Plan Ending March 31, 2023
 6 Year Road Plan Ending March 31, 2028