

# VELANTOCOMFORT+

BACK TO WALL SUITE

CODE: VT1100

**gallaria**

intelligentbathrooms®



- Inclusions**
- ✓ VELANTOCOMFORT+ Back to Wall Suite with Intelligent Bidet Seat
  - ✓ Waste pipes
  - ✓ Water filter
  - ✓ Check valve/ball valve & inlet hose

- Features**
- Fully concealed water & electrical connections (hidden from view)
  - Heated seat
  - Instantly heated water 35°C-38°C
  - Self-cleaning shower spray nozzle with rear and woman's wash functions
  - Easy to use control knob to adjust and control wash
  - Adjustable flush volume
  - Aerated wash stream
  - Soft close seat
  - 5 Year warranty (2 years parts & labour)
  - IPX4 Waterproof rating

**Note** This intelligent toilet is fitted with an integrated high hazard backflow prevention device that complies with the installation standards outlined in AS/NZS 3500.1 without the need for a RPZ valve.

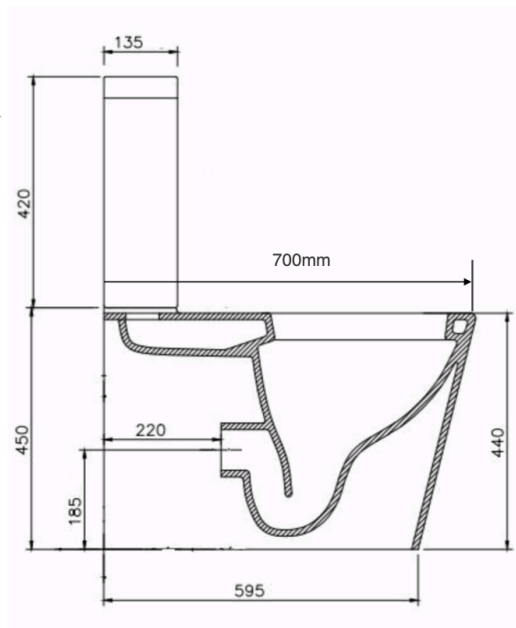
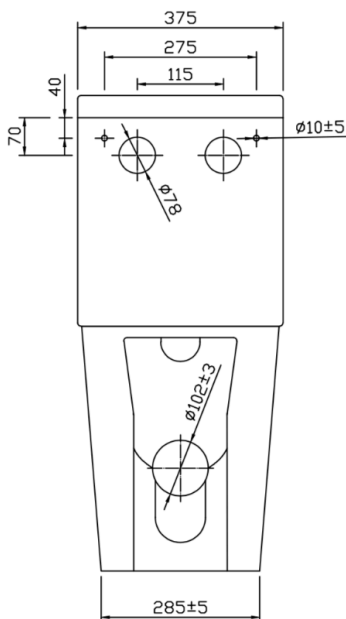

### Notes for the installer

Connection to rain water or grey water is not recommended. It should only be operated with potable/drinking water.

Standard setout: 80-170mm

Other vario-bend setout options:

90-170mm - code: XLDFB09

170-240mm - code: XLDFBQP

The maximum water pressure for water supply is 500kpa.

Power supply requirements: Dedicated 10A min, 220~240V AC, 50/60Hz supply

The water filter has a service life of approximately 6 months.

WELS: 0016  
WM: 030025

## WATER & ELECTRICAL CONNECTION DETAILS

### IMPORTANT

ALL ELECTRICAL CONNECTIONS MUST BE INSTALLED BY A QUALIFIED ELECTRICIAN IN ACCORDANCE TO AS/NZS 3000.

The electrical components must be protected by a 10A Residual Circuit Breaker/RCD and a 10A magnothermic switch. Both switches **MUST** be located outside of the bathroom.

