

DETAIL B
SCALE: 1 : 10

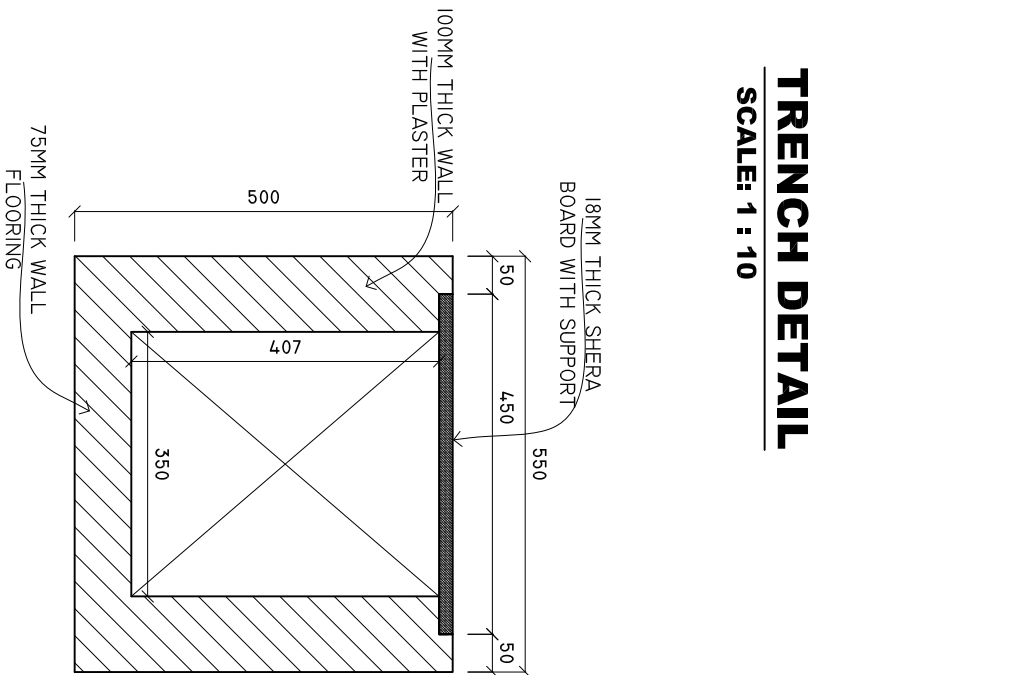

NOTE:ALL THE INTERNAL SURFACE TO BE APPLIED WITH WATERPROOF COATING. WATERPROOF COATING TO BE APPROVED BY CLIENT BEFORE APPLYING.

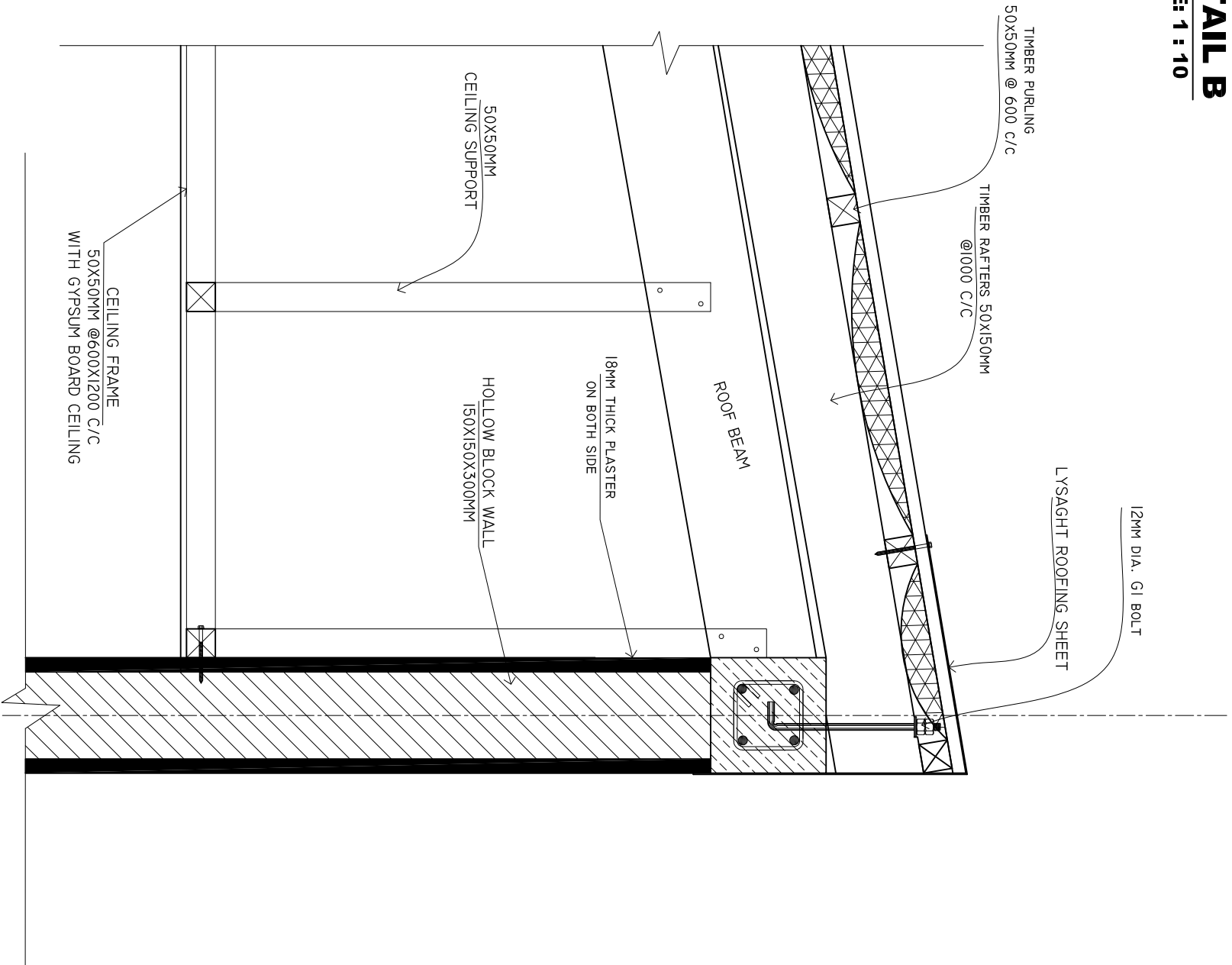

SHEET CONTENTS :

REVISION NOTES:

PROJECT:
CONSTRUCTION OF
PLANT HOUSE AT F.
NILANDHOO ATOLL
HOSPITAL

CLIENT:

MINISTRY OF HEALTH

LOCATION:

F . NILANDHOO

CONTENTS: AS GIVEN

PROJECT MANAGER:

DESIGNER: ARIZ

CIV/STR. ENGINEER:

SURVEYED BY: -

DRAWN BY: ARIZ

CHECKED BY:

DATE : OCTOBER 2022

SHEET NO. : /



ADMIN DIVISION
Ministry of Health
Roshanee Building
Saanu Maagu
Tel: 332 8887, Fax: 3328889