

بِسْمِ اللّٰهِ الرَّحْمٰنِ الرَّحِیْمِ



ދިވެހިރާއްޖޭގެ ޖުމްހޫރިއްޔާ ގުޅިގެން

މިއަހަރުގެ ސަރުކާރުގެ ސަލާމަތުގެ ދުވަހުގެ ރަސްމީ ދަލީގެ ގޮތުގައި

މިއަހަރުގެ ސަރުކާރުގެ ސަލާމަތުގެ ދުވަހުގެ ރަސްމީ ދަލީގެ ގޮތުގައި

މިއަހަރުގެ ސަރުކާރުގެ ސަލާމަތުގެ ދުވަހުގެ ރަސްމީ ދަލީގެ ގޮތުގައި

މިއަހަރުގެ ސަރުކާރުގެ ސަލާމަތުގެ ދުވަހުގެ ރަސްމީ ދަލީގެ ގޮތުގައި

(IUL)483/1/2022/23

މިއަހަރުގެ ސަރުކާރުގެ ސަލާމަތުގެ ދުވަހުގެ ރަސްމީ ދަލީގެ ގޮތުގައި

މިއަހަރުގެ ސަރުކާރުގެ ސަލާމަތުގެ ދުވަހުގެ ރަސްމީ ދަލީގެ ގޮތުގައި

މިއަހަރުގެ ސަރުކާރުގެ ސަލާމަތުގެ ދުވަހުގެ ރަސްމީ ދަލީގެ ގޮތުގައި

މިއަހަރުގެ ސަރުކާރުގެ ސަލާމަތުގެ ދުވަހުގެ ރަސްމީ ދަލީގެ ގޮތުގައި

މިއަހަރުގެ ސަރުކާރުގެ ސަލާމަތުގެ ދުވަހުގެ ރަސްމީ ދަލީގެ ގޮތުގައި

Annex 1 - (Minimum Requirements)

1. 48 Port Gigabit Manageable POE Switch

Units	1
Ethernet Ports	48x 10/100/1000
Power	100 to 240VAC
Other Requirements	Minimum 1-year warranty and Hardware support.

2. Wi-Fi Access Point

Units	2
Ports	GbE RJ45 port
Features	802.3ac Wave 1 Wi-Fi technology
	5 GHz band with 867 Mbps throughput rate
	2.4 GHz band with a 450 Mbps throughput rate
	Signal transmission up to 183 meters (600 feet)
	Powered by 802.3at PoE* or 24V passive PoE
Other Requirements	Minimum 1-year warranty and Hardware support.

3. 9U Wall Mount Rack and Cat6 Patch Panel

- 9U Server Rack Black- WT-2230A-9U (W- 600mm / D-540mm)
with 48 Port Cat6 Patch Panel
- Additional 24 Port Cat6 Patch Panel for existing switch

4. Fingerprint & RFID Access Control / T&A Terminal & Non-contact Exit Button



Units	5
Requirement	Fingerprint & RFID Access Control device should be compatible with existing iclock 990 T&A device and ZKTECO T&A Terminal (Model: MA300/ID)
Other Requirements	Minimum 1-year warranty and Hardware support.

5. Network Cabling Requirements

- Floor plan on Annex 2 shows the location of the Network switches, Access Points and End points.
- Network switch 1 (48 Port Gigabit Manageable POE Switch) is to be procured from the vendor.
- Network switch 2 (24 port POE smart switch) will be provided by the office.
- 3 Access points are to be procured from the vendor.
- 9U rack is to be procured from vendor. 6U rack will be provided by the office.
- 2 patch panels for the two network switches are to be procured from the vendor.
- Cables must be labeled clearly with their source and destination at each termination point (to ensure that both the ends of the cable are labeled for identification and traceability)
- Switch to Switch connections should be done using Cat6 outdoor cable. (Approximately 18 feet)

- Switch to devices should be connected using Cat6 outdoor cable. (23 end points from Network switch 1. 17 end points from Network switch 2)
- Cat6 Patch Panel must be installed in the Wall Mount Rack
- Every cable must be tested during installation and termination. If there are any connectivity issues whatsoever, the cable must be identified and replaced. Final test results must be provided.
- Bundle cables that route over the ceiling to the same location together
- Cables running above the ceiling must be run through a conduit
- Ensure termination points to the Patch Panel are arranged and bundled together neatly to ensure clean cabling to switch
- 1M Patch code (Preferable: Black) must be provided to each Network face panel (Which needs to connect to Workstations/equipment) and each point in the patch panel (which needs to connect to Network Switches)

Door Access Controls and Attendance System Requirements

- Installation and configuration of iClock990/ID Fingerprint access control, zk standard. The device will be provided by the office.
- Installation of 2 door access controls devices provided by office. Specifications of the devices are given below.
 - MA300/ID Zk fingerprint access control
 - Stainless Steel Exit Button with LED
 - Back Box-42MM
 - Power Supply 12V 3AH
 - 12V 7.0AH Battery
 - Fail safe electric bolt lock YL100+
- Installation of 3 door access control devices. (With the same technical features and specifications as above)

Annex 2 (Floor plan)

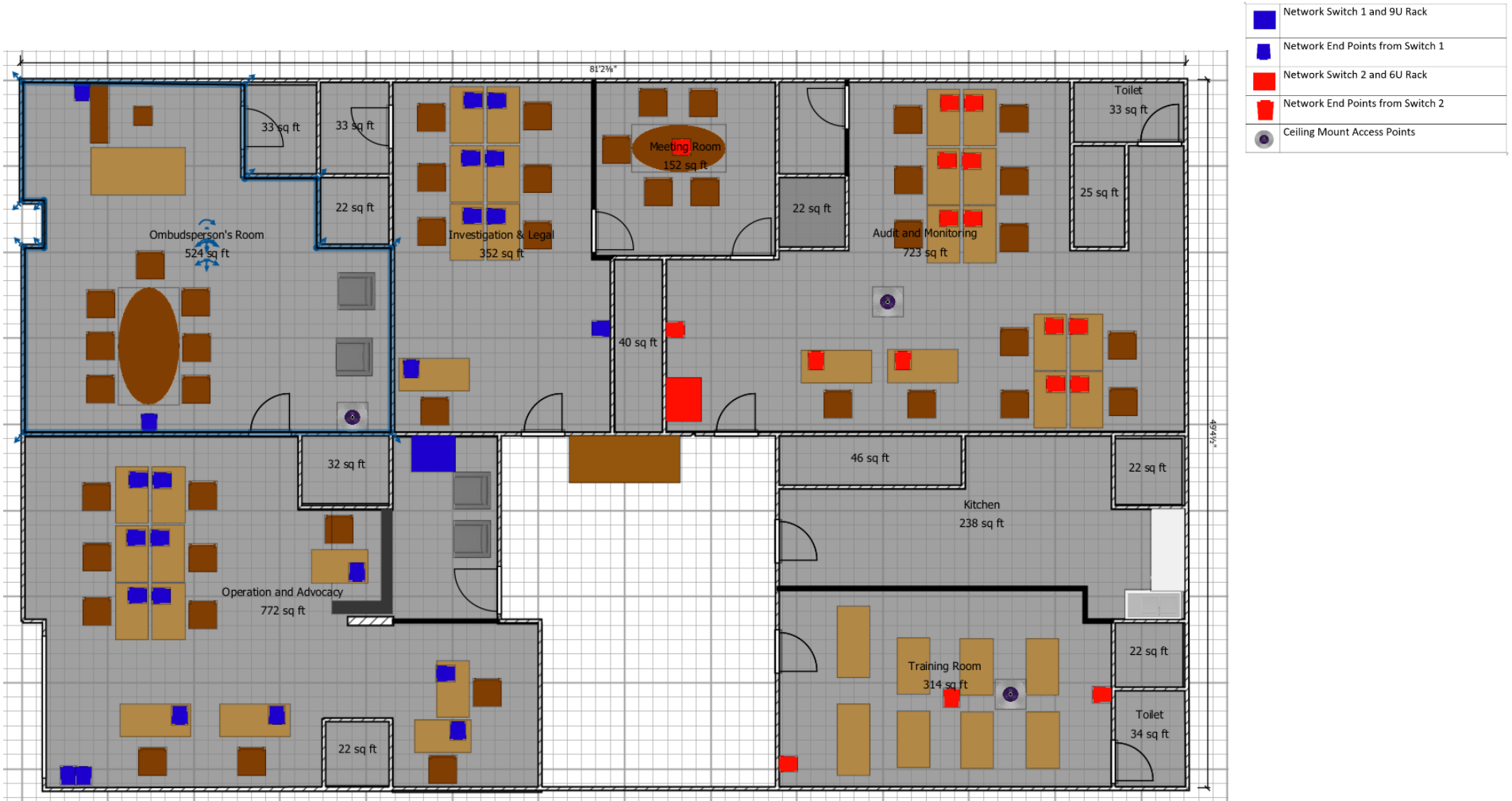

Annex 3: Work schedule

Network set-up work should be carried out as per below schedule.

Phases	Task	Work Completion
Phase 1	<ol style="list-style-type: none"> 1. Installation of 9U Wall Mount Rack 2. Installation of 48 Port Gigabit Manageable POE Switch 3. Laying network cable for 40 end points 4. Installation of Wireless Access Point 5. Installation of 3 door access control devices 	Within 10 Days from the award date.
Phase 2	<ol style="list-style-type: none"> 1. Removal of existing 6U Wall Mount Rack and 24 Port Network switch and Installation in new Office space 2. Removal of Existing 2 (two) Door access Control devices and Installation in new Office space 3. Removal of iClock990/ID Fingerprint access control device and installation and configuration in new Office space 	Within 2-3 Days (before moving to new office space)
Phase 3	<ol style="list-style-type: none"> 1. Connection of 48 Port Gigabit Manageable POE Switch and final configuration 2. Switch to switch connection and configuration 3. Final testing 	1 day (before moving to new office space)