

## Annex 1 Operation of a Hair and Makeup Salon at SME Hub

### 1. INTRODUCTION

Business Center Corporation operates the SME Hub, a commercial space for our SME community. SME Hub is being operated at STO Allied Building, Chaandhanee Magu, Male' City. SME Hub provides a market space with affordable kiosks on monthly contracts for businesses to sell products and services. Additionally, this will be an avenue for home-based workers in certain fields such as literature, gardening, food & beverages, art, crafts, fashion, hair & makeup, and apparel, to expand their businesses to a new level.

- Ground Floor – Garden Café and Bookstore.

An indoor garden with a cafe combined with bookstore, and performance art stage area.

- First Floor & Second Floor - Commercial Salon

Kiosks rented to startups and SME businesses with other facilities.

As such, BCC is seeking an interested party to provide services of a Hair and Makeup Salon on the Second floor of the SME Hub.

### 2. DETAILS OF LEASE

#### 2.1 Operation Salon

- (a) The Hair and Makeup Salon is an approximately 192 Square feet area inside the STO Allied Building Second floor, as outlined in **Attachment 1** of this document.
- (b) The basic structure of the area shall be provided by the BCC along with the necessary furniture.
- (c) Utilities and garbage disposal fees are included in the lease fee. For clarification, utilities include Supply of water only. Tenant must bear electricity expenses.

#### 2.2 Minimum Lease Amount

- (a) The base price of lease per month which can be proposed for this bid shall be MVR 15,000 (Fifteen Thousand Rufiyaa)

#### 2.3 Security Deposit

- (b) The successful bidder shall be required to pay a security deposit of MVR 30,000 (Thirty Thousand Rufiyaa) which shall be payable upon signing the Agreement, and can be paid in two monthly installments.

## **2.4 Commencement of Operations**

- (a) The maximum duration which shall be allowed for the successful bidding party to commence operations after award of lease shall be 15 calendar days.

## **2.5 Lease Duration**

- (a) The area will be leased for a period of 2 (two) years

## **2.6 Minimum Requirement of bidders**

- (a) Bidders applying to operate the Salon shall be registered at the Ministry of Economic Development as an MSME.

## **2.7 Exclusions and Limitations**

- (a) Smoking is prohibited within the SME Hub.

## **2.8 Operational Hours**

- (a) The services of the Salon must be provided during the times which SME Hub is operational.

## **3. RESPONSIBILITIES OF THE TENANT**

- (a) It is the responsibility of the tenant to acquire and maintain all necessary permits and license for the operation of this Salon during the period of the lease.
- (b) It is the responsibility of the tenant to supply and install all equipment required for the operation of the area.
- (c) It is the responsibility of the tenant to adequately clean and maintain the area and the tenant shall be responsible for the disposal of all waste generated by the Salon.
- (d) It is responsibility of the tenant to collaborate with BCC on all promotional activities of SME Hub

## **4. BUSINESS PLAN**

- 4.1. A feasible proposed business plan for the operation of the Salon must be submitted by the bidding parties along with the bid, which should in the very least cover the below areas:
  - (a) Executive Summary
  - (b) Introduction
  - (c) Management and Staffing Plan
  - (d) Operational Plan (*The proposed Services must be included*)
  - (e) Financial Overview
  - (f) Marketing Plan

## **5. STANDARDS OF REQUIREMENT**

- 5.1 The services must be available to customers during at all times during the operational hours in alignment with the services of SME Hub.
- 5.2 All employees of the tenant shall be trained well in the provision of relevant services, shall be groomed for such services and during official hours shall wear adequate attire.

ATTACHMENT 1 \_SME HUB SECOND FLOOR PLAN

Hair and Makeup Salon

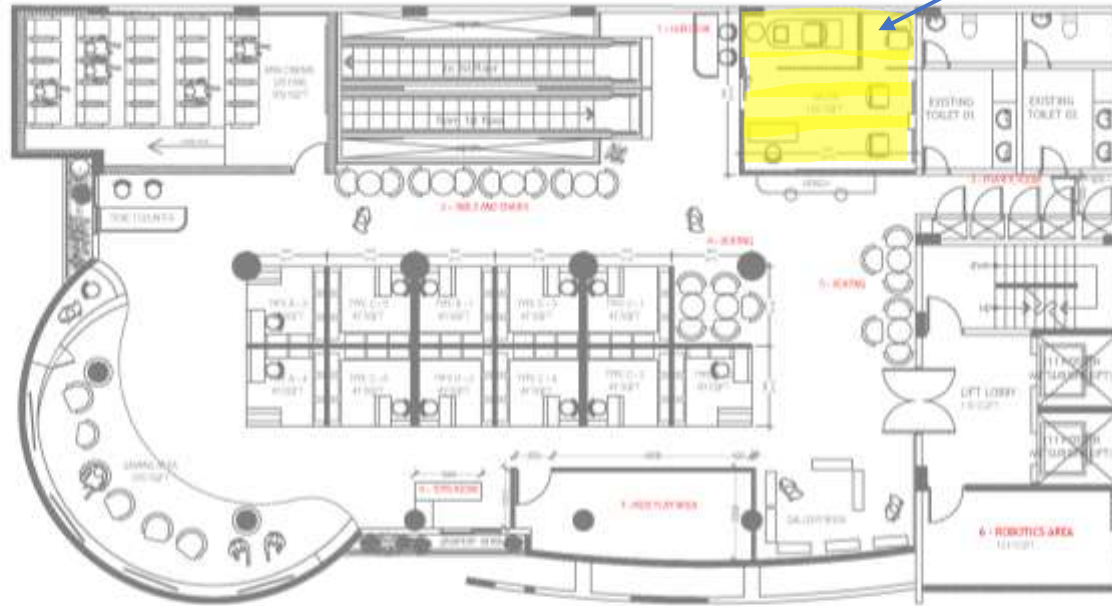

NOTE:

- PROPOSED TERRAZZO FLOOR OVER CONCRETE SLAB (SEE SECTION 210101.00 FOR DETAILS)
- PROPOSED GLASS PARTITION WALLS WITH ALUMINUM FRAME (SEE SECTION 210101.00 FOR DETAILS)
- PROPOSED WOOD FLOOR OVER CONCRETE SLAB (SEE SECTION 210101.00 FOR DETAILS)
- PROPOSED WOOD FLOOR OVER CONCRETE SLAB (SEE SECTION 210101.00 FOR DETAILS)
- PROPOSED WOOD FLOOR OVER CONCRETE SLAB (SEE SECTION 210101.00 FOR DETAILS)
- PROPOSED WOOD FLOOR OVER CONCRETE SLAB (SEE SECTION 210101.00 FOR DETAILS)

**SECOND FLOOR PLAN - REVISION 5**  
SCALE: 1/8" = 1'-0"

ATTACHMENT 2 \_HAIR AND MAKEUP SALON RENDERS



ATTACHMENT 3 \_HAIR AND MAKEUP SALON LAYOUT

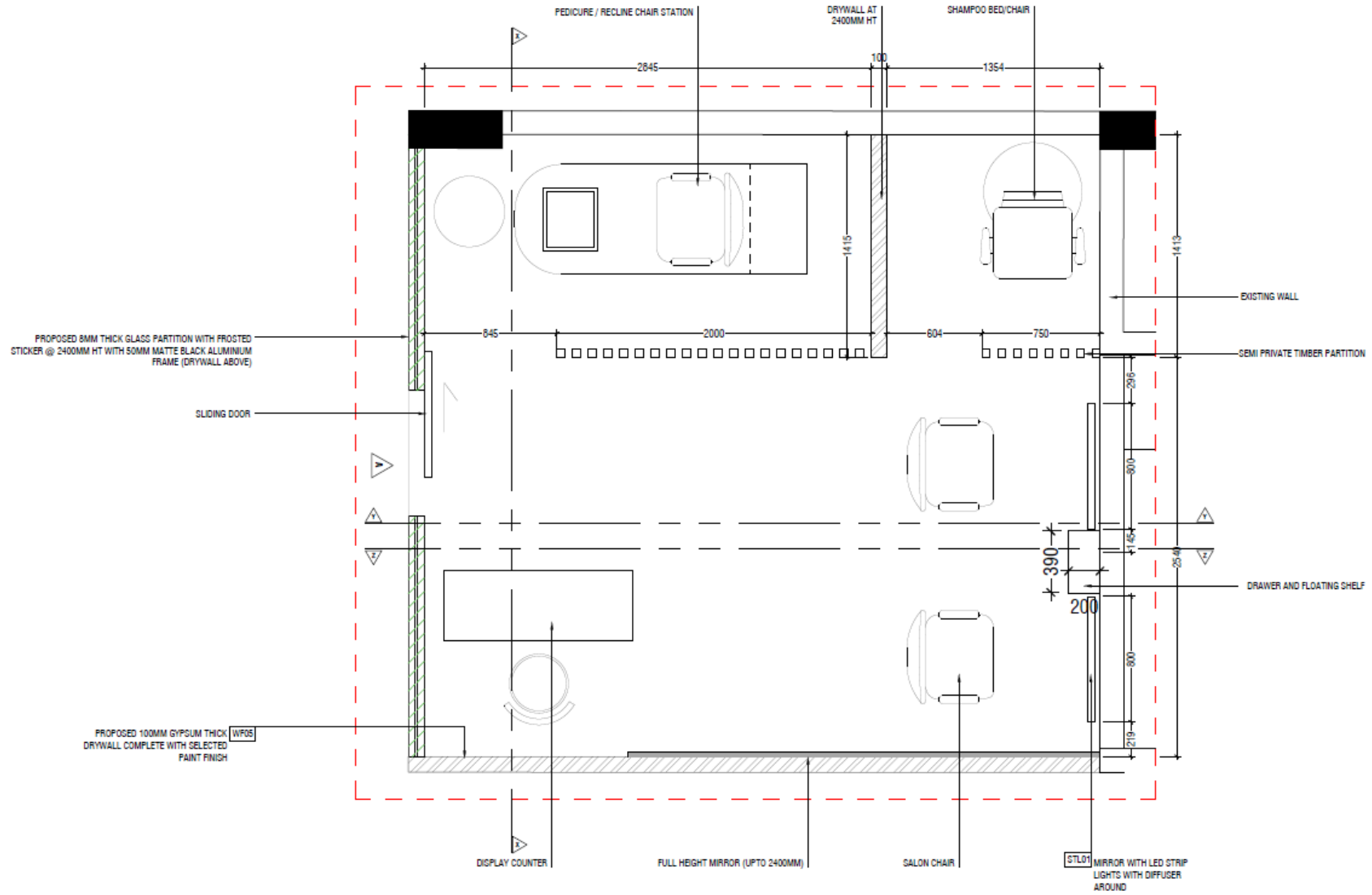

**ATTACHMENT 3 \_HAIR AND MAKEUP SALON FURNITURE**

Furniture	Qty	Image
Hair and makeup chair	2	
Shampoo chair	1	

Pedicure/ Reclining chair	1	
Swivel height adjustable stool	1	
Pouf Seat	1	
Trolley	1	