

UPGRADING OF B.THULHAADHOO  
ISLAND WASTE AND RESOURCE MANAGEMENT CENTRE



PREPARED BY:  
MINISTRY OF ENVIRONMENT, CLIMATE CHANGE AND TECHNOLOGY

---

SEPTEMBER 2023



PREPARED BY

PROJECT

DESIGN BY

AMENDMENTS

UPGRADING OF IWRMC  
B.THULHAADHOO

MA

TITLE  
LOCATION PLAN

STRUCTURE BY  
MA

CLIENT DEPARTMENT  
WMPC DEPARTMENT

DRAWN BY  
MA

PAPER SIZE A3  
PAGE NO. 01





SCALE 1:150  
DWG NO. THUL-A1-01  
DATE 13.09.2023

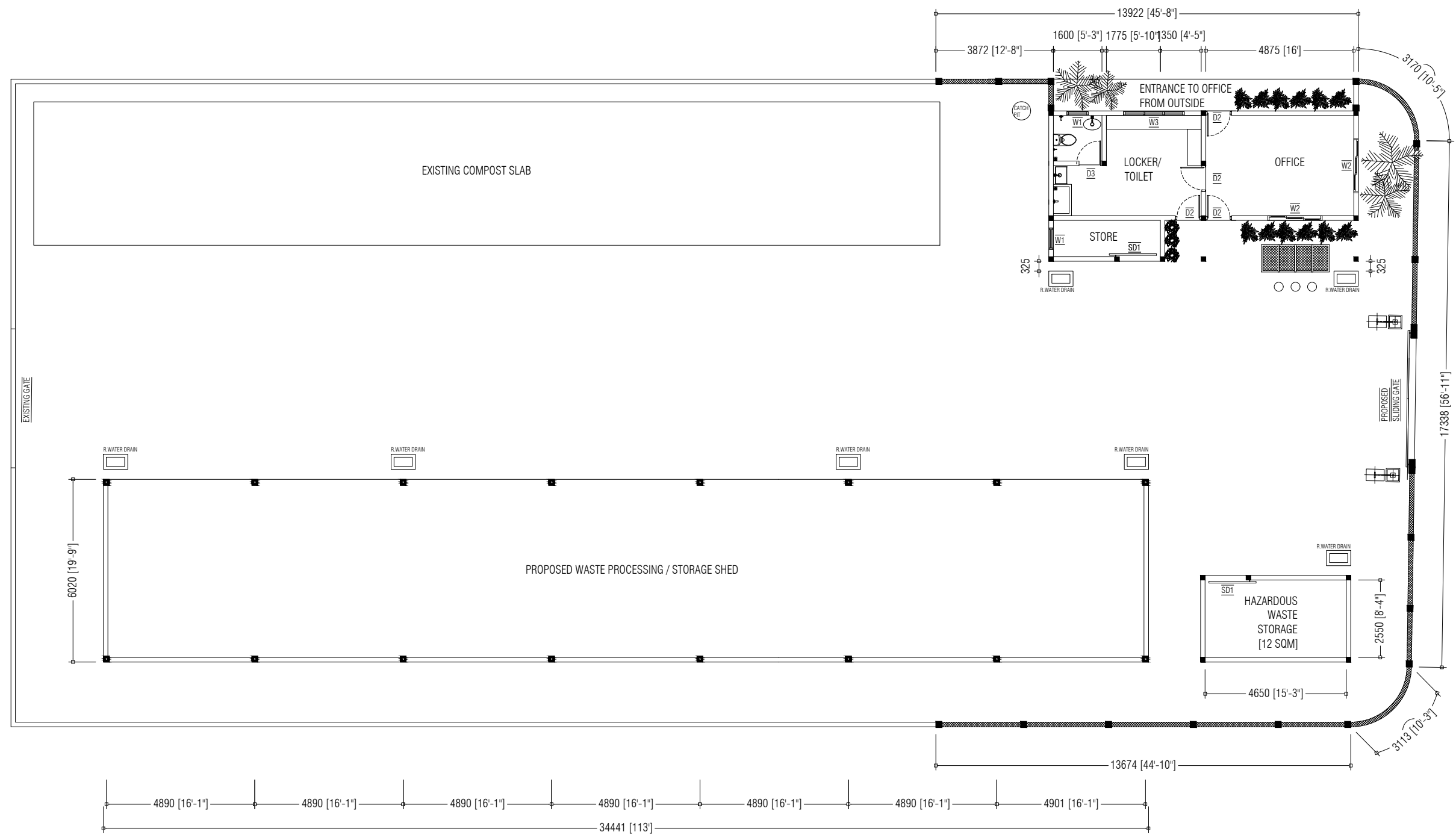

MINISTRY OF ENVIRONMENT, CLIMATE CHANGE AND TECHNOLOGY  
GREEN BUILDING, HANDHUVAREE HIGUN,  
MAAFANNU, MALE' (20392), REPUBLIC OF MALDIVES,  
TEL: +960-3018431, +960-3018300, FAX: +960-328301

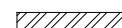

NOTE:

-  600mm HEIGHT WALL + 2m HEIGHT CLADDING ON TOP
-  OFFICE / HAZARDOUS WASTE BUILDING WALLS
-  600mm HEIGHT MASONRY WALL + FULL HEIGHT CLADDING ON TOP
-  BOUNDARY FENCE

PREPARED BY	PROJECT	DESIGN BY	AMENDMENTS
 <p>MINISTRY OF ENVIRONMENT, CLIMATE CHANGE AND TECHNOLOGY            GREEN BUILDING, HANDHUVAREE HIGUN,            MAAFANNU, MALE' (20392), REPUBLIC OF MALDIVES.            TEL: +960-3018431, +960-3018300, FAX: +960-328301</p>	UPGRADING OF IWRMC B.THULHAADHOO	MA	
	TITLE LAYOUT PLAN	STRUCTURE BY MA	
	CLIENT DEPARTMENT WMPC DEPARTMENT	DRAWN BY MA	
	PAPER SIZE A3	SCALE 1:150	
	PAGE NO. 02	DWG NO. THUL-A1-02	
		DATE 13.09.2023	

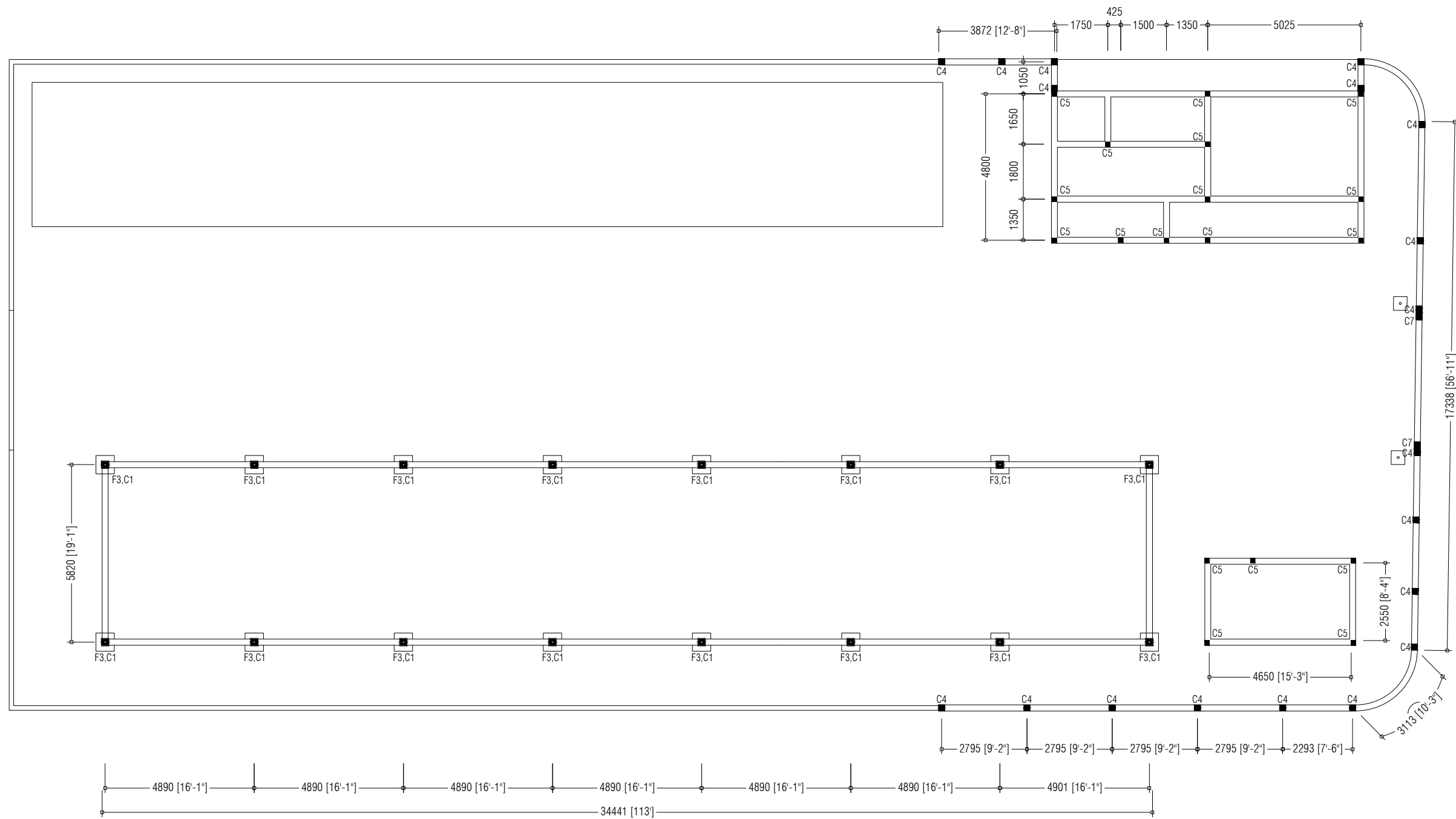

NOTE:

- TIE BEAMS [200X200mm]
- LAMP POST FOOTING [450X450mm]

PREPARED BY	PROJECT	DESIGN BY	AMENDMENTS
 <p>MINISTRY OF ENVIRONMENT, CLIMATE CHANGE AND TECHNOLOGY GREEN BUILDING, HANDHUVAREE HIGUN, MAAFANNU, MALE' (20392), REPUBLIC OF MALDIVES. TEL: +960-3018431, +960-3018300, FAX: +960-328301</p>	UPGRADING OF IWRMC B.THULHAADHOO	MA	
	FOUNDATION PLAN	MA	
	CLIENT DEPARTMENT WMPC DEPARTMENT	MA	
	PAPER SIZE A3	SCALE 1:150	
	PAGE NO. 03	DWG NO. THUL-A1-03	
		DATE 13.09.2023	

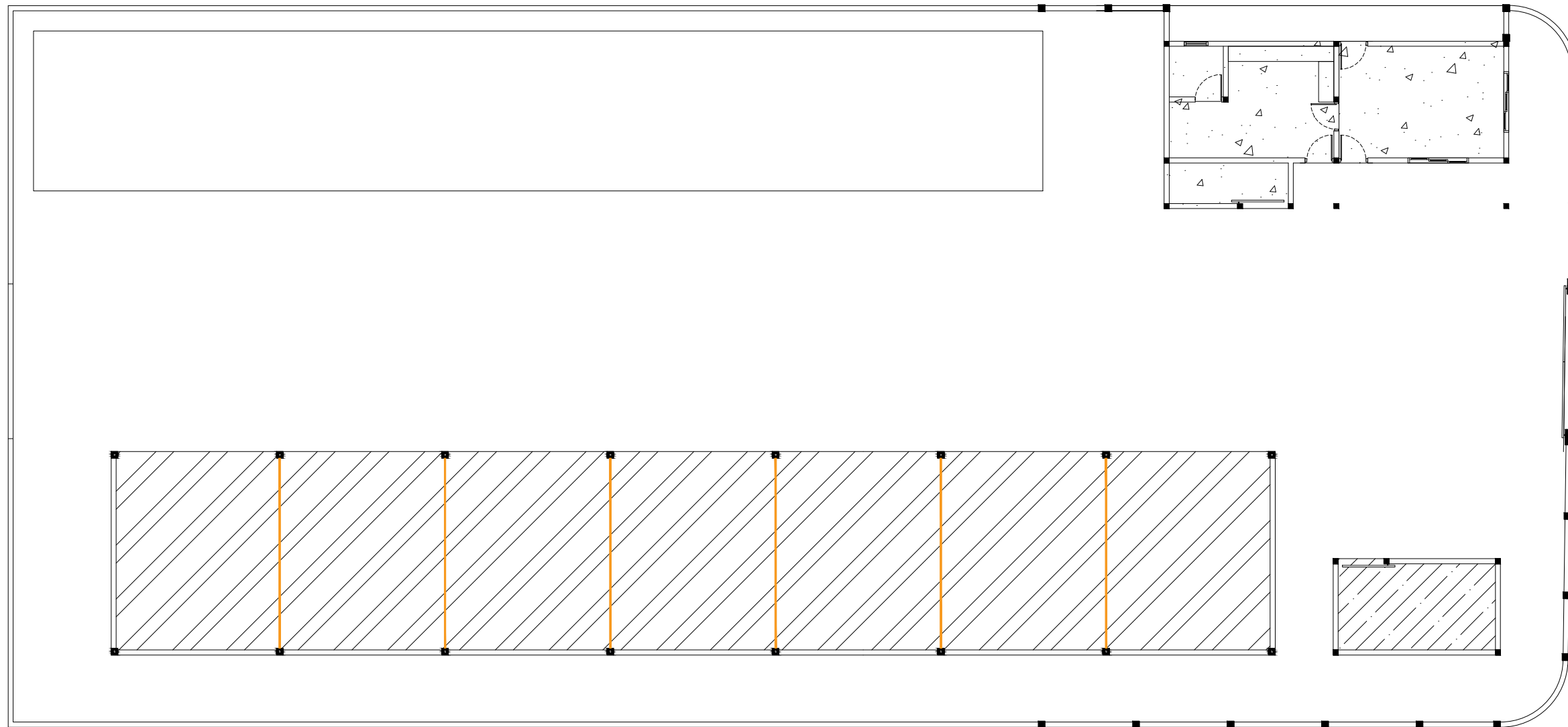

NOTE:

- 75mm THICK SLAB ON FILL, R6@150 B/W (SINGLE NET)
- 125mm THICK SLAB ON FILL, T10@200 B/W (SINGLE NET)
- 100mm THICK SLAB ON FILL, T10@200 B/W (SINGLE NET)
- EXPANSION JOINTS

PREPARED BY   MINISTRY OF ENVIRONMENT, CLIMATE CHANGE AND TECHNOLOGY GREEN BUILDING, HANDHUVAREE HIGUN, MAAFANNU, MALE' (20392), REPUBLIC OF MALDIVES, TEL: +960-3018431, +960-3018300, FAX: +960-328301	<table border="1" style="width: 100%; border-collapse: collapse;"> <tr> <td style="width: 50%;">PROJECT</td> <td style="width: 50%;">DESIGN BY</td> </tr> <tr> <td>UPGRADING OF IWRMC B.THULHAADHOO</td> <td>MA</td> </tr> <tr> <td>TITLE</td> <td>STRUCTURE BY</td> </tr> <tr> <td>FLOOR SLAB PLAN</td> <td>MA</td> </tr> <tr> <td>CLIENT DEPARTMENT</td> <td>DRAWN BY</td> </tr> <tr> <td>WMPC DEPARTMENT</td> <td>MA</td> </tr> <tr> <td>PAPER SIZE   A3</td> <td>SCALE                   1:150</td> </tr> <tr> <td>PAGE NO.     04</td> <td>DWG NO.             THUL-A1-04</td> </tr> <tr> <td></td> <td>DATE                 13.09.2023</td> </tr> </table>	PROJECT	DESIGN BY	UPGRADING OF IWRMC B.THULHAADHOO	MA	TITLE	STRUCTURE BY	FLOOR SLAB PLAN	MA	CLIENT DEPARTMENT	DRAWN BY	WMPC DEPARTMENT	MA	PAPER SIZE   A3	SCALE                   1:150	PAGE NO.     04	DWG NO.             THUL-A1-04		DATE                 13.09.2023	AMENDMENTS           
PROJECT	DESIGN BY																			
UPGRADING OF IWRMC B.THULHAADHOO	MA																			
TITLE	STRUCTURE BY																			
FLOOR SLAB PLAN	MA																			
CLIENT DEPARTMENT	DRAWN BY																			
WMPC DEPARTMENT	MA																			
PAPER SIZE   A3	SCALE                   1:150																			
PAGE NO.     04	DWG NO.             THUL-A1-04																			
	DATE                 13.09.2023																			

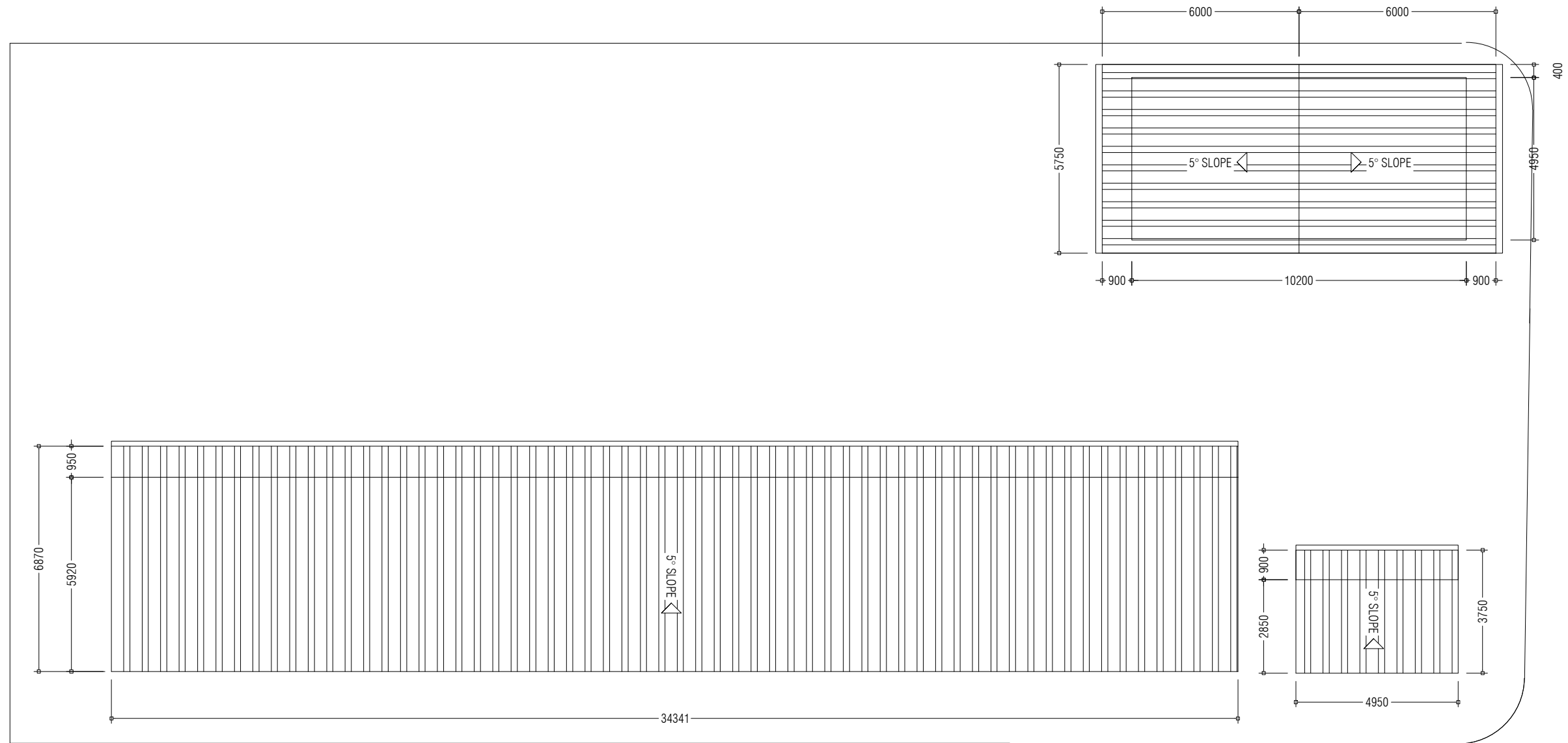

PREPARED BY

PROJECT

DESIGN BY

AMENDMENTS

UPGRADING OF IWRMC  
B.THULHAADHOO

MA

TITLE  
ROOF PLAN

STRUCTURE BY  
MA

CLIENT DEPARTMENT  
WMPC DEPARTMENT

DRAWN BY  
MA

PAPER SIZE A3

SCALE 1:150

PAGE NO. 05

DWG NO. THUL-A1-05

DATE 13.09.2023











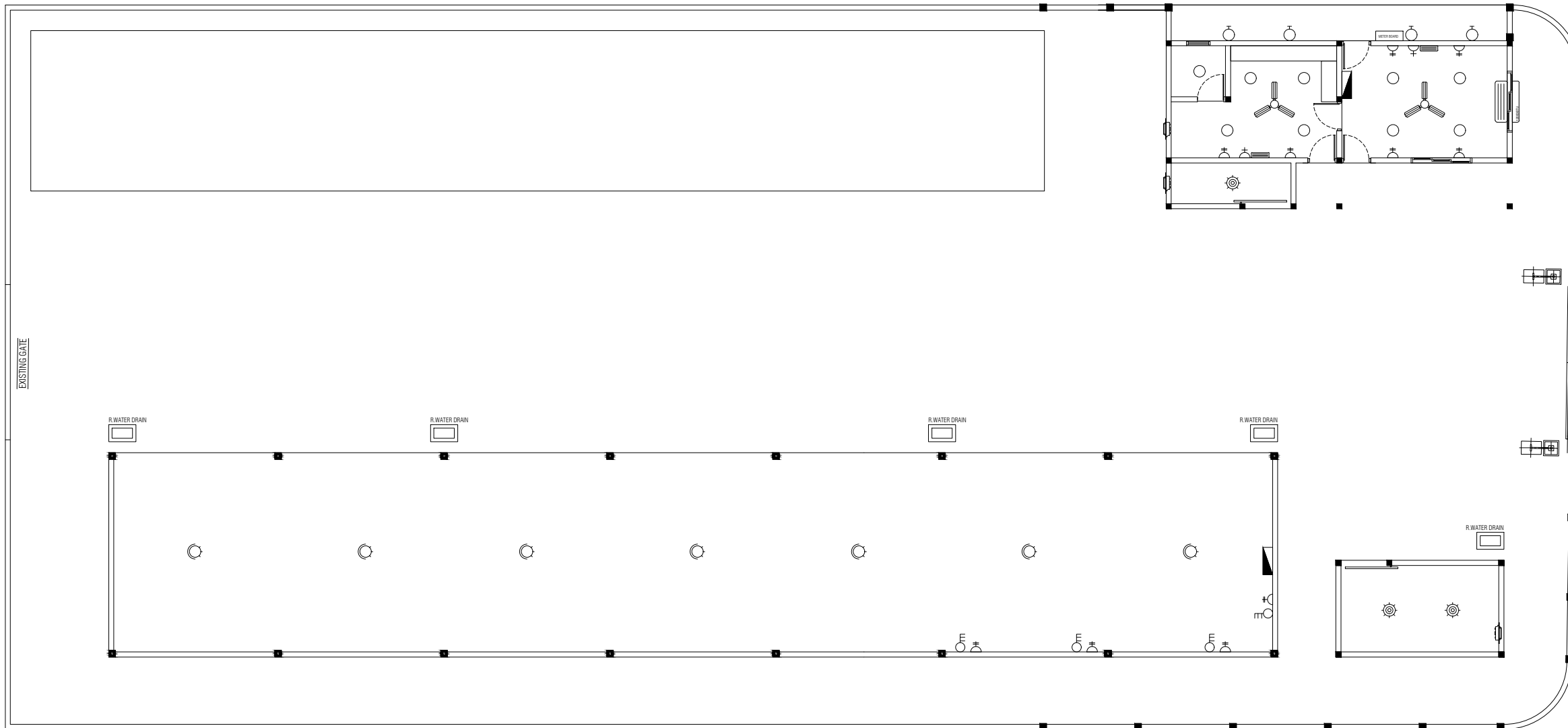

MINISTRY OF ENVIRONMENT, CLIMATE CHANGE AND TECHNOLOGY  
GREEN BUILDING, HANDHUVAREE HIGUN,  
MAAFANNU, MALE (20392), REPUBLIC OF MALDIVES,  
TEL: +960-3018431, +960-3018300, FAX: +960-328301







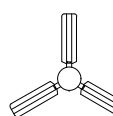

- METER BOARD 
- DISTRIBUTION BOARDS 
- 20W LED LIGHT (DAY LIGHT) 
- 20W CEILING MOUNT LED LIGHT (WARM WHITE) 
- 20W WALL MOUNT EXTERIOR LED LIGHT (WARM WHITE) 
- 100W SWIVEL LED FLOOD LIGHT (DAY LIGHT) 
- 10W WALL MOUNT LED EMERGENCY LIGHT (DAY LIGHT) 
- 13AMP DOUBLE SOCKET 
- 3 PHASE, 15A POWER POINTS [1.5m ABOVE FL. LEVEL] 
- 3 PHASE, WATERPROOF, 15A POWER POINTS [1.5m ABOVE FL. LEVEL] 
- CEILING FAN 56" DIA 

PREPARED BY	PROJECT	DESIGN BY	AMENDMENTS	
 <p>MINISTRY OF ENVIRONMENT, CLIMATE CHANGE AND TECHNOLOGY            GREEN BUILDING, HANDHUVAREE HIGUN,            MAAFANNU, MALE' (20392), REPUBLIC OF MALDIVES,            TEL: +960-3018431, +960-3018300, FAX: +960-328301</p>	UPGRADING OF IWRMC B.THULHAADHOO	MA		
	ELECTRICAL PLAN	MA		
	WMPC DEPARTMENT	MA		
	PAPER SIZE A3	SCALE 1:150		
	PAGE NO. 08	DWG NO. THUL-A1-08		
		DATE 13.09.2023		

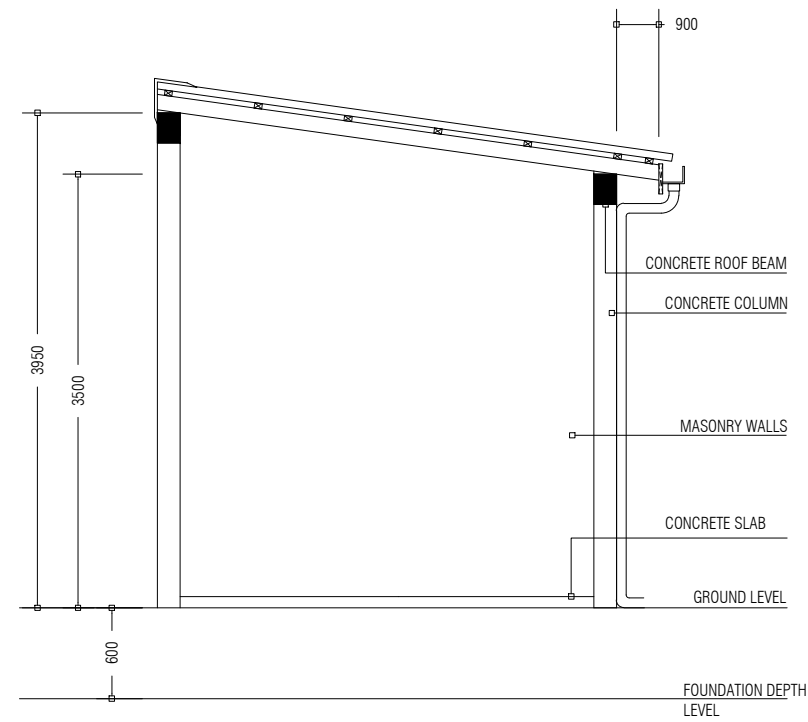

HAZARDOUS WASTE STORAGE BUILDING SECTION

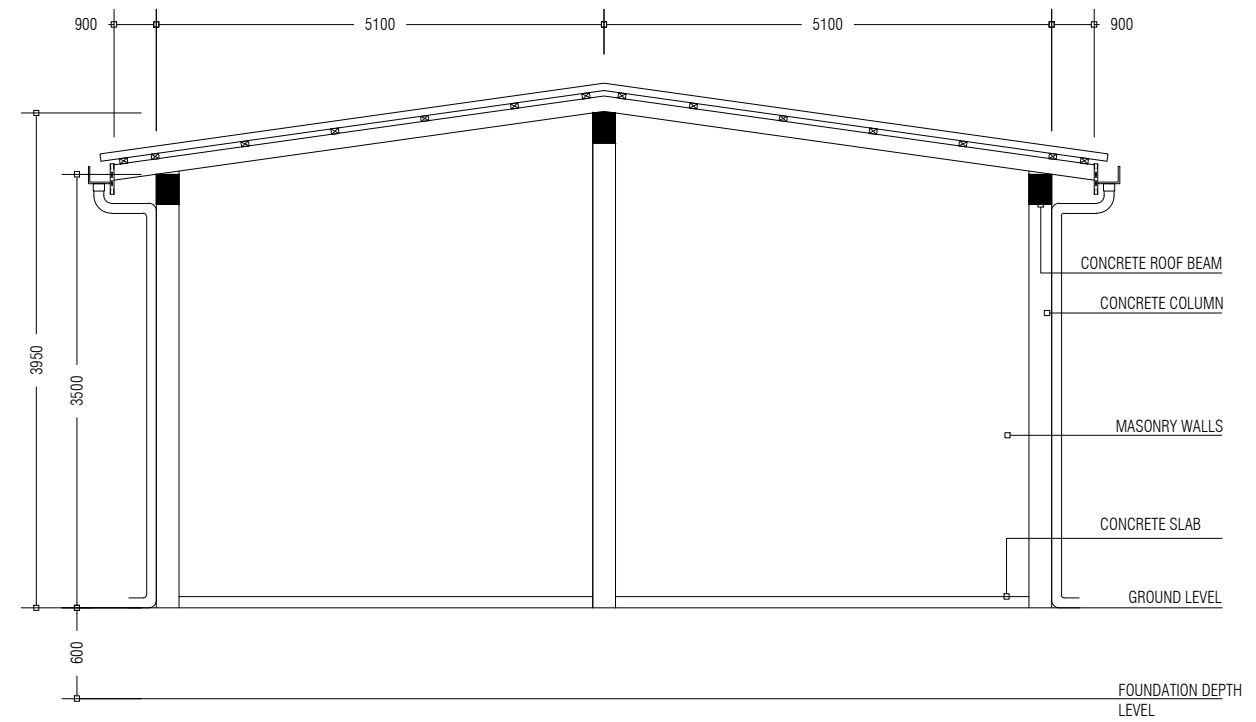

OFFICE / LOCKER BUILDING SECTION

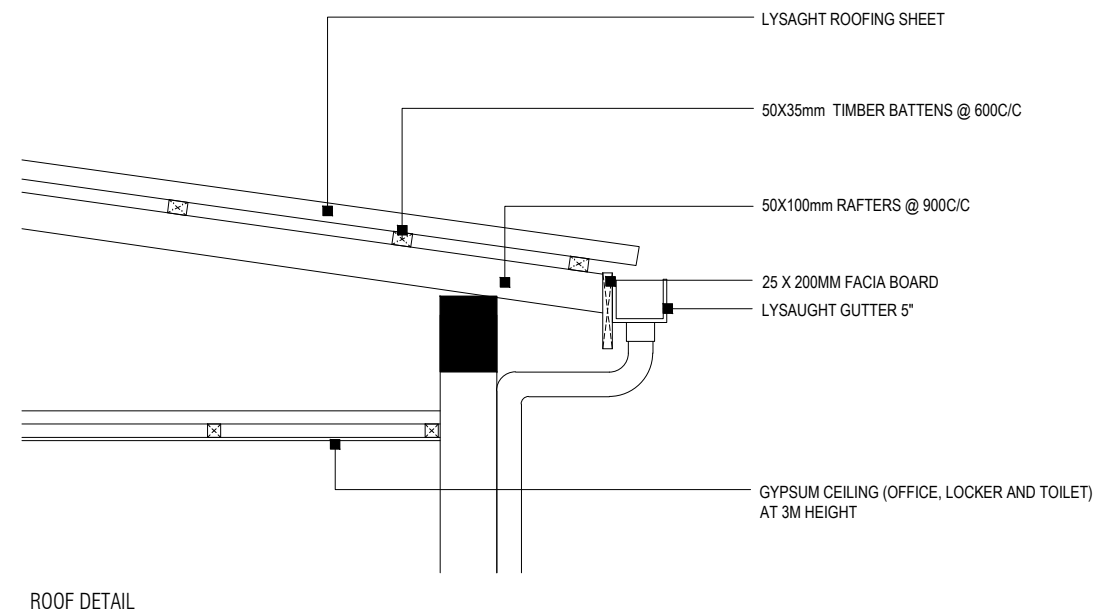

ROOF DETAIL

PREPARED BY

PROJECT

DESIGN BY

AMENDMENTS

UPGRADING OF IWRMC  
B.THULHAADHOO

MA

TITLE

STRUCTURE BY

ELEVATIONS AND SECTIONS

MA

CLIENT DEPARTMENT

DRAWN BY

WMPC DEPARTMENT

MA

PAPER SIZE A3

SCALE

1:150

PAGE NO. 07

DWG NO.

THUL-A2-09

DATE

13.09.2023



MINISTRY OF ENVIRONMENT, CLIMATE CHANGE AND TECHNOLOGY

GREEN BUILDING, HANDHUVAREE HIGUN,  
MAAFANNU, MALE' (20392), REPUBLIC OF MALDIVES,  
TEL: +960-3018431, +960-3018300, FAX: +960-328301

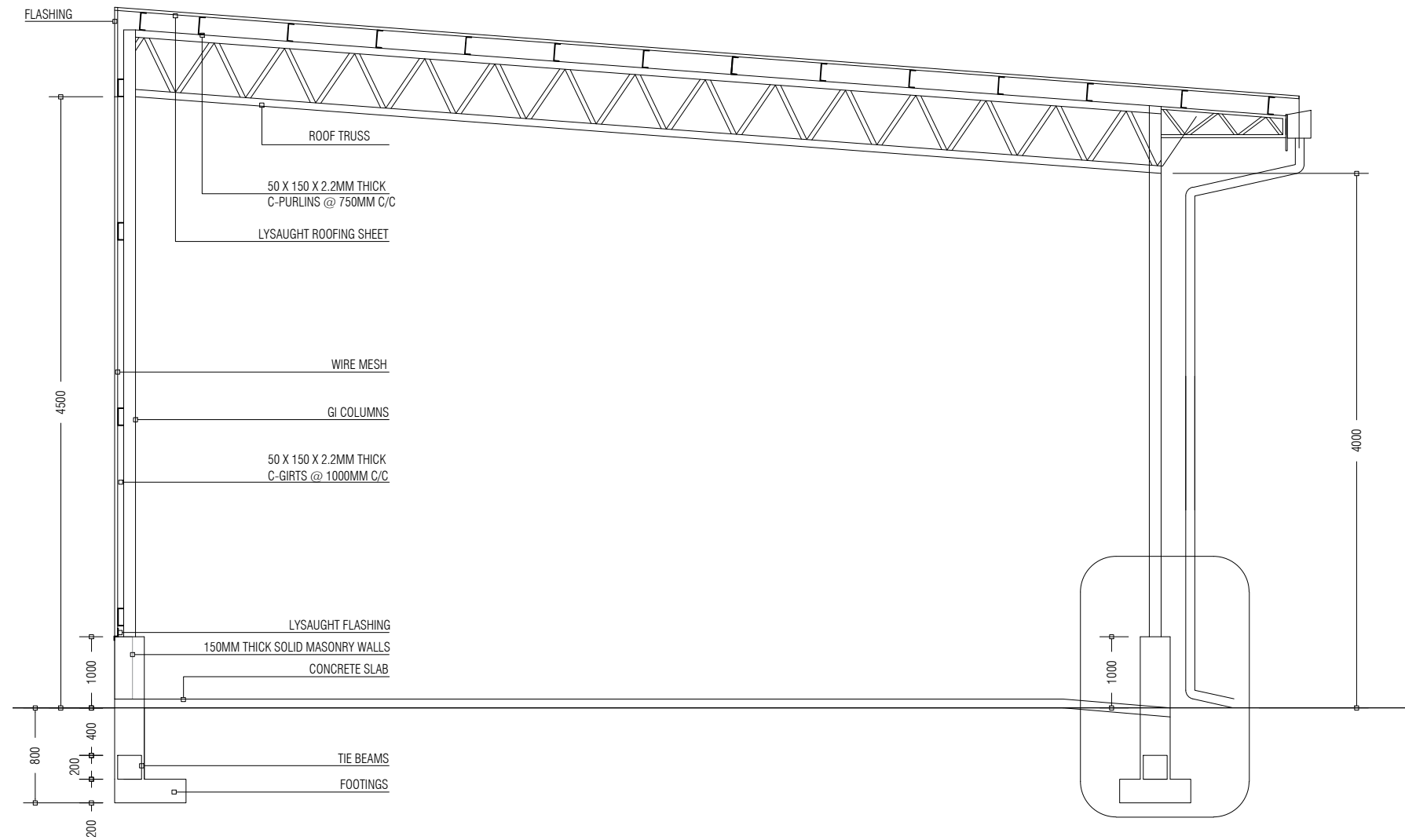

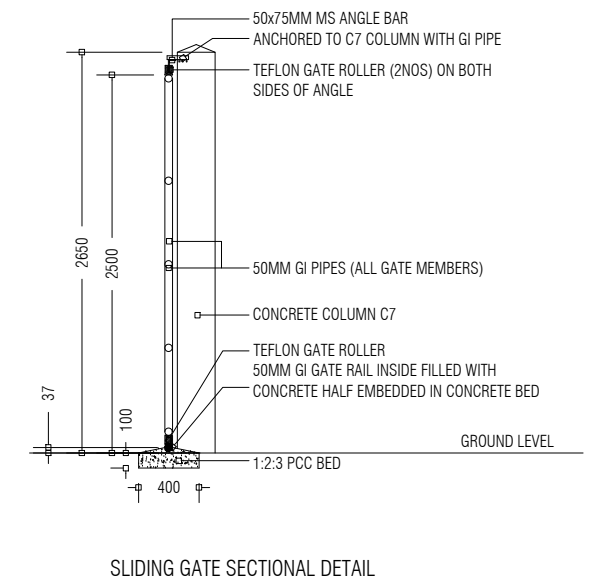
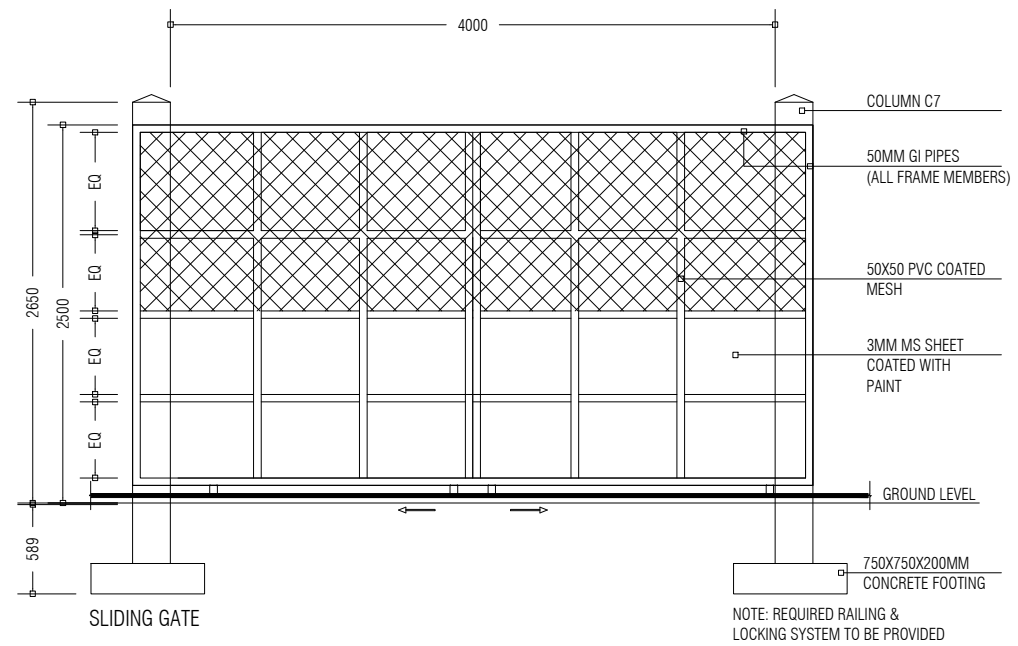

WASTE MANAGEMENT BAY SECTION

PREPARED BY	PROJECT	DESIGN BY	AMENDMENTS
 <p>MINISTRY OF ENVIRONMENT, CLIMATE CHANGE AND TECHNOLOGY          GREEN BUILDING, HANDHUVAREE HIGUN,          MAAFANNU, MALE' (20392), REPUBLIC OF MALDIVES,          TEL: +960-3018431, +960-3018300, FAX: +960-328301</p>	UPGRADING OF IWRMC B.THULHAADHOO	MA	
	TITLE	STRUCTURE BY	
	ELEVATIONS AND SECTIONS	MA	
	CLIENT DEPARTMENT	DRAWN BY	
	WMPC DEPARTMENT	MA	
	PAPER SIZE A3	SCALE 1:50	
PAGE NO. 10	DWG NO. THUL-A2-10		
	DATE 13.09.2023		

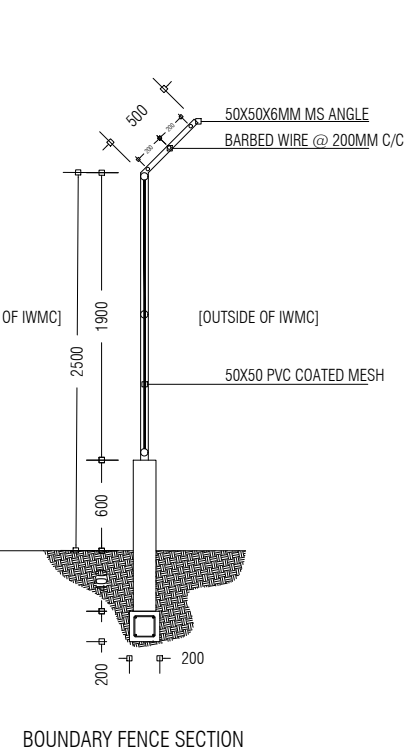
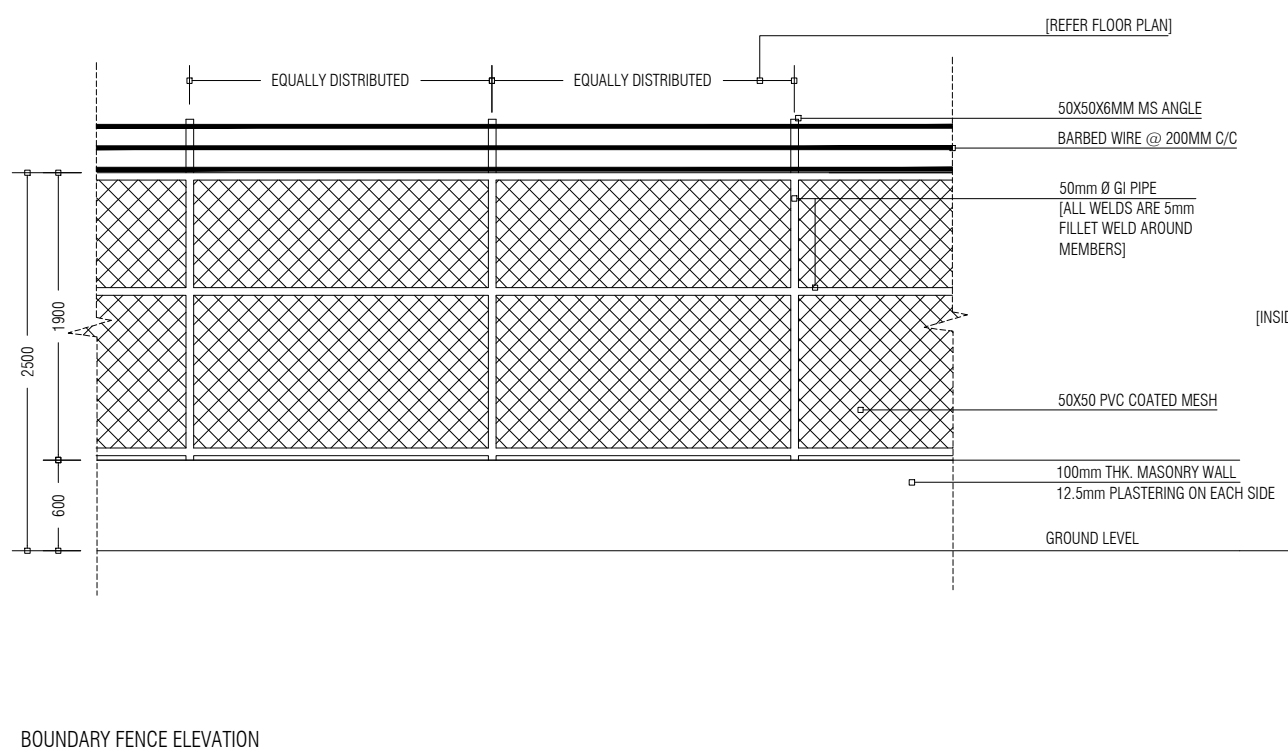

NOTE:  
ALL WELDS FOR THE  
GI MEMBERS ARE  
5mm FILLET WELDS



PREPARED BY	PROJECT	DESIGN BY	AMENDMENTS
 <p>MINISTRY OF ENVIRONMENT, CLIMATE CHANGE AND TECHNOLOGY GREEN BUILDING, HANDHUVAREE HIGUN, MAAFANNU, MALE' (20392), REPUBLIC OF MALDIVES, TEL: +960-3018431, +960-3018300, FAX: +960-328301</p>	UPGRADING OF IWRMC B.THULHAADHOO	MA	
	TITLE	STRUCTURE BY	
	ELEVATION AND SECTIONS: GATE DETAILS, FENCE DETAILS	MA	
	CLIENT DEPARTMENT	DRAWN BY	
	WMPC DEPARTMENT	MA	
	PAPER SIZE A3	SCALE 1:50	
PAGE NO. 11	DWG NO. THUL-A2-11		
	DATE 13.09.2023		

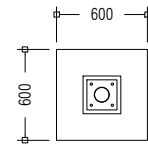
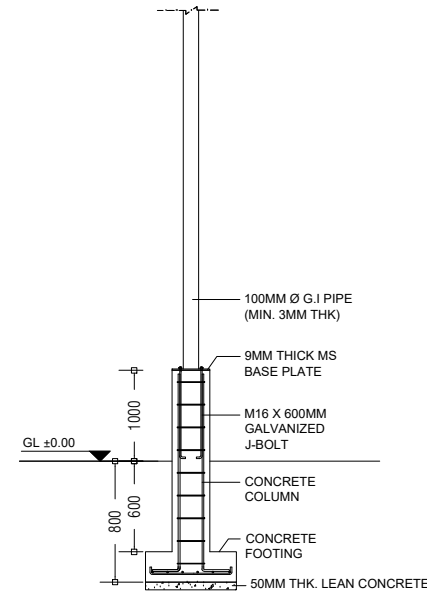

PAD	SIZE (MM)	REINFORCEMENT
F3	600 x 600 x 200	T10 @ 100 c/c BW (BOTTOM)

FOOTING DETAILS 1:50

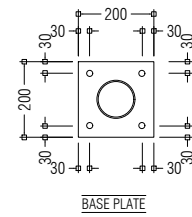

BASE PLATE

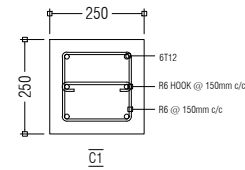

C1

BASE PLATE AND COLUMN DETAILS 1:20

PREPARED BY

PROJECT

DESIGN BY

AMENDMENTS

UPGRADING OF IWRMC  
B.THULHAADHOO

MA

TITLE

STRUCTURE BY

FOOTING DETAILS

MA

CLIENT DEPARTMENT

DRAWN BY

WMPC DEPARTMENT

MA

PAPER SIZE A3

SCALE

1:50, 1:20

PAGE NO. 12

DWG NO.

THUL-D1-12

DATE

13.09.2023



MINISTRY OF ENVIRONMENT, CLIMATE CHANGE AND TECHNOLOGY

GREEN BUILDING, HANDHUVAREE HIGUN,  
MAAFANNU, MALÉ (20392), REPUBLIC OF MALDIVES,  
TEL: +960-3018431, +960-3018300, FAX: +960-328301

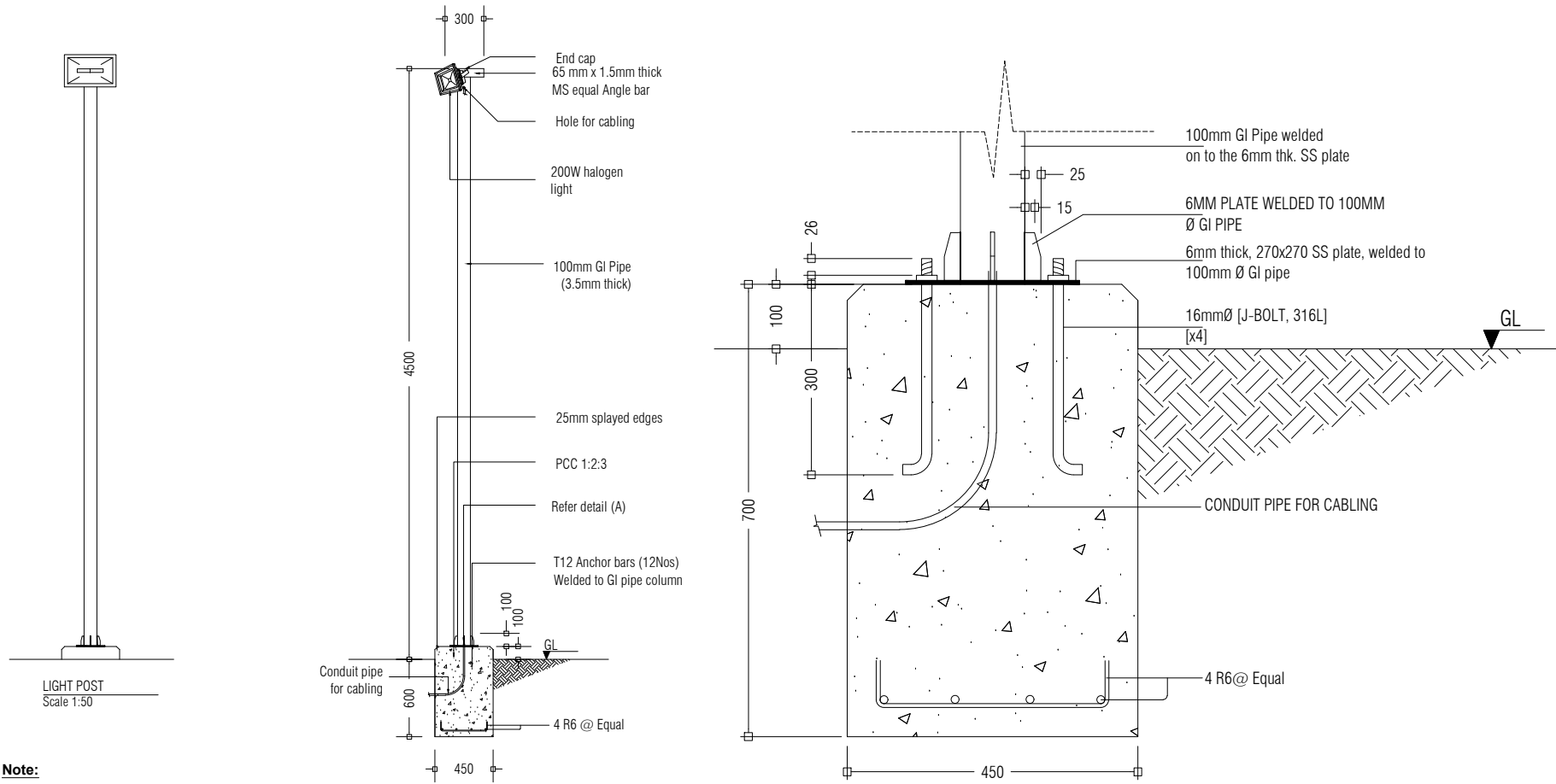

**Note:**

- \* Concrete cover: 50mm
- \* GI pipe to be painted with 1 coat of sealer & 2 coats of finishing paint. (Sigma or equivalent, maroon colour)

LIGHT POST DETAIL Scale 1:50

LIGHT POST FOUNDATION FOOTING DETAIL 1:10

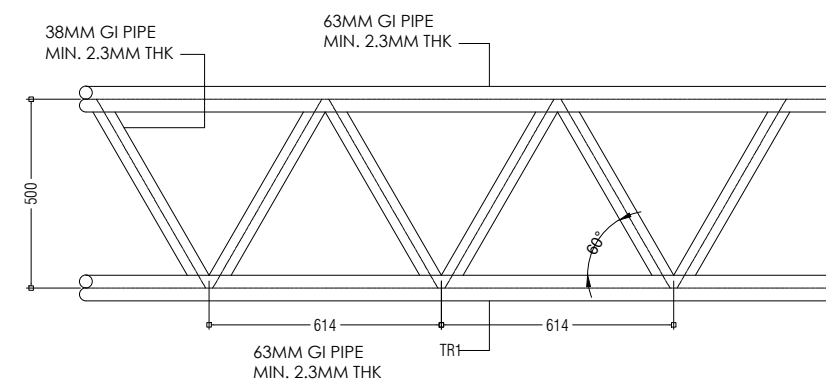

TRUSS DETAIL 1:20

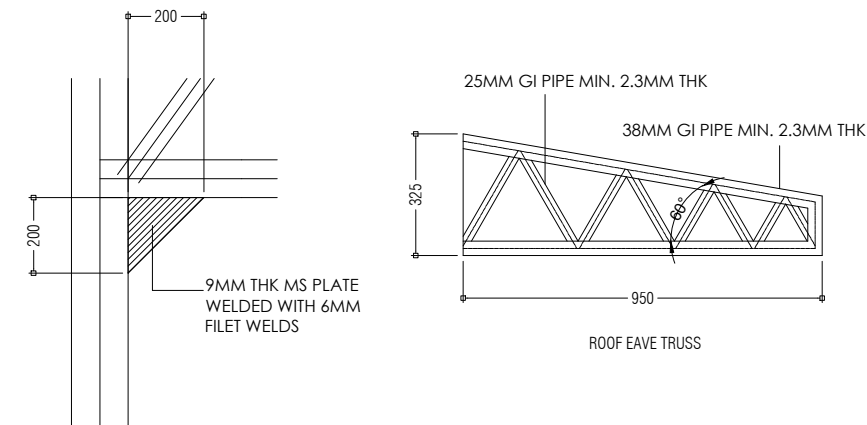

COLUMN AND TRUSS CONNECTION DETAIL 1:20

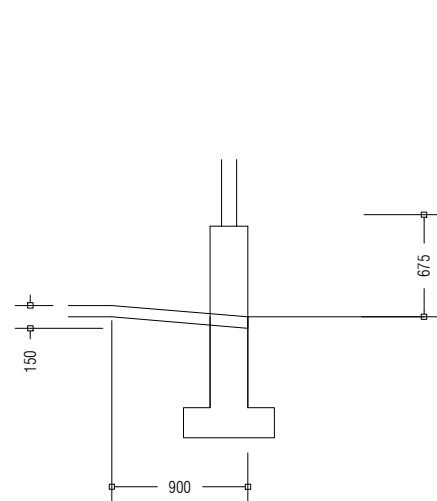

DETAIL A: RAMP DETAIL 1:50

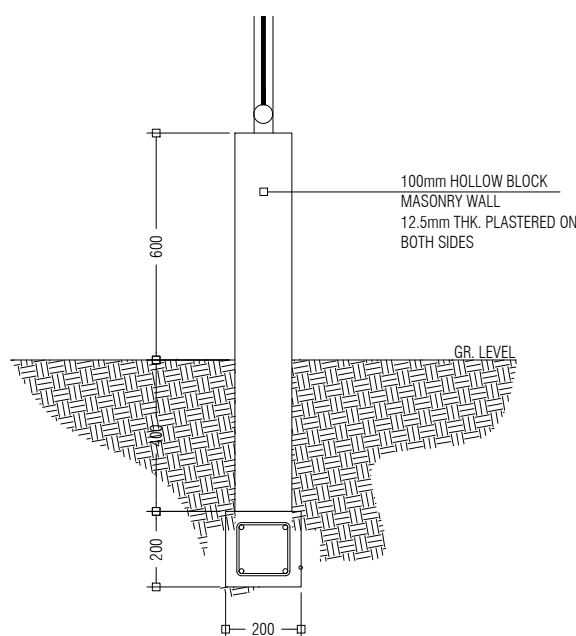

BOUNDARY FENCE SIDE SECTIONAL DETAIL 1:20

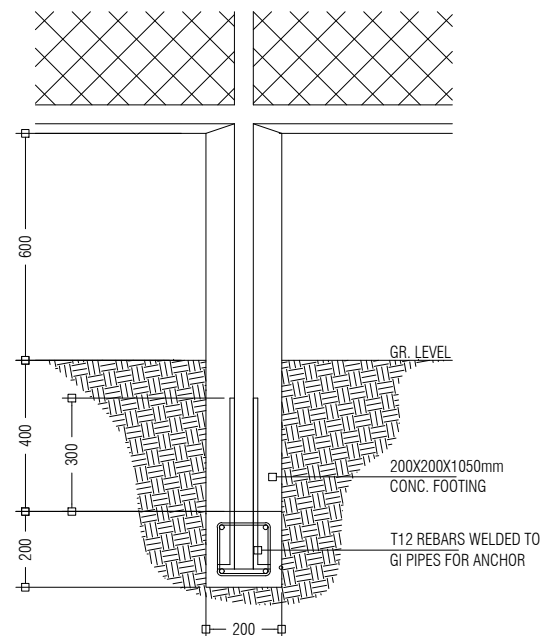

BOUNDARY FENCE FRONT SECTIONAL DETAIL 1:20

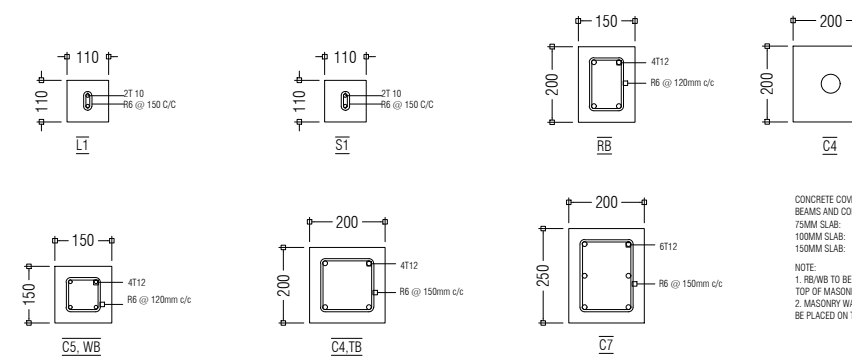
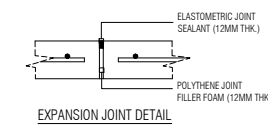

COLUMN, BEAM AND EXPANSION JOINT DETAILS 1:20

CONCRETE COVERS:  
BEAMS AND COLUMNS: 30mm  
75MM SLAB: 30mm  
100MM SLAB: 40mm  
150MM SLAB: 40mm

NOTE:  
1. RB/WB TO BE CAST ON TOP OF MASONRY WALLS  
2. MASONRY WALLS TO BE PLACED ON TB

PREPARED BY	PROJECT	DESIGN BY	AMENDMENTS	
 <p>MINISTRY OF ENVIRONMENT, CLIMATE CHANGE AND TECHNOLOGY GREEN BUILDING, HANDHUVAREE HIGUN, MAAFANNU, MALÉ (20392), REPUBLIC OF MALDIVES, TEL: +960-3018431, +960-3018300, FAX: +960-328301</p>	B.THULHAADHOO	MA		
	TITLE	STRUCTURE BY		
	STRUCTURAL DETAILS	MA		
	CLIENT DEPARTMENT	DRAWN BY		
	WMPC DEPARTMENT	MA		
	PAPER SIZE A3	SCALE	1:50, 1:20, 1:10	
	PAGE NO. 13	DWG NO.	THUL-D1-13	
		DATE	13.09.2023	

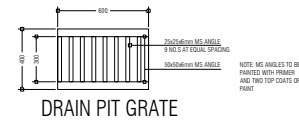

DRAIN PIT GRATE

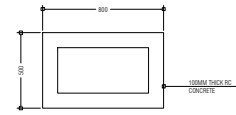

DRAIN PIT: TOP VIEW

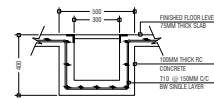

DRAIN PIT: SECTION VIEW

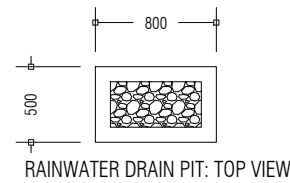

RAINWATER DRAIN PIT: TOP VIEW

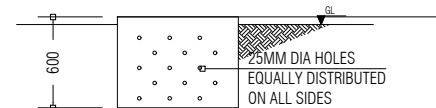

RAINWATER DRAIN PIT: SIDE VIEW

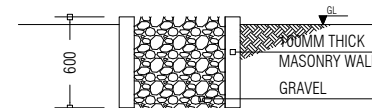

RAINWATER DRAIN PIT: SECTION VIEW

PREPARED BY	PROJECT	DESIGN BY	AMENDMENTS
 <p>MINISTRY OF ENVIRONMENT, CLIMATE CHANGE AND TECHNOLOGY GREEN BUILDING, HANDHUVAREE HIGUN, MAAFANNU, MALÉ (20392), REPUBLIC OF MALDIVES, TEL: +960-3018431, +960-3018300, FAX: +960-328301</p>	UPGRADING OF IWRMC B.THULHAADHOO	MA	
	TITLE RAINWATER DRAIN PIT AND WASTE MANAGEMENT BUILDING DRAIN PIT DETAILS	STRUCTURE BY MA	
	CLIENT DEPARTMENT WMPC DEPARTMENT	DRAWN BY MA	
	PAPER SIZE A3	SCALE NTS, 1:50	
	PAGE NO. 14	DWG NO. THUL-D1-14	
		DATE 13.09.2023	

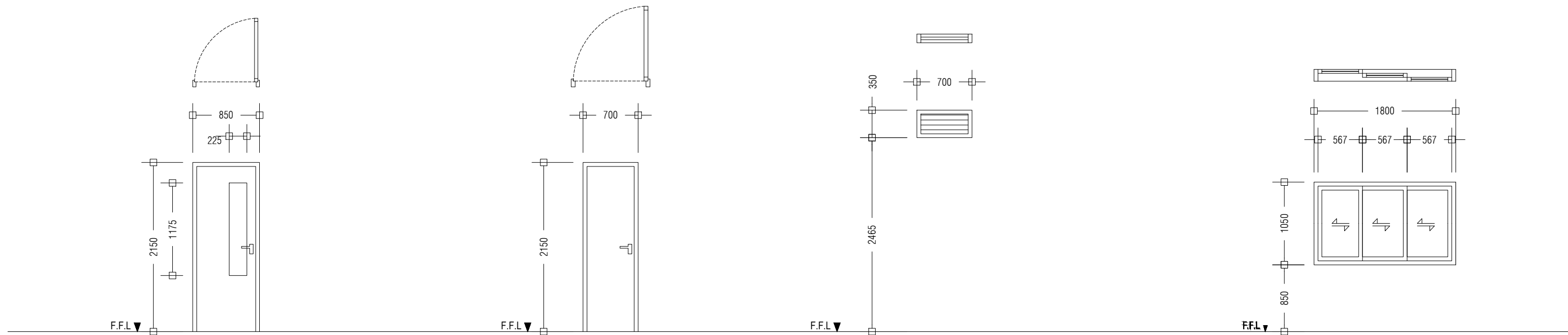

<b>D2</b>	SWING TYPE DOOR
REMARKS	ALUMINIUM DOOR WITH CLEAR GLASS PANEL 01 DOOR KNOB WITH LOCK SET 04 HINGES DOOR STOPPER, FINISHED WITH WHITE COATED PAINT
LOCATION	GROUND FLOOR
QUANTITY	NO.S 04
OPEN AREA	1.83 m <sup>2</sup>

<b>D3</b>	SWING TYPE DOOR
REMARKS	ALUMINIUM DOOR WITH DOOR KNOB AND 1 LOCK SET 04 HINGES
LOCATION	GROUND FLOOR
QUANTITY	NO.S 01
OPEN AREA	1.51m <sup>2</sup>

<b>W1</b>	ALUMINIUM LOUVER WINDOW
REMARKS	ALUMINIUM FRAMED, ALUMINIUM LOUVERED, FINISHED WITH WHITE COATED PAINT
LOCATION	GROUND FLOOR
QUANTITY	NO.S 2
OPEN AREA	0.25 m <sup>2</sup>

<b>W2</b>	ALUMINIUM SLIDING WINDOW
REMARKS	ALUMINIUM FRAMED, TINTED BLACK GLASS, FINISHED WITH WHITE POWDER COATED PAINT
LOCATION	GROUND FLOOR
QUANTITY	NO.S 02
OPEN AREA	1.89 m <sup>2</sup>

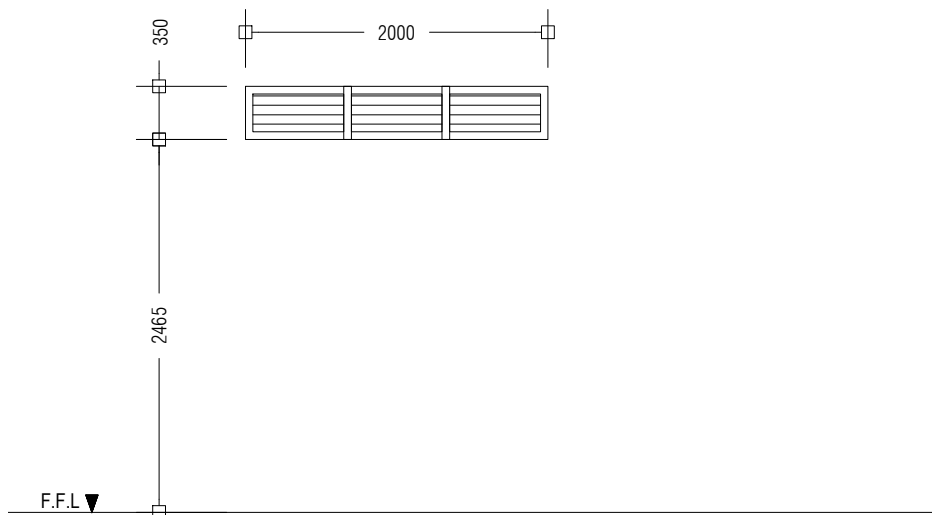

<b>W3</b>	ALUMINIUM LOUVER WINDOW
REMARKS	ALUMINIUM FRAMED, ALUMINIUM LOUVERED, FINISHED WITH WHITE COATED PAINT
LOCATION	GROUND FLOOR
QUANTITY	NO.S 1
OPEN AREA	0.75 m <sup>2</sup>

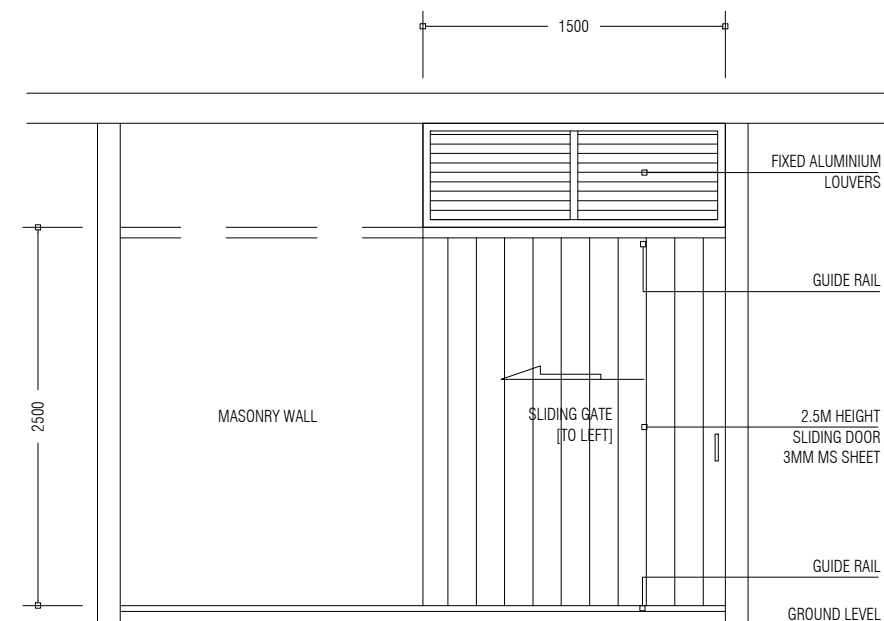

HAZADIOUS WASTE / STORE SD1

PREPARED BY	PROJECT	DESIGN BY	AMENDMENTS
	UPGRADING OF IWRMC B.THULHAADHOO	MA	
	TITLE	STRUCTURE BY	
	DOOR AND WINDOW SCHEDULE	MA	
	CLIENT DEPARTMENT	DRAWN BY	
	WMPC DEPARTMENT	MA	
PAPER SIZE	A3	SCALE	1:50
PAGE NO.	15	DWG NO.	THUL-A2-15
		DATE	13.09.2023