

Proposed Multipurpose Hall Building at  
Gdh. Gahdhoo School

*SERVICES DRAWINGS*

Client: Ministry of Education

### TABLE OF CONTENTS

DRAWING No.	TITLE	REVISION No.	DATE	REMARKS
<b>S E R V I C E S</b>		---	---	---
EL - 01 / 02	GROUND FLOOR LIGHTING LAYOUT	---	---	---
EL - 02 / 02	1ST FLOOR LIGHTING LAYOUT	---	---	---
EP - 01 / 02	GROUND FLOOR POWER LAYOUT	---	---	---
EP - 02 / 02	1ST FLOOR POWER LAYOUT	---	---	---
DR - 01 / 04	GROUND FLOOR PLUMBING & DRAINAGE LAYOUT	---	---	---
DR - 02 / 04	1ST FLOOR DRAINAGE LAYOUT	---	---	---
DR - 03 / 04	ROOF PLAN -1 DRAINAGE LAYOUT	---	---	---
DR - 04 / 04	ROOF PLAN -2 DRAINAGE LAYOUT	---	---	---
FDP - 01 / 02	GROUND FLOOR FDP LAYOUT	---	---	---
FDP - 02 / 02	1ST FLOOR FDP LAYOUT	---	---	---
DETAIL - 01 / 01	SEPTIC TANK DETAIL	---	---	---

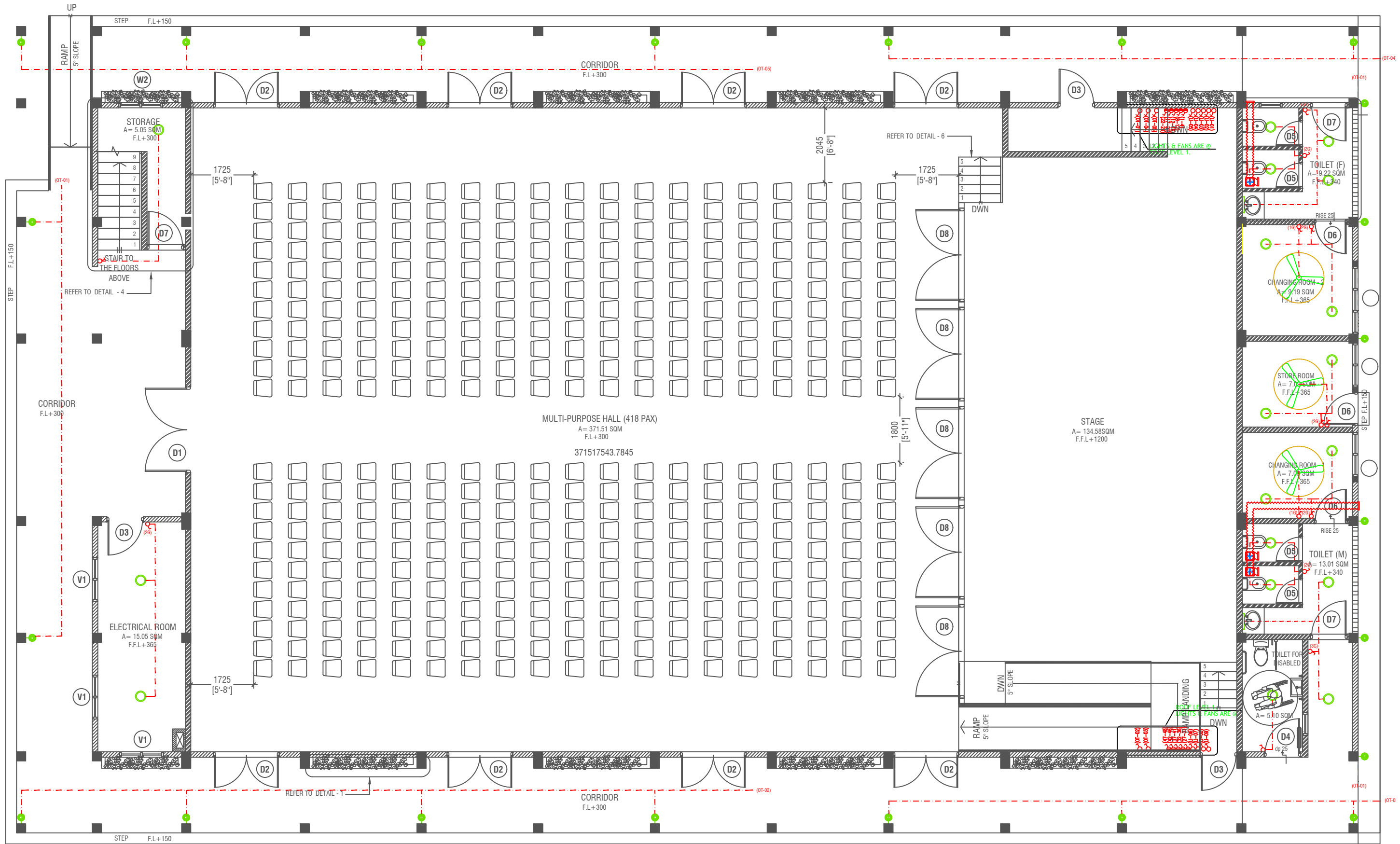

## GROUND FLOOR LIGHTING LAYOUT

SCALE 1:100



### LEGEND

4 x 55W PLL Lamps  
(Wire guard, Polycarbonate diffuser, Emergency and dimming versions)

LED CEILING DOWN LIGHT ( 18W)

CEILING FAN (52" - 54")

40W (IP 65) OUT DOOR WALL LIGHT

MIRROR LIGHT (7W LED LIGHT)

LIGHT SWITCH

CEILING FAN SWITCH

CIRCUIT LINE

SWITCHING LINE

Ceiling Mounted Exhaust Fan 90m<sup>3</sup>/hr

Wall Mounted Exhaust Fan

### NOTE:

- ALL WIRING TO BE OF STELCO APPROVED STANDARDS
- SWITCH CONTROL = 1200MM FROM FLOOR FIN. LEVEL
- ALL LIGHTING POINTS CONNECTED TO THEIR RESPECTIVE DB
- POLYCARBONATE ENCLOSURE TO ALL SWITCH AND SOCKET WHICH ARE LOCATED AT THE OUTDOORS

### NOTE:

- THE DOWNROD OF THE FANS IN THE HALL SHOULD BE NOT LESS THAN

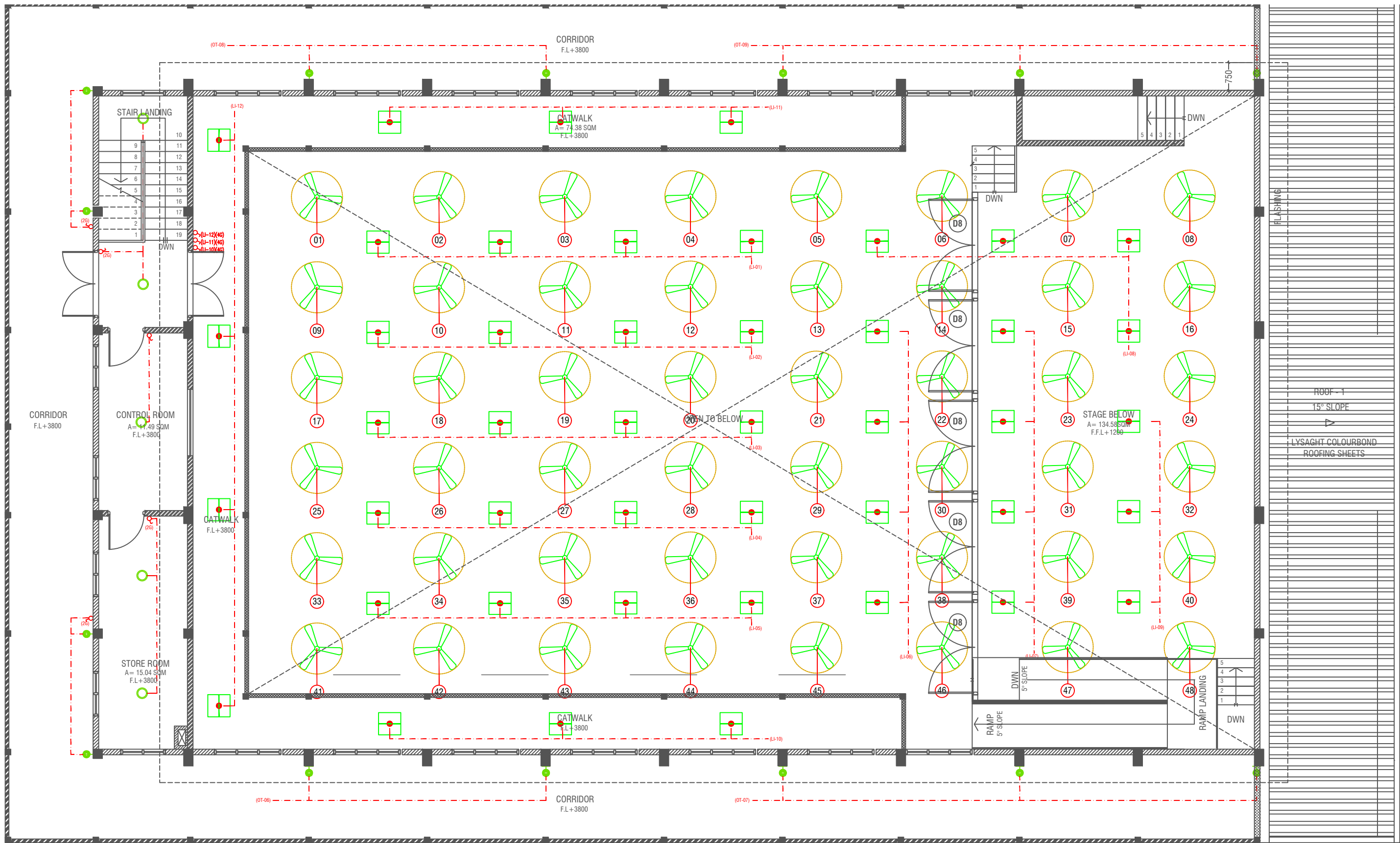

## FIRST FLOOR LIGHTING LAYOUT

SCALE 1:100



### LEGEND

600mm x 600mm LED CEILING MOUNT LIGHT (30W)  
(Wire guard, Polycarbonate diffuser, Emergency and dimming versions)

LED CEILING DOWN LIGHT ( 18W)

CEILING FAN (52" - 54")

40W (IP 65) OUT DOOR WALL LIGHT

MIRROR LIGHT (7W LED LIGHT)

LIGHT SWITCH

CEILING FAN SWITCH

CIRCUIT LINE

SWITCHING LINE

Ceiling Mounted Exhaust Fan 90m3/hr

Wall Mounted Exhaust Fan

**NOTE:**

- ALL WIRING TO BE OF STELCO APPROVED STANDARDS
- SWITCH CONTROL = 1200MM FROM FLOOR FIN. LEVEL
- ALL LIGHTING POINTS CONNECTED TO THEIR RESPECTIVE DB
- POLYCARBONATE ENCLOSURE TO ALL SWITCH AND SOCKET WHICH ARE LOCATED AT THE OUTDOORS

**NOTE:**

- THE DOWNROD OF THE FANS IN THE HALL SHOULD BE NOT LESS THAN

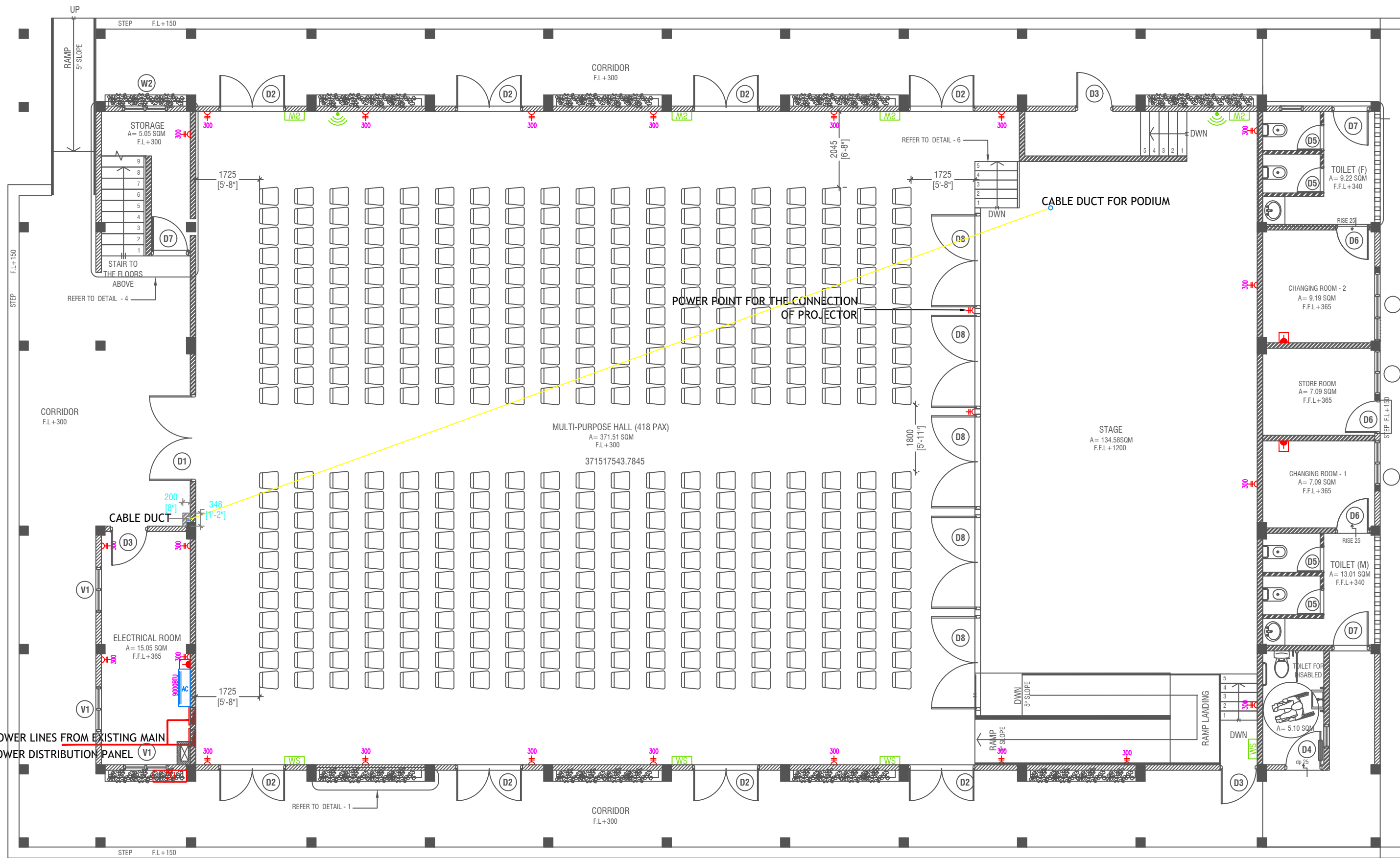

## GROUND FLOOR POWER LAYOUT

SCALE 1:100



- PHONE EXTENSION
  - COMPUTER NETWORK OUTLET (RJ 45 CONNECTORS)
  - TELEPHONE OUTLET (RJ11, CONNECTOR)
  - 13A POWER POINT
  - 13A TWIN SOCKET OUTLET
  - 15A SWITCHED/ SPUR UNIT @ H.L.
  - DISTRIBUTION BOX
  - WALL SPEAKERS AT SLAB SOFFIT LEVEL AND SPEAKER SOCKET TO THE CONTROL ROOM
  - DATA POINT
  - Wall Mount Air Conditioner
  - Outdoor Condensing Unit
- NOTE:**
1. ALL WIRING TO BE OF APPROVED STANDARDS
  2. POWER/IT/COMPUTER SOCKETS = 300MM - 450MM FROM FLOOR FIN. LEVEL
  3. SWITCH CONTROL / SOCKET = 1100MM - 1200MM FROM FLOOR FIN. LEVEL
  4. KITCHEN SOCKETS / PANTRY SOCKETS = 1150MM - 1250MM FROM FLOOR FIN. LEVEL
  5. AC = 2500MM - 2700MM FROM FLOOR FIN. LEVEL
  6. ALL SPEAKERS SOCKET SHALL BE AT CONTROL ROOM

ALL ELECTRICAL COMPONENT TO BE CONNECTED TO THEIR RESPECTIVE DB

SPEAKERS TO BE CONNECTED TO THE MAIN PA SYSTEM OF THE SCHOOL

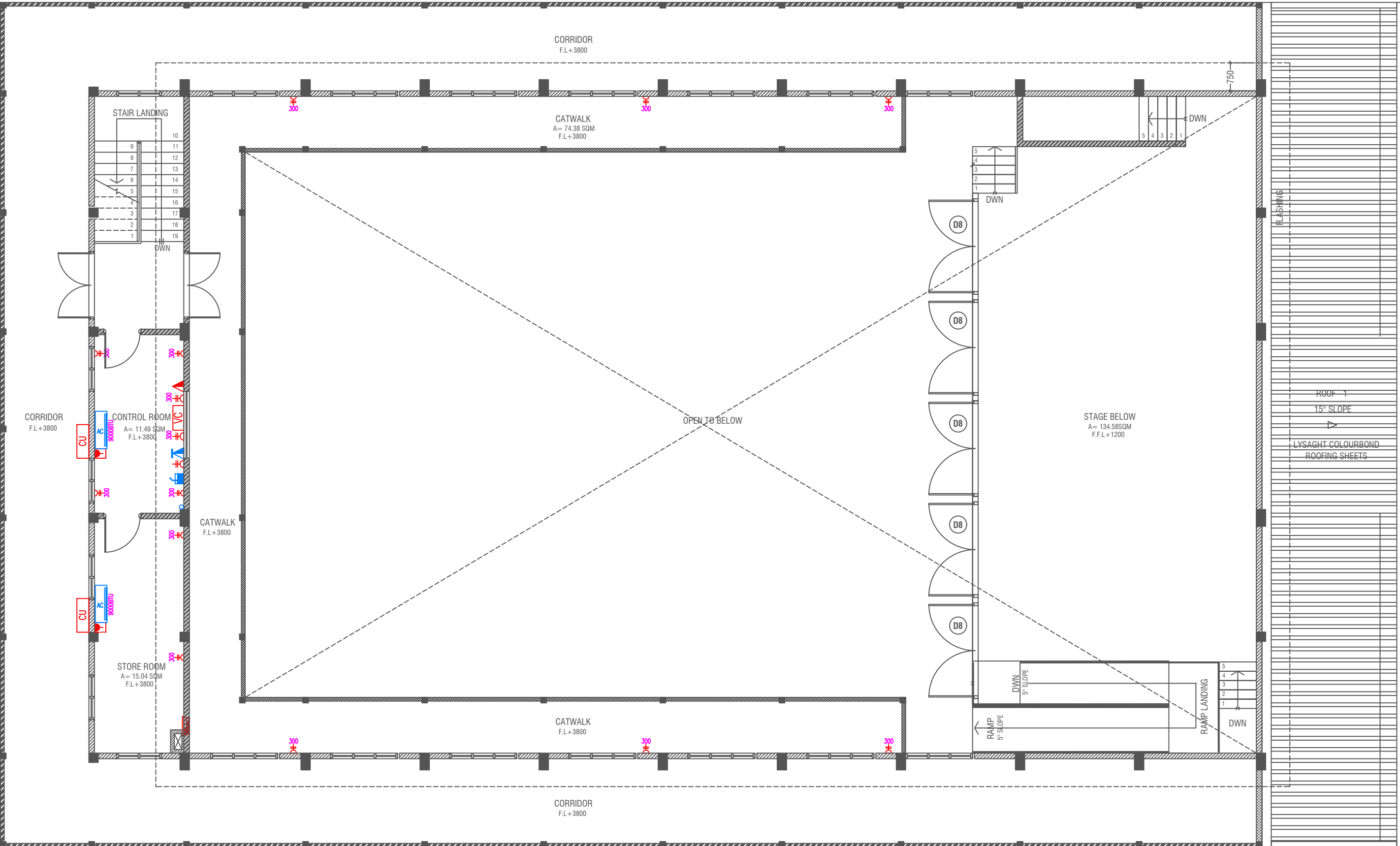

# FIRST FLOOR POWER LAYOUT

SCALE 1:100

- PUBLIC ADDRESS SYSTEM
- PHONE EXTENSION
- COMPUTER NETWORK OUTLET (RJ 45 CONNECTORS)
- TELEPHONE OUTLET (RJ11, CONNECTOR)
- 13A POWER POINT
- 13A TWIN SOCKET OUTLET
- 15A SWITCHED/ SPUR UNIT @ H.L.
- DISTRIBUTION BOX

- WALL SPEAKERS AT CEILING LEVEL AND SPEAKER SOCKET TO THE CONTROL
- VOLUME CONTROLLER

- NOTE:**
1. ALL WIRING TO BE OF APPROVED STANDARDS
  2. POWER/IT/COMPUTER SOCKETS = 300MM - 450MM FROM FLOOR FIN. LEVEL
  3. SWITCH CONTROL / SOCKET = 1100MM - 1200MM FROM FLOOR FIN. LEVEL
  4. KITCHEN SOCKETS / PANTRY SOCKETS = 1150MM - 1250MM FROM FLOOR FIN. LEVEL
  5. AC = 2500MM - 2700MM FROM FLOOR FIN. LEVEL

- Wall Mount Air Conditioner
- Ceiling Conductor Unit

ALL ELECTRICAL COMPONENT TO BE CONNECTED TO THEIR RESPECTIVE DB

SPEAKERS TO BE CONNECTED TO THE MAIN PA SYSTEM OF THE SCHOOL

Gdh. Gandhoo School Hall  
Client: Ministry of Education

Rev no	Date



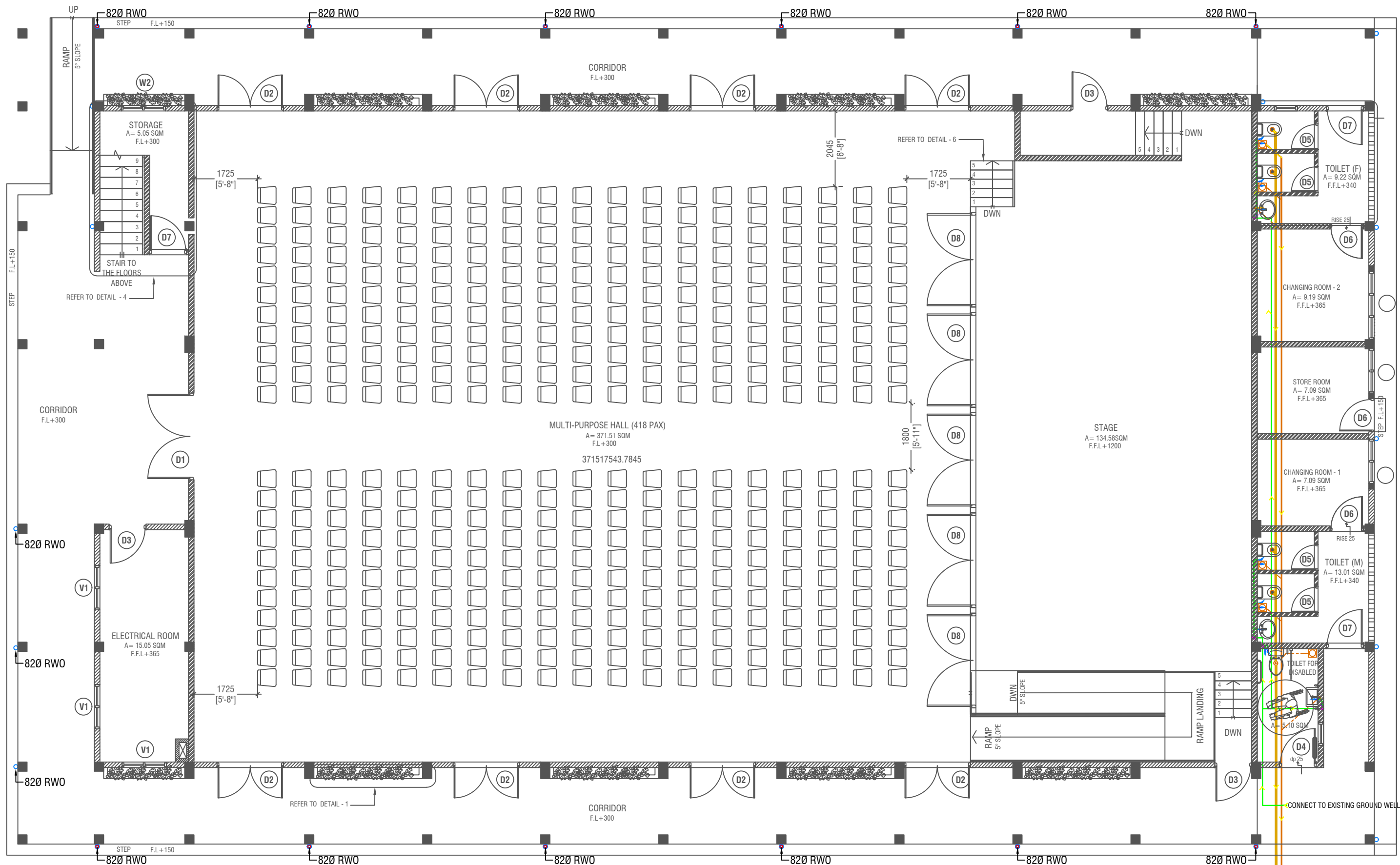

# GROUND FLOOR PLUMBING & DRAINAGE LAYOUT

SCALE 1:100



### LEGEND

- |     |   |      |                               |
|-----|---|------|-------------------------------|
| FC  | 160 COLD WATER SUPPLY FAUCET / WALL TAP/SINK            | FD   | FLOOR DRAIN                   |
| GV  | 160 COLD WATER SUPPLY TO CISTERN                        | FG   | FLOOR GULLY                   |
| R   | RISE IN WALL  | 1100 | SOIL PIPE (CPVC PIPE)         |
| D   | DROP IN WALL  | 820  | WASTE PIPE (CPVC PIPE)        |
| --- | 320 COLD WATER SUPPLY PIPES RUNNING UNDERGROUND         | 400  | WASTE PIPE (CPVC PIPE)        |
| --- | 250 COLD WATER SUPPLY PIPES RUNNING IN WALLS            | 500  | WASTE PIPE (CPVC PIPE)        |
| --- | 250 COLD WATER SUPPLY PIPES RUNNING UNDERGROUND         | 820  | MANHOLE VENT PIPE (CPVC PIPE) |
| --- | 250 COLD WATER SUPPLY PIPES RUNNING ABOVE FALSE CEILING | BT   | BOTTLE TRAP                   |
|     |   | GS   | GROUND WATER SUPPLY           |

**NOTE:**  
 - ALL RAINWATER PIPES TO BE AT GROUND LEVEL DISCHARGED THROUGH A PERFORATED COWL OR TO A SOAK PIT  
 - ALL SOIL AND WASTE PIPES TO BE AT GROUND LEVEL, UNDER THE SLAB.  
 - ALL COLD WATER PIPES SHOULD BE CPVC

**NOTE:**  
 - THE WELL SHALL BE RELOCATED ACCORDING TO THE SALINITY OF THE GROUND WATER.  
 - BASED ON WELL LOCATION PUMP CAPACITY AND LOACTION TO BE DECIDED

Gdh. Gandhoo School Hall  
 Client: Ministry of Education

Project Number: .....  
 Date: February 2024  
 Architect: .....  
 Drawn by: .....  
 Services: .....  
 Interior: .....

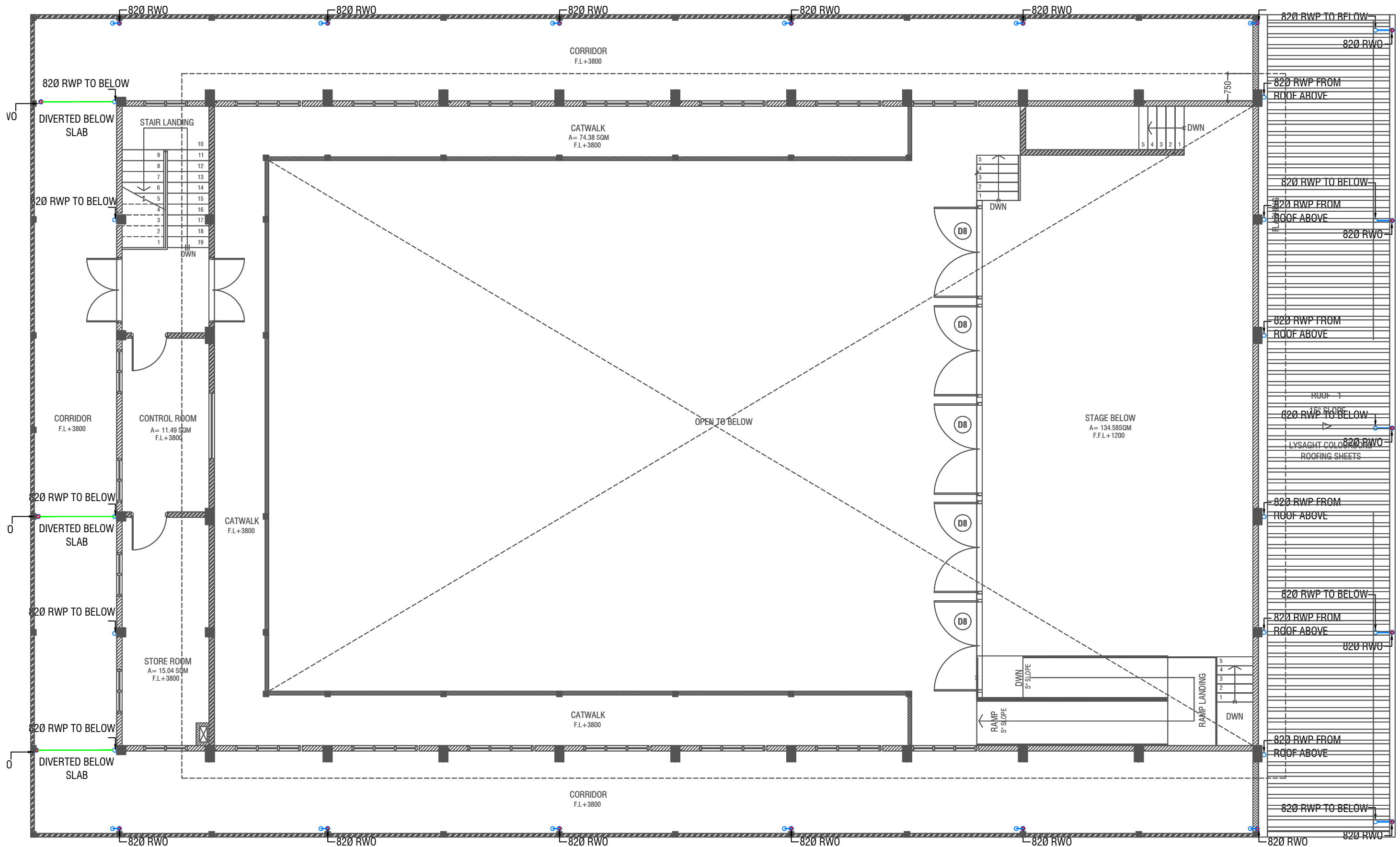

# FIRST FLOOR DRAINAGE LAYOUT

SCALE 1:100



- RWP — 82/50 Ø RAINWATER PIPE
- RWO — 82/50 Ø DRAIN OUTLET
- CD — 25 Ø DRAIN PIPE
- MHVP — 50 Ø MANHOLE VENT PIPE

**NOTE:**  
 - ALL RAINWATER PIPES TO BE AT GROUND LEVEL  
 DISCHARGED THROUGH A PERFORATED COWL OR TO A SOAK PIT

Gdh. Gahdhoo School Hall  
 Client: Ministry of Education

Rev no	Date



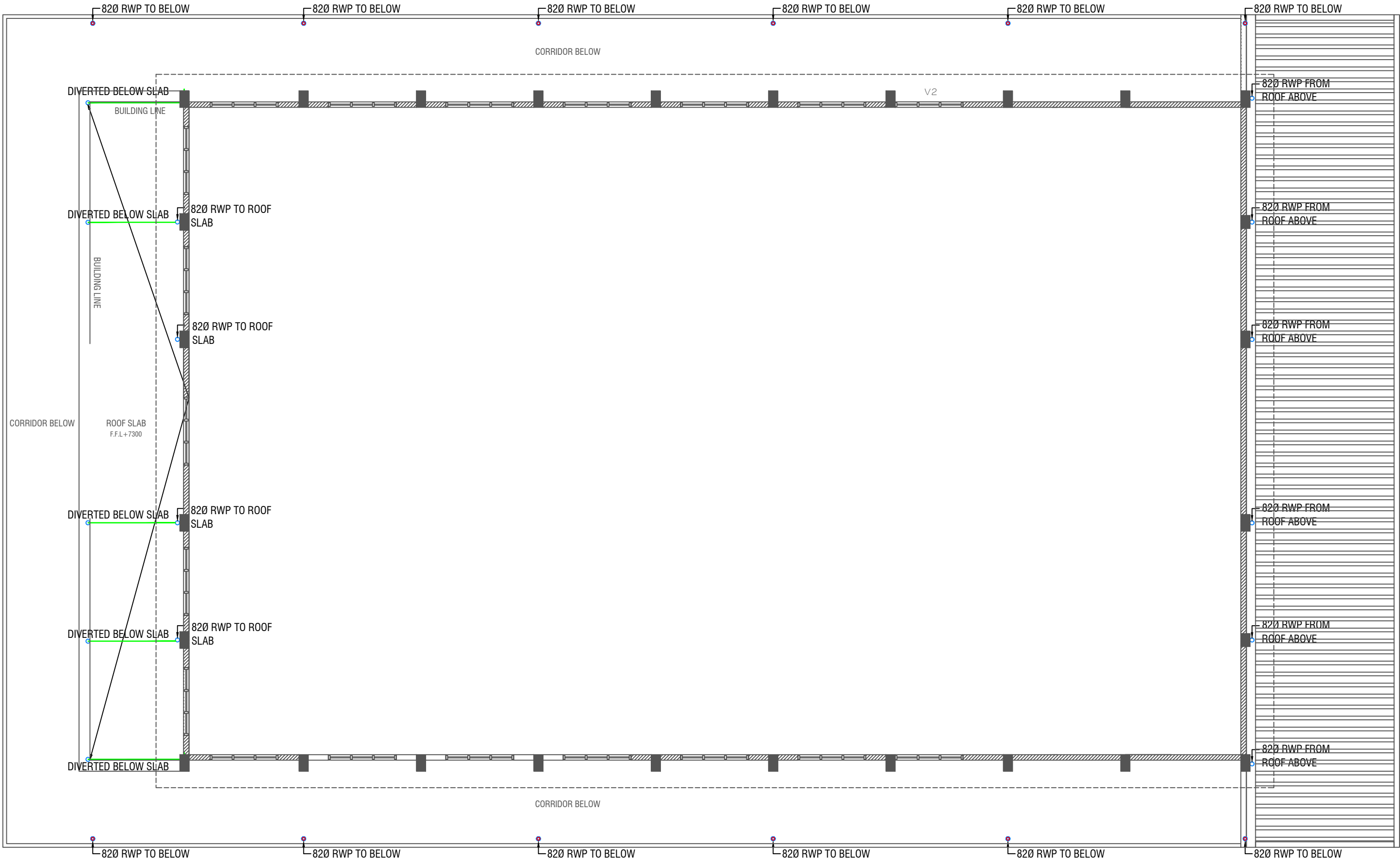

## ROOF PLAN - 1 DRAINAGE LAYOUT

SCALE 1:100



- RWP — 82/50 Ø RAINWATER PIPE
- RWO ● 82/50 Ø DRAIN OUTLET
- CD — 25 Ø DRAIN PIPE
- MHVP — 50 Ø MANHOLE VENT PIPE

**NOTE:**  
 - ALL RAINWATER PIPES TO BE AT GROUND LEVEL  
 DISCHARGED THROUGH A PERFORATED COWL OR TO A SOAK PIT

Gdh. Gahdhoo School Hall  
 Client: Ministry of Education

Project Number	Date
.....	.....
Rev no	Date
.....	.....
.....	.....
.....	.....
.....	.....
.....	.....

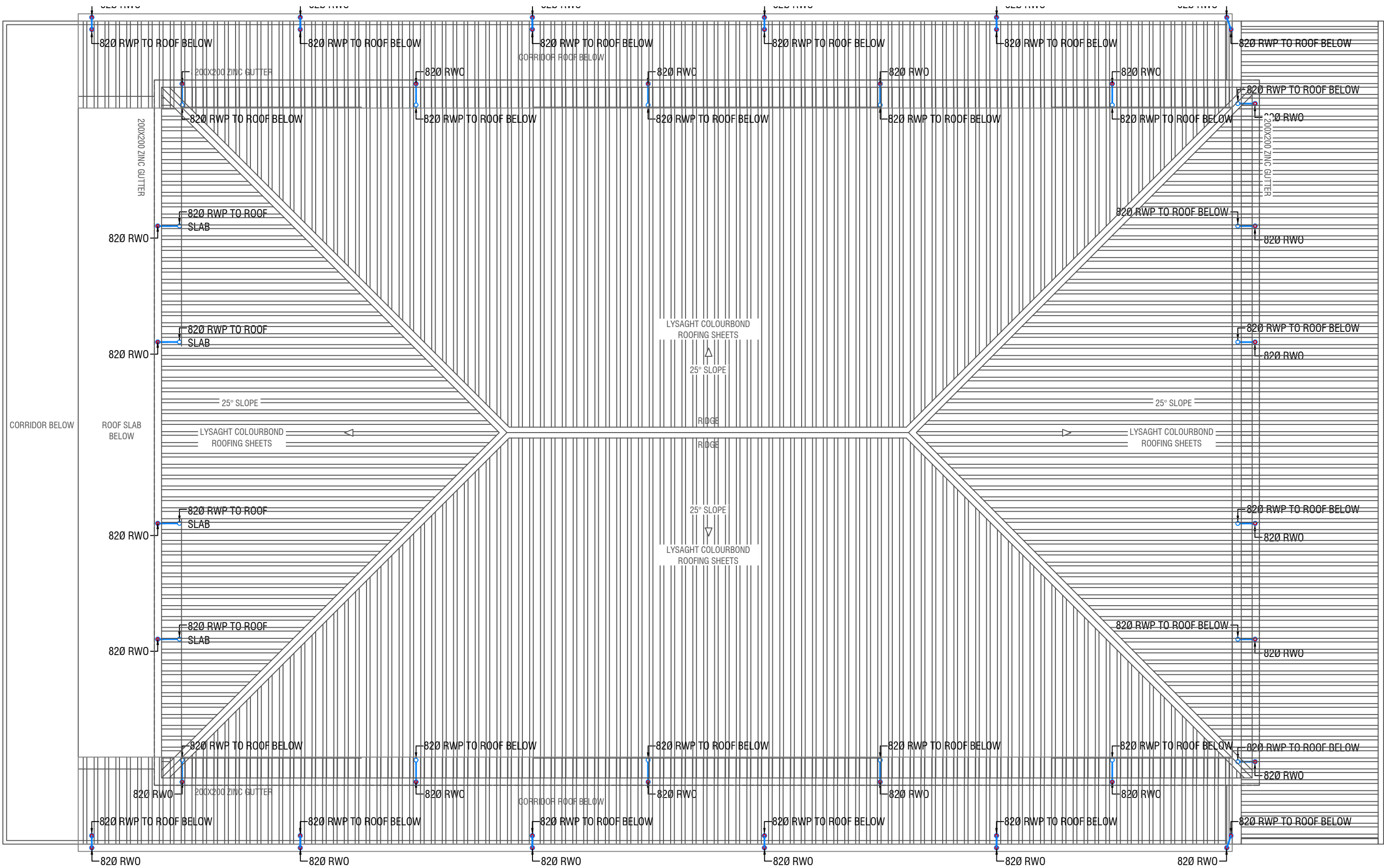

## ROOF PLAN - 2 DRAINAGE LAYOUT

SCALE 1:100



- RWO ● 82/50 Ø DRAIN OUTLET
- CD — 25 Ø DRAIN PIPE
- MHVP — 50 Ø MANHOLE VENT PIPE

**NOTE:**  
 - ALL RAINWATER PIPES TO BE AT GROUND LEVEL  
 DISCHARGED THROUGH A PERFORATED COWL OR TO A SOAK PIT



# GROUND FLOOR FDP LAYOUT

SCALE 1:100



- LEGEND**
- SD SMOKE DETECTOR
  - HD HEAT DETECTOR
  - EXIT EXIT SIGN
  - EM EMERGENCY LIGHT
  - CO<sub>2</sub> CO<sub>2</sub> EXTINGUISHER (LOAD: 2KG) IN POLYCARBONATE ENCLOSURE(TYP.)
  - WET WET CHEMICAL FIRE EXTINGUISHER (LOAD: 7.2KG)
  - H<sub>2</sub>O H<sub>2</sub>O EXTINGUISHER (LOAD: 9L) IN POLYCARBONATE ENCLOSURE(TYP.)
  - ELR END OF LINE RESISTANCE
  - FACP FIRE ALARM CONTROL PANEL
  - MCP MANUAL CALL POINT (RESETTABLE)
  - BEACON BEACON
  - SOUNDER SOUNDER BELL (85 DB)

- 1. ALL PIPES SHOULD BE GALVANIZED, SCHEDULE 40.
- 2. ALL PIPE SHALL BE PAINTED IN RED AS PER REGULATION.
- 3. ALL SUPPORT/BRAKET SHALL BE HOT DIPPED GALVANIZED TO 100MM.
- 4. ALL FIRE EXTINGUISHER INSIDE CABINETS. (CABINET SHOULD BE PROVIDED)

Gdh. Gandhoo School Hall  
Client: Ministry of Education

Rev no	Date

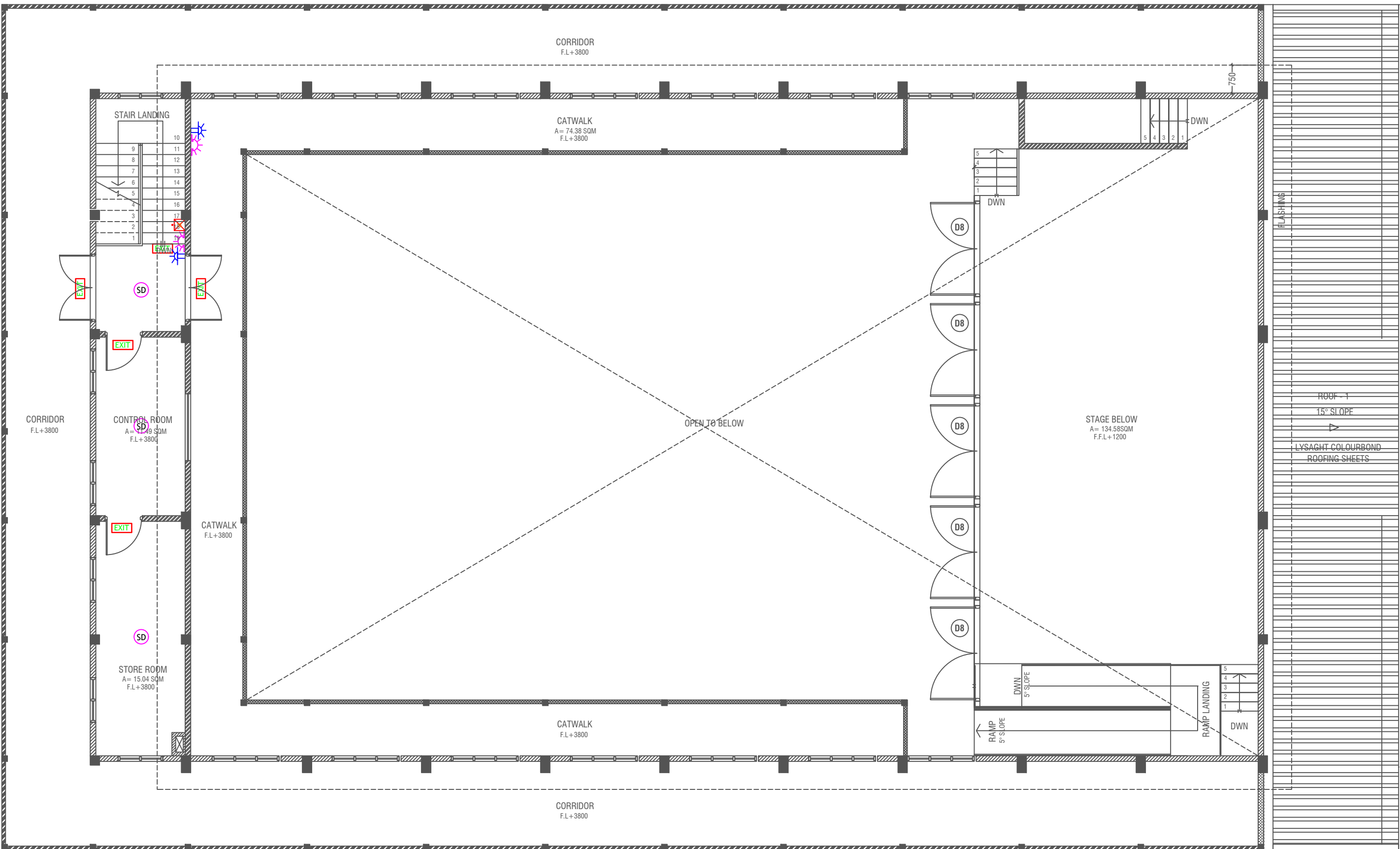

# FIRST FLOOR FDP LAYOUT

SCALE 1:100



- LEGEND**
- SD SMOKE DETECTOR
  - HD HEAT DETECTOR
  - EXIT EXIT SIGN
  - EM EMERGENCY LIGHT
  - CO<sub>2</sub> EXTINGUISHER (LOAD: 2KG) IN POLYCARBONATE ENCLOSURE (TYP.)
  - WET CHEMICAL FIRE EXTINGUISHER (LOAD: 7.2KG)
  - H<sub>2</sub>O EXTINGUISHER (LOAD: 9L) IN POLYCARBONATE ENCLOSURE (TYP.)
  - ELR END OF LINE RESISTANCE
  - FACP FIRE ALARM CONTROL PANEL
  - MCP MANUAL CALL POINT (RESETTABLE)
  - BEACON
  - SOUNDER BELL (85 DB)

- ALL FIRE RATED DOOR SHOULD COME WITH PACKING (EXPANSION SEAL TRAP)
- 1. ALL PIPES SHOULD BE GALVANIZED (SCHEDULE 40).
- 2. ALL PIPE SHALL BE PAINTED IN RED AS PER REGULATION.
- 3. ALL SUPPORT/BRACKET SHALL BE HOT DIPPED GALVANIZED TO 100µM.
- 4. ALL FIRE EXTINGUISHER INSIDE CABINETS. (CABINET SHOULD BE PROVIDED)

Gdh. Gahdhoo School Hall  
Client: Ministry of Education

Rev no	Date

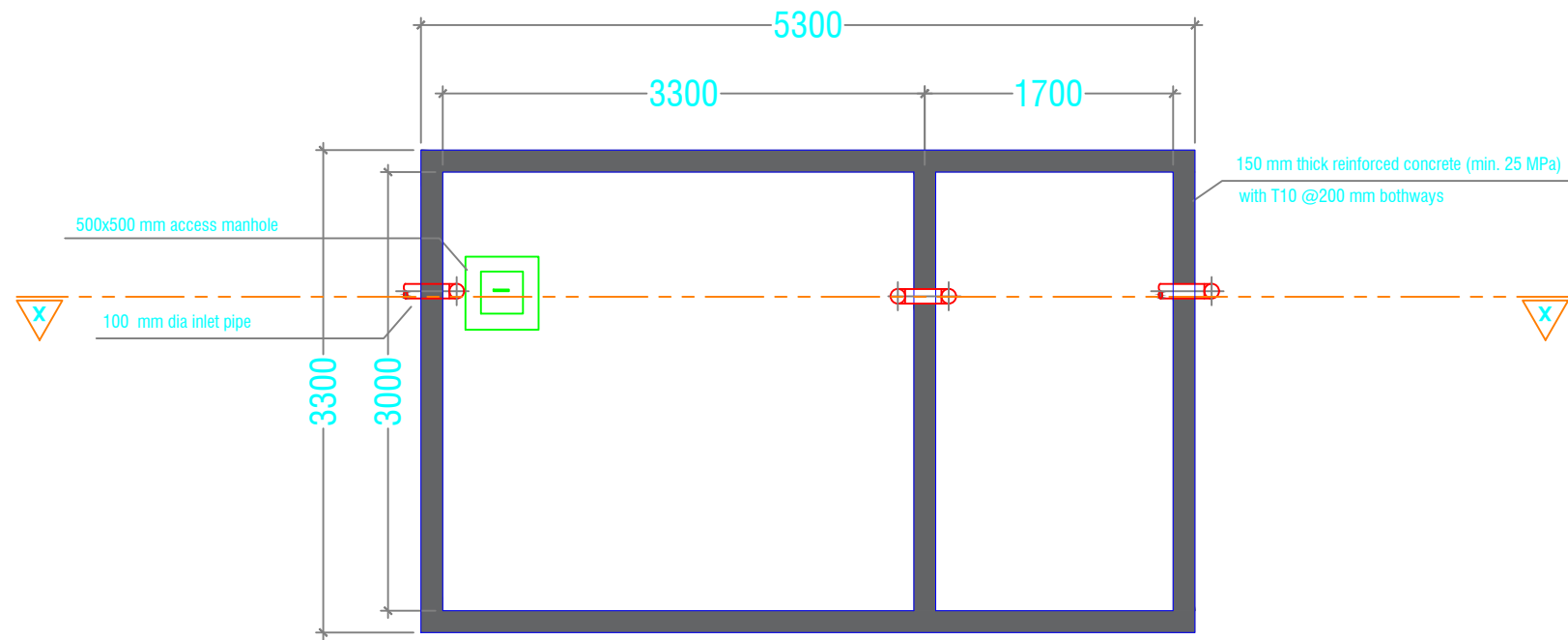

**PLAN**

SCALE 1:50

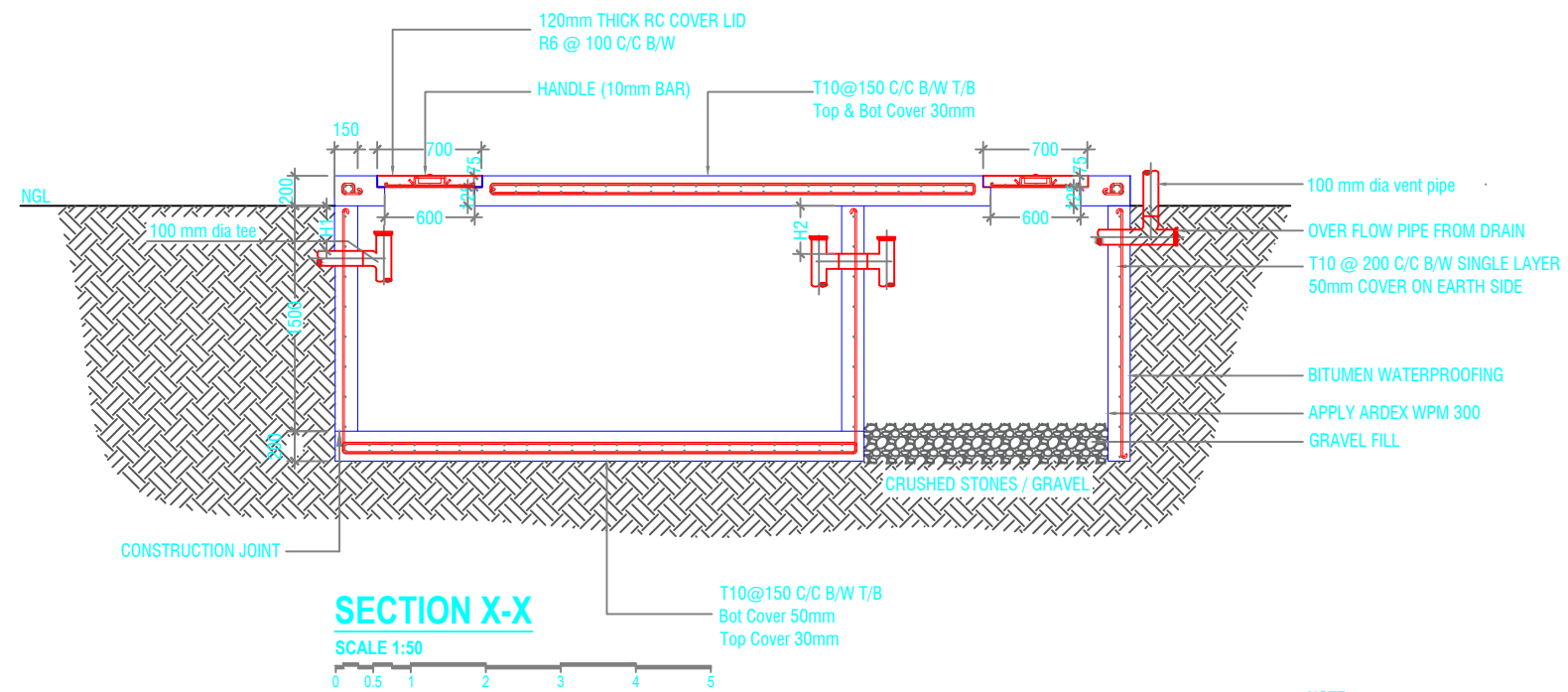

**SECTION X-X**

SCALE 1:50



**SEPTIC TANK DETAIL**

SCALE 1:50



**NOTE:**

H1 < H2

- TOP AND BOTTOM OF SEPTIC TANK SHOULD BE OF 200mm THICK
- BITUMINOUS WATERPROOFING TO BE APPLIED BELOW GROUND SURFACE
- REINFORCEMENT TO HAVE A COVER OF 50mm FROM EARTH

Rev no	Date