

FLOOR PLAN

SCALE: 1 : 100

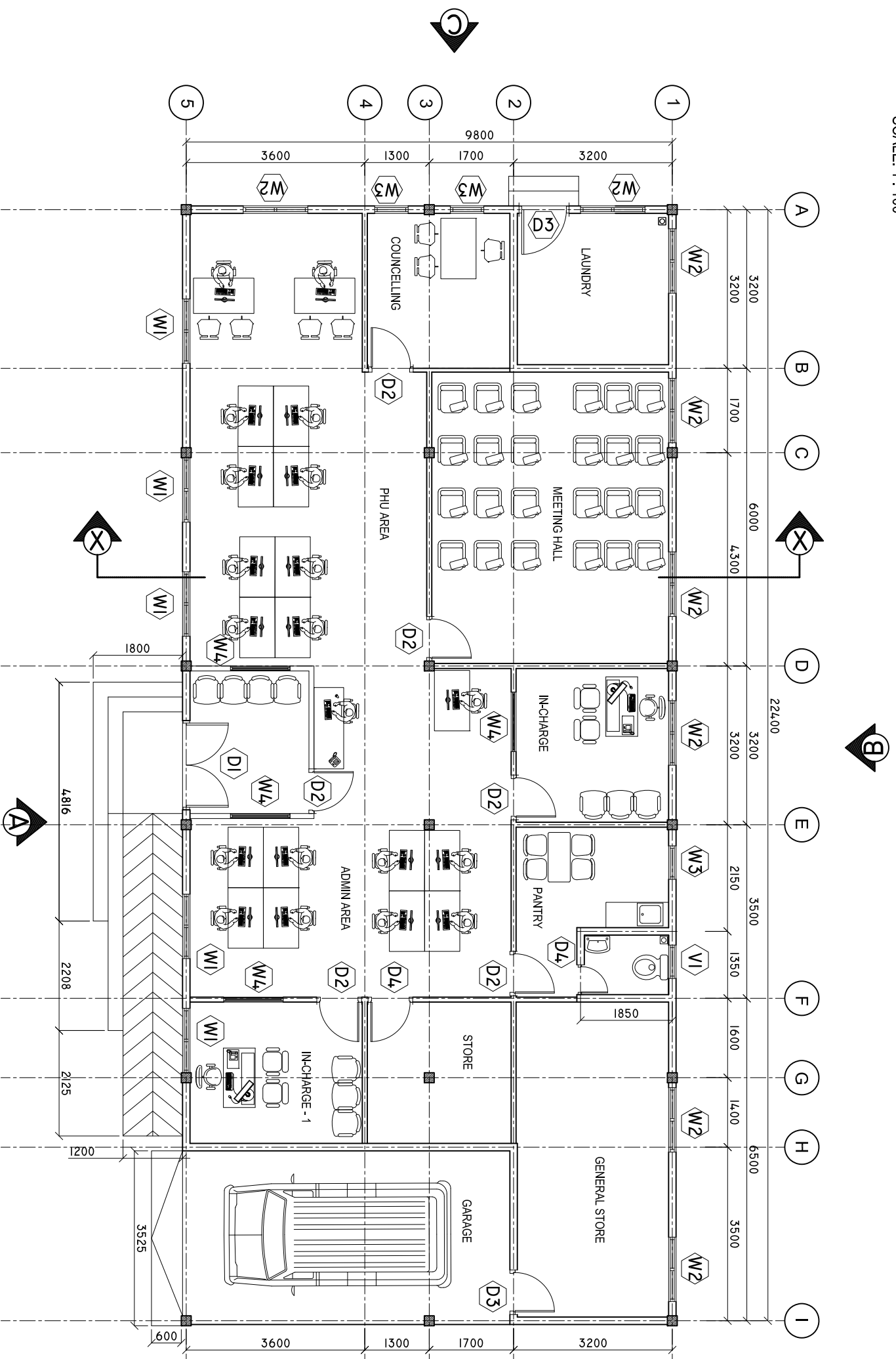

SHEET CONTENTS :

REVISION NOTES:

REVISED ON 14, OCT 2019.

PROJECT:
CONSTRUCTION OF HA.
BAARAH HEALTH
CENTER EXTENSION

CLIENT:
MINISTRY OF HEALTH

LOCATION:
HDH, HA, BAARAH

CONTENTS: AS GIVEN

PROJECT MANAGER:

DESIGNER: ARIZ

CIV/STR. ENGINEER:

SURVEYED BY: -

DRAWN BY: ARIZ

CHECKED BY:

DATE : OCTOBER 2019

SHEET NO. : /



ADMIN DIVISION
Ministry of Health
Roshanwe Building
Sasun Nagar
Tel: 332 8887, Fax: 332 8889