

DETAIL B

SCALE: 1 : 10

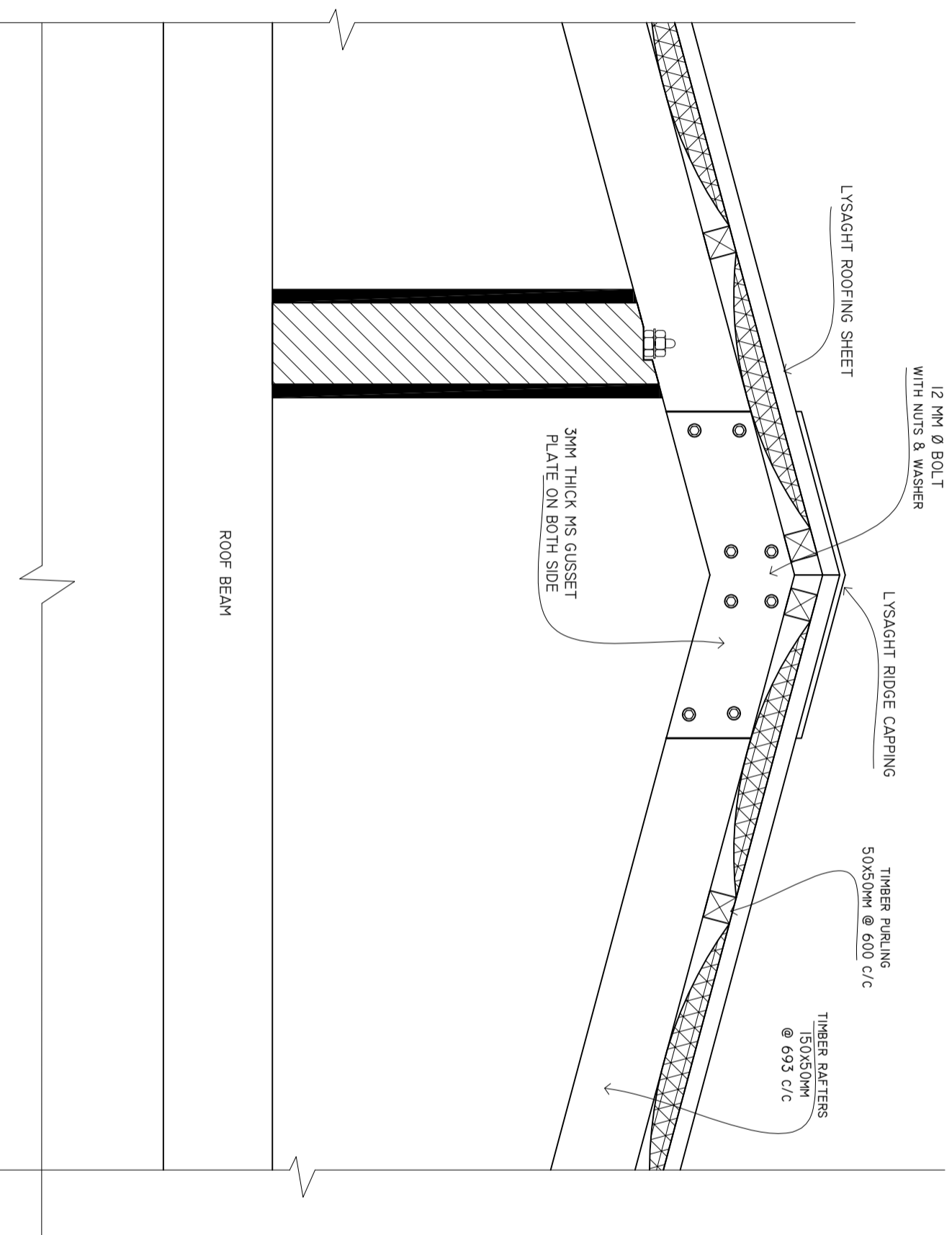

SHEET CONTENTS :

REVISION NOTES:

PROJECT:
CONSTRUCTION OF OPD
AREA AT N. ATOLL
HOSPITAL.

CLIENT:
MINISTRY OF HEALTH

LOCATION:
N. MANADHOO ISLAND

CONTENTS: AS GIVEN

PROJECT MANAGER:
DESIGNER: ARIZ
CIV/STR. ENGINEER:
SURVEYED BY: -
DRAWN BY: ARIZ
CHECKED BY:
DATE : FEBRUARY 2020
SHEET NO. : /

ADMIN DIVISION
Ministry of Health
Roshanee Building
Sosun Maga
Tel: 332 8887, Fax: 3328889