

100 Football pitch Project



Football Ground: S. Hithadhoo
Site visit report – supporting information

Date of visit	12 th January 2021	
Site address	S. Hithadhoo	
Weather Condition during site visit	Hot dry and sunny	
Officials present during site visit	Council representative, Youth Associate to Hithadhoo and Feydhoo	
Local Contact details	Island:	S. Hithadhoo(Island)
	Contact name:	Mr. Aik
	Designation	Youth Associate
	Addresss:	
	Tel:	7784899
	e-mail	
	Fax:	

Scope of the Project	Design and construction of full-size football Artificial turf pitch (Sub base)				
	Category of pitch requirement	FIFA Recommended			
	Level of competition and activities & requirement	National Level			
Proposed usage	Level of play	National Level			
	Intensity of paly per week / year	+/- 36 hrs. /week			
Field orientation	North / South				
Proposed filed dimensions					
		Length		Width	
	Field size	100m		64m	
	Run – off area	North	South	West	East
		3m	3m	2.5m	2.5m
	Total Green area (synthetic)	106m x 69m			
Spectator Area	No spectator area built, Existing pavilion				
Fencing	build boundary wall with pvc coated fence				

<p>Ground Conditions: Proposed site is located in the central area of the island;4 trial holes were made. Most part is covered with grass, Noticed +/- 350 mm of good soil(reclaimed sand) have to be scrapped and back filled with reclaimed sand damped for compaction create sub base ready for installation</p>	
<p> </p>	
<p>Groundwater evidence</p>	<p>Location is the central area of the island, according to the represents on site water is likely very shallow. Evidence of water found in the 3 out of 4 trial holes made (+/- 2ft deep)</p>
<p>Topography</p>	<p>Old surface with mostly covered with grass and, generally a football size area flat</p>
<p>Drain Outlet</p>	<p>public sewerage pipe or system in place, Gutter and soak-pit system is designed with sufficient number of soak pits due to the size of the area.</p>
<p>Existing Service & sports lighting</p>	<p>Floodlight and a small pavilion in the allocated land, floodlight may not be enough.</p>
<p>Disposal of Spoil</p>	<p>All removed spoil sand disposal must be finalized with a consent from local council.</p>

Site Photos



Trial Holes



Construction Detail: Allocated land is slightly smaller to construct a full pitch, however 100 x 64 pitch will be an ideal construction for the plot allocated.		
Site access	Proposed site may have some degree of difficulty, all sides except North will not be easy, due to the narrow roads.	
Site Compound	It's located near south of the island, transporting materials may course some degree of difficulty due to the size of the surrounding roads	
Best time of the year to construct	No significant time of the year	
Working restriction	Beside the plot on East side, a mosque is there, prayer time must be notified and local culture with regard to prayer times must be respected at all times.	
Drainage	Gutter and soak-pit system in base construction, Local Sewerage system in place, Existing base is filled with reclaimed sand water will infiltrate.	
Provision for new functional extension	Plot of land allocated is not rectangular in shape, orientation of the pitch and footprint must be laid in a way space is best utilized. South side with space for further development,	
Maintenance equipment requirement	TBC	
Sports equipment	TBC	

Other Consideration

- Irregular shape of the proposed land. Orientation may have to be changed to best utilize the space for further development of the facility
- Easy access to the facility for vehicles (Ambulance)
- Potential outlet for field drainage connecting to local sewerage system
- Power supply to football field should be a direct cable from the power house avoiding interference to public households during an event.

PPROPOSED INDICATIVE LAYOUT

Existing pavilion in south East side of the plot

Spectator area to be development by Council, footprint of the pitch according to the concept by council

Drawing of the pitch area

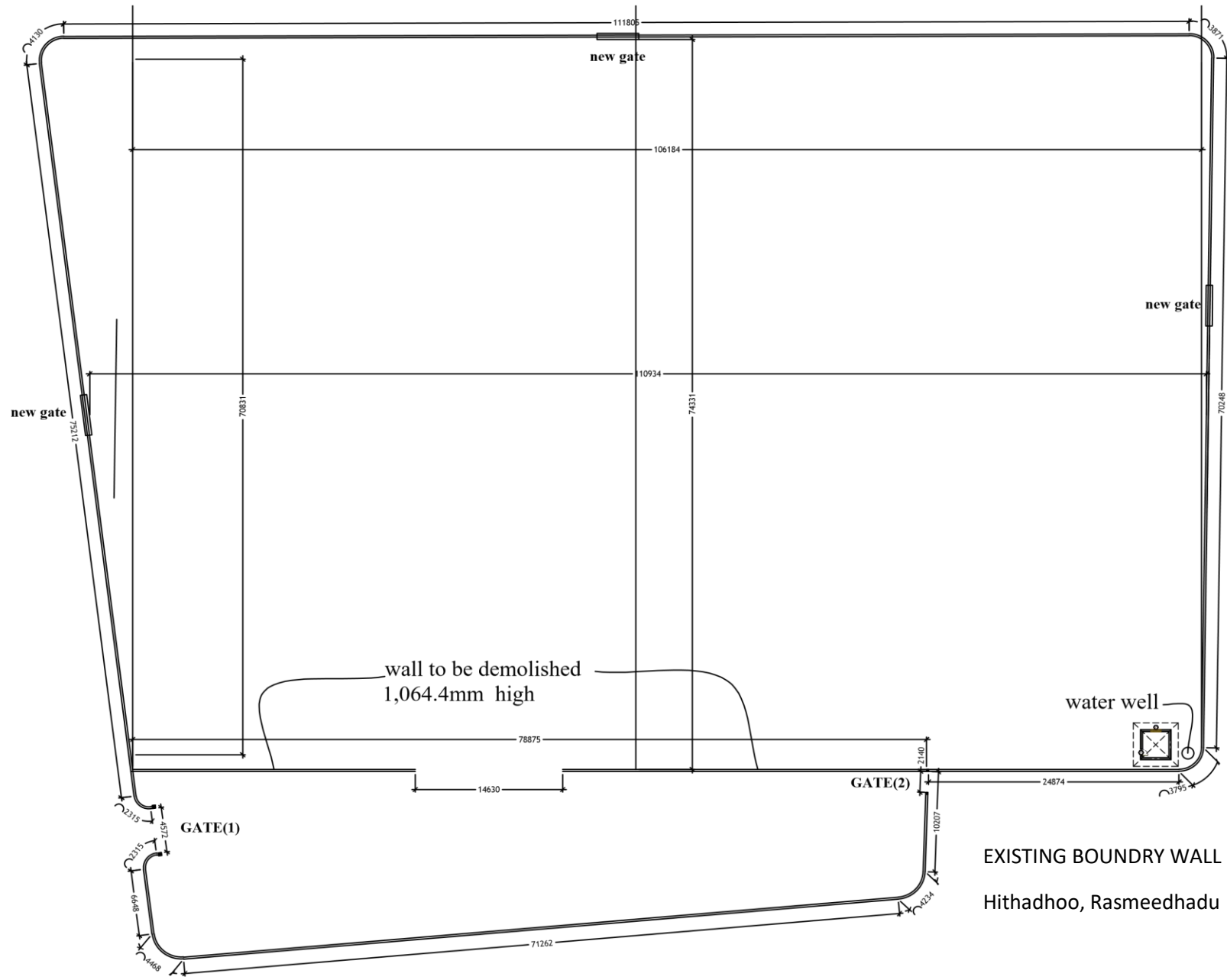

EXISTING BOUNDARY WALL
Hithadhoo, Rasmeedhadu