

Proposed 02 Classroom Block at
HDh. Nellaidhoo School
(02 Storey)

SERVICES DRAWING
Client: Ministry of Education



RIYAN PRIVATE LIMITED

t : +9603315049 f : +9603310776
e : info@riyan.com.mv
w : www.riyan.com.mv

3rd floor, H. Azum, Arneeremagau, Male'

TABLE OF CONTENTS

DRAWING No.	TITLE	REVISION No.	DATE	REMARKS
A R C H I T E C T U R A L		---	---	---
DR - 01 /03	GROUND FLOOR DRAINAGE LAYOUT	---	---	---
DR - 02 /03	1ST FLOOR DRAINAGE LAYOUT	---	---	---
DR - 03 /03	ROOF DRAINAGE LAYOUT	---	---	---
EL - 01 / 02	GROUND FLOOR LIGHTING LAYOUT	---	---	---
EL - 02 / 02	1ST FLOOR LIGHTING LAYOUT	---	---	---
EP - 01 / 02	GROUND FLOOR POWER LAYOUT	---	---	---
EP - 02 / 02	1ST FLOOR POWER LAYOUT	---	---	---



HDh.Nellaidhoo School - 02 Classroom (02 Storey)
Client: Ministry of Education

Project Number: RI(2019)/012
Date: June 2019

	Rev no	Date
Architect :	Razana Amir	
Engineer :	Insaan Waheed	
Drawn by :	Mohamed Yasbiq	
Services :	Aishath Ahmed	
Interior :-		

Project Number: RI/2019/012
Date: June 2019
Architect : Razana Amir
Engineer : Ihsaan Waheed
Drawn by : Mohamed Yasbiq
Services : Aishath Ahmed
Interior : -



t: +9603315049 f: +9603310776
e: info@riyan.com.mv
w: www.riyan.com.mv
3rd floor, H. Azum, Ameenemagu, Male'

Page: DR 01-03

FIRST FLOOR DRAINAGE LAYOUT

SCALE 1:75

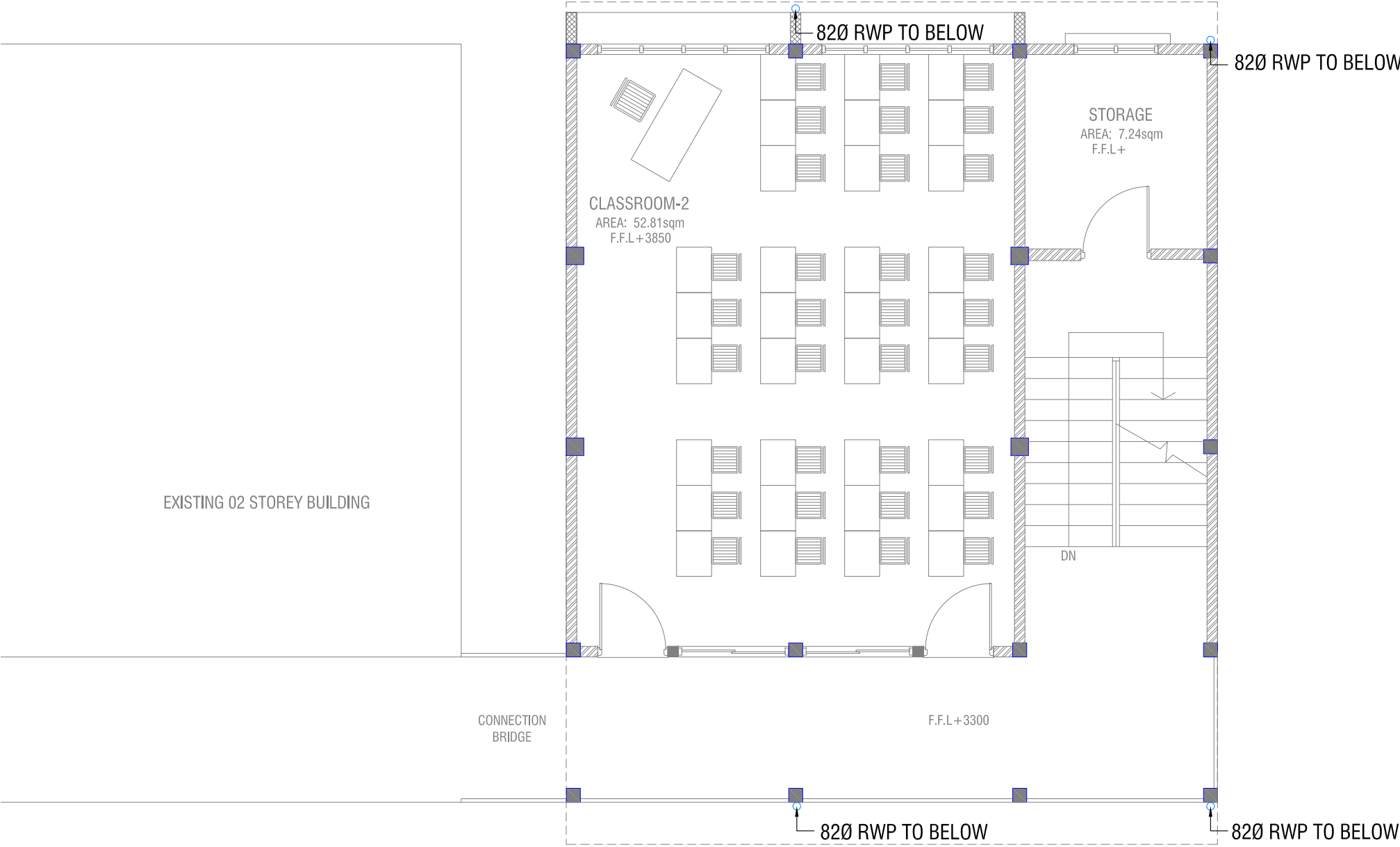

- LEGEND
- FG FLOOR GULLY
 - FD FLOOR DRAIN
 - WM 40 Ø STUB FOR WASHING MACHINE
 - SP 110 Ø SOIL PIPE
 - SVP 110 Ø SOIL VENT PIPE
 - WP 82 Ø WASTE PIPE
 - WVP 82 Ø WASTE VENT PIPE
 - WP 40 Ø WASTE PIPE
 - RWP 110 Ø RAINWATER PIPE
 - CD 25 Ø DRAIN PIPE
 - MHVP 50 Ø MANHOLE VENT PIPE

HDh.Nellaidhoo School - 02 Classroom (02 Storey)

Client: Ministry of Education

Project Number: RI/2019/012
Date: June 2019
Architect: Razana Amir
Engineer: Ihsaan Waheed
Drawn by: Mohamed Yasbiq
Services: Aishath Ahmed
Interior: -

Rev no	Date
-	-
-	-
-	-



RYAN PRIVATE LIMITED
t: +9603315049 f: +9603310776
e: info@ryan.com.mv
w: www.ryan.com.mv
3rd floor, H. Azum, Ameenemagau, Male'

Title: First Floor
Drainage Layout

Page: DR 01-03

ROOF DRAINAGE LAYOUT

SCALE 1:75

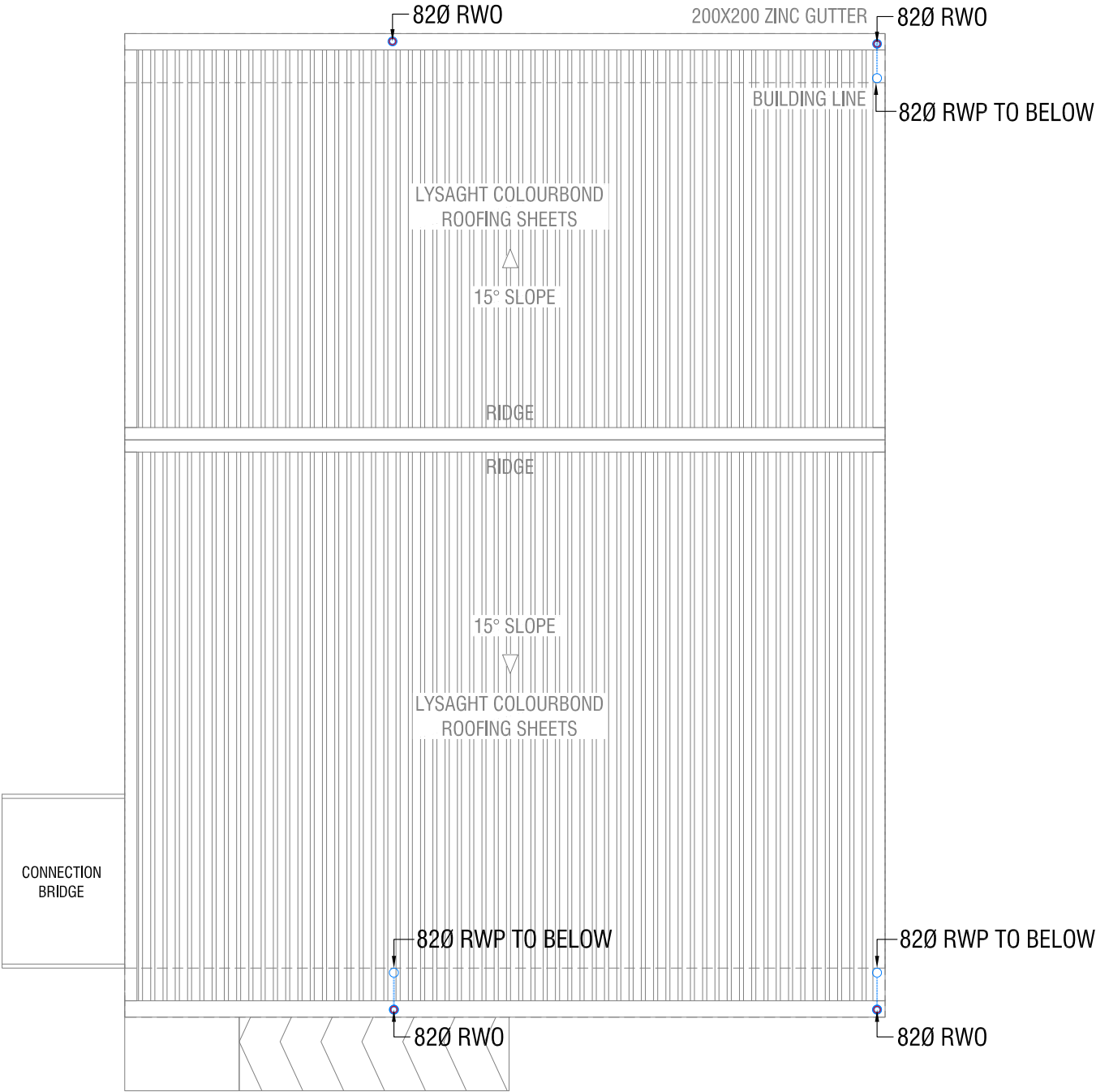

LEGEND

- FG FLOOR GULLY
- FD FLOOR DRAIN
- WM 40 Ø STUB FOR WASHING MACHINE
- SP 110 Ø SOIL PIPE
- SVP 110 Ø SOIL VENT PIPE
- WP 82 Ø WASTE PIPE
- WVP 82 Ø WASTE VENT PIPE
- WP 40 Ø WASTE PIPE
- RWP 110 Ø RAINWATER PIPE
- CD 25 Ø DRAIN PIPE
- MHVP 50 Ø MANHOLE VENT PIPE

Rev no	Date
-	-
-	-
-	-



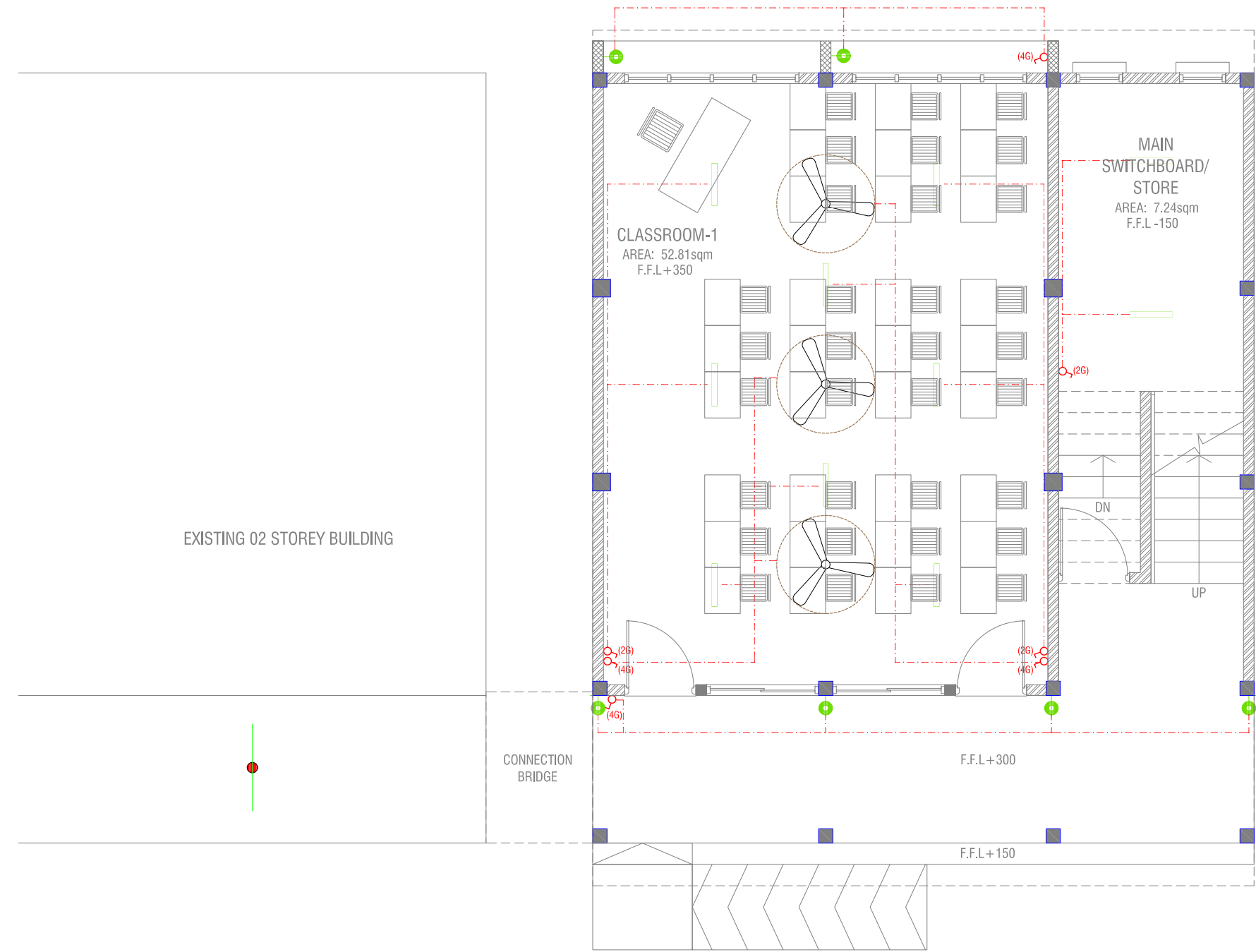

LEGEND

WPD

OUT DOOR WALL LIGHT

ML

MIRROR LIGHT (7W LED LIGHT)

H2

RECESSED DOWN LIGHT 12W

CL

CEILING LIGHT 18W CFL

WP

2 X 4' TUBE LIGHT WITH WEATHER PROOF OPAL CASING

C2

CEILING DOWN LIGHT (18W)

LIGHT SWITCH

SWITCHING LINE

CL2

2 X 4' FLUORESENT LIGHT WITH OPAL CASING

CEILING FAN (52" - 54")

NOTE:

- ALL WIRING TO BE OF STELCO APPROVED STANDARDS

- SWITCH CONTROL = 1200MM FROM FLOOR FIN. LEVEL

-ALL LIGHTING POINTS CONNECTED TO THEIR RESPECTIVE DB

GROUND FLOOR LIGHTING LAYOUT
SCALE 1:75



HDh.Nellaidhoo School - 02 Classroom (02 Storey)
Client: Ministry of Education

Rev no	Date
-	-
-	-
-	-
-	-

Project Number: RI/2019/012
Date: June 2019
Architect : Razana Amir
Engineer : Ihsaan Waheed
Drawn by : Mohamed Yasbiq
Services : Aishath Ahmed
Interior : -

RIYAN PRIVATE LIMITED

t : +9603315049 f : +9603310776

e : info@riyan.com.mv

w : www.riyan.com.mv

3rd floor, H. Azum, Ameeneneeragu, Male'

The contents of these drawings remain as a property of Riyan Private Limited. Any use other than those expressly stated is a violation of this copyright

FIRST FLOOR LIGHTING LAYOUT

SCALE 1:75

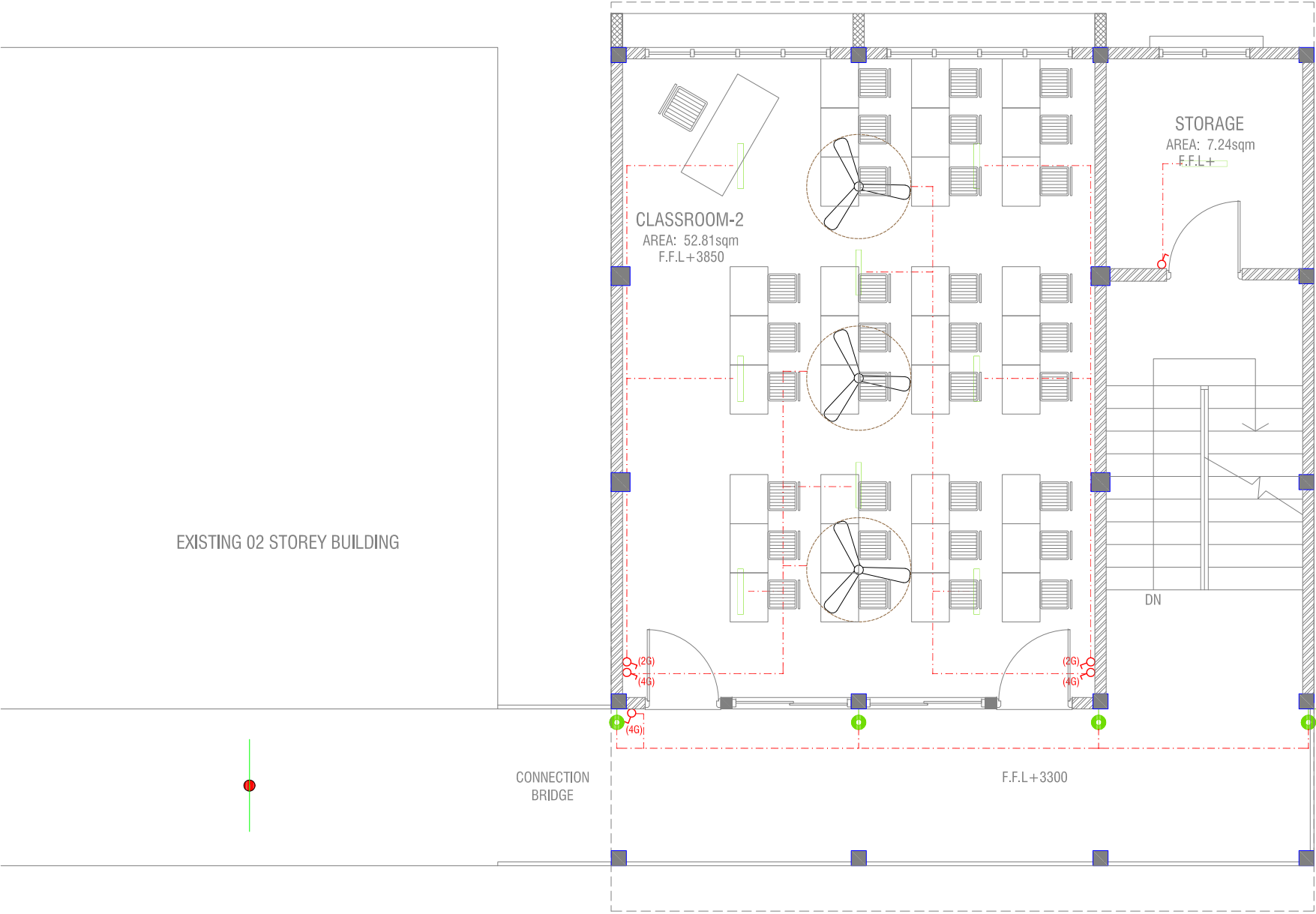

LEGEND

- WPD OUT DOOR WALL LIGHT
- ML MIRROR LIGHT (7W LED LIGHT)
- H2 RECESSED DOWN LIGHT 12W
- CL CEILING LIGHT 18W CFL
- WP 2 X 4' TUBE LIGHT WITH WEATHER PROOF OPAL CASING
- C2 CEILING DOWN LIGHT (18W)
- LIGHT SWITCH
- SWITCHING LINE
- CL2 2 X 4' FLUORESENT LIGHT WITH OPAL CASING



NOTE:

- ALL WIRING TO BE OF STELCO APPROVED STANDARDS
- SWITCH CONTROL = 1200MM FROM FLOOR FIN. LEVEL
- ALL LIGHTING POINTS CONNECTED TO THEIR RESPECTIVE DB

Rev no	Date
-	-
-	-
-	-
-	-

Project Number: RI/2019/012
Date: June 2019
Architect : Razana Amir
Engineer : Ihsaan Waheed
Drawn by : Mohamed Yasbiq
Services : Aishath Ahmed
Interior : -



RIYAN PRIVATE LIMITED
t : +9603315049 f : +9603310776
e : info@riyan.com.mv
w : www.riyan.com.mv
3rd floor, H. Azum, Ameenemaguu, Male'

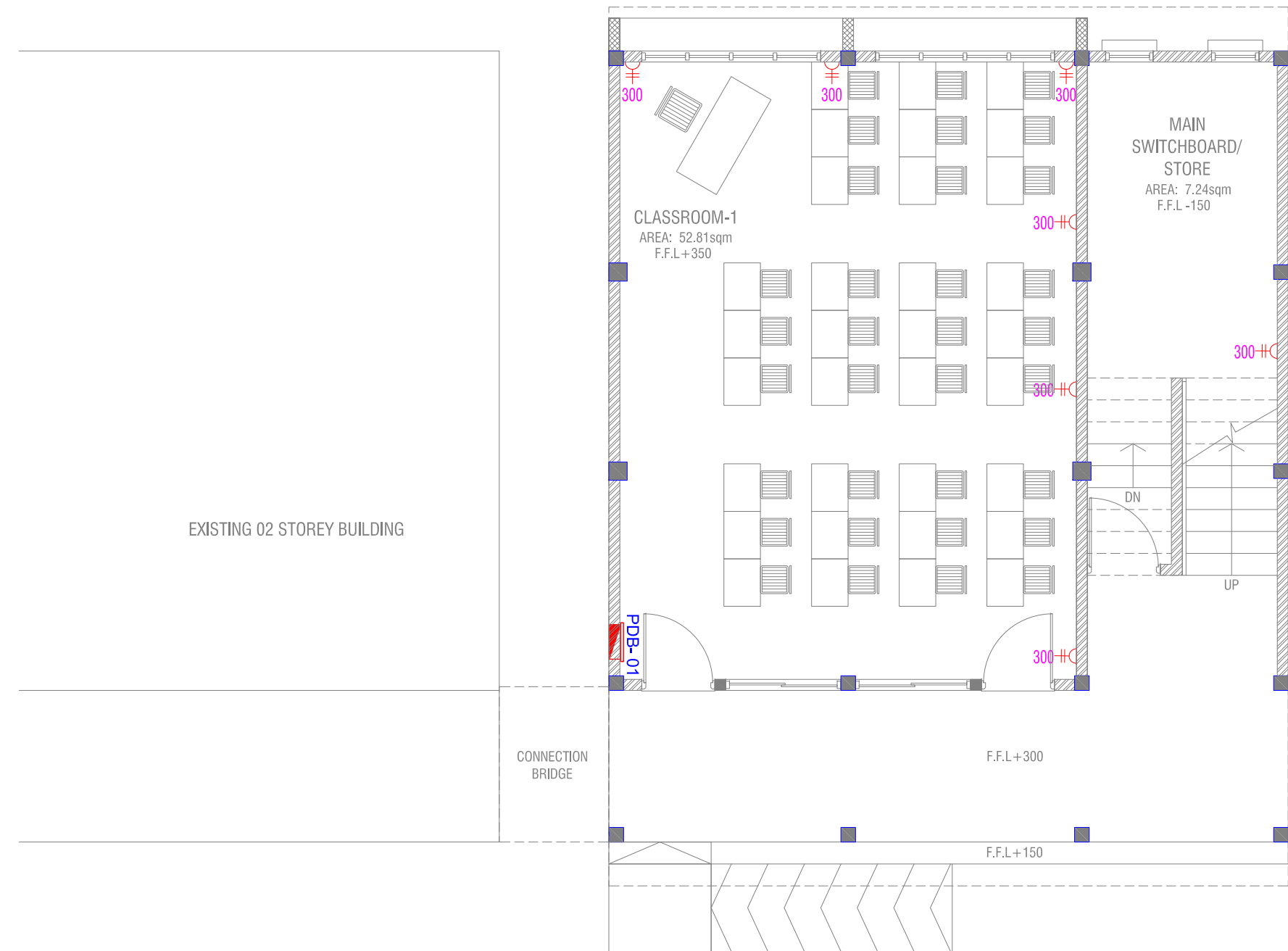

GROUND FLOOR POWER LAYOUT
SCALE 1:75

- LEGEND**
- PHONE EXTENSION
 - COMPUTER NETWORK OUTLET (RJ 45 CONNECTORS)
 - TELEPHONE OUTLET (RJ11, CONNECTOR)
 - 13A POWER OUTLET
 - 13A TWIN SOCKET OUTLET
 - TPN ISOLATOR
 - VGA CABLE FOR PROJECTOR
 - DISTRIBUTION BOX
 - 15A.SWITCHED/ SPUR UNIT @ H.L.
 - TWO GANG TV/SAT SOCKET OUTLET
 - HL. HIGH LEVEL
 - WPE WEATHER PROOF POLYCARBONATE ENCLOSURE
- ALL ELECTRICAL COMPONENT TO BE CONNECTED TO THEIR RESPECTIVE DB

FIRST FLOOR DRAINAGE LAYOUT

SCALE 1:75



LEGEND

- PHONE EXTENSION
- COMPUTER NETWORK OUTLET (RJ 45 CONNECTORS)
- TELEPHONE OUTLET (RJ11, CONNECTOR)
- 13A POWER OUTLET
- 13A TWIN SOCKET OUTLET
- TPN ISOLATOR
- VGA CABLE FOR PROJECTOR
- DISTRIBUTION BOX
- 15A.SWITCHED/ SPUR UNIT @ H.L.
- TWO GANG TV/SAT SOCKET OUTLET
- HL. HIGH LEVEL
- WPE WEATHER PROOF POLYCARBONATE ENCLOSURE

ALL ELECTRICAL COMPONENT TO BE CONNECTED TO THEIR RESPECTIVE DB

Rev no	Date
-	-
-	-
-	-
-	-

Project Number: RI/2019/012
Date: June 2019
Architect : Razana Amir
Engineer : Ihsaan Waheed
Drawn by : Mohamed Yasbiq
Services : Aishath Ahmed
Interior : -

