

## (IUL)22-E/1/2017/429 - FURNITURE SPECIFICATIONS:



**NAME:** F1 CHAIR

**QUANTITY:** 12

**DIMENSION:**

450mm [WIDTH]

450mm [LENGTH]

400mm [HEIGHT]

**FINISH:** GRAY SEAT WITH TIMBER LEGS



**NAME:** F2 CHAIR WITH ARM

**QUANTITY:** 08

**DIMENSION:**

450mm [WIDTH]

450mm [LENGTH]

400mm [HEIGHT]

**FINISH:** GRAY SEAT WITH ARMS AND TIMBER LEGS



**NAME:** F3 STOOL

**QUANTITY:** 04

**DIMENSION:**

480mm [WIDTH]

330mm [DEPTH]

700mm [HEIGHT]

**FINISH:** METAL STOOL WITH CUSHION



**NAME:** F8 KITCHEN CUPBOARD

**QUANTITY:** 02

**DIMENSION:**

450mm [WIDTH]

1000mm [LENGTH]

850mm [HEIGHT]

**REFER TO DETAIL F8**

**FINISH:** KITCHEN CUPBOARD IN WHITE FINISH

**MALDIVES POLYTECHNIC**

Client: Ministry of Education

Project Number: RI/2017/012

Date: September 2017

Architect : Razana Amir

Engineer : Aishath Mohammed Rasheed

Services : Aishath Ahmed

Interior : Razana Amir

Rev no	Date
01	29-10-2017



# (IUL)22-E/1/2017/429 - PROPOSED FURNITURE PLAN:

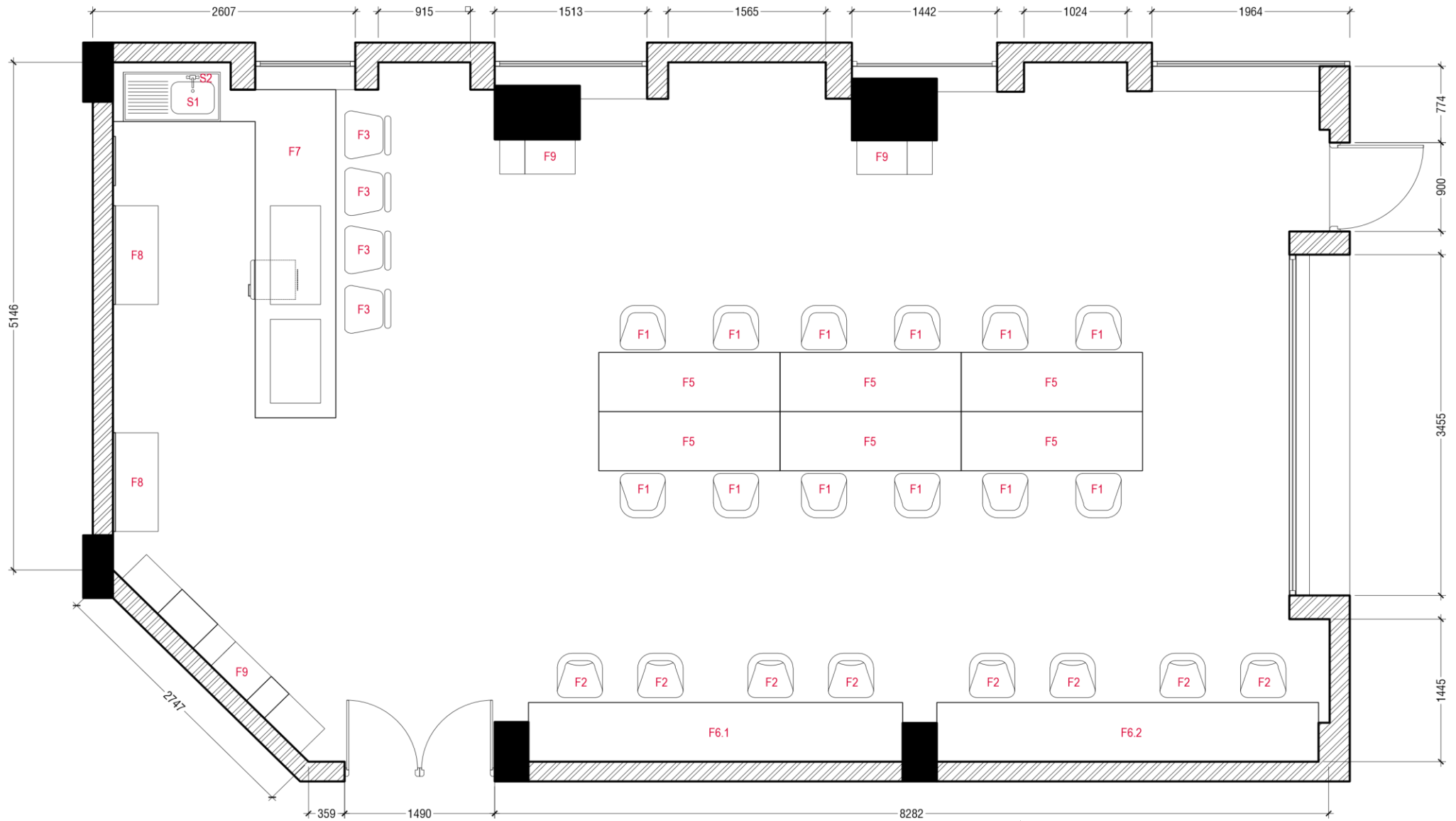

## MALDIVES POLYTECHNIC

Client: Ministry of Education

Project Number: RI/2017/012

Date: September 2017

Architect : Razana Amir  
 Engineer :  
 Drawn by : Aishath Mohammed Rasheed  
 Services : Aishath Ahmed  
 Interior : Razana Amir

Rev no	Date
01	29-10-2017
--	-----
--	-----