

## **Annex 2: Design files**

Note: Dimensions are for indicative purposes only. The consultant is expected to list the nearest available item in the market if the mentioned dimensions are not standard or not available in Maldives

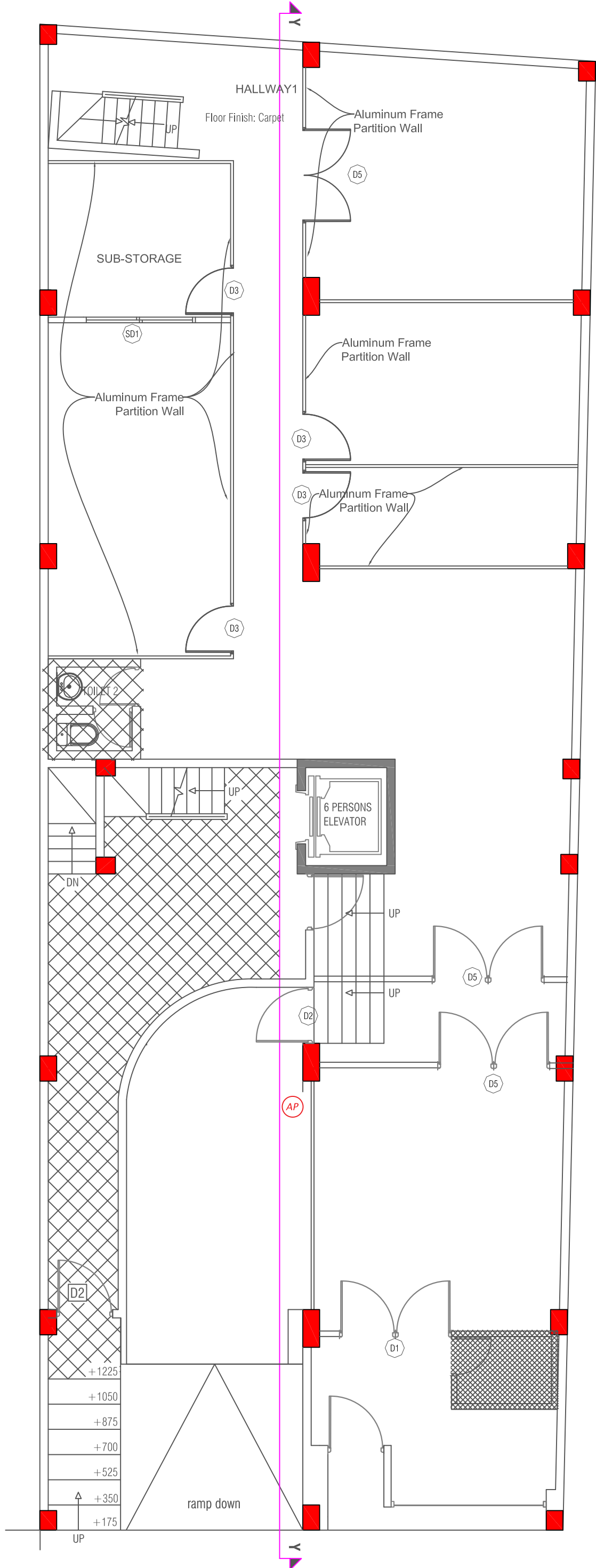

Ground Floor Table Doors & Partitions		
Item	Units	Quantity
Aluminum Partition - Ceiling Height	m	51
Door - D1	unit	1
Door - D2	unit	1
Door - D3	unit	4
Door - D5	unit	1
Door - SD1	unit	1

# GROUND FLOOR INTERIOR PLAN

SCALE 1:100



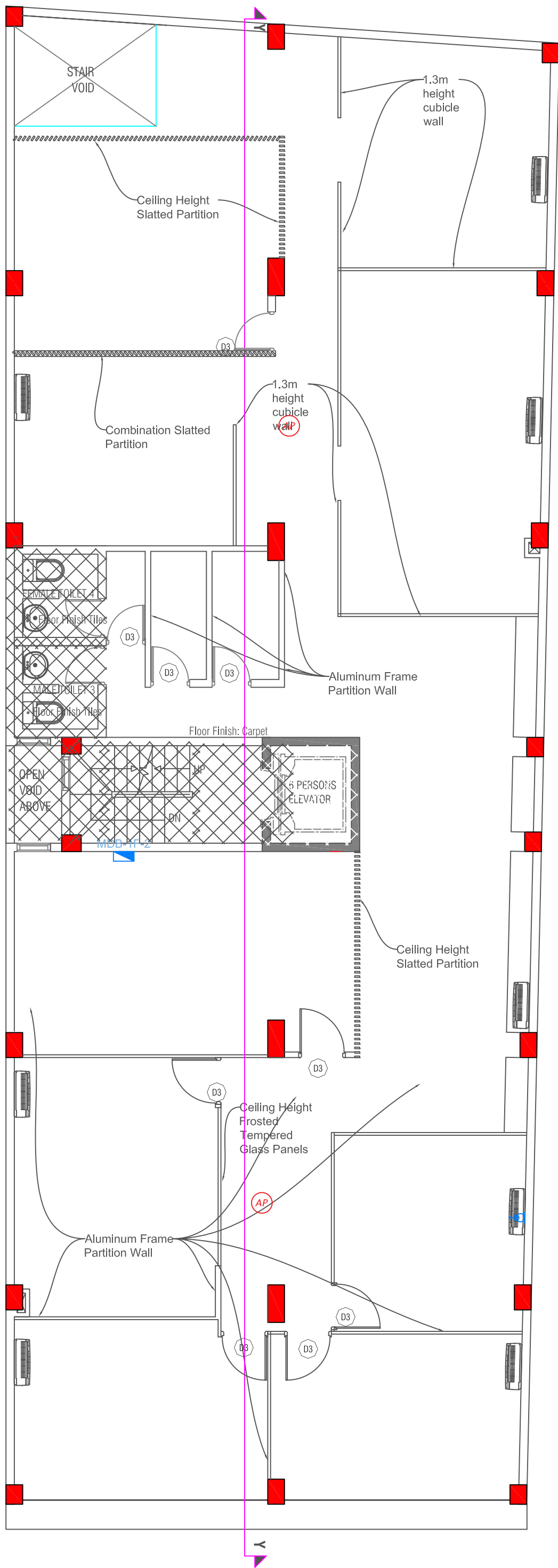











First Floor Table of Doors & Partitions		
Item	Units	Quantity
Aluminum Partition - Ceiling Height	m	37
Aluminum Partition - 1300mm Height	m	22
Door - D1	unit	0
Door - D2	unit	0
Door - D3	unit	9
Door - D5	unit	0
Door - SD1	unit	0

**FIRST FLOOR INTERIOR PLAN**















SCALE 1:100



### ELECTRICAL LEGEND

-  TELEPHONE/CAT6 SOCKET
-  WALL SOCKET OUTLET (SINGLE 13A AT 300mm)
-  WALL SOCKET OUTLET (DOUBLE 13A AT 300mm)
-  WALL SOCKET OUTLET (DOUBLE 13A AT 1000mm)
-  WALL SOCKET OUTLET (SINGLE 13A AT 2500mm)
-  WALL SOCKET OUTLET 13A (DBL GNG)/WATER HEATER ( TOILETS )
-  SHAVER SOCKET OUTLET (SINGLE13A)
-  WALL SOCKET OUTLET (SERVICE 15A)
-  WALL SOCKET OUTLET 13A (ONE GANG) FOR HOOD(1800mm H) / IGNITION(300mmH)
-  D-BOARD
-  MAIN PANEL BOARD

### ELECTRICAL LEGEND FOR NEW CONNECTIONS

-  TELEPHONE/CAT6 SOCKET
-  WALL SOCKET OUTLET (SINGLE 13A AT 300mm)
-  WALL SOCKET OUTLET (DOUBLE 13A AT 300mm)
-  WALL SOCKET OUTLET (DOUBLE 13A AT 1000mm)
-  WALL SOCKET OUTLET (SINGLE 13A AT 2500mm)
-  WALL SOCKET OUTLET 13A (DBL GNG)/WATER HEATER ( TOILETS )
-  SHAVER SOCKET OUTLET (SINGLE13A)
-  WALL SOCKET OUTLET (SERVICE 15A)
-  WALL SOCKET OUTLET 13A (ONE GANG) FOR HOOD(1800mm H) / IGNITION(300mmH)
-  D-BOARD
-  MAIN PANEL BOARD
-  PoE SWITCH
-  CEILING MOUNTED WIRELESS AP
-  ACCESS CONTROL POINT

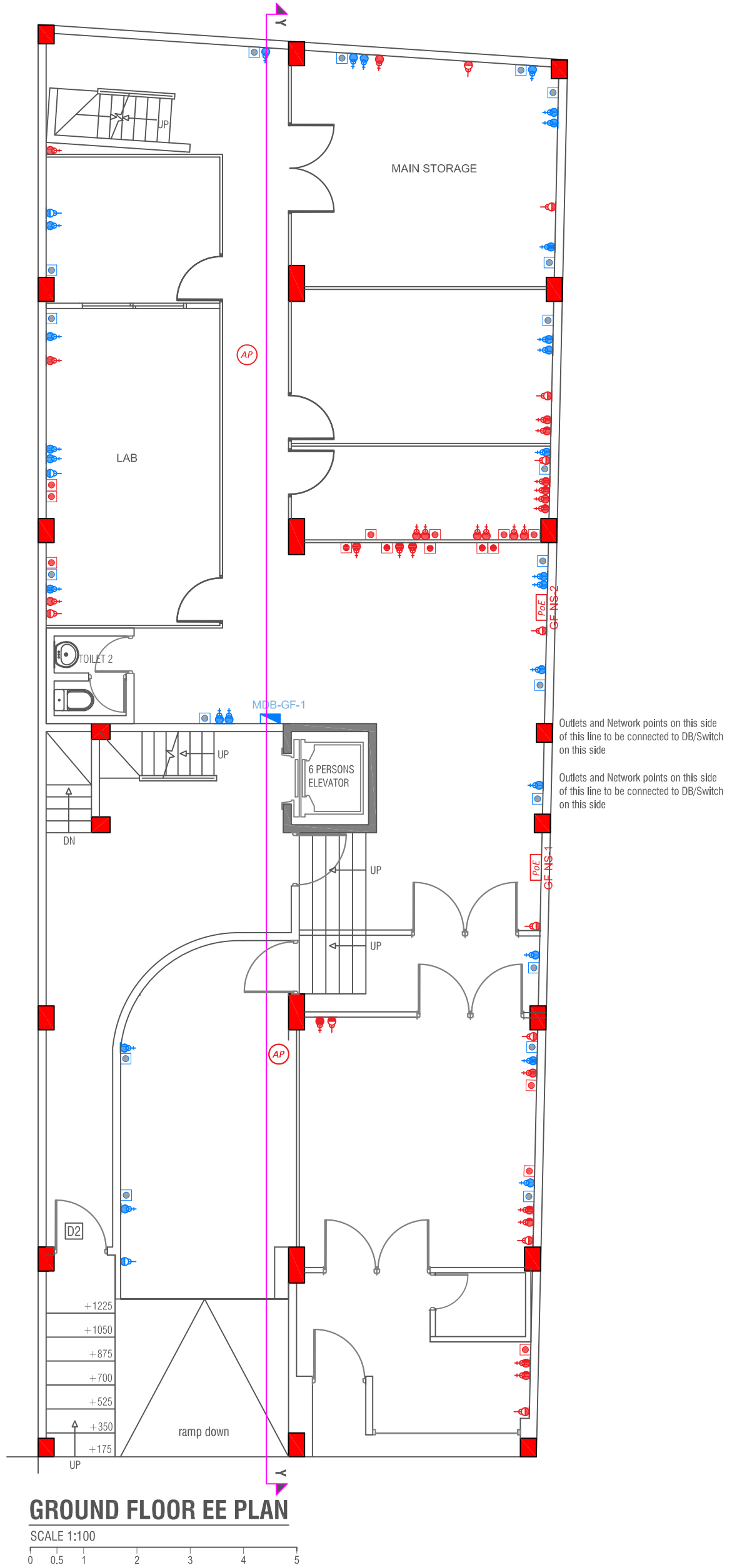

Outlets and Network points on this side of this line to be connected to DB/Switch on this side

Outlets and Network points on this side of this line to be connected to DB/Switch on this side

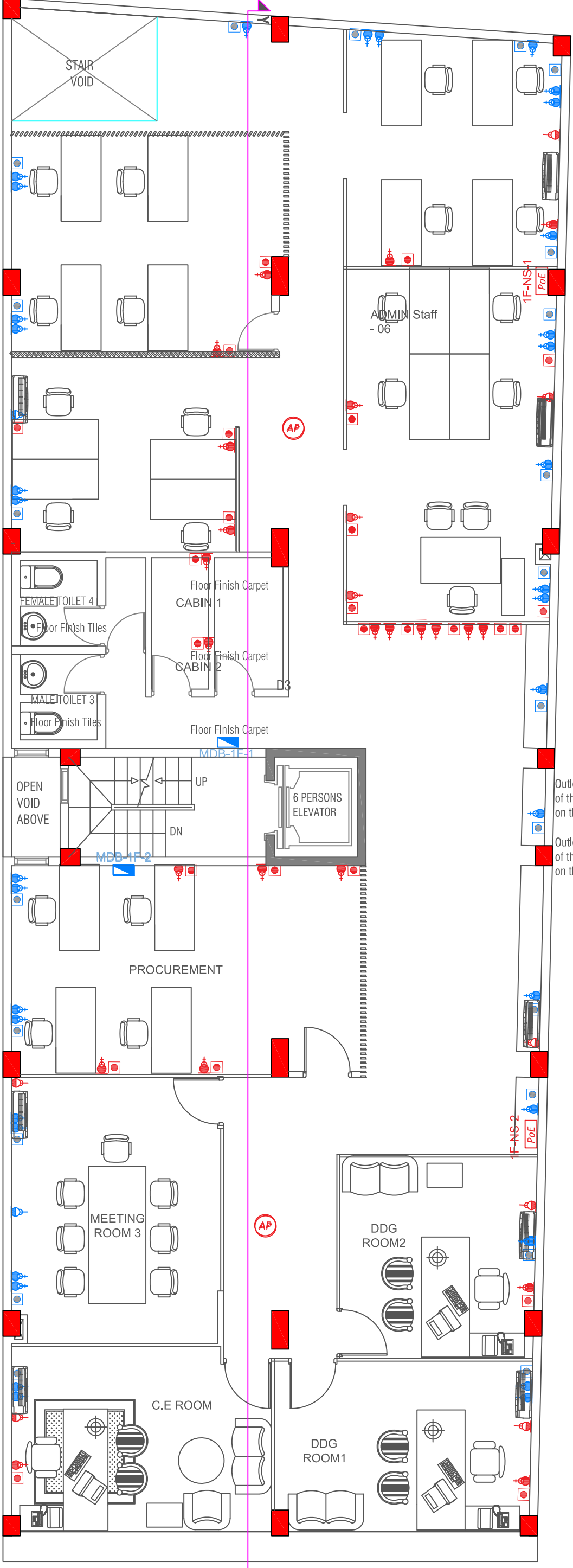

**FIRST FLOOR EE PLAN**

SCALE 1:100



Outlets and Network points on this side of this line to be connected to DB/Switch on this side

Outlets and Network points on this side of this line to be connected to DB/Switch on this side

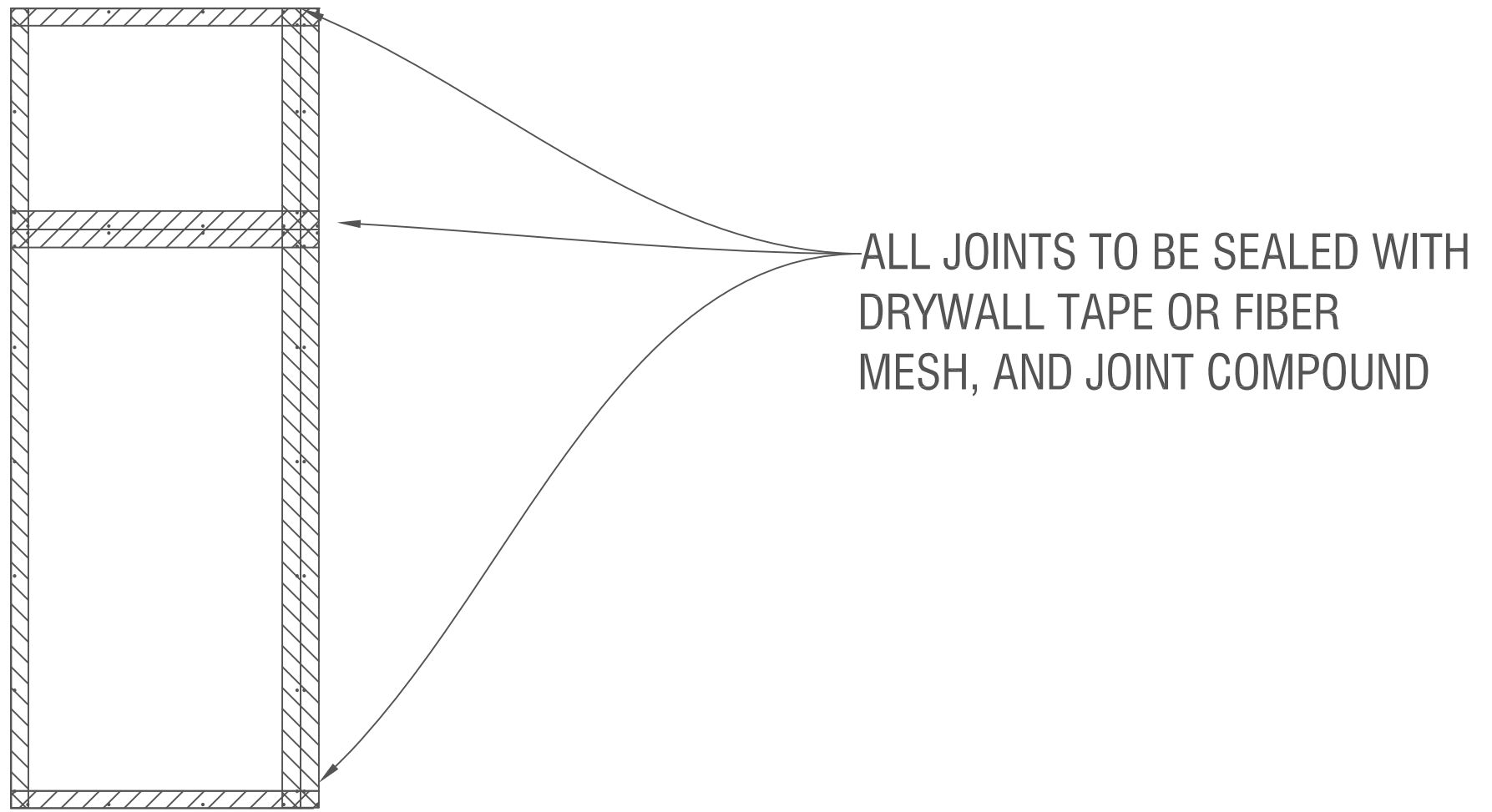

PANEL:  
9MM PVC BOARD

INSULATION:  
FIBERGLASS INSULATION OR SIMILAR  
75MM TOTAL THICKNESS OR PROFILE WIDTH

FINISHING DETAILS:  
LAYER 1: WALL PUTTY/JOINT COMPOUND APPLIED AND SANDED  
LAYER 2: WALL SEALER  
LAYER 3: ANTI-BACTERIAL, ANTI-FUNGAL, SEMI-GLOSS, PURE WHITE PAINT  
LAYER 4: ANTI-BACTERIAL, ANTI-FUNGAL, SEMI-GLOSS, PURE WHITE PAINT

# Partition Finishing Details

SCALE 1:100





BLIND RIVETS  
MINIMUM 3 PCS PER SECTION

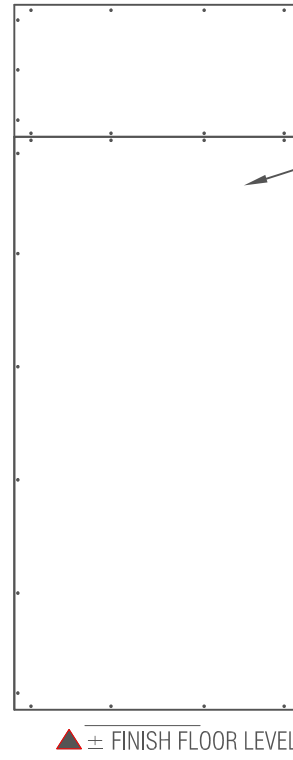
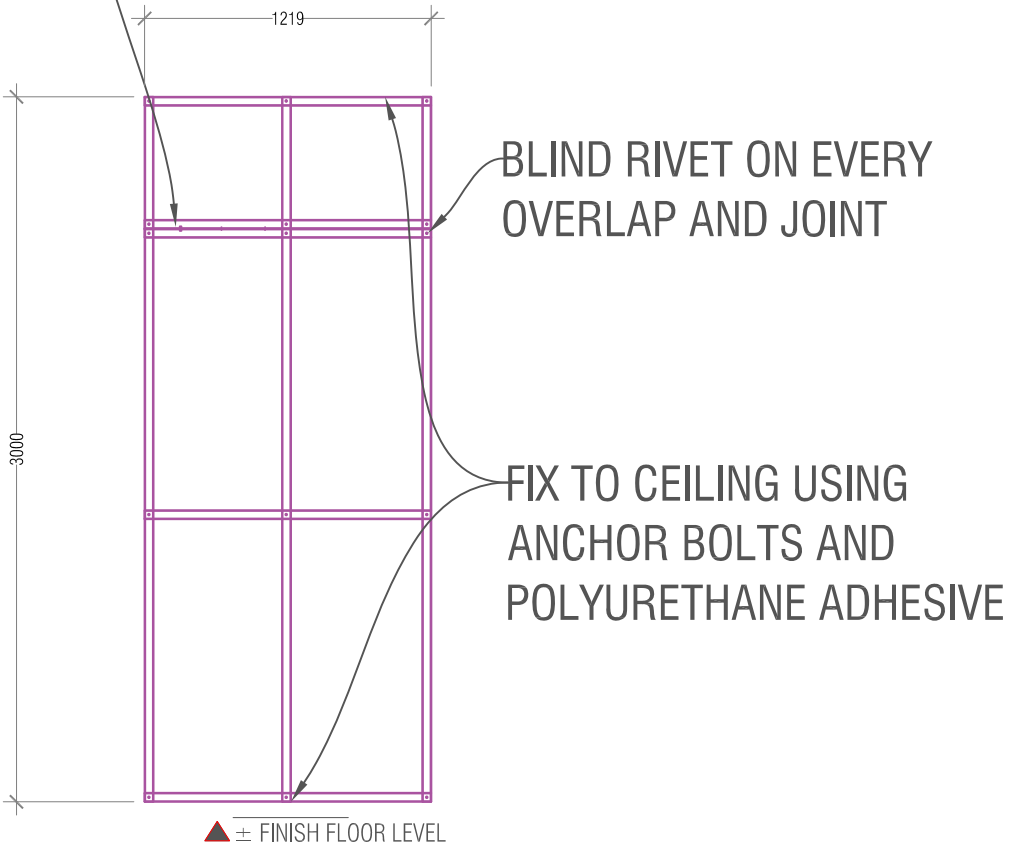

# 1st Floor Partition and Frame Detail

SCALE 1:100

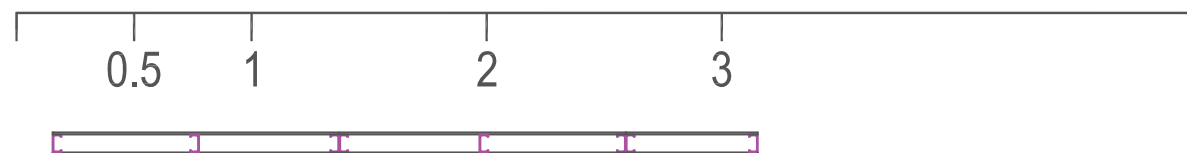

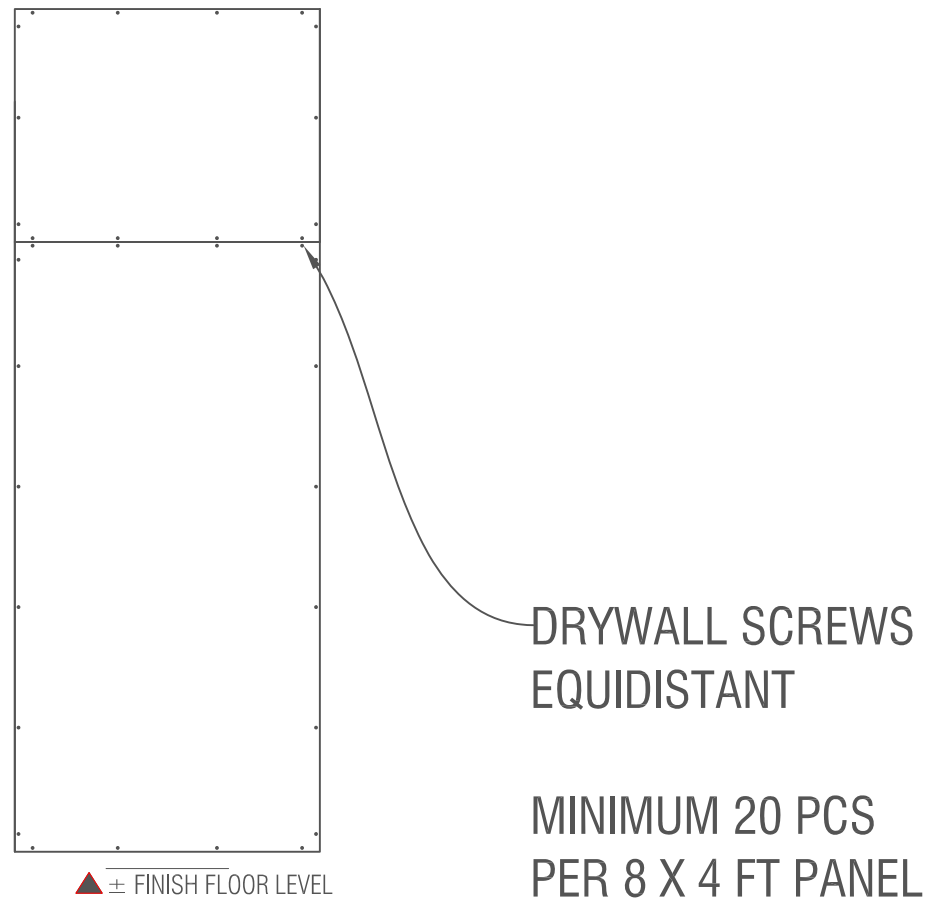
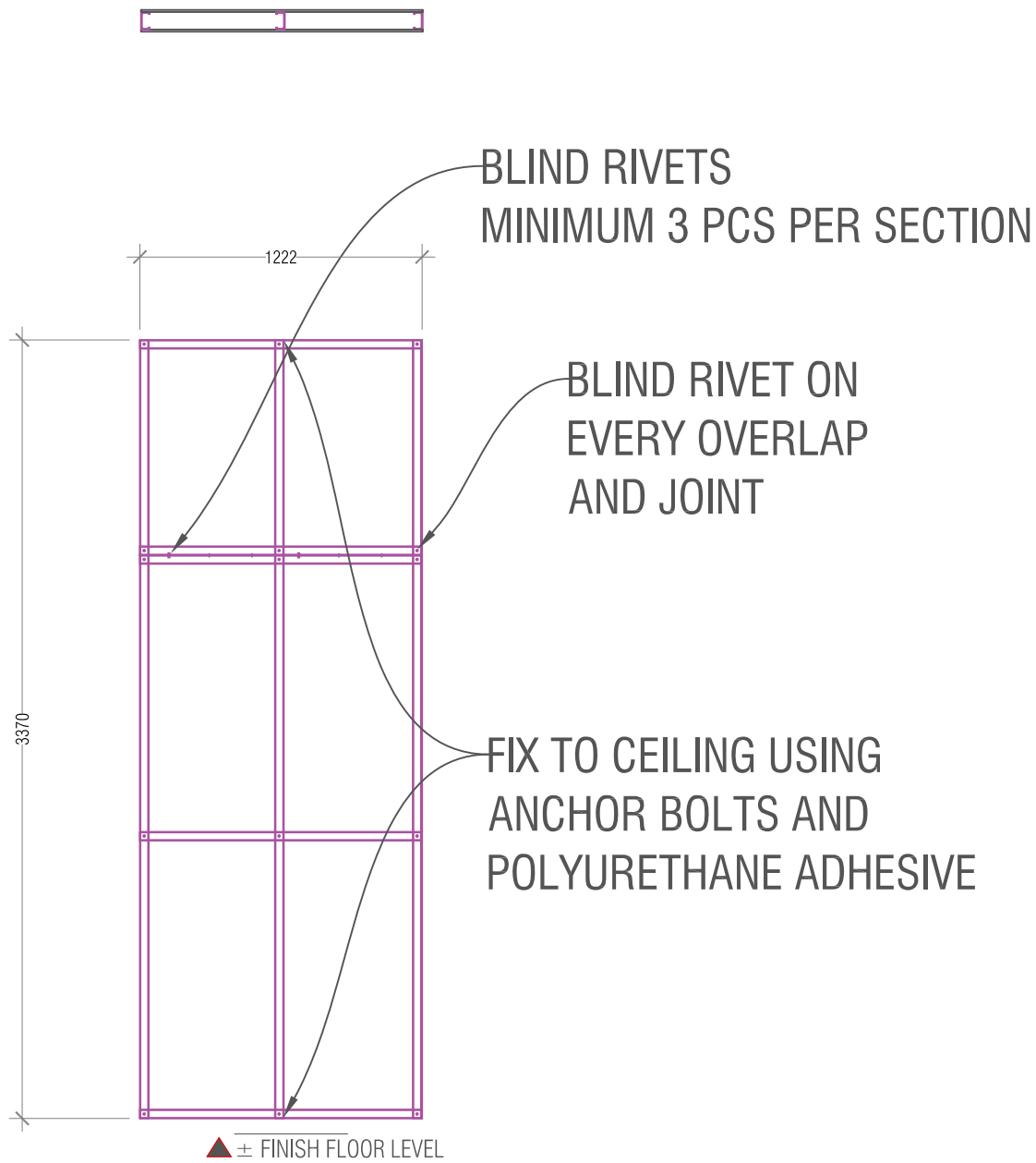

ALUMINUM CHANNELS (GRND FLOOR)  
3 X 3 METER SEGMENT  
16 CHANNELS

BLIND RIVET (GRND FLOOR)  
3 X 3 METER SEGMENT  
55 BLIND RIVETS

DRYWALL SCREW (GRND FLOOR)  
3 X 3 METER SEGMENT  
98 SCREWS

PVC BOARD (GRND FLOOR)  
3 X 3 METER SEGMENT  
8 (4x8 ft) PANELS

# Ground Floor Partition and Frame Detail

SCALE 1:100





## Primary Option

## Alternative Option

VERTICAL CHANNELS

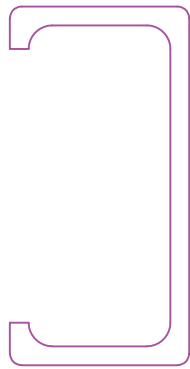

C CHANNEL

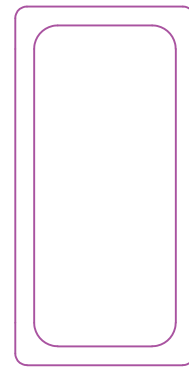

BOX CHANNEL

HORIZONTAL CHANNELS

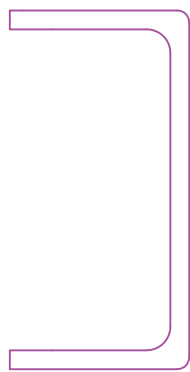

U CHANNEL

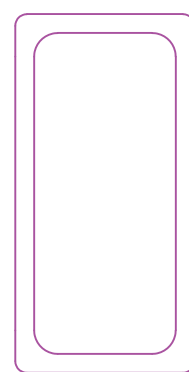

BOX CHANNEL

# Aluminum Profiles

SCALE 1:100



NAME

TOP AND BOTTOM HUNG

SLIDING DOOR TOP AND BOTTOM HUNG

SLIDING DOOR

PLAN

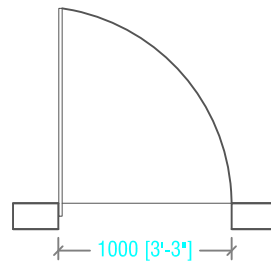
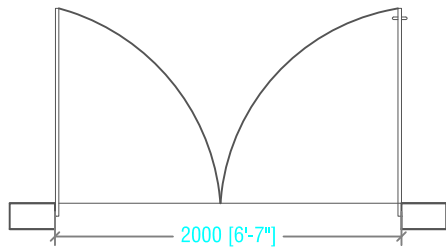

ELEVATION

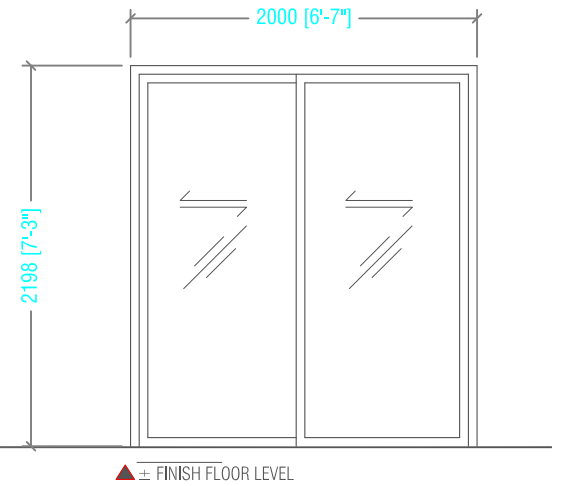
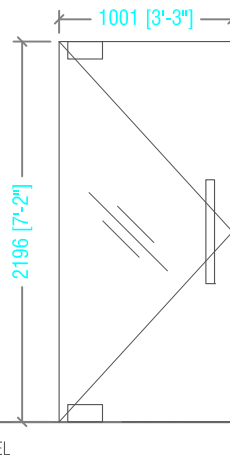
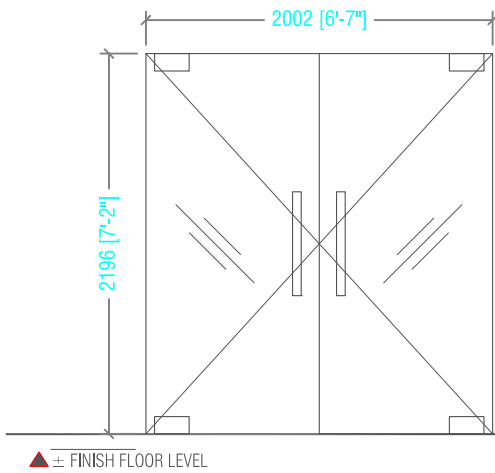

▲ ± FINISH FLOOR LEVEL

▲ ± FINISH FLOOR LEVEL

▲ ± FINISH FLOOR LEVEL

SYMBOL	D1	TOTAL = 01nos.	SYMBOL	D2	TOTAL = 01nos.	SYMBOL	SD1	TOTAL = 01nos.
LOCATION	Grnd flr		LOCATION	Grnd flr		LOCATION	Grnd flr	
QUANTITY	01		QUANTITY	01		QUANTITY	01	
DOOR FRAME	-	REMARKS TO SUPPLIERS DETAILS	DOOR FRAME	-	REMARKS TO SUPPLIERS DETAILS	DOOR FRAME	ALUMINUM TRACK	REMARKS
FINISHES	FRAME LESS TEMPERED GLASS		FINISHES	FRAME LESS TEMPERED GLASS		FINISHES	ALUMINUM FRAME GLASS DOOR	

NAME

SIDE HUNG DOOR

NAME

SIDE HUNG DOOR

PLAN

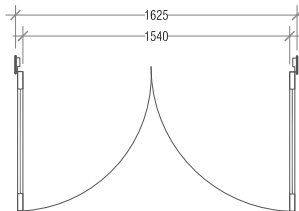
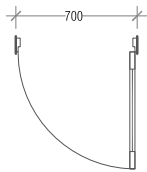

ELEVATION

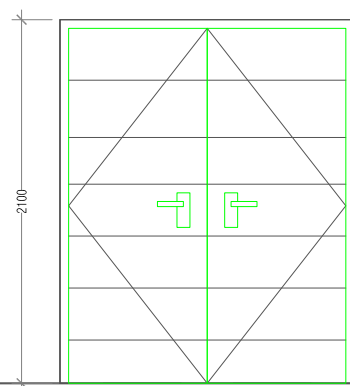
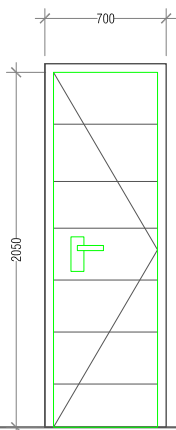

▲ ± FINISH FLOOR LEVEL

▲ ± FINISH FLOOR LEVEL

SYMBOL	D3	TOTAL = 13 nos.	SYMBOL	D5	TOTAL = 03nos.
LOCATION	All flr		LOCATION	Grnd Flr	
QUANTITY	13		QUANTITY	03	
DOOR FRAME	WOOD	REMARKS	DOOR FRAME	WOOD	REMARKS
FINISHES	LAMINATED WOOD PANEL		FINISHES	LAMINATED WOOD PANEL	

# Door Schedule

SCALE 1:100

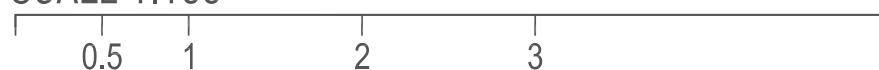

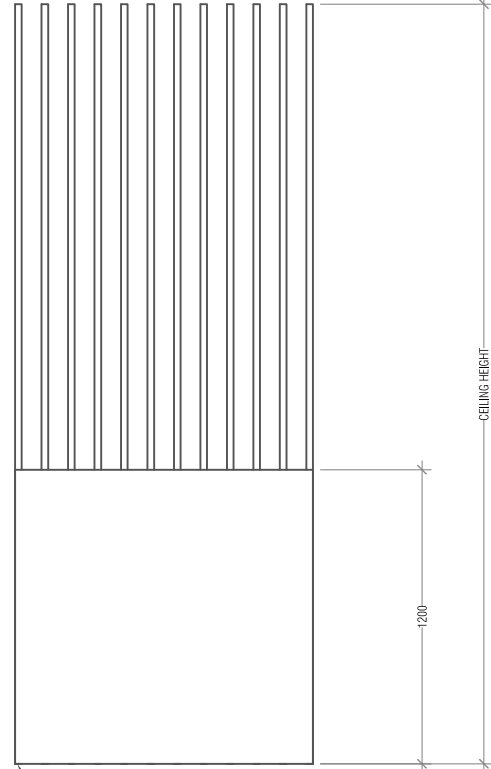
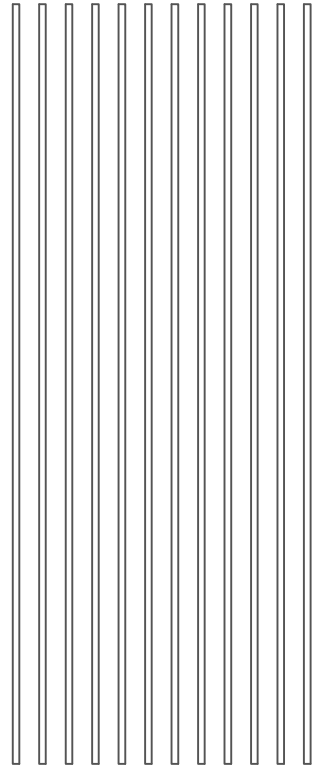

ALUMINUM FRAME PARTITION

## Slatted Partition Details

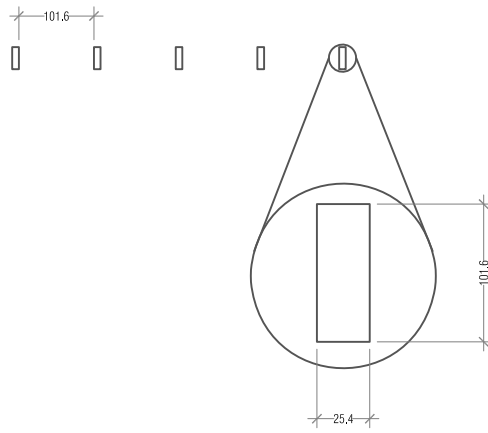

MATERIAL: KAPUR HARDWOOD OR SIMILAR

INDICATIVE DIMENSIONS:  
CROSS SECTION: 1 X 4 IN (25.4 X 101.8 MM)  
HEIGHT: CEILING HEIGHT

TREATMENT:  
ANTI-FUNGAL TREATMENT  
ANTI-TERMITE TREATMENT

FINISHING:  
1000 GRIT SANDED  
3 COAT SEMI-GLOSS POLYURETHANE VARNISH

## SLATTED AND COMBINATION PARTITION DETAILS

NOT TO SCALE