

大牧人 Big Herdsman



肉禽养殖设备
POULTRY GROWING



青岛大牧人机械股份有限公司，创立于2005年，公司以客户价值驱动创新为纽带，整合、学习、吸收国内外最前沿的技术、管理理念，充分挖掘人力资源的最大潜力，配套强大的研发、制造和交付能力，迅速打造规模优势，成为行业公认的领跑者。

公司始终致力于规模化与现代化畜禽养殖装备的设计、生产与销售，主营产品包括肉禽、蛋禽、养猪等全套自动化养殖设备，业务遍布全球。

公司先后获得国家高新技术企业、科技进步奖一等奖、中国畜牧业先进企业、山东省企业技术中心等多项荣誉。

大牧人始终秉承着“让养殖变得简单、可靠、环保、高效”的企业使命，创新思路研发产品，不断为客户提供专业产品和标准化的服务。

Qingdao Big Herdsman Machinery Co., LTD was founded in 2005. With its customer-value driven innovation as the joint, the company learns, absorbs and integrates the most cutting-edge technology and advanced management concepts at home and abroad, fully exploits the maximum potential of human resources, possesses strong R&D manufacturing and delivery capabilities, quickly creates advantage of scale, and becomes a recognized leader in the industry.

With the business across the globe, the company is devoted to the design, production and manufacture of large-scale and modern livestock and poultry breeding equipment. The main products include a complete set of automatic breeding equipment such as table poultry, pig breeding, etc.

The company has won many honors such as national high-tech enterprise, first prize of science and technology progress award, advanced husbandry enterprise of China, enterprise technology center of Shandong Province, etc.

Big Herdsman has always been adhering to the company mission of "make the breeding activities simple, reliable, green and efficient by means of science and technology", researching and developing the production with innovation, and constantly providing professional products and standardized services to the customer.



大牧人
Big Herdsman



料盘式自动出鸡笼
Automatic broiler cage system

青岛大牧人机械股份有限公司
Big Herdsman Machinery CO.,LTD
让养殖变得简单/可靠/环保/高效
Simple/Reliable/Green/Efficient

● 技术说明/Technical Description

产品介绍 / Product introduction



单元尺寸: 3m长*1.6/1.8m ; 养殖高度: 0.45m
笼养饲养密度50kg/m², 单元饲养92/104只。

Unit size: 3m *1.6/1.8m; Height of breeding: 0.45m Cage
breeding density: 50kg/m², 92/104 birds/units.

产品参数 / Product Parameters

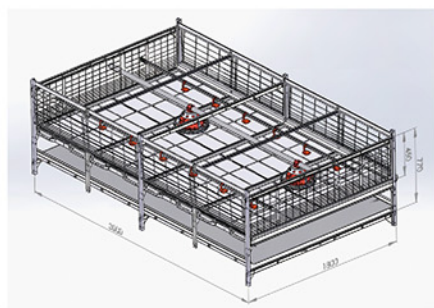
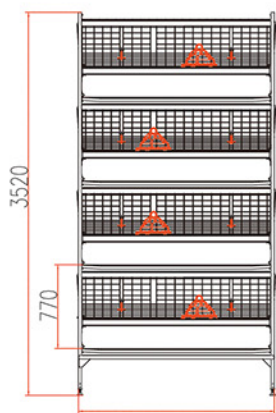

肉鸡笼3000×1800
broiler cage 3000×1800

产品特点 / Features

- 自动饮水, 多层自动升降;
 - 自动送料, 绞龙+料盘精确送料; 自动清粪, 多层自动运行, 舍内清洁;
 - 自动出鸡, 减少劳动强度, 减少鸡只损伤;
 - LED灯照明, 绿色亮度可调, 促进鸡只生长
-
- Automatic drinking, multi-tier automatic lifting;
 - Automatic feeding, auger&pan feeding; Automatic manure cleaning, multi-tier automatic operation, house cleaning;
 - Automatic chicken removing, reduce labor reduce chicken damage;
 - LED lighting, green brightness can be adjusted to promote chicken growth;

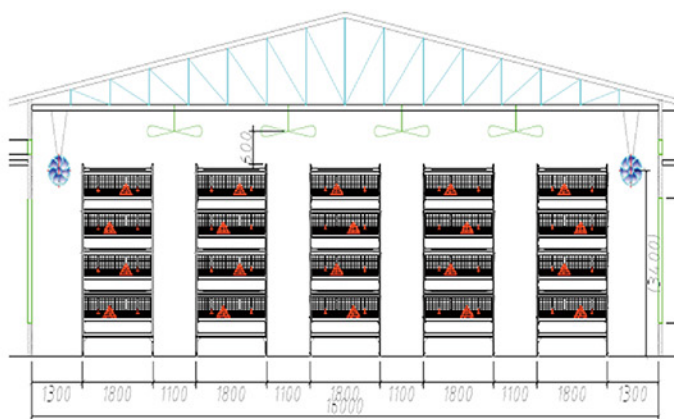

青岛大牧人机械股份有限公司

地址: 青岛市城阳区空港工业园月河路
电话: 0532-8493 3988
网址: www.bigherdsman.com

QINGDAO BIG HERDSMAN MACHINERY CO.,LTD

Add: Yuehe road, Konggang industrial park, Qingdao city,
Shandong Province, PR China
Tel: +86-532-8493 3988
Website: www.bigherdsman.com



微信扫描二维码, 关注大牧人

大牧人
Big Herdsman



NSM100A型层叠式肉鸡笼养系统

NSM100A Stacked Broiler Cage Rearing System

NSM100A型层叠式肉鸡笼养系统是大牧人研发设计的一款通风效果好，自动喂料，自动饮水，自动清粪，人工抓鸡笼。

长1250mm*宽1000mm，层高600mm，笼上养殖通风空间450mm，笼下通风口50&80mm，每笼饲养25只白羽肉鸡（2.5kg）。

Researched, developed and designed by Big Herdsman, NSM100A Stacked Broiler Cage Rearing System is well ventilated and characterized by automatic feeding, automatic water drinking and manure cleaning as well as manual broiler catching.

With length and width being L 1,250mm* W 1,000mm, a layer height being 600mm, a 450mm rearing ventilation space above the cages, a 50&80mm ventilation opening under the cage, 25 white feather broilers (2.5kg) are bred in each cage.

青岛大牧人机械股份有限公司
Big Herdsman Machinery CO.,LTD

让养殖变得简单/可靠/环保/高效
Simple/Reliable/Green/Efficient

主体系统/Main cage system

- 主体构架为无锌花热镀锌板，镀锌层厚度为275g/m²。笼丝采用镀铝锌丝焊接或焊后整体热镀锌工艺，使用寿命长。
- 新式出鸡侧纵向连接：紧靠底网，外翻设计，防止漏粪，方便冲洗。
- 新式螺纹绳夹：调节板上的螺纹绳夹防丢损的设计，节省人工，提高使用效率。
- 一体封边式注塑垫网：搭配挡鸡板使用，舒适、不伤鸡、防往下层食槽漏粪、防漏鸡苗、省人工的设计。

- The main body framework is made of spangle-free hot galvanized sheets, with zinc-plated layer 275g/m² thick. The cage is welded with aluminized zinc wires or hot dip galvanized as a whole after welding, and thus has a long service life.
- New-style longitudinal connection on bird harvest side: Close to the bottom net, designed to be inside-out, preventing manure leakage and easy to flush.
- New-style threaded rope clip: The threaded rope clip on the adjusting plate is designed to be loss and damage preventing type, saving labor and improving the use efficiency.
- Integrated edge-sealing injection molding cushion net: Used with the chicken baffle, comfortable, hurting no chickens, preventing the manure from leaking into the lower feeders, preventing baby chicks from falling, and designed to be labor-saving.



清粪系统/Manure Cleaning System

- 纵向粪带采用1.0mm厚PP带，表面光洁，强度高，清粪干净，杜绝跑偏。
- 横向清粪框架采用整体热镀锌处理，输送带PVC材质，采用无缝焊接设计，整体环形安装，保证了强度、使用效果和寿命。

- The longitudinal manure removal belt, a 1.0mm thick PP belt with smooth surface and high strength, cleans manure neatly without deviation.
- The transverse manure cleaning frame undergoes integrated hot galvanizing, and the conveyor belt is made of PVC. Seamless welding and integral annular installation are adopted, ensuring the strength, use effect and service life.



喂料系统/Feeding System

- 播种机式打料机，热镀锌钣金框架，防腐耐用，设计精密，稳定可靠。
- 匀料器可伸缩式专业设计，克服因地面不平带来的落料不均，打料均匀。
- 播种机轮防压脚、防脱轨电器设计，安全护航养殖。
- 集成电路板控制箱，停止自动纠正功能，电气更安全。
- 手动、遥控、定时自动打料，累计打料次数，定位、显示播种机行走距离，向无人值守智能化养殖更进一步。

- The feed sower system type material rammer consists of a hot-dip galvanized sheet metal frame, and is featured by corrosion resistance, durability, precise design, stability and reliability.
- The feed distributor is professionally designed to be retractable, can overcome the uneven feed drop caused by ground unevenness, and help with uniform material ramming.
- The feed sower wheel is designed as an electrical foot pressing and derailling prevention device, resulting in safe cultivation.
- Integrated circuit board control box has a stop and automatic correction function, and thus is safer electrically.
- Materials are rammed in a manual, remotely controlled or timed manner, the number of times of material ramming is accumulatively calculated, and the travel distance of the feed sower system is located and displayed, a further progress in unmanned intelligent cultivation.



供水系统/Water Supply System

- 统一提升的饮水系统，质量可靠，避免泄露，减少人工，避免人为操作失误造成水线损坏。
- 饮水乳头360°侧击出水，水滴挂珠，刺激饮水。

- The unitedly lifting drinking water system has reliable quality, requires less labor and is prevented from leakage and damage to water line caused by wrong man-made operation.
- The water drinking nipple can give water at an angle of 360°, and the water drops can stimulate water drinking.



青岛大牧人机械股份有限公司

地址：青岛市城阳区空港工业园月河路
电话：0532-8493 3988
网址：www.bigherdsman.com

QINGDAO BIG HERDSMAN MACHINERY CO.,LTD
Add: Yuehe road, Konggang industrial park, Qingdao city,
Shandong Province, PR China
Tel: +86-532-8493 3988
Website: www.bigherdsman.com



微信扫描二维码，关注大牧人

● 清粪系统/Manure Cleaning System

- 纵向粪带采用1.0mm厚PP带，表面光洁，强度高，清粪完全，杜绝跑偏。
- 横向清粪框架采用整体热镀锌处理，输送带采用PVC材质，采用无缝连接设计，整体环形安装，保证强度、使用效果和寿命。
- The longitudinal PP manure cleaning belt with a thickness of 1.0 mm with smooth surface and high strength is used to remove all manure without deviation.
- The horizontal manure cleaning frame is hot galvanized as a whole, and the PVC conveyor belt in seamless connection design and whole ring installation is used to ensure strength, use effect and service life.



● 供水系统/Water Supply System

- 统一提升的饮水系统，质量可靠，避免泄露。减少人工，避免人为操作失误造成水线损坏。
 - The unified-lifting nipple drinking water system, no leakage, reduce labor and avoid drinking line damage manually.
- a: 单元尺寸: 1.05*0.8m 单元高度: 0.45m。
b: 单元饲养17只鸡，单组（三层）饲养102只鸡。
c: 中间带空挡，便于通风散热，大网门结构，出鸡空间大。
d: 自动供水、供料、清粪。
- a: unit dimension: 1.05*0.8m; unit height: 0.45m.
b: 17 broilers in one unit and 102 broilers in one group (three tiers).
c: with space in the middle for ventilation and with large mesh door to provide large space for bird harvest.
d: automatic water supply, feeding and manure cleaning.



青岛大牧人机械股份有限公司

地址: 青岛市城阳区空港工业园月河路
电话: 0532-8493 3988
网址: www.bigherdsman.com

QINGDAO BIG HERDSMAN MACHINERY CO.,LTD
Add: Yuehe road, Konggang industrial park, Qingdao city,
Shandong Province, PR China
Tel: +86-532-8493 3988
Website: www.bigherdsman.com



微信扫描二维码，关注大牧人

大牧人 Big Herdsman



DSM系列层叠式肉鸡笼养系统 DSM cage system

DSM系列层叠式肉鸡笼养系统是大牧人开发设计的一种播种机或行车式人工出鸡笼，笼体中间带通风道，可以有效提高换气效率。

DSM cage system (laminated broiler cage - manual bird harvest) is a broiler cage of feed sower system type (or trolley type) hollow in the middle for manual bird harvest which is independently developed by Big Herdsman. The distance between outside of uprights is 1950 mm.

青岛大牧人机械股份有限公司
Big Herdsman Machinery CO.,LTD
让养殖变得简单/可靠/环保/高效
Simple/Reliable/Green/Efficient

● 主体系统/Main cage system

- 主体构架为无锌花热镀锌板，镀锌层厚度为275g/m²。笼丝采用镀铝锌丝或焊后整体热镀锌两种选配工艺，焊后热镀锌工艺，无锌渣，使用寿命长。
- 横向、纵向连接结构坚固可靠，但又简单高效，保证笼体稳固。
- 采用大网门整体内推式，操作空间大，更便于人员操作。
- 三层中间带空档，空档大于320mm，方便散热，极大的降低环控操作难度。
- 带操作车轨道，方便观察、抓鸡并能保护食槽。
- 一体封边式注塑垫网：加挡粪板配合安装，舒适、不伤鸡、防往下层食槽漏粪、防漏鸡苗、便于冲洗清理、省人工的设计。
- The main cage is made from hot galvanized sheet with a zinc coating of 275g/m². Two processing options are available for the cage wire: aluminized zinc wire or integrated hot dip galvanizing after welding. The latter is zinc slag free with long service life.
- Reliable transverse and longitudinal connected simple structure of highly efficiency, ensuring the stability of cage body.
- Large net door overall push type, large operating space, more convenient to operation.
- 1.05m*0.8m in one set, with integral push-in type large mesh door to provide convenient operation space.
- A hollow space of 320 mm in the middle of the three-tiers for heat dissipation to greatly reduce climate control difficulty.
- One sealing edge injection molding pad net: with the installation of the feces retaining board, comfortable, does not hurt the chicken, prevent the leakage of feces to the lower trough, prevent the leakage of chicken, easy to wash and clean, save labor.

● DSM系列选型参考

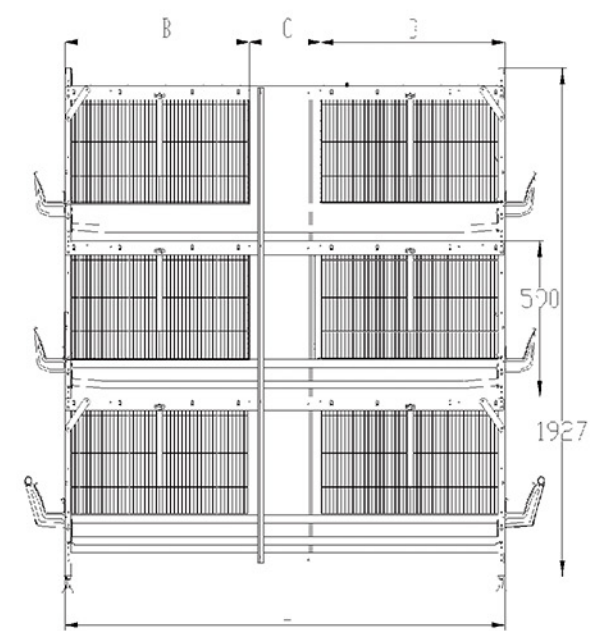

单元格长A Length A	1.05		1.25		
单元格宽B Width B	0.8	0.9		0.8	
空挡C Neutral	0.35	0.35	0.4	0.35	0.45
底层pp带 PP belt	分开 Total belt	分开 Total belt	分开 Total belt	分开 Separate	分开 Separate
总宽L (m) Total Width L	1.95	2.15	2.2	1.95	2.05

● 喂料系统/Feeding System

- 大牧人提供播种式与行车式两种选配供料方式：（热镀锌，锌层保证）。
- 不同款式的匀料器，克服因地面不平带来的落料不均。
- 行车式优点：结构紧凑，下料顺畅、精准，可实现分列控制打料，有利于灯光排布，并且对鸡舍地面平整度依赖较小，适合新建和改造鸡舍，饲料适应性强。
- 食槽：白色PVC材质料槽，质量可靠，接缝小，直线度高。
- Big Herdsman provides two feeding options: sowing type and trolley type: (hot galvanizing, zinc layer).
- Different styles of feeding devices to overcome the uneven feeding caused by uneven floor.
- Advantages of trolley type: compact in structure, smooth and accurate in feeding, separate in feeding control, good for lighting, and less dependent on flat poultry house floor, suitable for new poultry house and renovation of poultry house, and feed adaptable.
- Feed trough: straight white PVC Feed trough with reliable quality and small seam.



大牧人
Big Herdsman



三层自动清粪肉鸭笼养系统

Three-tier Automatic Manure-cleaning Duck Cage System

三层自动清粪肉鸭笼养系统是大牧人开发设计的一种三层自动清粪、人工出鸭的肉鸭笼。

笼长1350mm，层高690mm，笼深1100mm，养殖高度540mm。饲养密度48kg/m，3kg/只，24只鸭/格。

Three-tier automatic manure-cleaning duck cage system is a duck cage developed and designed by Big Herdsman, featuring automatic manure-cleaning and manual duck removing.

The cage is 1350mm long, 690mm high of each tier and 1100mm deep, breeding height is 540mm. The feeding density is 48kg/m, 3kg per duck and 24 ducks per grid.

青岛大牧人机械股份有限公司
Big Herdsman Machinery CO.,LTD

让养殖变得简单/可靠/环保/高效
—Simple/Reliable/Green/Efficient—

主体系统/Main cage system

- 主体构架为无锌花热镀锌板，镀锌层厚度为275g/m²。笼丝整体采用镀锌铝锌丝焊接工艺，主要接粪处安装PVC保护套，防腐耐磨，使用寿命长。
- 横向、纵向连接结构坚固可靠，但又简单高效，保证笼体稳固，无塌陷。
- 食槽采用底部倒角，便于扁型鸭喙吃食，并且保证食槽内部不存料。
- 笼网采用镀锌铝锌丝焊接，配有塑料垫网使鸭更舒适，并延长笼网使用寿命。
- 上下滑动式育雏挡网，有效防止育雏鸭串出笼具。
- 网门挡板结构，便于分群、防疫、出鸭，且确保不漏粪，提高养殖环境。
- 1.1m*1.35m一组，采用后网全部打开式，更便于人的操作。
- 网门挡板便于装卸和后网上翻，出鸭空间540mm*1325mm。
- The main frame is hot galv.sheet, 275g/ m² thickness. The whole cage wire adopts the welding process of aluminized zinc wire. PVC protective cover at the manure connector. Anti-corrosive, wear-resistant and long service life.
- Sound and reliable transverse and longitudinal connected simple structure of highly efficiency, ensuring the stability of cage body without collapse.
- The feeder is chamfered at the bottom to facilitate the feeding of duck with its flat duck beak and ensure that there is no feed in the feeder.
- The cage net is welded with aluminized zinc wires and equipped with plastic cushion net to make ducks more comfortable and prolong the service life of the cage net.
- The up-and-down sliding pullet screen can effectively prevent pullet ducks from springing out of cages.
- The net door baffle structure is convenient for grouping, epidemic prevention and duck harvest, and ensures no manure leakage to improve the breeding environment.
- A group of 1.1m*1.35m is adopted with the back net fully open, which is more convenient for people to operate.
- The net door baffle is convenient for loading and unloading and turning over on the back net, and the duck harvest space is 540mm*1325mm.



清粪系统/Manure Cleaning System

- 纵向粪带采用耐冲击、韧性强的PP带，为聚丙烯材质，表面光洁，强度高，清粪干净。
- 后驱特殊的清粪结构，有效防止溅出粪沟，大大改善舍内环境，降低劳动强度。
- 横向清粪采用PE材质绞龙叶片防腐耐用，电机3-4kw，清粪量可达18T/h。
- The longitudinal manure belt adopts PP belt with strong impact resistance and toughness, which is made of polypropylene with smooth surface and high strength, and can clean manure neat.
- The manure cleaning system with special rear drive allows to effectively prevent the manure from splashing out of the manure pit to greatly improve the environment in the house and reduce labor intensity.
- The horizontal manure cleaning is made from packing auger blade of PE material, which is corrosion-resistant and durable. The motor is 3-4kw, and the manure cleaning capacity can reach 18 T/h.



播种式喂料系统/Feeding System

- 钣金外框，防腐耐用，漂亮结实。
- 料箱大，打料次数少，无需人工加料，减少人工劳动强度。
- 轨道接口焊接处平稳，无需要人工推播种机行走。
- 特殊拨料轮，下料顺畅，不磨损料，满足多种料使用。
- The sheet metal outer frame is corrosion-resistant, durable, aesthetic and strong.
- The large feed box helps decline feeding times and manual labor intensity with no need for manual feeding manual feeding.
- The welding position of rail interface is stable, and there is no need to manually push the feed sower system.
- The special feed allocating wheel is conducive to smooth feed dropping without feed damage and allows use of various feed.



可伸缩式匀料器，克服因地面不平带来的落料不均。
The retractable feed distributor can overcome the uneven feed drop caused by uneven floor.



食槽：白色PVC材质料槽，质量可靠，接缝小，直线度高
Feeder: it is made from white PVC material, featuring reliable quality small joint and high straightness.

供水系统/Water Supply System

- 统一提升的饮水系统，质量可靠，避免泄露。减少人工，避免人为操作失误造成水线损坏。
- The unified lifting drinking system with reliable quality is used to avoid leakage. It can reduce labor to avoid drinking line damage caused by manual misoperation.



青岛大牧人机械股份有限公司

地址：青岛市城阳区空港工业园月河路
电话：0532-8493 3988
网址：www.bigherdsman.com

QINGDAO BIG HERDSMAN MACHINERY CO.,LTD

Add: Yuehe road, Konggang industrial park, Qingdao city,
Shandong Province, PR China
Tel: +86-532-8493 3988
Website: www.bigherdsman.com



微信扫描二维码，关注大牧人

大牧人
Big Herdsman



大牧人物联网系统 Big Herdsman IOT System

大牧人提供包含智能硬件和IOT平台的全套物联网服务，旨在集中高效管理多栋舍，全面支持大牧人系列环控设备。

Big Herdsman provides a full set of IOT services including smart hardware and IOT system, aiming at centralized and efficient management of multiple houses, fully supporting BH series of environmental control devices.



青岛大牧人机械股份有限公司

地址: 青岛市城阳区空港工业园月河路
电话: 0532-8493 3988
网址: www.bigherdsman.com

QINGDAO BIG HERDSMAN MACHINERY CO.,LTD
Add: Yuehe road, Konggang industrial park, Qingdao city,
Shandong Province, PR China
Tel: +86-532-8493 3988
Website: www.bigherdsman.com



微信扫描二维码，关注大牧人

青岛大牧人机械股份有限公司 Big Herdsman Machinery CO.,LTD

让养殖变得简单/可靠/环保/高效
—Simple/Reliable/Green/Efficient—

● 肉鸡物联网系统（中国版Chinese version）

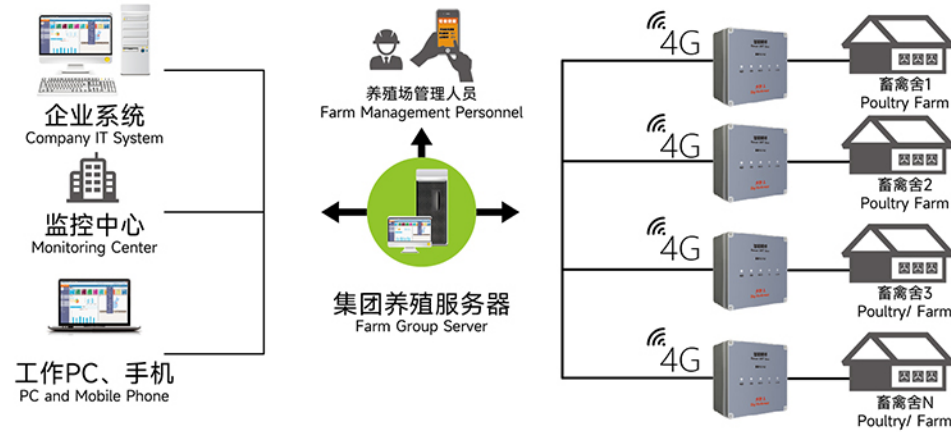

- 智能采集并存储养殖环境信息、动物及生产信息，所有数据实时可视化处理。
- 专业的数据库服务，支持在云端和本地进行数据分析，养殖数据长期保存。
- 多重权限设计，云端参数保护设计，让远程设定参数更安全。
- 支持单账号同时于手机、PAD、PC等多终端登录。
- 多渠道报警方案，通过本地语音播报、虚拟电话报警以及微信公众号信息推送实现全天候守护。
- Production information, all information real-time visualization processing.
- Professional database services support data analysis in cloud and local, and long-term storage of breeding data.
- Multiple permission design and cloud parameter protection design make remote parameter setting more secure.
- You can log in to multiple terminals at the same time using one single account, such as a mobile phone, PAD, and PC.
- Multi-channel alarm, through the local sound alarm, virtual phone alarm and wechat Official Accounts to achieve all-day protection.

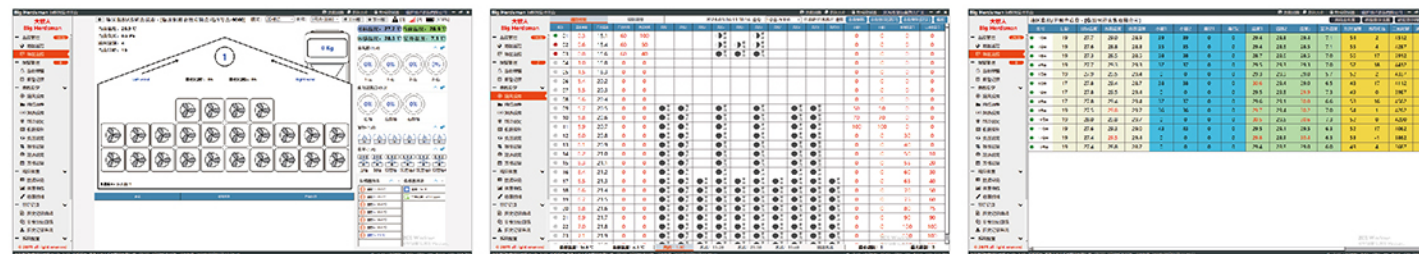

● 肉鸡物联网系统（国际版 BH FarmNet International version）

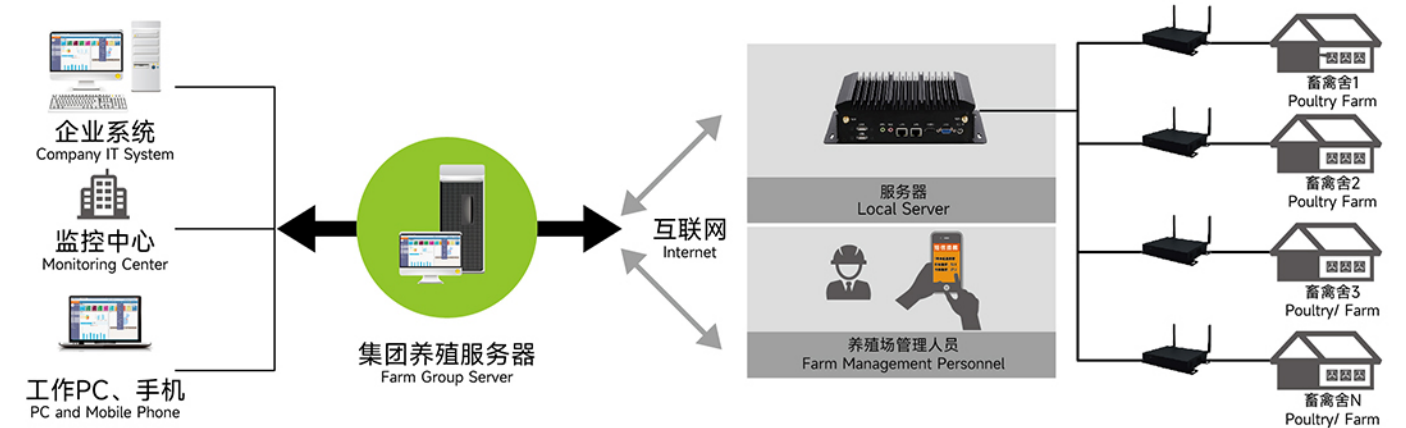

- 智能采集并储存养殖环境信息及生产信息，所有信息实时可视化处理。
- 专业的数据库服务，支持在云端和本地进行数据分析，养殖数据长期保存。
- 可通过场内局域网和物联网云平台（浏览器、微信小程序、APP）访问农场数据。
- BH FarmNet物联网系统不限连接鸡舍数量，不限使用用户数量。
- 环控器可以独立接入网络，实现鸡舍远程同屏操作。
- 主动告警基于场内语音、电话、短信以及网络消息推送等多个渠道，实现全天候守护。
- 支持定制开发。
- Intelligent collection and storage of breeding environment information, animal and production information, all information real-time visualization processing.
- Professional database services, supporting data analysis in the cloud and local, long-term storage of breeding data.
- Farm data can be accessed through LAN and IOT cloud platform (browser, wechat mini program, app)
- BH FarmNet IOT is not limited to the number of connected houses and the number of users.
- Controller can be independently connected to the network, which can realize the remote operation with the one screen.
- Alarm based on voice, phone, SMS and wechat official accounts to achieve all-day protection.
- Customization.





BH8218环境控制器BH8218 controller



- 支持温度、湿度、负压等环境数据的采集，采集数据丰富、精度高。可以连接4个温度传感器（包含1个室外温度传感器）和1个湿度传感器。
- 内置专业肉鸡温度、体重、通风等参数，可免设置全自动实时调控养殖舍环境。
- 能够控制8组风机（包括1组最小通风系统）、1组照明、1组料线、1组喷雾、1组加热器、1组冷却水泵（湿帘水泵）和1组用于报警输出的继电器。能够自动控制1组进风窗系统和1组幕帘系统。2组模拟输出（0-10V），进行灯光和调速风机的控制。
- 含有1张温度自动下降表和1张用于最小通风的体重自动增加表。
- 可连接智能网关和云服务器，养殖数据实时、多终端共享，实现在家办公、云上养殖。
- It supports the collection of environmental data such as temperature, humidity and negative pressure. The collected data is diversified and of high accuracy. It can be connected with 4 temperature sensors (including 1 outdoor temperature sensor) and 1 humidity sensor.
- Built-in professional parameters of temperature, weight and ventilation for broilers, which can be set free, enable fully automatic real-time regulation of breeding house environment.
- It can control 8 ventilation fans (including 1 minimum ventilation system), 1 lighting system, 1 feed line, 1 fogging pipe system, 1 heater, 1 cooling water pump (cooling pad water pump) and 1 relay for alarm output. It can control 1 air inlet system and 1 curtain system. It provides 2 analog outputs (0-10V) to control the lights and variable-speed fans.
- It has 1 automatic temperature drop meter and 1 automatic weight increase meter for the minimum ventilation.
- It can be connected to an intelligent gateway and cloud server, sharing breeding data in real time at multiple terminals, so as to enable work from home and breeding via the Internet.



BH8228环境控制器BH8228 controller



- 支持温度、湿度、负压等环境数据的采集，采集数据丰富、精度高。可以连接7个温度传感器（包含1个室外温度传感器）和1个湿度传感器。
- 内置专业肉鸡温度、体重、通风等参数，可免设置全自动实时调控养殖舍环境。
- 能够控制16组风机（包括1组最小通风系统）、1组照明、1组料线、1组喷雾、3组加热器、1组冷却水泵（湿帘水泵）和1组用于报警输出的继电器。能够自动控制2组进风窗系统和1组幕帘系统。2组模拟输出（0-10V），进行灯光和调速风机的控制。
- 含有1张温度自动下降表和1张用于最小通风的体重自动增加表。
- 可连接智能网关和云服务器，养殖数据实时、多终端共享，实现在家办公、云上养殖。
- It supports the collection of environmental data such as temperature, humidity and negative pressure. The collected data is diversified and of high accuracy. It can be connected with 7 temperature sensors (including 1 outdoor temperature sensor) and 1 humidity sensor.
- Built-in professional parameters of temperature, weight and ventilation for broilers, which can be set free, enable fully automatic real-time regulation of breeding house environment.
- It can control 16 ventilation fans (including 1 minimum ventilation system), 1 lighting system, 1 feed line, 1 fogging pipe system, 3 heaters, 1 cooling water pump (cooling pad water pump) and 1 relay for alarm output. It can control 2 air inlet systems and 1 curtain system. It provides 2 analog outputs (0-10V) to control the lights and variable-speed fans.
- It has 1 automatic temperature drop meter and 1 automatic weight increase meter for the minimum ventilation.
- It can be connected to an intelligent gateway and cloud server, sharing breeding data in real time at multiple terminals, so as to enable work from home and breeding via the Internet.

主界面

大牧人
Big Herdsman

报警

参数

系统

历史

当前日龄 1
目标温度 33.8 °C
平均温度 30.7 °C



环境控制器
Climate controller

适用于白羽肉鸡、817肉鸡、三黄鸡等肉用鸡及其种鸡的规模化养殖，自动调控养殖舍内的温度、湿度等环境参数。

It is suitable for large-scale breeding of broiler and breeders such as white feather broilers, 817 broilers, yellow-hair chickens, and adjusts and controls environmental parameters such as temperature and humidity automatically in the breeding house.



青岛大牧人机械股份有限公司

地址：青岛市城阳区空港工业园月河路
电话：0532-8493 3988
网址：www.bigherdsman.com

QINGDAO BIG HERDSMAN MACHINERY CO.,LTD
Add: Yuehe road, Konggang industrial park, Qingdao city,
Shandong Province, PR China
Tel: +86-532-8493 3988
Website: www.bigherdsman.com



微信扫描二维码，关注大牧人

青岛大牧人机械股份有限公司
Big Herdsman Machinery CO.,LTD

让养殖变得简单/可靠/环保/高效
Simple/Reliable/Green/Efficient

● BH9100PLUS环境控制器BH9100PLUS controller



- 支持13路温度、1路湿度、1路负压、1路CO₂、1路NH₃环境数据的采集，采集数据丰富、精度高。
- 内置专业肉鸡温度、体重、通风等参数，可免设置全自动实时调控养殖舍环境。
- 精细降温及多达36个通风级别和26个风机组，实现养殖舍的精密通风。
- 支持9个可独立控制的进风口，自动调控进风口的位置和大小。
- 分5区加热可针对养殖舍内不同区域的温度精准控制加热量。
- 可自动调控养殖舍照明时间和照明强度，可实现变频风机的转速和运行时间的自动调控，并有熄灯温度补偿功能。
- 可控制2组制冷设备，水泵山墙、侧墙可独立控制。
- 湿热补偿作为特色功能，可实现温度、湿度与通风量的自动联动。
- 10寸工业级触摸屏操控，3D立体画面显示，50路干式触点，运行可靠，使用便捷。
- 可连接智能网关和云服务器，养殖数据实时、多终端分享，实现在家办公、云上养殖。

- Supports the collection of environmental data from 13 channels of temperature, 1 channel of humidity, 1 channel of negative pressure, 1 channel of CO₂, and 1 channel of NH₃, with rich data collection and high precision.
- Built-in professional broiler temperature, weight, ventilation and other parameters, automatic real-time control of breeding house environment without setting.
- 36 ventilation levels and 26 fan units, to achieve the precise ventilation.
- Support 9 controlled air inlet independently, adjust the position and size of the air inlet automatically.
- Divided into 5 zones heating can precisely control the heating according to the temperature of different areas.
- It can automatically regulate the lighting time and intensity of the breeding house, realize the automatic regulation of the speed and running time of the frequency conversion fan, and has the function of light out temperature compensation.
- Can control 2 groups of cooling equipment, water pump of gable, side wall can be controlled independently.
- Humidity and heat compensation function can realize the automatic linkage of temperature, humidity and ventilation volume.
- 10" industrial touch screen control, 3D display, 50 dry contacts, reliable operation, easy to use.
- Smart gateway and cloud server can be connected to real-time and multi-terminal sharing of breeding data, so as to realize working at home and breeding on the cloud.

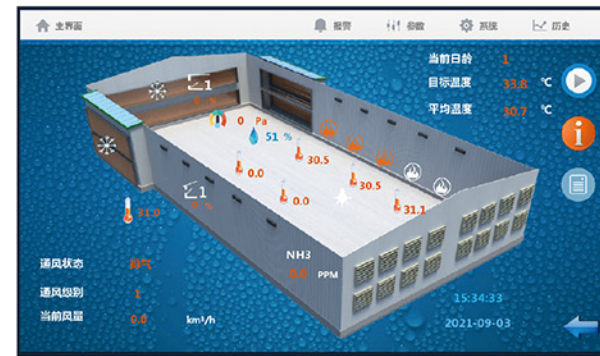

制冷模式	自动调整	制冷温度设定	100 %RH
制冷1启动温度	44.0 °C	制冷2启动温度	44.0 °C
制冷1启动时间	1.00 60S	制冷2启动时间	1.00 60S
制冷1关闭时间	5.00 300S	制冷2关闭时间	5.00 300S
制冷1运行时间	8.00	制冷2运行时间	10.00
制冷1停止时间	20.00	制冷2停止时间	16.00
最小比例	5%	最小时间	15S
最大比例	60%	最大时间	180S
制冷温差带	3.0°C	每度温差时间	55S
制冷周期	5.00	周期	300S
当前制冷工作比例	5%	当前制冷时间	15S
当前制冷2工作比例	5%	当前制冷2时间	15S

区域	温度	湿度	负压	风速	风向
1	45	0.10	0.10	0.10	0.10
2	45	0.10	0.10	0.10	0.10
3	45	0.10	0.10	0.10	0.10
4	45	0.10	0.10	0.10	0.10
5	45	0.10	0.10	0.10	0.10
6	45	0.10	0.10	0.10	0.10
7	45	0.10	0.10	0.10	0.10
8	45	0.10	0.10	0.10	0.10
9	45	0.10	0.10	0.10	0.10
10	45	0.10	0.10	0.10	0.10

● BH9100环境控制器BH9100 controller



- 支持9路温度、1个湿度、1个CO₂、1个负压环境数据的采集，采集数据丰富、精度高。
- 内置专业肉鸡温度曲线、体重、通风等参数，可免设置全自动实时调控养殖舍环境。
- 精细降温及多达36个通风级别和24个风机组，实现养殖舍的精密通风。
- 支持4路可独立的控制的进风口，自动调控进风口的位置和大小。
- 分3区可针对养殖舍内不同区域的温度精准控制加热量。
- 可控制3组制冷设备，根据温差分级控制打水量，实现精细上水；水泵山墙、侧墙可独立控制。
- 7寸工业触摸屏操作，40路干式触点，运行可靠，使用便捷。
- 可以实现主页面实时显示当前养殖舍风机运转状态、温度、加热、制冷、进风口比例等。
- 可连接智能网关和云服务器，养殖数据实时、多终端共享，实现在家办公、云上养殖。

- Support 9 temperature, 1 humidity, 1 CO₂, 1 negative pressure environmental data collection, full and high precision.
- Built-in professional broiler temperature curve.
- Fine cooling and up to 36 ventilation levels and up to 24 fan groups, to achieve precision ventilation of the breeding house.
- Support 4 independent control of the air inlet, automatically adjust the position and size
- Divided into 3 zones, accurately control the heating heat according to the temperature of different areas in the breeding house.
- Can control 3 groups of cooling equipment, according to the temperature difference classification control water, to achieve fine water. Water pump gable wall, side wall can be independently controlled.
- touch screen operation, 40 dry contacts, reliable operation, easy to use.
- Realize the main page real-time display of the current farm fan operating status, temperature, heating, cooling, air inlet ratio, etc.
- Connect smart gateway and cloud server, farming data real-time, multi-terminal sharing, to achieve home office, cloud farming.

制冷温度	0.0 °C	当前温度	0.0 °C
启动时刻	08:00	启动时刻	08:00
停止时刻	08:00	停止时刻	08:00
启动温差	0.0 °C	启动温差	0.0 °C
停止温差	0.0 °C	停止温差	0.0 °C
启动比例	100%	启动比例	100%
停止比例	100%	停止比例	100%
启动时间	5 S	启动时间	5 S
停止时间	5 S	停止时间	5 S
启动风速	0.10	启动风速	0.10
停止风速	0.10	停止风速	0.10
启动风向	0.10	启动风向	0.10
停止风向	0.10	停止风向	0.10

制冷温度	0.0 °C	当前温度	0.0 °C
启动时刻	08:00	启动时刻	08:00
停止时刻	08:00	停止时刻	08:00
启动温差	0.0 °C	启动温差	0.0 °C
停止温差	0.0 °C	停止温差	0.0 °C
启动比例	100%	启动比例	100%
停止比例	100%	停止比例	100%
启动时间	5 S	启动时间	5 S
停止时间	5 S	停止时间	5 S
启动风速	0.10	启动风速	0.10
停止风速	0.10	停止风速	0.10
启动风向	0.10	启动风向	0.10
停止风向	0.10	停止风向	0.10

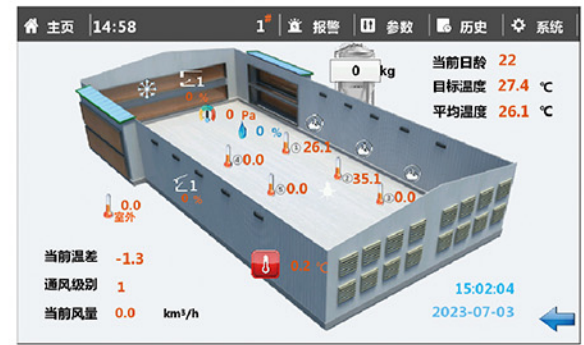

制冷温度	0.0 °C	当前温度	0.0 °C
启动时刻	08:00	启动时刻	08:00
停止时刻	08:00	停止时刻	08:00
启动温差	0.0 °C	启动温差	0.0 °C
停止温差	0.0 °C	停止温差	0.0 °C
启动比例	100%	启动比例	100%
停止比例	100%	停止比例	100%
启动时间	5 S	启动时间	5 S
停止时间	5 S	停止时间	5 S
启动风速	0.10	启动风速	0.10
停止风速	0.10	停止风速	0.10
启动风向	0.10	启动风向	0.10
停止风向	0.10	停止风向	0.10

制冷温度	0.0 °C	当前温度	0.0 °C
启动时刻	08:00	启动时刻	08:00
停止时刻	08:00	停止时刻	08:00
启动温差	0.0 °C	启动温差	0.0 °C
停止温差	0.0 °C	停止温差	0.0 °C
启动比例	100%	启动比例	100%
停止比例	100%	停止比例	100%
启动时间	5 S	启动时间	5 S
停止时间	5 S	停止时间	5 S
启动风速	0.10	启动风速	0.10
停止风速	0.10	停止风速	0.10
启动风向	0.10	启动风向	0.10
停止风向	0.10	停止风向	0.10

● 50 拢风筒风机 50 cone fan

- 采用430不锈钢扇叶，强度高，整机运行平稳；
- 风机抗负压能力强，专用于高负压鸡舍的通风降温；
- 自动张紧装置提高传动效率，减少维护频次；
- PCV材质百叶窗，防冰冻式设计，可拆卸式百叶窗组件，维护方便。
- The 430 stainless steel fan blade is used, has a high strength, and can facilitate the stable operation of the complete machine;
- The fan has a strong anti-NP ability and is specially used for ventilating and cooling the HNP poultry house;
- The automatic tensioning device used can improve the transmission efficiency and
- PCV material louvers, anti freezing design, detachable louver components, easy maintenance.



产品参数 Product parameters

额定功率 1.1/1.5kw，风量数据如下：
Rated power 1.1W.air volume data as follows

型号 Model	风量 m³/h Air volume m3/h						
	0pa	12pa	25pa	37pa	50pa	62pa	75pa
1.1KW 50 拢风筒风机 50 cone fan	39300	36600	34300	32800	28900	25600	20300
1.5KW 50 拢风筒风机 50 cone fan	42600	39600	36800	34700	31900	28800	25300

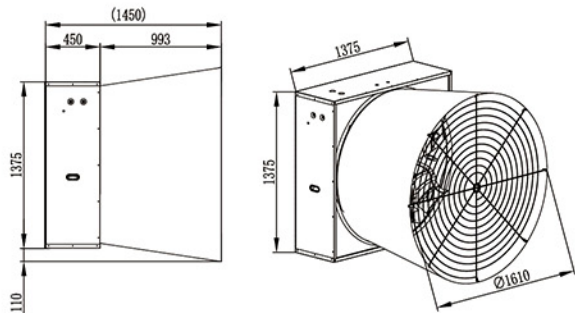

青岛大牧人机械股份有限公司
地址：青岛市城阳区空港工业园月河路
电话：0532-8493 3988
网址：www.bigherdsman.com
QINGDAO BIG HERDSMAN MACHINERY CO.,LTD
Add: Yuehe road, Konggang industrial park, Qingdao city,
Shandong Province, PR China
Tel: +86-532-8493 3988
Website: www.bigherdsman.com



微信扫描二维码，关注大牧人



大牧人
Big Herdsman

风机
Fan

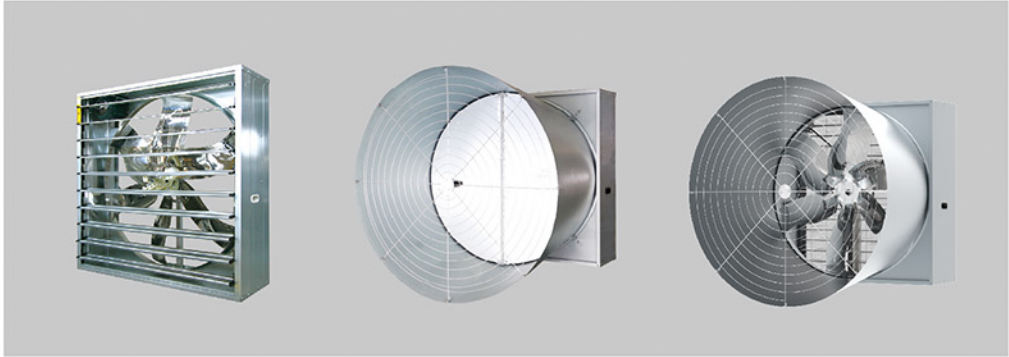

青岛大牧人机械股份有限公司
Big Herdsman Machinery CO.,LTD
让养殖变得简单/可靠/环保/高效
Simple/Reliable/Green/Efficient

50（36）箱式风机 50（36）Box fan

- 适用于鸡舍的通风降温，有效排出舍内废气；
- 不锈钢材质扇叶，表面光亮，具有自清洁功能；
- 扇叶组件经动平衡校正，整机运行平稳；
- 离心式开启机构，使百叶片完全90度开启；
- Suitable for the ventilation and cooling of chicken coops, effective discharge of waste gas in the shed;
- Stainless steel material fan leaves, bright surface, with self-cleaning function;
- Fan-leaf components are balanced by movement, and the whole machine runs smoothly;
- Centrifugal opening mechanism, so that the blinds are fully 90 degrees open;



产品参数Product parameters

额定功率1.1kw，风量数据如下：
Rated power 1.1kW, air volume data as follows

50箱式风机 50 box fan	负压pa	0	12	25	37	50	62
	风量m³/h	38400	36900	35100	32900	30100	26900

36箱式风机 36 box fan	负压pa	0	12	25	37	50	62
	风量m³/h	16200	14900	13000	10500	7400	5400

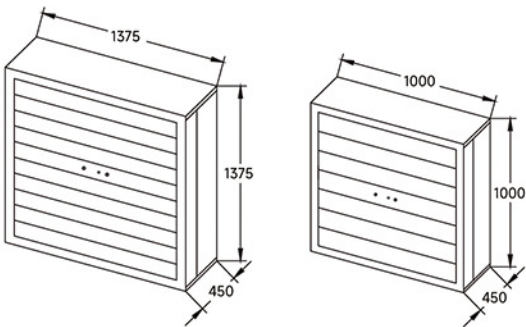

高负压50蝴蝶拢风筒风机HNP 50 butterfly cone fan

- 适用于高负压鸡舍的通风，抗负压范围0-100pa；
- 自动张紧装置提高传动效率，减少维护频次；
- 后端护网增加支撑结构，护网强度更高；
- 风筒可选配收窄款，适用于山墙空间紧凑鸡舍；
- Suitable for ventilation of high-negative pressure chicken coops with a negative pressure range of 0-100pa ;
- The automatic tensioning device used can improve the transmission efficiency and reduce the maintenance frequency;
- The support structure is added to the back-end protective net, which enhances the strength of the protective net;
- The narrowed air duct is optional, which is suitable for a poultry house with compact gable wall space.



产品参数Product parameters

额定功率1.5kw，风量数据如下：
Rated power1.5kW, air volume data as follows

高负压50蝴蝶风机 HNP 50 butterfly fan	负压pa	0	12	25	37	50	62	75
	风量m³/h	46600	44900	43300	41600	39700	37800	35500

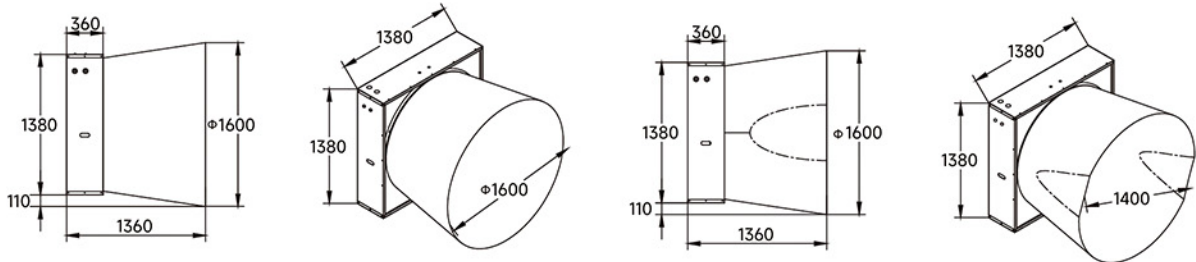

50蝴蝶拢风筒风机50 butterfly cone fan

- 适用于鸡舍的通风降温，有效排出舍内废气；
- 不锈钢材质扇叶，表面光亮，具有自清洁功能；
- 自动张紧装置提高传动效率，减少维护频次；
- 风筒可选配收窄款，适用于山墙空间紧凑鸡舍；
- Suitable for the ventilation and cooling of chicken coops, stable operation;
- Fan leaves are stainless steel material, bright surface, with self-cleaning function;
- The automatic tensioning device used can improve the transmission efficiency and reduce the maintenance frequency;
- The narrowed air duct is optional, which is suitable for a poultry house with compact gable wall space.

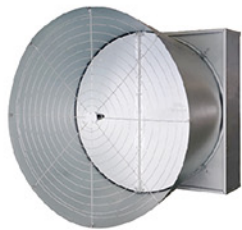

产品参数Product parameters

额定功率1.1kw，风量数据如下：
Rated power 1.1kW, air volume data as follows

50蝴蝶拢风筒风机 50 butterfly fan	负压pa	0	12	25	37	50	62
	风量m³/h	42300	41000	38500	36900	34000	30500

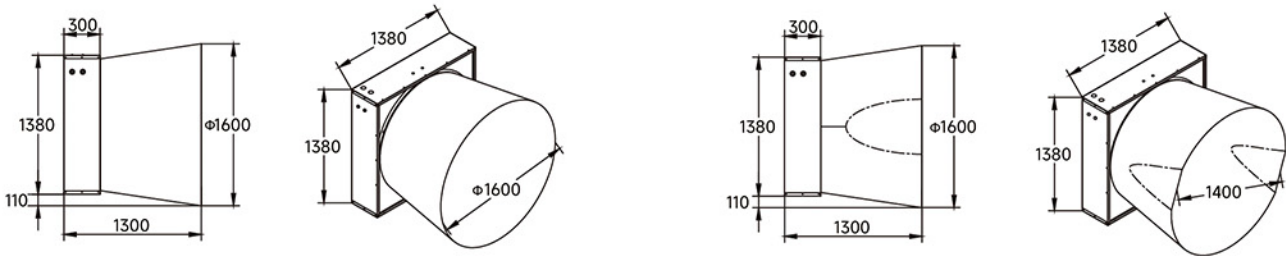

大牧人
Big Herdsman



保温门设备

Panel Door Equipment

保温门安装于湿帘进风口，冬季关闭保温，夏季开启通风。

Panel door is installed at the air inlet of cooling pad system. It can be closed in winter for heat preservation, and open ventilation in summer.

青岛大牧人机械股份有限公司
Big Herdsman Machinery CO.,LTD

让养殖变得简单/可靠/环保/高效
Simple/Reliable/Green/Efficient



- 保温性能好，隔热保温。
- 密封性能好，不漏贼风。
- 导风效果好，山墙保温门最大可开启90度，无通风死角。
- Good thermal insulation performance, effective thermal insulation.
- Good sealing performance, no leakage of wind after closing.
- Good air guide effect, gable insulation door can be opened up to 90 degrees, no ventilation dead Angle.



分类/Category	参数/parameters
面板材质/ Material	FRP、PVC
芯板材质/ Material	10kg/m ³ EPS、15kg/m ³ EPS、25kg/m ³ XPS、35kg/m ³ PU
保温板厚度/Thickness	50mm、30mm
高幅系列/Width range	600、650、710、780、980、1180
电机/ Motor	0.55KW, 600N.M, IP55, 2.6rpm
绞车/Winch	H-1500-1, Ratio 41:1

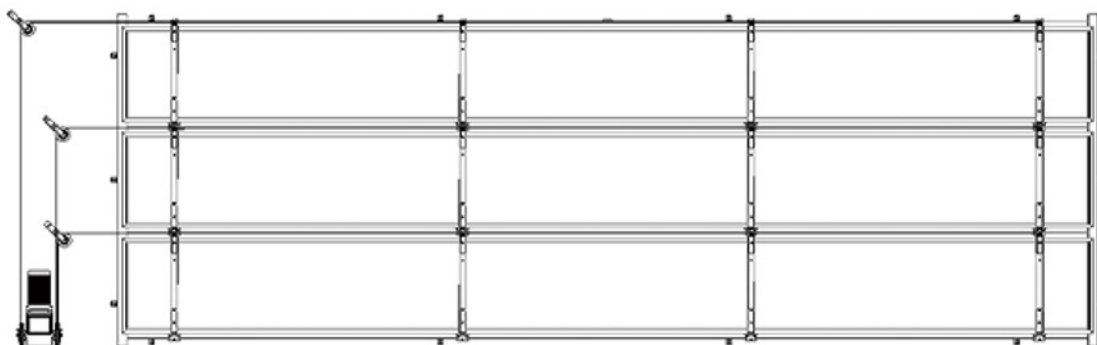
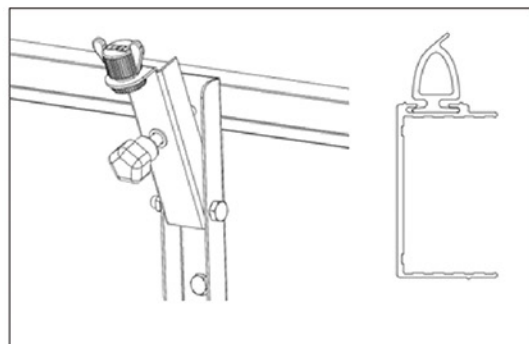

青岛大牧人机械股份有限公司

地址: 青岛市城阳区空港工业园月河路
电话: 0532-8493 3988
网址: www.bigherdsman.com

QINGDAO BIG HERDSMAN MACHINERY CO.,LTD
Add: Yuehe road, Konggang industrial park, Qingdao city,
Shandong Province, PR China
Tel: +86-532-8493 3988
Website: www.bigherdsman.com



微信扫描二维码，关注大牧人



湿帘

Cooling Pad System

湿帘主要用于禽舍降温，也可用于增湿。主要采用“湿帘—负压风机”模式，其工作原理：系统的降温过程是在其核心“湿帘纸”内完成的。当室外热空气被风机抽吸进入布满冷却水的湿帘纸时，冷却水由液态转化成气态的水分子，吸收空气中大量的热能从而使空气温度迅速下降，与室内的热空气混合后，通过负压风机排出室外。

Cooling pad is mainly used for poultry house cooling and humidification. The mode of “cooling pad-negative pressure fan” is mainly used, and the working principle goes like that: The cooling process of the cooling pad is completed in its core “cooling pad paper”. When the outdoor hot air is sucked into the cooling pad paper covered with cooling water by the fan, the cooling water will be transformed from liquid to gaseous water molecules, which absorb a large amount of heat energy in the air, so that the temperature of the air drops rapidly. After being mixed with indoor hot air, it will be discharged outdoors by the negative pressure fan.

青岛大牧人机械股份有限公司
Big Herdsman Machinery CO.,LTD

让养殖变得简单/可靠/环保/高效
Simple/Reliable/Green/Efficient



我公司湿帘分为铝合金湿帘和深水槽湿帘两种。

Our cooling pad system comprises cooling pad-aluminum alloy frame and PVC frame with water trough cool pad.

- 铝合金湿帘框架采用铝合金材质，美观实用，强度高。
- 深水槽湿帘下水槽为PVC深水槽，自带储水功能，不需额外修设水池。
- 湿帘主进水管路加装过滤器，过滤精度高，防止水中杂质堵塞喷水管及湿帘纸。
- Cooling pad-aluminum alloy frame uses aluminum alloy as frame material, which is practical, good-looking and has high strength.
- PVC frame with water trough cool pad uses PVC water trough, which has water storage function, so there is no need to build additional water pool.
- Main water inlet piping of cooling pad system is equipped with filter of high fineness, so as to prevent the spray pipe and the cooling pad paper from being clogged by impurities in water.

大牧人公司有多种规格型号的湿帘纸可供选择。

单块湿帘纸厚度0.15m，宽度0.6m，高度有1m、1.5m、1.8m、2.0m多种规格，同时还可加高安装；角度型号有7090（45°×45°）和7060（45°×15°），外观可选择常规不涂黑或单面涂黑型式。

Big Herdsman provides many kinds of cooling pad papers to choose from. A single piece of cooling pad paper has a thickness of 0.15m, a width of 0.6m and a height of 1m, 1.5m, 1.8m and 2.0m respectively. At the same time, it can be installed by heightening. The angle models are 7090 (45 × 45) and 7060 (45 × 15), and the appearance options of conventional non-blackening and single-sided blackening are available.

常规水泵参数：

Parameters of water pump:

序号 NO.	功率 POWER	流量 Flow	额定扬程 Rated lift	额定电源 Rated power	推荐湿帘长度 Recommend length
QDX1.5 - 12 - 0.25KW	0.25KW	1.5m ³ /h	12m	220V /50HZ	0 < L < 5 米
QDX1.5 - 17 - 0.37KW	0.37KW	1.5m ³ /h	17m	220V /50HZ	5 ≤ L < 10 米
QDX10 - 12 - 0.55KW	0.55KW	10m ³ /h	12m	220V /50HZ	10 ≤ L < 20 米
QDX8 - 18 - 0.75KW	0.75KW	8m ³ /h	18m	220V /50HZ	20 ≤ L < 30 米

自吸循环水泵参数：

Parameters of conventional self-priming circulating water pump:

水泵型号 NO.	额定功率 POWER	最大流量 Flow	最大扬程 Rated lift	额定电源 Rated power	湿帘纸长度 length
HLS — 370	0.37KW	180L/min	9m	220V — 240V/50HZ	小于 9 米
HLS — 550	0.55KW	215L/min	10m	220V — 240V/50HZ	9 米 — 15 米
HLS — 900	0.9KW	300L/min	13m	220V — 240V/50Hz	15 米 — 25 米
HL -150	1.1KW	460L/min	17m	220V 50HZ	25 米 — 35 米

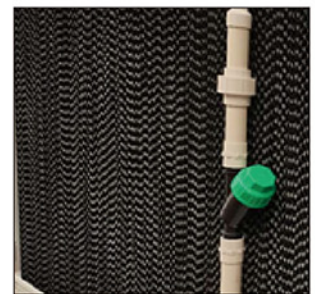
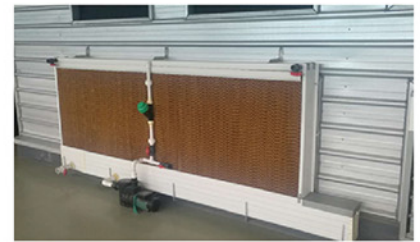

青岛大牧人机械股份有限公司

地址：青岛市城阳区空港工业园月河路
电话：0532-8493 3988
网址：www.bigherdsman.com

QINGDAO BIG HERDSMAN MACHINERY CO.,LTD
Add: Yuehe road, Konggang industrial park, Qingdao city,
Shandong Province, PR China
Tel: +86-532-8493 3988
Website: www.bigherdsman.com



微信扫描二维码，关注大牧人

大牧人
Big Herdsman



幕帘

Curtain system

幕帘安装在进风口上，调节通风面积，以达到理想通风换气效果。
The curtain is installed on the air inlet to adjust the ventilation area to achieve the ideal ventilation effect.

青岛大牧人机械股份有限公司
Big Herdsman Machinery CO.,LTD

让养殖变得简单/可靠/环保/高效
——Simple/Reliable/Green/Efficient——



技术说明/Technical Description

幕帘结构简单，使用方便，可提供安全、有效、持久的通风控制。

Curtain structure is simple, easy to use, can provide safe, effective, lasting risk control system.

帘布分类 Curtain fabric classification		
材质Material	PE	PVC
克重Weight (g)	200±10 g/m ²	500±30 g/m ²
颜色Color	白色White	黑银Black and silver
UV	有Available	
结构Structure	四道口/单封边Four crossings/single-edge sealing	
遮光Shade	/	有Available



控制方式Control mode

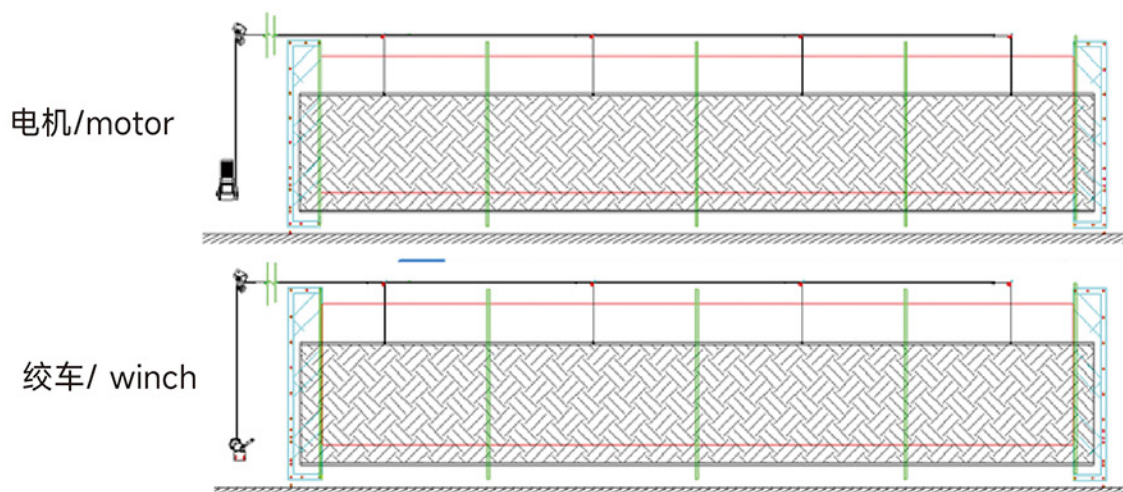

青岛大牧人机械股份有限公司

地址: 青岛市城阳区空港工业园月河路
电话: 0532-8493 3988
网址: www.bigherdsman.com

QINGDAO BIG HERDSMAN MACHINERY CO.,LTD
Add: Yuehe road, Konggang industrial park, Qingdao city,
Shandong Province, PR China
Tel: +86-532-8493 3988
Website: www.bigherdsman.com



微信扫描二维码，关注大牧人

大牧人
Big Herdsman



进风窗
Air Inlet

进风窗可调节进风面积，控制进舍风速及通风量，以达到理想通风换气效果。

Inlet window can adjust the area of air intake, control the wind speed and ventilation volume of the house, to achieve the ideal ventilation effect.

青岛大牧人机械股份有限公司
Big Herdsman Machinery CO.,LTD

让养殖变得简单/可靠/环保/高效
Simple/Reliable/Green/Efficient

● 弹簧进风窗 Spring Air Inlet

- 进风窗由驱动牵引开启，弹簧拉紧关闭。
- 进风窗设计有沟筋咬合结构，关闭密封效果好。
- 进风窗配导流板，可调不同开启角度，确保小窗进风吹至鸡舍中央。
- The air inlet is opened by drive traction and closed by spring tension.
- The air inlet is designed with groove rib occlusal structure, which has good sealing effect.
- The air inlet is equipped with a guide plate, which can be adjusted to different opening angles to ensure that the air inlet is blown into the center part of poultry house.



分类/Category	参数/parameters	
材质/The material	PS	
尺寸/ The hole size	560mm (W) *270mm (H)	840mm(W)*270mm(H)
面积/Area	0.11m ²	0.16m ²

● 弧面进风窗系统 Air inlet system with curved

- 进风窗由驱动牵引关闭，自重开启。
- 进风窗设计有PU密封条，关闭密封效果好。
- 进风窗配导流板，可调不同开启角度，确保小窗进风吹至鸡舍中央。
- The air inlet is closed by drive traction and opened by self weight.
- The air inlet window is designed with PU sealing strip, which has good sealing effect.
- The air inlet is equipped with a guide plate, which can be adjusted to different opening angles to ensure that the air inlet is blown into the center part of poultry house.



分类/Category	参数/parameters	
材质/The material	PP+PVC	
尺寸/ The hole size	800mm(W)*270mm(H)	1200mm(W)*270mm(H)
面积/Area	0.16m ²	0.24m ²
拉臂/NO. of pull arms	1	2

● 侧墙大窗系统

- 进风窗由驱动牵引关闭，自重开启。
- 进风窗设计有橡胶密封条，关闭密封效果好。
- 进风窗配导流板，可调不同开启角度，确保小窗进风吹至鸡舍中央。

- The air inlet is closed by driving traction and opened by self-gravity.
- Air inlet is designed with rubber sealing strip, good sealing effect.
- The air inlet is equipped with a guide plate, which can be adjusted to different opening angles to ensure that the air is blown to the center of the chicken house.



分类/Category	参数/parameters
材质/The material	ABS+PVC
尺寸/ The hole size	800mm(W)*500mm(H)
面积/Area	0.26m ²
拉臂/NO. of pull arms	1



青岛大牧人机械股份有限公司

地址: 青岛市城阳区空港工业园月河路
电话: 0532-8493 3988
网址: www.bigherdsman.com

QINGDAO BIG HERDSMAN MACHINERY CO.,LTD
Add: Yuehe road, Konggang industrial park, Qingdao city,
Shandong Province, PR China
Tel: +86-532-8493 3988
Website: www.bigherdsman.com



微信扫描二维码，关注大牧人

大牧人
Big Herdsman



调光照明系统 Dimming Lighting System



智能调光器采用BH1607 (2kW) 和BH1608 (4kW) 两种型号。

Two models of smart dimmers are available, BH1607 (2kW) and BH1608 (4kW).

该智能调光系统是为适应肉、种、蛋禽养殖照明自主研发的调光控制系统，通过本系统可以对照明直流灯具的亮度、亮度时间、亮度变化进行精准控制，给畜禽一个适宜的光环境。

The smart dimming system is independently developed for broiler and duck breeding. It can control the brightness, time and brightness change of DC lights accurately to provide a suitable light environment for broilers and ducks.

青岛大牧人机械股份有限公司
Big Herdsman Machinery CO.,LTD

让养殖变得简单/可靠/环保/高效
Simple/Reliable/Green/Efficient

智能调光器特点Features of intelligent dimmer

- 显示屏：采用7寸电容触摸屏，操作简单，易上手，可视性强。
- 系统采用交流220V，50Hz/60Hz供电，输出直流0-50V可调可设置。
- 支持外部控制，手动控制，日龄控制，实现自动调光。
- 支持亮度变化延时控制（延时时间可调）。
- 支持中英文语言切换。
- 输入端带有过欠压保护功能，防止电压过低或过高损害电源。
- 拥有应急功能，可通过应急开关开启强制输出，机械式调光。
- Display screen: 7" capacitive touch screen, which is easy to operate and use, and visible.
- AC 220V, 50Hz/60Hz power supply, and DC 0-50V adjustable and setttable output.
- External control, manual control and age-in-day control supported.
- Brightness change delay control (adjustable delay time) supported.
- Chinese-English language switching supported.
- It has emergency function, can start forced output through emergency switch, and mechanical dimming.
- The input terminal is provided with overvoltage and undervoltage protection function to prevent the power supply from being damaged by too low or too high voltage.



调光灯具采用直流10W球泡灯和T5灯管两种型号DC 10W bulb light and T5 tube light

“红黄蓝”系列球泡灯

"Red, yellow and blue" series bulb lights



球泡灯参数Parameters:

球泡灯型号 Model	功率 Power	灯头型号 light holder	电压 Voltage	色温 Color temperature	防水等级 Waterproof grade
红色系Red	10W	E27	DC48V	3000K	IP67
黄色系Yellow					
蓝色系Blue					

“红黄蓝”系列T5灯管

"Red, Yellow and Blue" Series T5 Tube lights



T5灯管参数Parameters:

球泡灯型号 Model	功率 Power	灯头型号 light holder	电压 Voltage	色温 Color temperature	防水等级 Waterproof grade
红色系Red	4W/6W	1.2m/1.4m	DC48V	3000K	IP67
黄色系Yellow					
蓝色系Blue					

- DC直流、无频闪、安全可靠、不易起火、寿命长，三年质保，三年光衰不超过10%。
- 通过独特内部电路设计，并按照红黄蓝的排列顺序排列，解决鸡舍前后端压降问题，使得亮度更加均匀。
- 高光效、IP67防水等级。
- 色温3000K,可以有效减少鸡啄、提升肉质、增加产蛋量，促进鸡、鸭健康生长。

- DC, no stroboscopic, safe and reliable, not prone to fire, long service life.
- Unique internal circuit design and arrangement of red, yellow and blue lights to avoid voltage drop at the front and back ends of the poultry house and allow more uniform brightness.
- High light efficiency, waterproof grade of IP67.
- Color temperature of 3000K to effectively reduce broiler pecking, improve meat quality, increase meat weight, and promote the healthy growth of broilers and ducks.



青岛大牧人机械股份有限公司

地址: 青岛市城阳区空港工业园月河路
电话: 0532-8493 3988
网址: www.bigherdsman.com

QINGDAO BIG HERDSMAN MACHINERY CO.,LTD
Add: Yuehe road, Konggang industrial park, Qingdao city,
Shandong Province, PR China
Tel: +86-532-8493 3988
Website: www.bigherdsman.com



微信扫描二维码，关注大牧人

大牧人
Big Herdsman



鸡用水线

Water line for poultry

该乳头式饮水系统适用于各种禽类动物饮水，其结构简单可靠，供水及密封性能良好。

The nipple-type drinking water system features simple and reliable structure and good water supply and sealing and applies to water feeding of various kinds of poultry animals



青岛大牧人机械股份有限公司
Big Herdsman Machinery CO.,LTD

让养殖变得简单/可靠/环保/高效
——Simple/Reliable/Green/Efficient——



技术说明/Technical Description

- 水线前端采用二级过滤，有效过滤掉水中的杂质。
- 单独的反冲管路有利于准确记录鸡只的饮水情况。
- 专有的调压器可调节水压大小，从而调节乳头的出水量，适应不同日龄鸡只的饮水需求，并且带有反冲旋钮（手动/自动），方便冲洗水线。

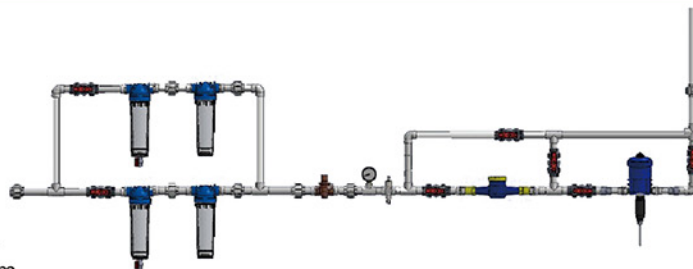

- 饮水乳头为双密封结构，360度侧击出水，上顶出水，保证鸡只在任何位置都可以喝到水。有红色、黄色两种饮水乳头：红色20cm水压乳头侧击平均出水量为18ml/min，种鸡常用；黄色20cm水压乳头侧击平均出水量为34ml/min，肉鸡常用。
- 饮水管配有可伸缩的公母接头，可消除因热胀冷缩产生的应力，避免损坏饮水管。
- 末端配有透明钢丝软管和集中排污管路，方便观察水位及冲洗水线。

- The water front parts is equipped with a double-layer filter, witch can effectively filter impurities in water.
- The separate recoil line allows to accurately record how much water the chickens drink.
- The pressure regulator can be adjusted so as to adjust the nipple's water output, to meet the needs of the chicken's different age, and with a recoil knob (manual/automatic), easy to flush water line.
- The drinking nipples are double sealed structure, and they can flow by both 360 degrees side knocking and by top knocking, which ensure that chickens can drink water at any position. There are two kinds of drinking nipples, the red and the yellow, which are respectively used for breeding chicken and broiler feeding. The red nipples' average water flow is 18mL /min at 20cm water pressure, and the yellow nipples' average water flow is 34 mL /min at 20cm water pressure.
- The drinking pipes with retractable hermaphrodite connectors can relieve stress caused by thermal expansion and contraction, preventing damage to the pipe.
- The tube end is equipped with transparent steel wire hose and centralized drain line for easy observation of water level and flushing water line.

- 有红色、黄色两种饮水乳头，分别用于种鸡、肉鸡的喂养，360度侧击出水，上顶出水，出水量根据水压可调节，满足各日龄鸡只的饮水需求。

- There are two kinds of drinking nipples (red and yellow) for feeding breeders and broilers respectively. Water can come out from the upper top by laterally tapping in any direction within 360°. Its water flow can be adjusted according to water pressure to meet the drinking demands of the poultry of different ages in days.

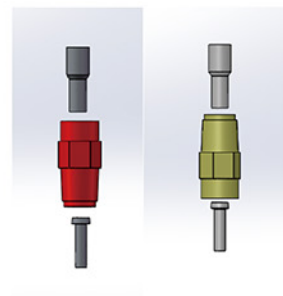

技术参数 / Technical Parameters

序号 S/N	种类 Category	饲养量 Feeding capacity
1	肉鸡 Broiler	8- 12 只/Unit 8- 12 birds/Unit
2	鸭 Duck	10 只/ Unit 10 birds/Unit
3	种鸡 Breeder	10 只/ Unit 10 birds/Unit

饮水乳头饲养量 Drinking nipple feeding capacity



青岛大牧人机械股份有限公司

地址：青岛市城阳区空港工业园月河路
电话：0532-8493 3988
网址：www.bigherdsman.com

QINGDAO BIG HERDSMAN MACHINERY CO.,LTD
Add: Yuehe road, Konggang industrial park, Qingdao city,
Shandong Province, PR China
Tel: +86-532-8493 3988
Website: www.bigherdsman.com



微信扫描二维码，关注大牧人

● 人工产蛋箱Nest System

人工产蛋箱主要用适用于种鸡和蛋鸡，作为产蛋穴使用。
Nest system are mainly for breeders and layers as egg laying holes.

● 技术说明/Technical Description

- 采用防栖支架结构，避免鸡只站于产蛋箱上。
- 木质栖息架，鸡只福利养殖，可根据需要关闭产蛋箱。
- 上部有防栖支架，可有效保持产蛋箱表面的清洁。
- 前部有可活动的支架，可以根据需要关闭产蛋箱，防止鸡只晚间在里面栖息。
- 产蛋箱侧板上设有通风孔，可保持产蛋箱内良好的通风。
- 针型草垫，保证蛋窝舒适，背面采用方形透气孔设计，方便清理蛋窝垃圾。
- Anti-roost support structure is adopted to avoid chickens standing on the nest.
- Wooden roost racks for caring breeding of chickens, and nest can be closed as required.
- The upper part is provided with anti-roost support, which can effectively keep the surface of the nest clean.
- A movable support is equipped in the front, which can close the nest as required to prevent chickens from inhabiting inside at night.
- Ventilation holes are set on the side plate of the nest to provide good ventilation.
- Needle-shaped straw mat ensures the comfort of the nest. The back is designed with square air holes, which is convenient for cleaning up the garbage in the nest.



产品参数Product parameters

蛋穴数量 Number of Nests	每套产蛋箱父母代鸡只数量（羽） Number of parent chickens in each nest (Nr.)	重量 (kg) Weight
双层 24 穴 Double-tier 24 holes	96	50
双层 12 穴 Double-tier 12 holes	48	25
单层 12 穴 Single-tier 12 holes	48	28
单层 6 穴 Single-tier 6 holes	24	14



青岛大牧人机械股份有限公司

地址：青岛市城阳区空港工业园月河路
电话：0532-8493 3988
网址：www.bigherdsman.com

QINGDAO BIG HERDSMAN MACHINERY CO.,LTD
Add: Yuehe road, Konggang industrial park, Qingdao city,
Shandong Province, PR China
Tel: +86-532-8493 3988
Website: www.bigherdsman.com



微信扫描二维码，关注大牧人

青岛大牧人机械股份有限公司
Big Herdsman Machinery CO.,LTD

让养殖变得简单/可靠/环保/高效
Simple/Reliable/Green/Efficient

大蛋穴自动产蛋箱Big Hole Auto Nest

自动产蛋箱是自动收集和清理鸡蛋的现代化设备，其主要功能是通过输送带将鸡舍中干净鸡蛋平稳的输送到鸡舍外的操作间。

The auto nest is modern equipment for automatic collection and cleaning of eggs. It is designed to convey clean eggs from the poultry house smoothly to the operation room outside the poultry house through the conveyor belt.

技术说明/Technical Description

- 捡蛋台运行速度可调0~4.7m/min。
- 蛋窝空间超大，同时容纳4-5.5只鸡同时产蛋（高峰期可以容纳8-10只）。
- 蛋窝底部柔软舒适，侧面和顶部透气顺畅，保障安全舒服的产蛋环境。
- 蛋窝前方红色布帘，吸引鸡群产蛋，同时保证蛋窝内部鸡群不受外界干扰。
- 针状蛋窝结构，保证刚产出的鸡蛋不接触任何异物，保障鸡蛋表面不被污染。
- 鸡群产蛋完成后，鸡蛋迅速滑落到方孔输送带上，避免鸡群啄蛋的机会。
- 方孔输送带，且保证鸡蛋稳定输出，输送带内部良好的通风性能，提高孵化率。
- 产蛋底网可翻转，防止熄灯后鸡只趴窝问题的产生。
- Adjustable running speed of the egg picking table of 0 ~ 4.7 m/min.
- Spacious nest for 4 - 5.5 layers laying eggs at the same time (up to 8 - 10 in peak period).
- Soft and comfortable nest bottom, ventilated sides and top to ensure a safe and pleasant egg laying environment.
- Red cloth curtain in front of the nest to attract the layers to lay eggs, while ensuring that the herd inside the nest is not disturbed by the outside.
- Needle-shaped nest structure prevents the freshly produced eggs from contacting any foreign objects and protects the egg surface from contamination.
- After the herd have finished laying, eggs quickly slide down to the square-hole conveyor belt, avoiding the chance of egg pecking by the herd.
- Square-hole conveyor belt ensures stable egg output, and good ventilation inside the belt improves the hatching rate.
- The egg-laying bottom net can be turned over to prevent layers from lying on the nest after lights out.



产品参数Product parameters

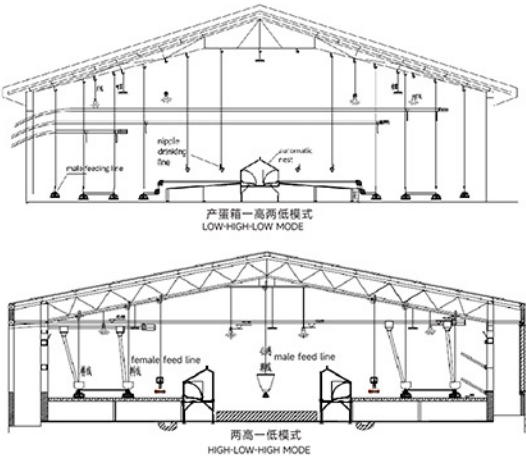

模式分类	一高两低模式 LOW-HIGH-LOW MODE	两高一低模式 HIGH-LOW-HIGH MODE
电机功率 (Kw)	1.5	0.75
运行速度 (m/min)	0- 4.7	
输送带宽度 (mm) conveyor belt width	500	250
蛋穴尺寸 (长*宽) dimension L*W	1150*500mm	
养殖密度 (羽/穴) Capacity birds/unit	48-56	

小蛋穴自动产蛋箱Single-hole Auto Nest System

小蛋穴自动产蛋箱集蛋系统的用途是采集鸡蛋，用于肉种鸡平养，两高一低的饲养模式。

The egg collection system of Single-hole Auto Nest functions to collect eggs, and is used in the floor breeding and High-Low-High feeding modes for broiler breeders.

技术说明/Technical Description

- 捡蛋台运行速度可调0~5m/min。
- 捡蛋台采用PVC板材材质，不变形，耐腐蚀，易清洗。
- 采用pp白色挤出输送带，经久耐用。
- 产蛋箱草垫为针型草垫，多孔设计，可以有效漏粪。
- 挡鸡杆统一提升和降落，能有效阻挡鸡只进入蛋穴。
- 稳定性防晒翻板，有效防止鸡只站立于产蛋箱顶端，延长蛋箱顶板等部件的使用寿命。
- 破蛋和地面蛋比例低，提高合格蛋比例，减轻工人负担。
- The running speed of the egg picking table can be adjusted by 0 ~ 5 m/min.
- The egg picking table is made of PVC plate, which is not deformed, corrosion-resistant and easy to clean.
- The durable PP white extrusion conveyor belt is adopted.
- The needle-shaped straw mat of nest is designed as porous, which can effectively discharge manure.
- The chicken retaining rod can be lifted and lowered uniformly, which can effectively prevent chickens from entering the egg hole.
- Stable anti-perching turnable plate can effectively prevent chickens from standing on the top of the nest, and prolong the service life of top plate of the nest and the like.
- The broken eggs and eggs laid on the ground are reduced, improving the ratio of qualified eggs and reduces the burden on workers.



产品参数Product parameters

- 单组蛋箱尺寸A*E*D=2440*960*550; A*E*D=2440*960*550。
- 蛋穴尺寸B*C=270*355。
- 电机功率：0.55kw。
- 输送带速度：0~5m/min。
- 每个蛋穴对应的蛋鸡数量:约6只
- The size of a single egg box is A*E*D=2440*960*550; A*E*D=2440*960*550.
- Egg hole size B*C=270*355.
- Motor power: 0.55 kW
- Conveyor belt speed: 0~5 m/min
- Number of layer in each egg hole: about 6

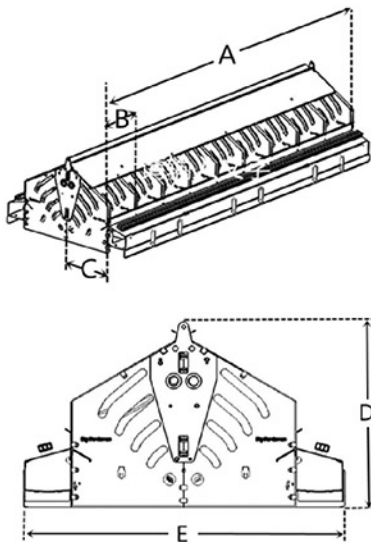



45绞龙料线
45 Auger feeding system

送料系统通过螺旋弹簧绞龙旋转送料，在每条副料线的末端各有一料位感应器，自动控制驱动电机的启闭，实现自动送料。

The feeding system functions through the rotation of a spiral spring auger. There is a feed level sensor at the end of each auxiliary feed line to automatically control the on/off of the motor, so as to realize automatic feeding.



青岛大牧人机械股份有限公司
地址：青岛市城阳区空港工业园月河路
电话：0532-8493 3988
网址：www.bigherdsman.com
QINGDAO BIG HERDSMAN MACHINERY CO.,LTD
Add: Yuehe road, Konggang industrial park, Qingdao city,
Shandong Province, PR China
Tel: +86-532-8493 3988
Website: www.bigherdsman.com



微信扫描二维码，关注大牧人

青岛大牧人机械股份有限公司
Big Herdsman Machinery CO.,LTD
让养殖变得简单/可靠/环保/高效
Simple/Reliable/Green/Efficient

45绞龙肉鸡料线45 Broiler Auger feeding system

- 驱动采用意大利品牌电机，铝合金外壳，散热快，不生锈，防护等级IP55；
- 绞龙采用进口高性能材质绞龙，性能稳定；
- 料盘分为14格栅内调和外调两种样式，养殖量约为170kg/盘；
- 提升可选用人工升降或电动升降，方便调节料线的高度；
- A Italian-brand motor is employed for drive. It has an aluminum alloy housing providing fast heat dissipation, no rust, and protection grade of IP55;
- The auger is made of imported high-performance material, with stable performance;
- The feed pan includes two types: 14-grill internal adjustable and external adjustable types, and the breeding capacity is about 170 kg/ pan;
- Manual lifting or electric lifting are options for lifting, convenient for adjusting the height of feed line;



产品参数Product parameters

绞龙料线规格 Auger Feedline Specification		45 料管 45 Weld Pipe	
料管直径 Feed Pipe Diameter (mm)		Φ45	
料管壁厚 Feed Pipe Thickness (mm)		1.2	
料管材质 Feed Pipe Material		热镀锌管 Hot galvanized pipe	
电机 Motor	电压 Voltage (V)	380	
	频率 Frequency (Hz)	50	
	防护等级 Protection Class	IP55	
	功率 Power (kw)	0.75	1.1
	转速比 Speed Ratio	1:5	
	输出转速 Output Speed (r/min)	290	
送料能力 Horizontal Delivery Capacity (kg/h)		450	
最大输送距离 Max Delivery Distance (m)		120	140
料管长度 Feed Pipe Length (mm)		3040	
绞龙外径 Auger Outer Diameter (mm)		36.8	
绞龙内径 Auger Inner Diameter (mm)		20.8	
绞龙断面宽度 Auger Cross - section Width (mm)		8	
绞龙断面厚度 Auger Cross - section Thickness (mm)		3.85	
绞龙螺距 Auger Pitch (mm)		44.45	



14格栅内调料盘容量
Feed Quantity of 14-grill Internal Adjustable Feed Pan

档位 Gear	1	2	3	4	5
料量 (g) Feed quantity (g)	260	275	360	400	520
档位 Gear	6	7	8	9	10
料量 (g) Feed quantity (g)	530	610	640	770	850



14格栅外调料盘容量
Feed Quantity of 14-grill External Adjustable Feed Pan

档位 Gear	1	2	3	4	5 档
料量 (g) Feed quantity (g)	830	845	1090	1280	1320

45绞龙公鸡料线45 Auger feeding system for Males

- 驱动采用意大利品牌电机，铝合金外壳，散热快，不生锈，防护等级IP55；
- 绞龙采用进口高性能材质绞龙，性能稳定；
- 料盘分为九格栅和五格栅两种，每个料盘饲养8-10只鸡；
- 提升可选用人工升降或电动升降，方便调节料线的高度；
- A Italian-brand motor is employed for drive. It has an aluminum alloy housing providing fast heat dissipation, no rust, and protection grade of IP55;
- The auger is made of imported high-performance material, with stable performance;
- The feed pan includes nine-grill and five-grill types, and each feed pan is for 8-10 chickens;
- Manual lifting or electric lifting are options for lifting, convenient for adjusting the height of feed line;



产品参数/Product Parameters

绞龙料线规格 Auger Feedline Specification		45 料管 45 Weld Pipe	
料管直径 Feed Pipe Diameter (mm)		Φ45	
料管壁厚 Feed Pipe Thickness (mm)		1.2	
料管材质 Feed Pipe Material		热镀锌管 Hot galvanized pipe	
电机 Motor	电压 Voltage (V)	380	
	频率 Frequency (Hz)	50	
	防护等级 Protection Class	IP55	
	功率 Power (kw)	0.75	1.1
	转速比 Speed Ratio	1:5	
	输出转速 Output Speed (r/min)	290	
送料能力 Horizontal Delivery Capacity (kg/h)		450	
最大输送距离 Max Delivery Distance (m)		120	140
料管长度 Feed Pipe Length (mm)		3040	
绞龙外径 Auger Outer Diameter (mm)		36.8	
绞龙内径 Auger Inner Diameter (mm)		20.8	
绞龙断面宽度 Auger Cross - section Width (mm)		8	
绞龙断面厚度 Auger Cross - section Thickness (mm)		3.85	
绞龙螺距 Auger Pitch (mm)		44.45	

九格栅料盘容量：
Feed Quantity of Nine-grill Feed Pan

档位 Gear	1 档	2 档	3 档	4 档	5 档	6 档	7 档	8 档
料量 (g) Feed quantity (g)	465g	500g	550g	590g	635g	680g	725g	770g
档位 Gear	9 档	10 档	11 档	12 档	13 档	14 档	15 档	16 档
料量 (g) Feed quantity (g)	815g	875 g	935g	995g	1060g	1125g	1190 g	1260g

五格栅料盘容量：
Feed Quantity of Five-grill Breeder Feed Pan:

档位 Gear	1	2	3	4	5
料量 (g) Feed quantity (g)	750	820	900	990	1080
档位 Gear	6	7	8	9	10
料量 (g) Feed quantity (g)	1170	1270	1380	1490	1600

大牧人
Big Herdsman

2



遮光罩
Light trap

青岛大牧人机械股份有限公司
Big Herdsman Machinery CO.,LTD

让养殖变得简单/可靠/环保/高效
——Simple/Reliable/Green/Efficient——

● 遮光罩(W型) Light trap (W-type)

- 适用于养殖舍遮光场合，遮光率达99%；
- 规格多样可根据实际需要情况定制；
- 硬质PVC材质料遮光片，耐腐蚀、易清洗；
- Suitable for the shelter blackout situation, the blackout rate of 99%;
- Various specifications are available;
- Hard PVC material, anti-corrosion, easy to clean;

产品参数Product parameters

名称型号 Model	长×高×厚 L × H × T (mm)	遮光率 Shading rate %
50遮光罩 50 Fan light trap	1375×1375×202	99%
36遮光罩 36 Fan light trap	1000×1000×202	99%
560*270窗遮光罩 560*270Inlet light trap	610×296×202	99%
800*270窗遮光罩 800*270Inlet light trap	865×296×202	99%
1200*270窗遮光罩 1200*270Inlet light trap	1265×296×202	99%



● 风机遮光罩(S型) Fan light trap (S-type)

- 适用于养殖舍非完全遮光场合，常压风阻约12%；
- 规格多样可根据实际尺寸定制；
- 硬质PVC材质料遮光片，耐腐蚀、易清洗；
- 遮光片卡接式固定结构，便于组装及拆卸保养；
- Suitable for the shelter blackout situation, the blackout rate of 99%;
- Various specifications are available;
- Hard PVC material, anti-corrosion, easy to clean;
- The light-shielding chip is connected to the fixed structure, which is easy to assemble and remove and maintain;

产品参数Product parameters

名称型号 Model	长×高×厚 L × H × T (mm)	风阻率 resistance rate %
50遮光罩 50 light trap	1375×1375×272	12%
36遮光罩 36 light trap	1000×1000×272	12%



青岛大牧人机械股份有限公司

地址：青岛市城阳区空港工业园月河路
电话：0532-8493 3988
网址：www.bigherdsman.com

QINGDAO BIG HERDSMAN MACHINERY CO.,LTD
Add: Yuehe road, Konggang industrial park, Qingdao city,
Shandong Province, PR China
Tel: +86-532-8493 3988
Website: www.bigherdsman.com



微信扫描二维码，关注大牧人

大牧人
Big Herdsman



45塞盘料线

45 Chain Pan Feeding System

料线通过链条在料管里运行，由链条上注塑的尼龙链盘推动饲料运动，将饲料由料箱通过链条的拖拉沿料管输送至各个料盘，达到饲喂的目的。本料线能满足各种家禽的限制饲喂、不限制饲喂等不同需求。

The feed line moves in the feeding pipe through the chain, and the nylon chain pan molded on the chain drives the feed to move in the feeding pipe, and the feed is transported from the feed box dragged by the chain along the feeding pipe to feed pans to achieve the purpose of feeding. This feed line can meet different needs such as restricted feeding and unrestricted feeding of various poultry.

青岛大牧人机械股份有限公司
Big Herdsman Machinery CO.,LTD

让养殖变得简单/可靠/环保/高效
——Simple/Reliable/Green/Efficient——

技术说明/Technical Description

- 驱动采用意大利品牌电机，铝合金外壳，散热快，不生锈，防护等级IP55；
- 主从动轮尼龙加玻纤材质，有效减轻与链盘之间的磨损，有安全销和过载保护功能，避免电机烧坏；
- 链盘采用改性尼龙材质，耐磨性高，不易移位；
- 转角采用防锈材质，坚固耐用；
- 料盘可全程使用，能够满足鸡只同时吃料，应激性小，料盘采食口宽度和高度可调，避免公鸡抢食；
- 饲料破碎率低，无污染，运行平稳，噪音低；
- 提升可选用人工升降或电动升降，方便调节料线的高度；
- A Italian-brand motor is employed for drive. It has an aluminum alloy housing providing fast heat dissipation, no rust, and protection grade of IP55;
- The drive and driven wheels are made of nylon and glass fiber, effectively reducing the wear with the chain pan, and they are provided with safety pins and overload protection to prevent the motor from burning out;
- The chain pan is made of modified nylon, with high wear resistance and not easy to be shifted;
- The corner is made of anti-rust material, firm and durable;
- The feed pan can be used throughout the whole process, and allows chickens to eat at the same time, with little stress. The width and height of the feeding opening of the feed pan are adjustable, avoiding males from grabbing food;
- Low broken rate of feed, no pollution, smooth operation and low noise;
- Manual lifting or electric lifting are options for lifting, convenient for adjusting the height of feed line;



产品参数/Product Parameters

塞盘料线规格 Pan Feedline Specification		45 料管 45 Weld Pipe
电机 Motor	电压 Voltage (V)	380
	频率 Frequency (Hz)	50
	防护等级 Protection Class	IP55
	功率 Power (kw)	1.5
	减速比 Speed Ratio	40
	输出转速 Output Speed (r/min)	35
链条速度 Chain Speed (m/min)		30
水平送料能力 Horizontal Delivery Capacity (kg/h)		900
水平最大输送距离 Max Delivery Distance (m)		300 (含 4 个转角) 300 (4 corners)
料管直径 Feed Pipe Diameter (mm)		Φ44.5
料管壁厚 Feed Pipe Thickness (mm)		1.2
料管材质 Feed Pipe Material		热镀锌管
料管长度 Feed Pipe Length (mm)		3040/根

料盘档位与料量对应关系如下表:

The corresponding relationship between feed pan gears and the feed quantity is shown in the following table:

档位 Gear	1	2	3	4	5	6	7	8
料量 Feed quantity (g)	305g	315g	375g	400g	440g	470g	500g	525g
档位 Gear	9	10	11	12	13	14	15	16
料量 Feed quantity (g)	550g	590g	610g	660g	690g	735g	775g	800g



青岛大牧人机械股份有限公司

地址: 青岛市城阳区空港工业园月河路
电话: 0532-8493 3988
网址: www.bigherdsman.com

QINGDAO BIG HERDSMAN MACHINERY CO.,LTD

Add: Yuehe road, Konggang industrial park, Qingdao city,
Shandong Province, PR China
Tel: +86-532-8493 3988
Website: www.bigherdsman.com



微信扫描二维码，关注大牧人

大牧人
Big Herdsman



主料线
Main Feed Line

通过螺旋弹簧绞龙转动带动饲料在料管里运动，将饲料送达分料塔、料箱等各个饲喂单元，通过料线末端料位感应器，自动控制送料。

The feed is driven to move in the feeding pipe by the rotation of the spiral spring auger, and delivered to various feeding units including the sub-silos and the feed boxes, and the feeding is automatically controlled by the feed level sensor at the end of the feed line.

青岛大牧人机械股份有限公司
Big Herdsman Machinery CO.,LTD

让养殖变得简单/可靠/环保/高效
Simple/Reliable/Green/Efficient



绞龙主料线Main Feed Line

- 驱动采用意大利品牌电机，铝合金外壳，散热快，不生锈，防护等级IP55；
- 绞龙采用进口高性能材质绞龙，性能稳定；
- 弯管采用尼龙材质，圆弧内侧加厚设计，更耐磨，密封防水；
- 各中转接力处可自由调节角度并配有检修口与观察口，方便观察。
- A Italian-brand motor is employed for drive. It has an aluminum alloy housing providing fast heat dissipation, no rust, and protection grade of IP55;
- The auger is made of imported high-performance material, with stable performance;
- The elbow is made of nylon, and the inner side of the arc is thickened, which is more wear-resistant, sealed and waterproof;
- The angles can be freely adjusted at each intermediate turning positions, and the access hole and observation port are provided to facilitate observation.

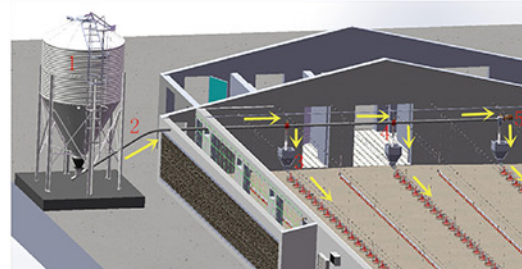

产品参数Product parameters

绞龙料线规格 Specification of auger feed line	125	90		75
电机功率(kw) Motor power	1.5	0.75	1.1	0.75
送料能力 (kg/h) Feeding capacity	5500	2100	3000	1400
最大输送距离 Maximum conveying distance	25	40		60



塞盘主料线Chain pan Main Feed Line

料线通过链条在料管里运行，由链条上注塑尼龙链盘推动饲料运动，将饲料由料塔或人工料箱通过链条的拖拉沿料管到达各个下料口，实现自动送料的目的。

The feed line moves in the feeding pipe through the chain, and the nylon chain pan molded on the chain drives the feed to move in the feeding pipe, and the feed is transported from the silo or manual feed box dragged by the chain along the feeding pipe to feed drop ports, so as to achieve the purpose of automatic feed.

- 驱动系统有过载保护功能，可有效防止电机堵转和链条拉坏；
- 链盘采用改性尼龙材质，耐磨性高，不易移位；
- 转角采用防锈材质，坚固耐用。
- The drive system is provided with overload protection, which can effectively prevent motor stalling and chain damage due to pulling;
- The chain pan is made of modified nylon, with high wear resistance and not easy to be shifted;
- The corner is made of antirust material, firm and durable.

产品参数Product parameters

料管直径 (mm)	Feeding pipe diameter (mm)	Φ101.6		Φ60
料管壁厚 (mm)	Feeding pipe wall thickness (mm)	2.0		1.5
料管材质	Feeding pipe material	热镀锌管 Hot galvanized pipe		热镀锌管 Hot galvanized pipe
驱动功率(kw)	Driving power (kw)	4	2.2	1.5
最大送料能力 (kg/h)	Maximum feeding capacity (kg/h)	5000		1500
最大输送距离 (m)	Maximum conveying distance (m)	250	120	300



青岛大牧人机械股份有限公司

地址: 青岛市城阳区空港工业园月河路
电话: 0532-8493 3988
网址: www.bigherdsman.com

QINGDAO BIG HERDSMAN MACHINERY CO.,LTD
Add: Yuehe road, Konggang industrial park, Qingdao city,
Shandong Province, PR China
Tel: +86-532-8493 3988
Website: www.bigherdsman.com



微信扫描二维码，关注大牧人

大牧人
Big Herdsman



种鸡链式喂料系统 Chain Type Feed Line

链式料线是一种可用于饲养祖代、父母代的肉种母鸡的料线。此种料线送料速度快，自动化程度高，饲料可视且易于维修。

It is a kind of feed line that can be used to feed the grandparent and parent female broilers. The feed speed of this feed line is high, with high automation degree, and feed is visible and easy to repair.

青岛大牧人机械股份有限公司
Big Herdsman Machinery CO.,LTD

让养殖变得简单/可靠/环保/高效
Simple/Reliable/Green/Efficient



主要特点 / Main features



- 驱动装置有安全销结构，有效保护电机过载；
- 链条采用进口品牌，强度高，不易拉伸；
- 转角壳体采用热镀锌处理，转角轮铸钢材质，轴承结构，不生锈，免维护；
- 料槽接口的连接以铆接代替焊接，防锈能力高，寿命长；
- 格栅可防止公鸡采食，宽度和高度可根据客户要求定做；
- 料槽支架为高强度尼龙材质，不易断裂；
- 料箱内有防溢料轮结构，有效防止料箱内饲料溢出；
- The drive device is provided with a safety pin structure to effectively protect the motor against overload;
- The chain is of imported brand, with high strength and not easy to stretch;
- The corner casing is hot-dip galvanized. The corner pulleys are made of cast steel. The bearing structure is rust-free and maintenance-free;
- The connection of the feeder interface is riveted instead of welded, with high rust-proof ability and long life;
- The grille can prevent males from eating, and the width and height can be customized;
- The feeder support is made of high-strength nylon and is not easy to break;
- There is an anti-overflow roller structure in the feed box to effectively prevent feed overflow in the box;



产品参数/Product Parameters

链式料线规格 Chain Feedline Specification		链条宽度 70mm
电机 Motor	电压 Voltage (V)	380
	频率 Frequency (Hz)	50
	防护等级 Protection Class	IP55
	功率 Power (kw)	2.2
	减速比 Speed Ratio	23
	输出转速 Output Speed (r/min)	65
链条速度 Chain Speed (m/min)		36
送料能力 Horizontal Delivery Capacity (kg/h)		3000
料槽盛料量 Feed Trough Capacity (kg/m)		0.55-1.57
水平最大输送距离 Max Horizontal Delivery Distance (m)		250 (含 4 个转角) 250 (4 corners)
料槽宽度 Trough Width (mm)		87
料管壁厚 Feed Pipe Thickness (mm)		1.2
料槽材质 Trough Material		热镀锌板
料槽长度 Trough Length (mm)		2997/根



青岛大牧人机械股份有限公司

地址: 青岛市城阳区空港工业园月河路
电话: 0532-8493 3988
网址: www.bigherdsman.com

QINGDAO BIG HERDSMAN MACHINERY CO.,LTD

Add: Yuehe road, Konggang industrial park, Qingdao city,
Shandong Province, PR China
Tel: +86-532-8493 3988
Website: www.bigherdsman.com



微信扫描二维码，关注大牧人

大牧人
Big Herdsman



镀锌板料塔 Silo

饲料存储设备，可采用打料车打料和气动打料两种方式进行饲料的灌装。

For feed storage equipment, feed can be filled in two ways, i.e. by feed charging truck and pneumatic feeding.

青岛大牧人机械股份有限公司
Big Herdsman Machinery CO.,LTD

让养殖变得简单/可靠/环保/高效
Simple/Reliable/Green/Efficient

技术说明/Technical Description

- 料塔标准梯，带防护栏杆，安全可靠；
- 折筋设计提高强度和密闭性；
- 中围板设计有流水坡，方便排水；
- 中围板和下锥板均开有透视孔，由胶泥条配合锁紧，密封性好，强度高，透视性好；
- 标准件全部经过特殊镀锌工艺处理，橡胶垫10年不老化。



- The standard ladder of the silo is equipped with protective railings, which are safe and reliable;
- The design of bent-up bars improves the strength and tightness;
- The middle coaming is designed with a drain slope to facilitate drainage;
- The middle coaming and the lower cone plate are provided with perspective holes, which are locked by sealing washers, with good sealing performance, high strength, and good perspectivity;
- All standard parts are treated by a special galvanizing process and the rubber pad does not age in 10 years.

产品参数/Product Parameters

序号 S/N	公称外径（下锥角） Nominal outside diameter (lower cone angle)		实际直径 Actual diameter	高度 H Height H	理论容积 Volume (m³)	支腿数 Number of legs
1	Φ1.8m 67°	一层 Layer 1	1834	4100	4.4	4
2		二层 Layer2	1834	5000	6.8	4
3		三层 Layer3	1834	5900	9.2	4
4	Φ2.7m 60°	一层 Layer1	2750	4700	11.7	6
5		二层 Layer2	2750	5600	16.9	6
6		三层 Layer3	2750	6500	22.1	6
7		四层 Layer4	2750	7360	27.3	6
8	Φ3.6m 60°	一层 Layer1	3668	5700	24.5	8
9		二层 Layer2	3668	6600	33.8	8
10		三层 Layer3	3668	7500	43.1	8
11		四层 Layer4	3668	8400	52.4	8

※镀锌板料塔容积与吨位换算按照0.65t/m³密度计算：吨位=容积*0.65t/m³

※ The conversion between the volume and tonnage of galvanized sheet silo is calculated according to the density of 0.65t/m³: tonnage = volume *0.65t/m³.



青岛大牧人机械股份有限公司

地址：青岛市城阳区空港工业园月河路
电话：0532-8493 3988
网址：www.bigherdsman.com

QINGDAO BIG HERDSMAN MACHINERY CO.,LTD

Add: Yuehe road, Konggang industrial park, Qingdao city,
Shandong Province, PR China
Tel: +86-532-8493 3988
Website: www.bigherdsman.com



微信扫描二维码，关注大牧人

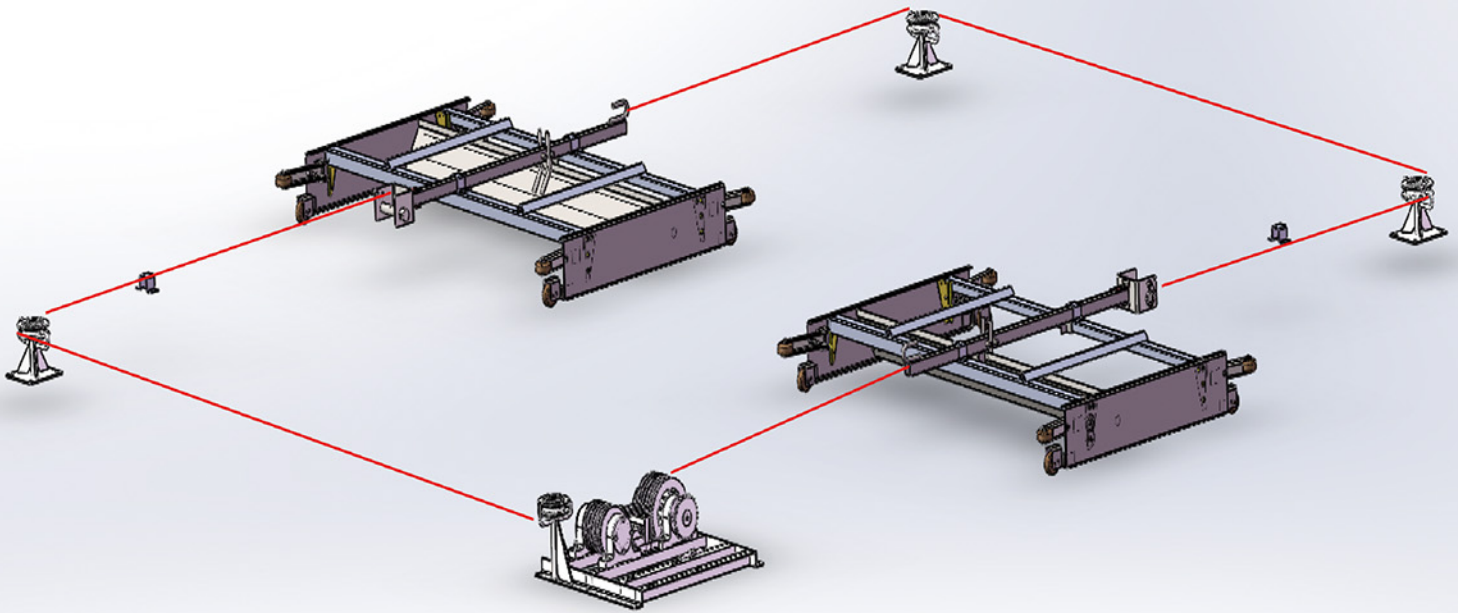

自动清粪机 Manure Scraper

牵引式刮板自动清粪机是为肉鸡网床式饲养和阶梯型笼养而设计的清粪设备，适用于网养、笼养等自动清粪的鸡场。

The traction & blade-type automatic manure scraper is designed for net-bed bred and tier-type cage bred broilers. It is suitable for automatic manure cleaning for net breeding and cage breeding in chicken farms.

青岛大牧人机械股份有限公司
Big Herdsman Machinery CO.,LTD

让养殖变得简单/可靠/环保/高效
——Simple/Reliable/Green/Efficient——

● 技术说明/Technical Description

- 自动清粪机电机与减速机采用卧式直连式组合，结构紧凑、体积小，重量轻、操作简便；
 - 刮粪机采用全部热镀锌、特殊加固刮粪板，保证了清粪机超长使用寿命，刮粪度大于95%，刮板回程离地间隙大于80mm；
 - 刮粪宽度按所制粪槽尺寸而定（标准粪沟尺寸为1850mm，1700mm，800mm）；
 - 牵引绳采用无污染、寿命长、防水、防潮、耐高温、抗腐蚀、超耐磨的PP材料（聚丙烯）；
 - 粪沟中设有行程开关，通过电控箱控制，操作方便可靠。
- The motor and reducer of the automatic manure scraper are combined in a horizontal direct-connection way, compact structure, small volume, light in weight and easy operation;
- The manure scraper is equipped with all hot-dip galvanized and special reinforced blade, ensuring the long service life of the manure scraper. The scraping ratio is greater than 95%, and the return clearance of the blade is greater than 80 mm from the slat;
- The width of manure scraping is determined according to the size of the manure channel (dimensions of a standard manure pit are 1,850 mm, 1,700 mm, 800 mm);
- PP material (polypropylene), which is non-polluting, long-life, waterproof, moisture-proof, high-temperature resistant, corrosion-resistant and super wear-resistant, is used for the traction rope;
- A travel switch is arranged in the manure pit. It is controlled by an electric cabinet and is convenient and reliable to operate.

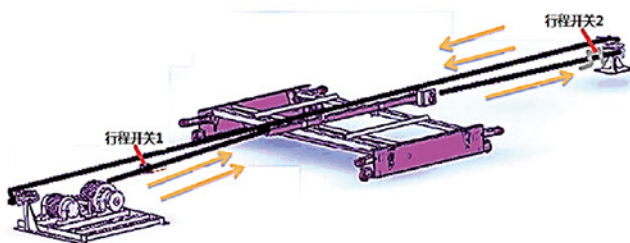

一拖一模式
1 drive 1 Mode

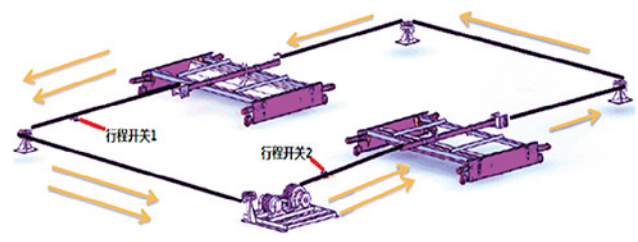

一拖二模式
1 drive 2 Mode

● 产品参数 / Product parameters

电机 Motor	电压 Voltage (V)	380
	频率 Frequency (Hz)	50
	防护等级 Protection Class	IP55
	功率 Power (kw)	2.2
	转速比 Speed Ratio	1: 87
	输出转速 Output Speed (r/min)	16
牵引绳直径 (mm)		16



青岛大牧人机械股份有限公司

地址: 青岛市城阳区空港工业园月河路
电话: 0532-8493 3988
网址: www.bigherdsman.com

QINGDAO BIG HERDSMAN MACHINERY CO.,LTD
Add: Yuehe road, Konggang industrial park, Qingdao city,
Shandong Province, PR China
Tel: +86-532-8493 3988
Website: www.bigherdsman.com



微信扫描二维码，关注大牧人

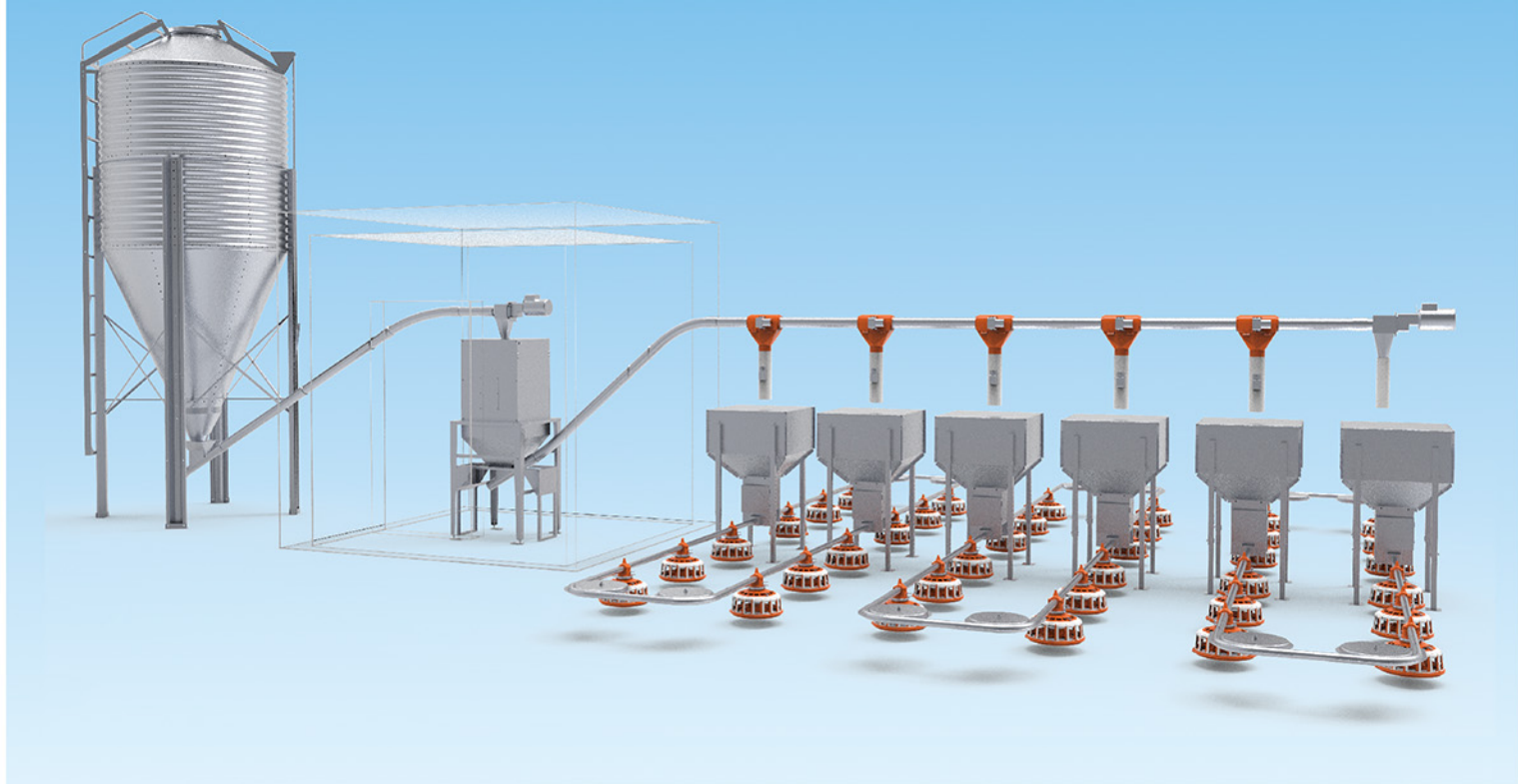

40K PLC称重控制系统

40K PLC Weighing system

40K PLC版称重控制系统为种鸡场专用称重控制系统，可定点定时定量打料、精确分料，系统称重精度小于3‰。

The 40K PLC is a special weighing control system for breeder farm. It can fixed point, timing and quantitative feeding and precise feeding. The weighing accuracy of the system is less than 3‰.

青岛大牧人机械股份有限公司
Big Herdsman Machinery CO.,LTD

让养殖变得简单/可靠/环保/高效
Simple/Reliable/Green/Efficient



●简单：用户输入所需料量按启动键即可自动打料，打料完成后系统自动停止。

●精确：高精度传感器及多种称重误差控制算法，保证称重精度。

●可靠：使用PLC作为核心控制单元，适合养殖环境，运行可靠。

●稳定：数字接线盒，系统抗电磁干扰能力强。

●Simple, users only need to input the required feed and press the start button to feed, the system will stop after completion automatically.

●Accurate, high precision sensor and a variety of weighing error control algorithm, to ensure the weighing accuracy.

●The use of PLC as the core control unit, suitable for breeding environment, reliable operation.

●Digital junction box, high anti-electromagnetic interference ability.



系统称重精度 System Weighing Accuracy	3‰
控制分料能力 Control and feed distribution capacity	可多达 12 个料箱 Up to 12 feed boxes
称重仓及支架主体材质 Main material of weighing bin and support body	高锌层热镀锌板 High-galvanized -layer hot-dip galvanized sheet
称重斗材质 Material of weighing hopper	高强度 PP High-strength PP
触摸屏大小 Touch screen size	7 寸 7 inches
控制系统 Control system	PLC



青岛大牧人机械股份有限公司

地址：青岛市城阳区空港工业园月河路
电话：0532-8493 3988
网址：www.bigherdsman.com

QINGDAO BIG HERDSMAN MACHINERY CO.,LTD

Add: Yuehe road, Konggang industrial park, Qingdao city,
Shandong Province, PR China
Tel: +86-532-8493 3988
Website: www.bigherdsman.com



微信扫描二维码，关注大牧人

大牧人
Big Herdsman



大牧人新型禽舍地板 Plastic Slat System

地板系统主要针对种鸡饲养使用，地板下方储存粪便的同时可为鸡只提供干净舒适的生活环境。

The plastic slat system is mainly designed for breeders. Space under the plastic slat collects manure, ensuring a clean and comfortable environment for breeders.

青岛大牧人机械股份有限公司
Big Herdsman Machinery CO.,LTD

让养殖变得简单/可靠/环保/高效
Simple/Reliable/Green/Efficient

技术说明/Technical Description

- 适用于鸡鸭等禽类的养殖，坚固可靠，平整度可调。
- 合理设计，保证鸡只的正常交配。
- 无毒无味、耐老化、抗腐蚀且安装简单、易冲洗。
- 使用过程中不会产生毛刺，不易产生塑性变形。
- 能有效保持地板清洁，避免污染。
- Suitable for breeding poultry, firm and reliable, with adjustable flatness.
- Appropriate design to ensure proper mating of chickens.
- Non-toxic, aging resistant, corrosion resistant and easy to install and flush.
- No burrs created during use, unlikely plastic deformation.
- Plastic slats are kept clean effectively, free from contamination.



产品参数/Product Parameters

序号 NO.	尺寸: 长*宽*高 (mm) Dimensions: length × width × height	漏粪孔 (mm) Manure discharge hole	漏粪孔数量 Number of manure discharge holes	漏粪率 Manure discharge rate
1	1000*500*40	24*20	448	45%
2	1000*500*40	40*23	320	60%
3	1200*500*40	24*20	560	45%

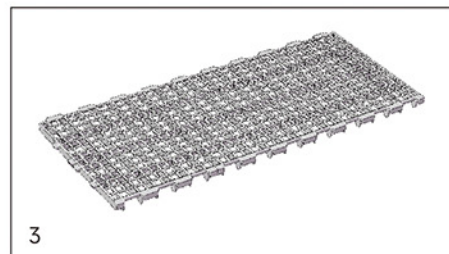
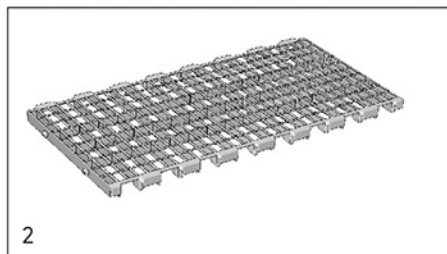
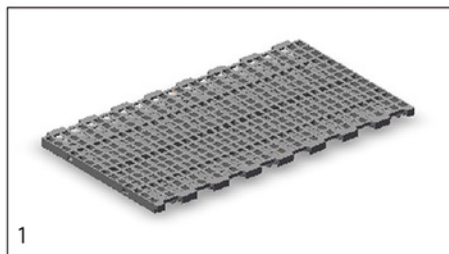

青岛大牧人机械股份有限公司

地址: 青岛市城阳区空港工业园月河路
电话: 0532-8493 3988
网址: www.bigherdsman.com

QINGDAO BIG HERDSMAN MACHINERY CO.,LTD
Add: Yuehe road, Konggang industrial park, Qingdao city,
Shandong Province, PR China
Tel: +86-532-8493 3988
Website: www.bigherdsman.com



微信扫描二维码，关注大牧人



大牧人
Big Herdsman

报警 参数 管理 历史 系统

08 最小级别
最大级别 36

999



999



目标温度 31.5 °C

室外温度 999

日龄

热应激指数

报警信息

通风窗 (%)		纵向进风口 (%)	
1 100 %	2 100 %	1 100 %	2 100 %
3 100 %	4 100 %	3 100 %	4 100 %
5 100 %	6 100 %	5 100 %	6 100 %
7 100 %	8 100 %	7 100 %	8 100 %

加热

光照强度 100 %

变频风机 100 %

湿帘

搅拌风机 100 %

变频风机 100 %



BH9100PRO环控器

BH9100PRO controller

BH9100PRO环控器是针对肉鸡笼养所设计的一款智能化养殖设备，它能够完全检测鸡舍内通风、温度、湿度等各个环境参数，并且根据预设参数自动调节鸡舍环境，让养殖变得更加简单可靠。

BH9100PRO is a smart breeding equipment designed for broiler cage breeding. It can completely detect the ventilation, temperature, humidity and other environmental parameters in poultry house, and adjust the environment of poultry house according to the preset parameters automatically, making the breeding more simple and reliable.

青岛大牧人机械股份有限公司
Big Herdsman Machinery CO.,LTD

让养殖变得简单/可靠/环保/高效
Simple/Reliable/Green/Efficient



输入
input

输出
output



■支持16路温度、4个湿度、4高个CO2、4个NH3、2个负压环境数据的采集，采集数据丰富、精度高。

■内置专业温度曲线、体重、通风等参数，可免设置全自动实时调控养殖舍环境。

■精细降温及多达36个通风级别和最多50个风机组，实现养殖舍的精密通风。

■支持16路可独立的控制的进风口，自动调控进风口的位置和大小。

■8个定频加热和4个变频加热，可针对养殖舍内不同区域的温度精准控制加热量。

■可控制10组制冷设备，水泵山墙、侧墙、双层墙可独立控制。

■12寸工业触摸屏操作，66路干式触点，全部可以实现自定义，两路报警更安全。

■8路定频搅拌风机和4路变频搅拌风机，实现养殖舍环境更均匀。

■可以实现主页面实时显示当前养殖舍风机运转状态、温度、加热、制冷、进风口比例等。

■可连接智能网关和云服务器，养殖数据实时、多终端共享，实现在家办公、云上养殖。

■Support 16 temperature, 4 humidity, 4 CO2, 4 NH3, 2 negative pressure environmental data collection, full and high precision.

■Built-in professional temperature curve, weight, ventilation and other parameters, can avoid setting automatic real-time control of the breeding house environment.

■Fine cooling and up to 36 ventilation levels and up to 50 fan groups, to achieve precision ventilation of the breeding house.

■Support 16 independent control of the air inlet, automatically adjust the position and size

■8 fixed frequency heating and 4 frequency conversion heating, can accurately control the heating heat according to the temperature of different areas in the breeding house.

■Control 10 groups of cooling equipment, water pump gables, side walls, double walls can be independently controlled.

■12" touch screen, 66 dry contacts, all can be customized, two alarm more secure.

■8 fixed frequency stirring fan and 4 frequency conversion stirring fan, to achieve more uniform environment.

■Realize the main page real-time display of the current farm fan operating status, temperature, heating, cooling, air inlet ratio, etc.

■Connect smart gateway and cloud server, farming data real-time, multi-terminal sharing, to achieve home office, cloud farming.



青岛大牧人机械股份有限公司

地址: 青岛市城阳区空港工业园月河路
电话: 0532-8493 3988
网址: www.bigherdsman.com

QINGDAO BIG HERDSMAN MACHINERY CO.,LTD
Add: Yuehe road, Konggang industrial park, Qingdao city,
Shandong Province, PR China
Tel: +86-532-8493 3988
Website: www.bigherdsman.com



微信扫描二维码，关注大牧人



高压喷淋养殖地板清洗机

High pressure spray slat cleaning machine

高压喷淋养殖地板清洗机的应用范围广泛，主要应用于养殖场塑料地板，食品厂的周转筐上的油渍污渍与残渣的清洗与清理。产品运转时由人工将被清洗的容器具送入设备链条轨道上依次进行热碱喷淋、热水喷淋、清水循环喷淋，被清洗容器具在传动链的传动下用三段高压水喷淋清洗。

High pressure spray slat cleaning machine has a wide range of applications, mainly used in farm plastic slat, food factory turnover basket on the oil stains and residue cleaning. When the product is running, the cleaned container is manually sent into the equipment chain track for hot alkali spray, hot water spray, and water circulation spray, and the cleaned container is cleaned with three high-pressure water spray under the transmission chain.

青岛大牧人机械股份有限公司
Big Herdsman Machinery CO.,LTD

让养殖变得简单/可靠/环保/高效
——Simple/Reliable/Green/Efficient——



每段设有防水帘
保证每段清洗不相互交叉污染
Each section is provided with a waterproof curtain to ensure that each section is cleaned without cross-contamination



360°高压清洗
清洗干净/无残留/提高工作效率
360° high pressure cleaning, clean up/no residue/efficiency



立式多级离心泵
扬程远/压力大/清洗效果好
Vertical multistage centrifugal pump, high lift/high pressure/good cleaning effect



智能控制系统
防水开关/一键式操作按钮/易上手
Intelligent control system, waterproof switch/one-click operation button/easy to use



不锈钢输送链条
不锈钢链条/减噪耐磨/自动出料
Stainless steel conveyor chain, stainless steel chain/noise reduction wear resistance/automatic discharge



循环过滤系统
二级过滤系统/清洁度高/防堵塞
Circulating filtration system, secondary filtration system/high cleanliness/anti-bloking

设备名称 Name		高压喷淋养殖地板清洗机 High pressure spray slat cleaning machine
外形尺寸 Size		4000*1200*1500mm(长*宽*高)
设备重量 Weight		350kg
产品主要功率 Power	第一段碱水 1st Alkaline water	水泵功率7.5Kw Pump power 7.5Kw
	第二段热水 2nd Hot water	水泵功率5.5Kw Pump power 5.5Kw
	电加热功率 Heating	18Kw
	输送电机功率 Conveyer motor power	0.55Kw
产量 Capacity	每小时800-1000个地板 800-1000 slats/hour	



青岛大牧人机械股份有限公司

地址: 青岛市城阳区空港工业园月河路
电话: 0532-8493 3988
网址: www.bigherdsman.com

QINGDAO BIG HERDSMAN MACHINERY CO.,LTD
Add: Yuehe road, Konggang industrial park, Qingdao city,
Shandong Province, PR China
Tel: +86-532-8493 3988
Website: www.bigherdsman.com



微信扫描二维码, 关注大牧人

大牧人
Big Herdsman



防腐隔热料塔

Anti-corrosion insulation silo

防腐隔热料塔采用性价比最高且高效的纳米防腐、隔热镀锌板，包括基板、高分子转化层、光谱选择性反射隔热层、纳米材料层(耐候、耐酸碱保护层)、镀锌层，其具有以下优点：

- 拥有良好的耐候性、耐酸碱、防腐蚀、隔热等优点，延长设备使用寿命；
- 安装便捷，和普通料塔完全一样，免去二次施工；
- 可减少85%热量吸收，有效保持塔内饲料温度，减少霉变，提高养殖效能

Anti-corrosion insulation silo is made with the most cost-effective anticorrosive and heat-insulating aluminium sheet includes substrate, polymer conversion layer, spectral selective reflective insulation layer, anti-aging PET material layer (weather and acid-alkali protection layer) and double-sided galvanized layer.

- Good weather resistance, acid and alkali resistance, corrosion resistance, heat insulation, extend the service life of the equipment;
- Easy installation, same as common silo, no need secondary construction;
- Reduce the heat absorption by 85%, effectively maintain the feed temperature in silo, reduce mildew, and improve the breeding efficiency.

青岛大牧人机械股份有限公司
Big Herdsman Machinery CO., LTD

让养殖变得简单/可靠/环保/高效
Simple/Reliable/Green/Efficient

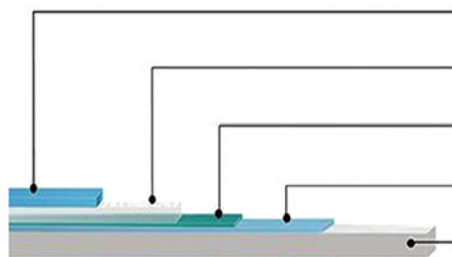

名称	功能
抗老化PET Anti-aging PET	耐老化、化学腐蚀、阻隔紫外线穿透 Anti-aging, anti-chemical corrosion, UV blocking penetration
抗老化胶 Anti-aging adhesive	耐紫外老化、化学腐蚀 UV resistant anti-aging bonding layer
铝箔层 Aluminum foil layer	耐紫外老化、化学腐蚀 Resistant to UV aging, chemical corrosion
高温、高分子 High temperature, polymer	强力粘结、耐候、伸缩性强 Strong bonding, weatherability and scalability
镀锌板 Galvanized sheet	双面镀锌层防腐、耐锈 Double-sided galvanized layer, anti-corrosion, rust resistance

纳米防腐隔热覆膜板表面的反射隔热膜能选择性地将阳光中的各种能源、红外线、紫外线以及可见光热能反射，反射率达85%，通过与普通彩钢板实验对比表明：纳米防腐隔热覆膜板表面温度远低于普通彩钢板，室内温度同样低于普通彩钢板温度，具有高效隔热性能。

The aluminum plastic steel plate adhered to the surface of the thermal insulation acid-proof plate can selectively reflect various energy, infrared, ultraviolet and visible light and heat energy in the sunlight, and the reflectivity can reach 85%. The comparative experiment of thermal insulation performance between aluminum plastic steel plate and common color steel plate shows that the surface temperature of heat insulation acid-proof plate is much lower than that of common color steel plate and the indoor temperature is lower than that of common color steel plate, which has high thermal insulation performance.



各种料塔温度对比发现纳米防腐隔热料塔隔热效果最好。

The comparative experiment of thermal insulation performance show that the aluminum plastic steel plate silo has high thermal insulation performance.

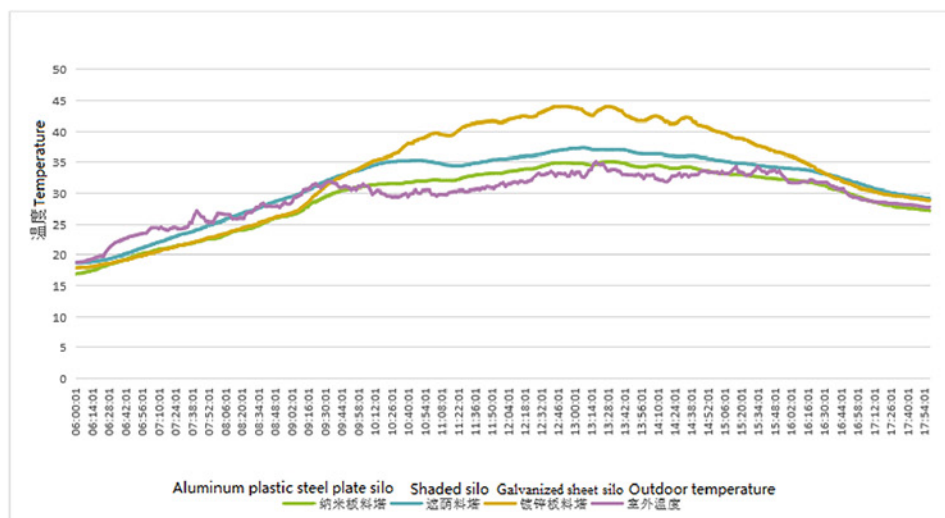

序号 NO1.	实际直径 Actual diameter	围板层数 Tier	高度 Height/m	容积 Volume/m ³	吨位 ton/t	支腿数 Uprights Quantity
1	1834	1	4100	4.4	2.8	4
2		2	5000	6.8	4.4	4
3		3	5900	92	6	4
4	2750	1	4700	11.7	7.6	6
5		2	5600	16.9	11	6
6		3	6500	22.1	14.3	6
7	3660	4	7360	27.3	17.7	6
8		2	6600	33.8	22	8
9		3	7500	43.1	28	8
10		4	8400	52.4	34	8



青岛大牧人机械股份有限公司

地址: 青岛市城阳区空港工业园月河路
电话: 0532-8493 3988
网址: www.bigherdsman.com

QINGDAO BIG HERDSMAN MACHINERY CO.,LTD
Add: Yuehe road, Konggang industrial park, Qingdao city,
Shandong Province, PR China
Tel: +86-532-8493 3988
Website: www.bigherdsman.com



微信扫描二维码，关注大牧人



公鸡槽式料线

Male Trough Feeding System

公鸡槽式料线是一种可用于饲养祖代、父母代的公鸡的料线

Male Trough Feeding System is a feeding line that can be used to feed grandparents and parents of male breeders.

公鸡槽式喂料系统是一种循环料线，它采用提升打料方式，在提升状态下把料槽内布满饲料，然后把料槽放到相应的高度，鸡只开始采食，此饲喂方式可以保证鸡只采食量的相同。在采食的过程中，循环料线还可以持续运转，可以保证所有的鸡只能够一直有料吃。

The male trough feeding system is a loop feed system, which filling the trough with feed in the lifting state, and then placing the trough to the corresponding height. It can ensure the same feed intake of chickens. During feeding, the feed line can continue to run, which can ensure that all chickens can always have food

青岛大牧人机械股份有限公司
Big Herdsman Machinery CO.,LTD

让养殖变得简单/可靠/环保/高效
Simple/Reliable/Green/Efficient

- ◆打料速度快，最高速度可达18m/min
- ◆自动化程度高，可设置提升打料时间、提升高度及正常料线高度，饲料可视且易于维修。
- ◆电动提升打料，落下同步吃料，可减少鸡只应激和确保打料均匀度
- ◆单位长度料量可调，最低料量达到行业最低：单侧350g/m，可以让公鸡更早的使用槽式喂料系统
- ◆灵活的料位调节机制，推荐1米双侧养10只，多余料位可以加盖子
- ◆食槽采用275g的国标热镀锌板，防锈性能好，边缘内翻边处理，防止伤鸡
- ◆链条采用长方形滑块，底部不存饲料，防止饲料霉变
- ◆链条牵引采用φ6丝径的链环焊接，1.8吨拉力不变形，粗壮不易断链
- ◆防止鸡只栖息在食槽上污染饲料，φ50PVC管防栖转轴机构
- ◆Fast feeding, up to 18m/min
- ◆Highly automatic, lifting time and height can be set. Feed visibility and easy maintenance
- ◆Electric lift feed, drop feed synchronously, can reduce stress of birds and ensure the uniformity of feed
- ◆Adjustable unit feeding, and the minimum feed is the lowest in the industry: 350g/m on one side, which allows the males to use the trough feeding system earlier.
- ◆Flexible feed level adjustment, it is recommended to raise 10units on both sides of 1 meter, and the excess feed level can be covered
- ◆275g national standard hot galvanized feed trough, with good rust-proof performance, and the edge is flanged to prevent chickens from being hurt
- ◆Adopt the slider type chain, no feed is stored at the bottom to prevent feed mildew
- ◆φ6 wire diameter chain ring welding, 1.8t of tension without deformation, firm and not easy to break
- ◆φ50PVC pipe design to keep birds from roosting

技术参数 Parameter

产品名称 Product name	公鸡槽式料线 MaleTrough Feeding System
产品组件 Product component	产品材质 Product material
驱动电机Driving motor	三相 380V 50HZ 功率1.5KW 防护等级 IP55，国外可定制 3 phase 380V 50HZ 1.5KW IP55 can be customized
主从动壳体Driven part	热镀锌，锌层厚度≥40μm Hot dip galvanizing, zinc layer thickness ≥40μm
双面食槽Feed trough	热镀锌板，壁厚1.2mm，锌层厚度275g/m ² Hot galvanized sheet, t= 1.2mm, zinc layer thickness 275g/m ²
防栖装置Anti roost part	PVC圆管，φ50mm，壁厚2.4mm PVC round pipe, φ50mm, t= 2.4mm
链条Chain	圆环材质20Mn，滑块材质Q235 Ring material 20Mn, slider material Q235
悬挂部分Suspension part	滑轮，悬挂钩，钢丝绳，起重链条等，用于吊点悬挂 Pulley, suspension hook, wire rope, lifting chain, etc., for suspension point suspension
电动提升Electric lift	三相380V、50HZ，功率0.75KW，防护等级：IP55，输出扭矩800N·M，国外可定制 3 phase 380V, 50HZ, 0.75KW, IP55, output torque 800N·M, can be customized
料箱Feed box	500L大料箱

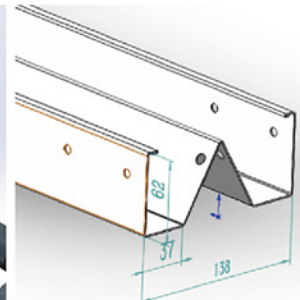
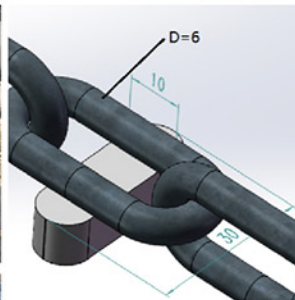

青岛大牧人机械股份有限公司

地址：青岛市城阳区空港工业园月河路
电话：0532-8493 3988
网址：www.bigherdsman.com

QINGDAO BIG HERDSMAN MACHINERY CO.,LTD
Add: Yuehe road, Konggang industrial park, Qingdao city,
Shandong Province, PR China
Tel: +86-532-8493 3988
Website: www.bigherdsman.com



微信扫描二维码，关注大牧人

大牧人
Big Herdsman



链式料线同步喂料系统

Chain synchronous feeding system

清洁 省料 全程无需拆卸繁复作业

Clean, saving feed and without complicated dismantling work

青岛大牧人机械股份有限公司
Big Herdsman Machinery CO.,LTD

让养殖变得简单/可靠/环保/高效
Simple/Reliable/Green/Efficient

- ◆封闭打料，布料均匀，并可有效防止饲料被粪便污染，降低鸡只患病风险
- ◆同时吃料，有效避免鸡只抢食，大大提高了鸡群体重均匀度
- ◆铰链式连接结构，防止夹鸡头
- ◆全程无需拆卸设备，不使用时只需要整体提升至一定高度代用，不会对其他作业产生干扰
- ◆Closed feeding, Uniform feeding distribution, and effectively preventing feed contamination by poultry dung, reducing the risk of disease
- ◆Eating at the same time, effectively avoiding chicken grabbing food, greatly improving the chicken weight uniformity
- ◆Hinged connection structure to prevent chicken head from hurting
- ◆It doesn't need to disassemble the equipment in the whole process, and it only needs to be lifted to a certain height when not in use, which will not interfere with other operations

封闭打料状态

Closed transporting feed condition

提升饲喂状态

Raised feeding condition

出鸡后使用前整体提升状态

Raised state from culling the chicken to using again

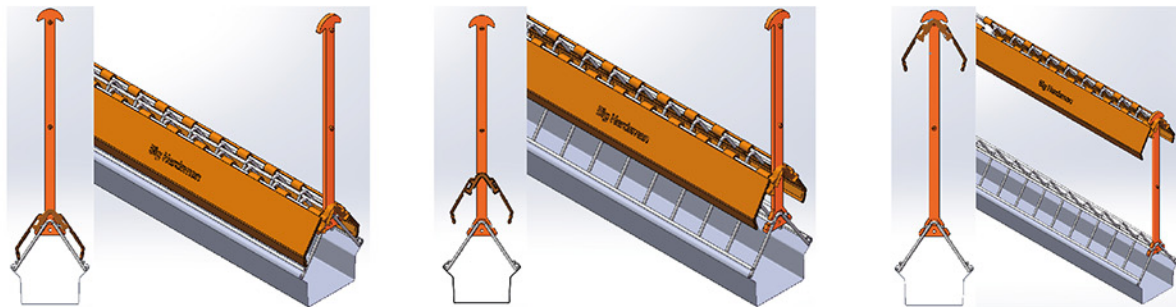

技术参数 Parameter

产品名称 Product name	链式料线同步喂料 Chain synchronous feeding system
产品组件 Product component	产品材质 Product material
导向座guide holder	PP polypropylene
盖板cover plate	PP polypropylene
格栅及提升格栅Grille and lift grille	热镀锌丝 Hot dip galvanized iron wire
换向器commutator	铸铁+锥形金属齿轮 Cast iron + conical metal gear
万向节cardan joint	镀黑锌 zinc black
卷轴管Spool tube	热镀锌管 DN25 Hot-dip galvanized pipe DN25
驱动电机drive motor	三相380V、50HZ，功率0.75KW， 防护等级：IP55，输出扭矩800N·M，国外可定制 Three-phase 380V, 50HZ, power 0.75KW, protection grade: IP55, output torque 800N · M, can be customized abroad



青岛大牧人机械股份有限公司

地址：青岛市城阳区空港工业园月河路
电话：0532-8493 3988
网址：www.bigherdsman.com

QINGDAO BIG HERDSMAN MACHINERY CO.,LTD
Add: Yuehe road, Konggang industrial park, Qingdao city,
Shandong Province, PR China
Tel: +86-532-8493 3988
Website: www.bigherdsman.com



微信扫描二维码，关注大牧人

大牧人
Big Herdsman



隧道通风窗

Tunnel ventilation window

- 小尺寸横梁遮挡，相同洞口尺寸下极尽增大进风面积；
Small size beam occlusion, the same hole size under the maximum increase in air inlet area;
- 模块化设计，备货周期短，运输安装更快捷简单；
Modular design, short stocking cycle, faster and simpler transportation and installation;
- 重量轻便，防晒耐腐；
Light weight, sun protection and corrosion resistance;
- 产品美观，经久耐用； Beautiful products, durable;

青岛大牧人机械股份有限公司
Big Herdsman Machinery CO.,LTD

让养殖变得简单/可靠/环保/高效
Simple/Reliable/Green/Efficient

1.门板材质Door panel material:

门板采用6mm厚度的雪弗板或PP中空板材质，耐酸碱腐蚀，使用寿命长。

The door plate is made of 6mm thick sheaf plate or PP hollow plate, which is resistant to acid and alkali corrosion and has a long service life.



克重: 1000g/m²



克重: 3000g/m²

3.密封性能Sealing performance:

边沿加装密封毛条，门板闭合后，可有效提高结合部位的密封性能。

The sealing performance of the joint part can be effectively improved after the door plate is closed and the sealing strip is installed on the edge.



2.框架材质Frame material:

框架采用ABS+PVC材质，接头处采用304不锈钢连接件加固，坚固不变形。

The frame is made of ABS+PVC material, and the joints are reinforced with 304 stainless steel connectors.



4.可拆卸结构Removable structure:

门板转动轴采用可拆卸结构，安装紧固，抗风性能突出，方便拆装更换，降低客户使用成本。

The rotating shaft of the door panel adopts a detachable structure, the installation is tight, the wind resistance is outstanding, the disassembly and replacement is convenient, and the customer's use cost is reduced.



5.联动性能Linkage performance:

在90°开合角度内任意角度开合，多向进风。联动结构，同步开合，满足各养殖阶段的通风需求。

Open and close at any Angle within 90° opening and closing Angle, multi-direction air intake. Linkage structure, synchronous opening and closing, to meet the ventilation needs of each breeding stage.

技术参数 Parameter

产品名称 Product name	隧道通风窗 Tunnel ventilation window
产品尺寸 Product size:	见附表 See attached table
产品材质 Product material:	ABS边框+6mm厚度雪弗板 ABS边框+6mm厚度PP中空板 ABS frame + 6mm chevrole ABS frame + 6mm PP hollow board

层数 layers	成品尺寸 (mm)	通风量 (10 pa)4	通风量 (20 pa)5.5	通风量 (25pa)6.3	洞口预留尺寸 (mm)
4	1500*1120	24192m ³ /h	33264m ³ /h	38102m ³ /h	1530*1150
5	1500*1400	30240m ³ /h	41580m ³ /h	47628m ³ /h	1530*1430
6	1500*1680	36288m ³ /h	49896m ³ /h	57154m ³ /h	1530*1710
7	1500*1960	42336m ³ /h	58212m ³ /h	66679m ³ /h	1530*1990
8	1500*2240	48384m ³ /h	66528m ³ /h	76205m ³ /h	1530*2270



青岛大牧人机械股份有限公司

地址: 青岛市城阳区空港工业园月河路
电话: 0532-8493 3988
网址: www.bigherdsman.com

QINGDAO BIG HERDSMAN MACHINERY CO.,LTD

Add: Yuehe road, Konggang industrial park, Qingdao city,
Shandong Province, PR China
Tel: +86-532-8493 3988
Website: www.bigherdsman.com



微信扫描二维码，关注大牧人

大牧人
Big Herdsman



鸡用圆管水线

Round tube waterline for chickens



- 出水量稳定，高效过滤杂质，使用寿命长
- 单独的反冲管路实时准确记录鸡只饮水情况
- 一体式结构化设计，有效防止水管转动问题
- 科学可靠的饮水系统，简单高效的产品理念

- This product lies in stable water output, efficient filtration of impurities, and longer service life.
- A separate recoil line accurately records the chickens' water intake in real time.
- Integrated structural design, effectively prevent water pipe rotation problems.
- Scientific and reliable drinking water system, simple and efficient product concept.

青岛大牧人机械股份有限公司
Big Herdsman Machinery CO.,LTD

让养殖变得简单/可靠/环保/高效
Simple/Reliable/Green/Efficient



- 水线前端采用两级过滤，有效过滤水中杂质。
- 饮水组件采用高耐磨、耐用材质，使用寿命长。
- 饮水圆管强度高，韧性好，不易变形，承压力大。
- 一体式球阀饮水器，出水量稳定，不渗水，不漏水。
- The water front kit adopts two-stage filtration to effectively filter impurities in the water.
- The drinking water component is made of high wear-resistant and durable material, which makes it a longer service life.
- The drinking water round pipe has high strength, good toughness, is not easy to deform and bear large pressure.
- Integral ball valve drinking water, stable water output, no water seepage, no water leakage.

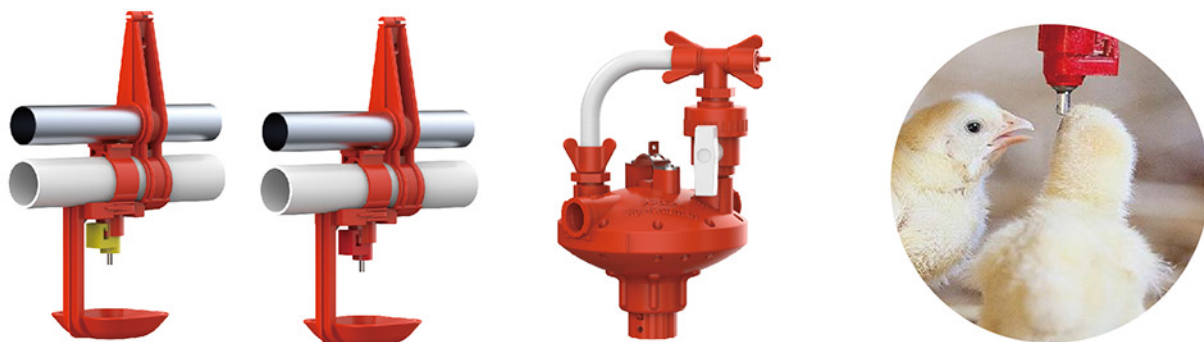

技术参数 Parameter

产品名称 Product name	鸡用圆管水线 Round tube waterline for chickens
结构形式 Structural form	一体式球阀饮水器，360°侧击可出水 Integral ball valve drinking water, 360° side impact can water
球阀饮水器材质 Ball valve drinking water equipment quality	ABS聚丙烯&304不锈钢 ABS polypropylene and 304Stainless steel
适用水压 Applicable water pressure	2kpa~6kpa 2kpa~6kpa
主进水管外径尺寸 Outer diameter of the main water inlet pipe	大于等于32mm Equal to or greater than 32mm
饮水管外尺寸 External dimensions of drinking pipe	Φ33.4 Φ33.4



青岛大牧人机械股份有限公司

地址: 青岛市城阳区空港工业园月河路
电话: 0532-8493 3988
网址: www.bigherdsman.com

QINGDAO BIG HERDSMAN MACHINERY CO.,LTD

Add: Yuehe road, Konggang industrial park, Qingdao city,
Shandong Province, PR China
Tel: +86-532-8493 3988
Website: www.bigherdsman.com



微信扫描二维码，关注大牧人

大牧人 Big Herdsman

让养殖变得简单/可靠/环保/高效
——Simple/Reliable/Green/Efficient——

青岛大牧人机械股份有限公司

地址: 青岛市城阳区空港工业园月河路

电话: 0532-8493 3988

网址: www.bigherdsman.com

QINGDAO BIG HERDSMAN MACHINERY CO.,LTD

Add: Yuehe road, Konggang industrial park, Qingdao city,
Shandong Province, PR China

Tel: +86-532-8493 3988

Website: www.bigherdsman.com



网站/Website



微信扫描二维码, 关注大牧人