

# ENGINEERED SOLUTIONS. INSPIRED EXECUTION.

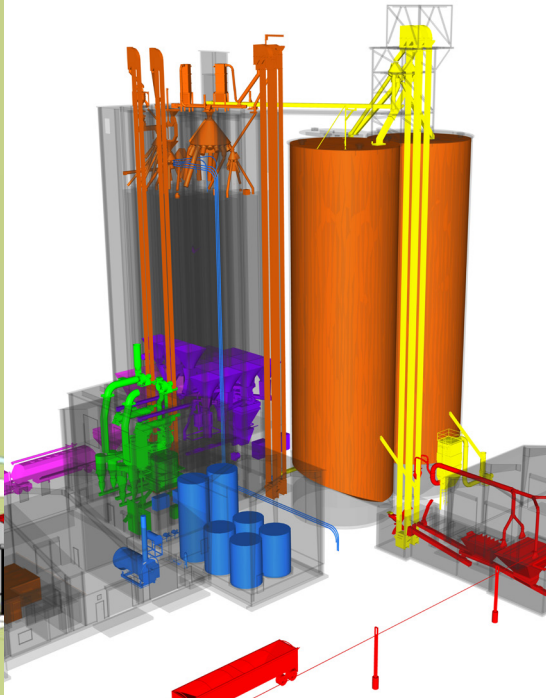

DESIGN & PRECONSTRUCTION  
ENGINEERING & DETAILING  
PROJECT MANAGEMENT & PROCUREMENT  
FIELD CONSTRUCTION & START UP

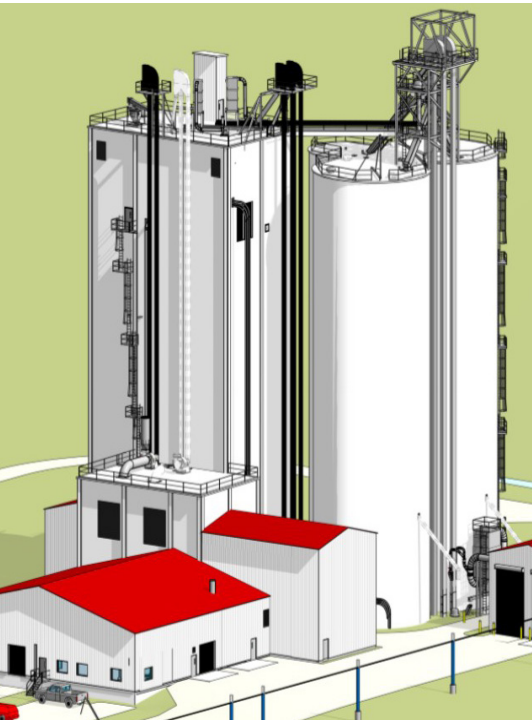

515.232.0442 | [tsargent.com](http://tsargent.com)



## Parrish & Heimbecker

*Viking, Alberta*

### Shuttle Train Terminal

- 23,000 BPH Truck Receiving
- 60,000 BPH Rail Shipping
- BM&M Float Cleaning System
- Slipform Concrete Workhouse
- Office Structure

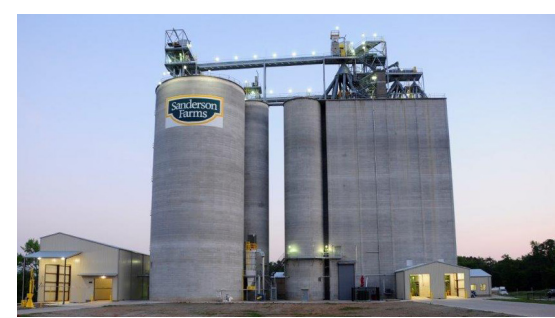

## Sanderson Farms

*Mineola, Texas*

### Poultry Feed Mill

- Rail & Truck Receiving
- Ingredient Storage
- Whole Grain Storage
- Grinding
- Batching
- Pelleting

## Richardson Pioneer

*High Level, Alberta*

### Inland Grain Terminal

- 30,000 BPH Truck Receiving
- 60,000 BPH Rail Loadout
- 10,000 BPH Truck Loadout
- Dryer with Pre-Cleaning System
- Future Cleaning Capability



## Pilgrim's Pride

*Ranger, Georgia*

### Poultry Feed Mill

- Truck & Rail Receiving
- Soy Storage
- Whole Grain Storage
- Grinding
- Batching
- Pelleting/Fat Application
- Corn Transload Bulkweigh System

## Heartland Coop

*Fairfield, Iowa*

### Shuttle Train Loading

- Two Truck Receiving Pits
- Third Pit - Rail or Truck
- 90,000 BPH Shipping System
- Slipformed Concrete Elevator
- Wet Grain Storage/ Dryer System



## OP Nutrition

*Peru, Indiana*

### Swine Feed Mill

- Two Truck Receiving
- Ingredient Storage
- Whole Grain Storage
- Grinding
- Batching
- Pelleting/Fat Application



# CONCEPT TO COMPLETION

## SERVICES PROVIDED

General Contractor  
Conceptual Development  
& Design Management  
Structural Engineering  
& Detailing

### *Self-Performed:*

- Cast-in-Place Concrete
- Slipform Concrete
- Millwright Installation
- Carpentry
- Steel Erection
- Commissioning

### *Site-Management:*

- Permits
- Rail
- Site/Civil
- Electrical
- Mechanical

